



DARTWOOD Mini Bubble Machine User Manual

[Home](#) » [DARTWOOD](#) » DARTWOOD Mini Bubble Machine User Manual 

Contents

- [1 DARTWOOD Mini Bubble Machine](#)
- [2 In the Box](#)
- [3 Introduction to Parts](#)
- [4 How to Add Bubble Liquid](#)
- [5 Guidelines](#)
- [6 SPECIFICATION](#)
- [7 Documents / Resources](#)
- [8 Related Posts](#)



DARTWOOD Mini Bubble Machine



In the Box

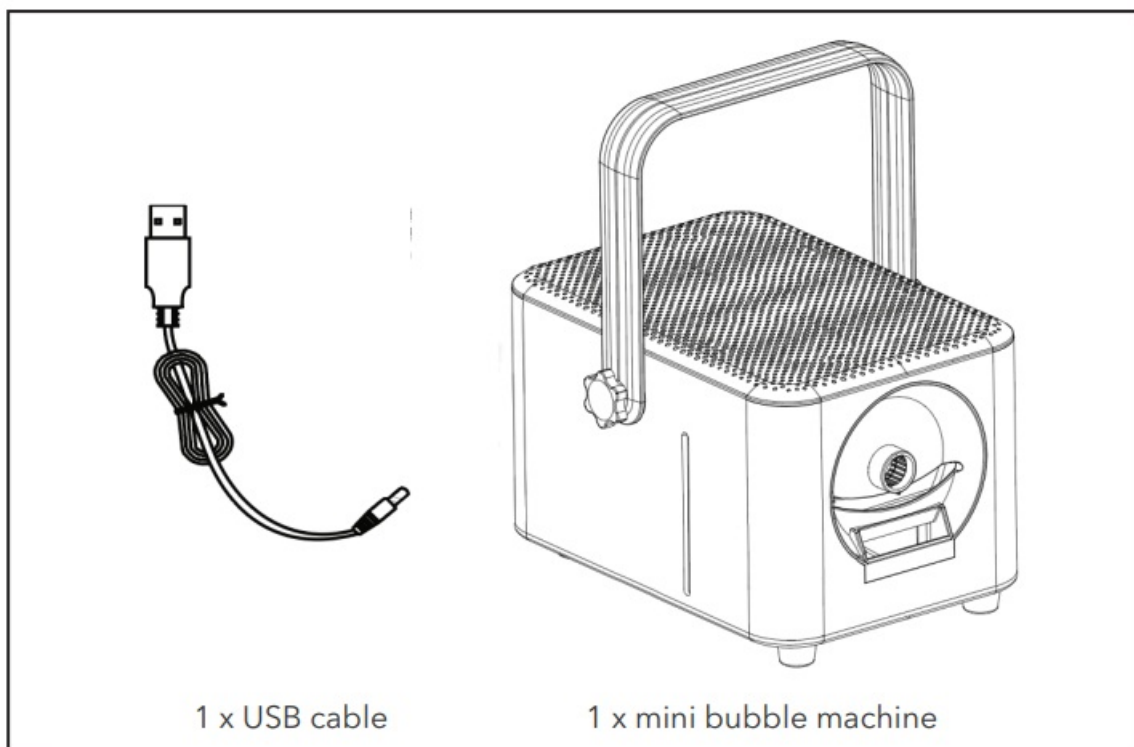

Introduction to Parts

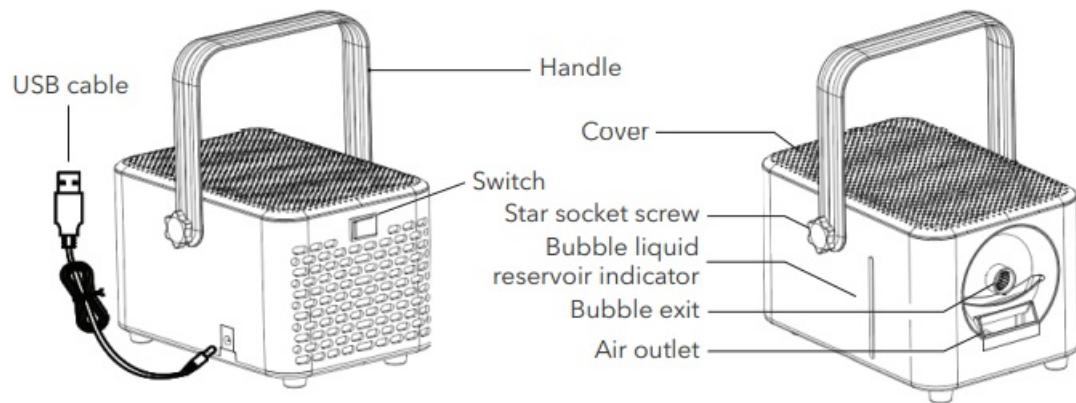

Note:

- **INDOOR:** 5V/2A USB Power Adapter are required (not included)
- **OUTDOOR:** Recommended to use a regular portable power bank (not included)

How to Add Bubble Liquid

1. Remove the top cover by sliding back and lifting up.

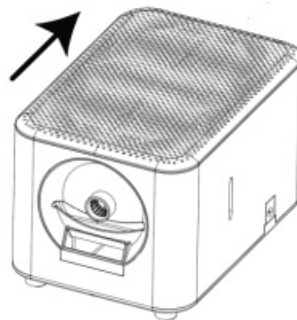

2. Pull out the plug and add the bubble liquid into the compartment.

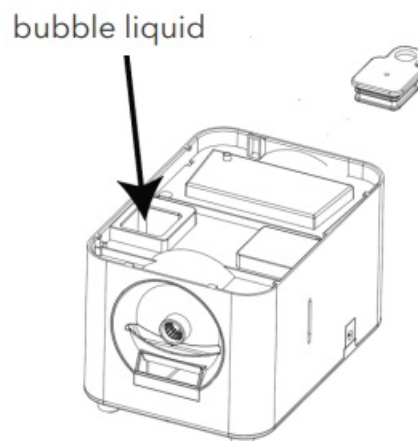

3. Reinsert the plug and slide the cover back on top.

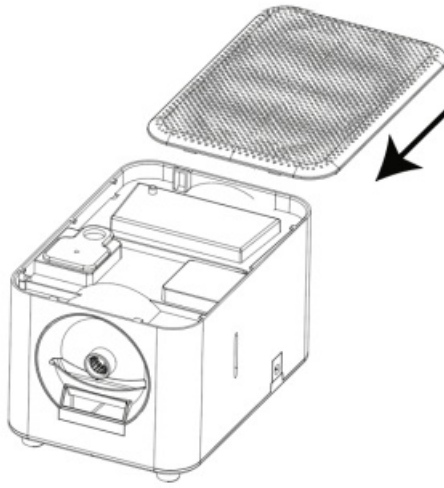

Power On/Off

Plug the USB cable into the machine and an adapter/outlet or power bank before use.



Guidelines

1. Do not overfill the bubble liquid.
2. Do not move, tilt, or turn over the bubble machine while it is on.
3. Do not use if machine has been broken or damaged in any way.

SPECIFICATION

- **Power input:** 5V/2A
- **Power consumption:** 10W
- **Control method:** Rocker switch
- **Environment temperature:** Room temperature
- **Product net weight:** 2.1 lb
- **Noise:** 75 dB
- **Product size:** 7.8 x 5.3 x 4.5 in
- **Bubble liquid maximum capacity:** 4.7 fl oz
- **Working hours:** 2.5 hours
- **Bubbling time (When it is filled with bubble liquid (4.7 fl oz):** About 15 minutes

Get More Support

Contact@wasserstein-home.com



WARNING: CHOKING HAZARD Small Parts. Not for Children under 3 years old.

www.wasserstein-home.com

Documents / Resources

 <p>Mini Bubble Machine USER MANUAL</p> <p>DARTWOOD</p>	<p>DARTWOOD Mini Bubble Machine [pdf] User Manual</p> <p>Mini Bubble Machine, Mini Machine, Bubble Machine, Mini Bubble</p>
--	---