



DART SL Extreme ZOHD User Guide

[Home](#) » [DART](#) » DART SL Extreme ZOHD User Guide



User Guide Thank you for supporting us buying a Dart XL “Extreme” Enhanced Version
Stay connected with us through our social media channels:



Contact us: info@sonicmodell.com sales@sonicmodell.com
Customer service: cs@sonicmodell.com www.sonicmodell.com



1. Remove the rear hatch by pulling up from the end closer to the motor. Its held by magnets.
2. Use the thumbscrews to attach or detach the main wings.

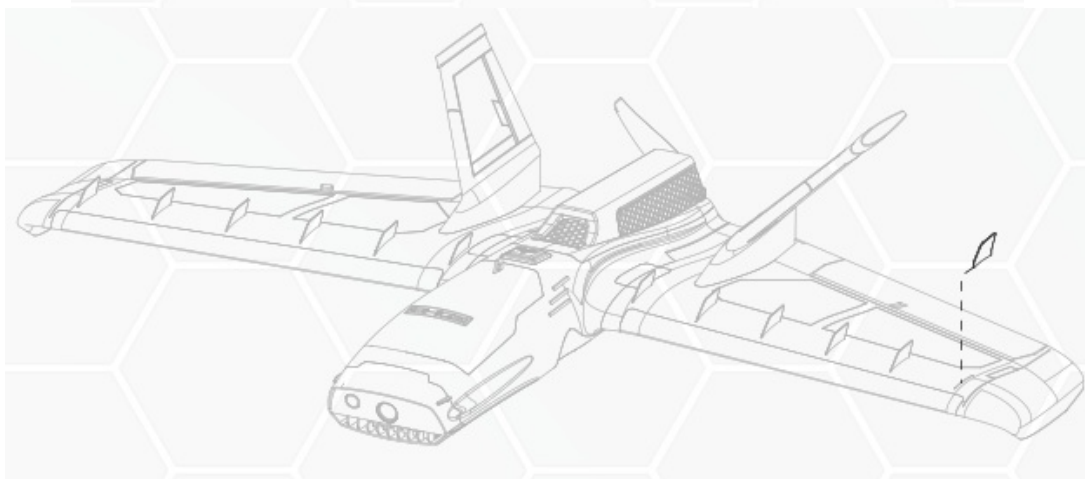
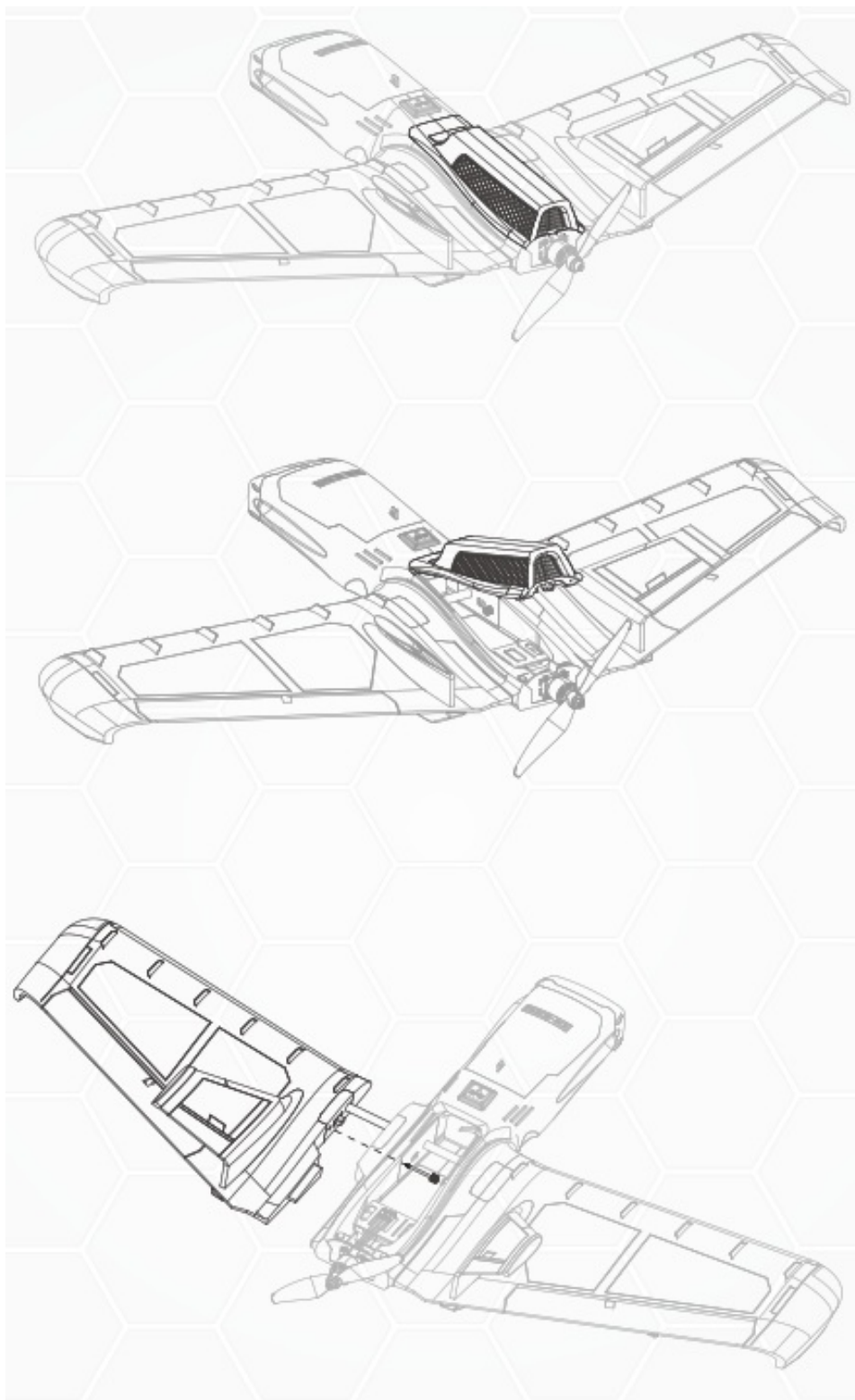

3. Use a bit of glue to fix the VG's on your wings.

4. Lock and unlock the tail fins by twisting the plastic peg shown in the picture.

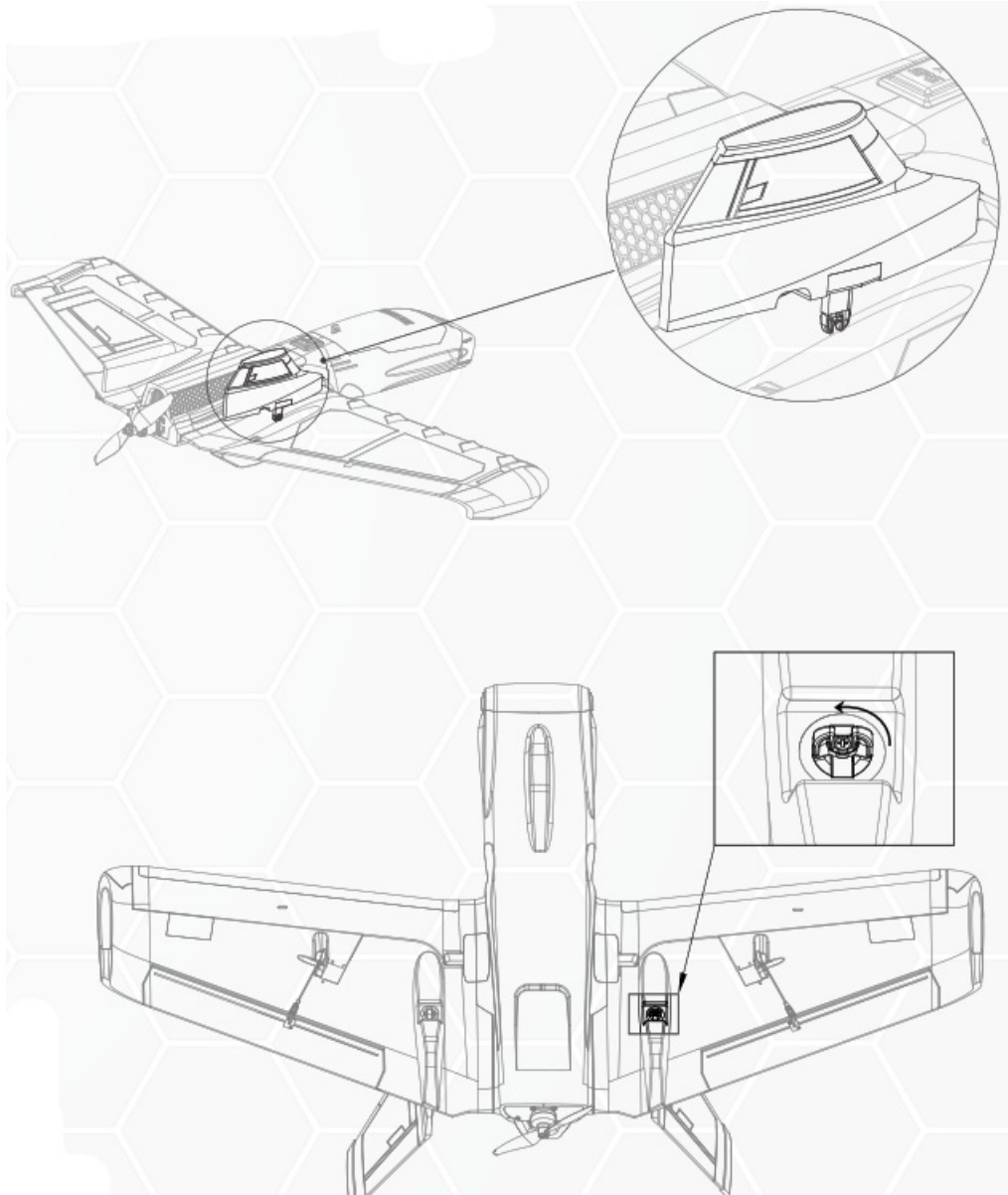

ZOHD
Inspiring The Future



5. Use the provided mask to suit your preferred camera configuration.



6. CG marks are below the wings. Be sure to set it properly before flying.

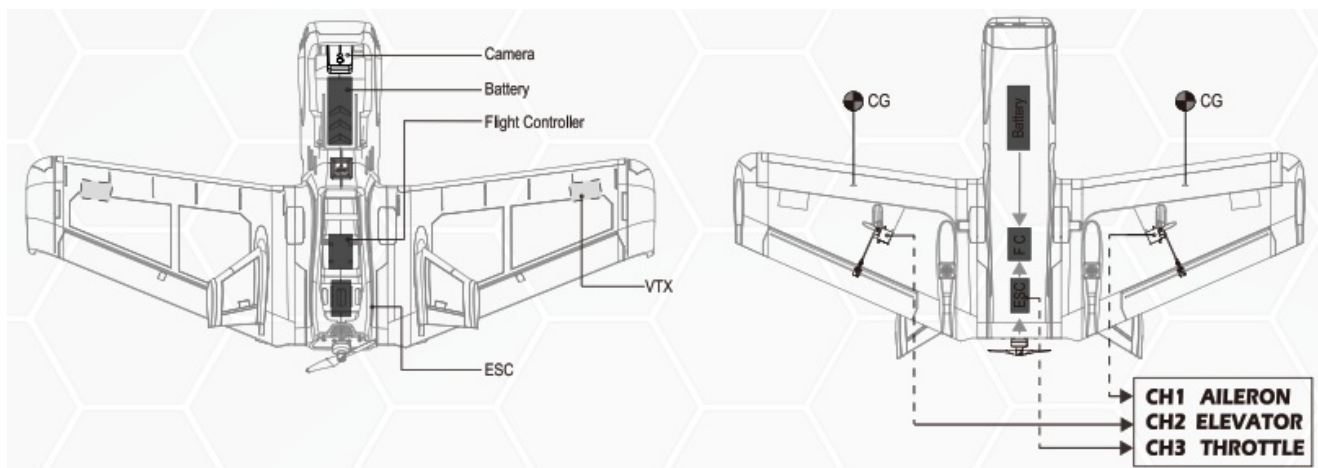

7. Recommended control surfaces throws:

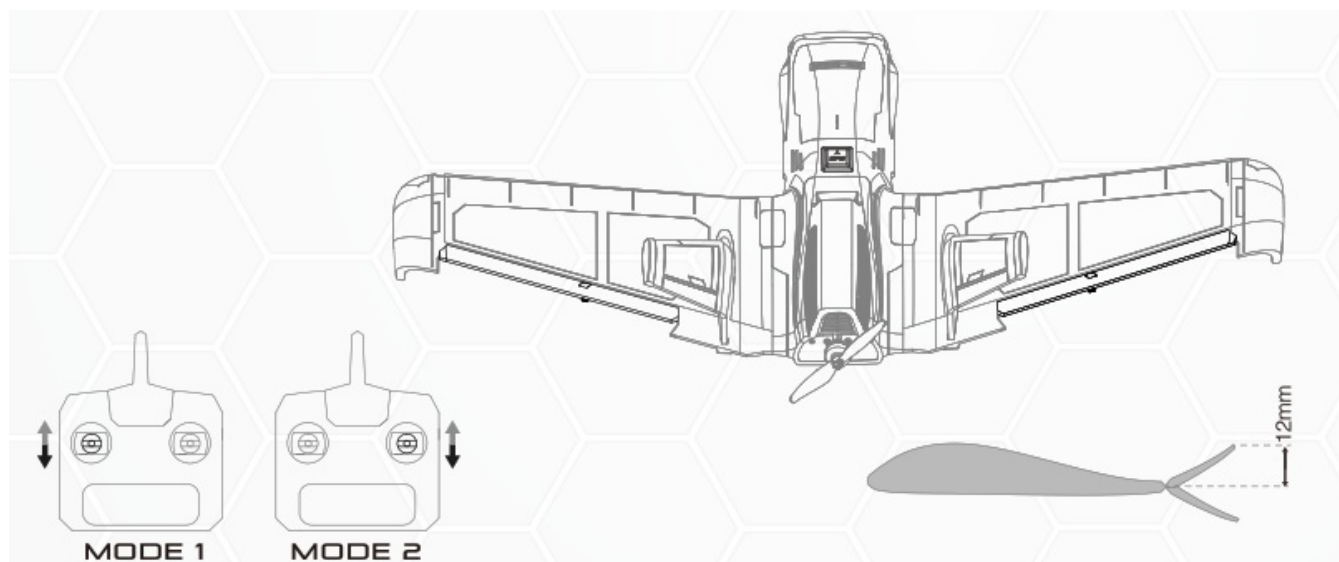
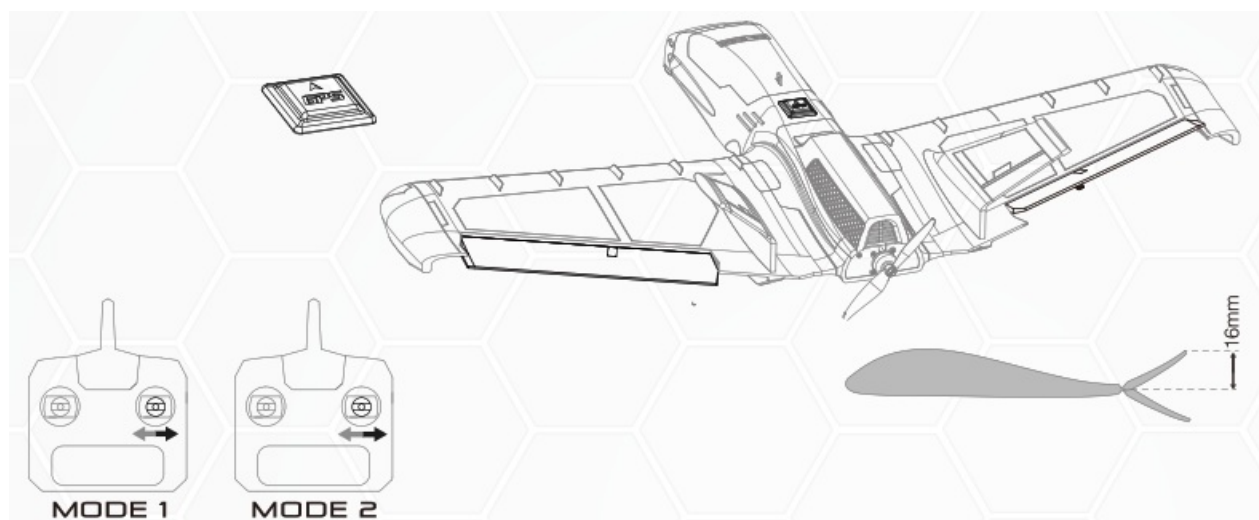

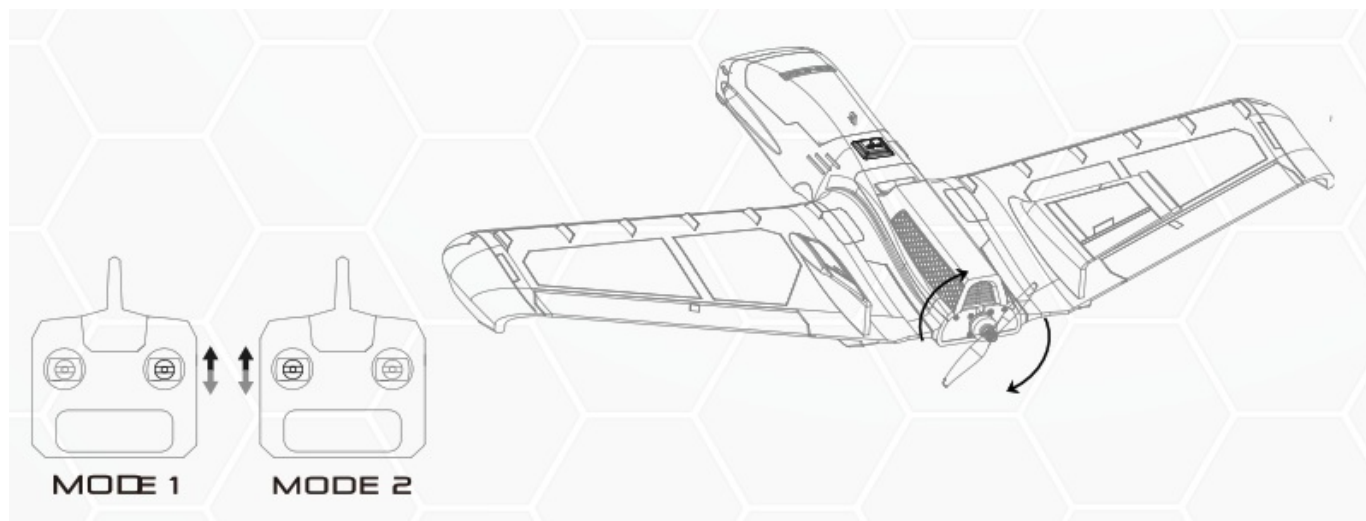

Contents [[hide](#)]

- [1 Specifications](#)
- [2 Operation instruction](#)
- [3 Documents / Resources](#)
- [4 Related Posts](#)

Specifications

Model	Con. Current (Good heat di ssipation)	Burst Current (Good heat di ssipation)	BEC	LiPo	Weight (For r eference)	Size (For refe rence)
ZOHD MKII 3 0A	40A	50A	5V/3A	2-4S	51g	65x26x15.5m m

Operation instruction

Normal start-up

1.Normal start-up

Turn on the transmitter, move the throttle stick to the bottom position.



Connect ESC with battery, wait for 2 seconds, motor emits short "BEEP-" few times, sound times is Lipo battery cells.

Wait for 1 second, It means "No Brake" when motor emit continuously 1 long and 1 short tone. It means "Brake is available" when motor emits a long tone. ESC is ready for working now.

ESC is ready for working now

2.Throttle Range calibration

Turn on the transmitter, move the throttle stick to the top position.



Connect ESC with battery. Wait for 2 seconds, after motor emits 2 short "BEEP-BEEP", the full throttle position is memorized.

Move the throttle stick to the bottom position in 3 seconds. Then waits for 1 second, the "zero throttle" position is memorized. Motor emits short "BEEP-" few times, sound times is Lipo battery cells.



Wait for 1 second, It means "No Brake" when motor emit continuously 1 long and 1 short tone. It means "Brake is available" when motor emits a long tone. ESC is ready for working now.

Programming

Turn on the transmitter, move the throttle stick to the top position.



Connect ESC with battery. Wait for 2 seconds, motor emits 2 short "BEEP-BEEP". Then still wait for 5 seconds. motor emits special tone "♪12321", it has entered programming mode.

Select Items

After entering programming mode, you will hear groups tone which emits in a loop as following sequence.

	♪12321		
1	Brake	1short	Beep-
2	Battery type	2short	Beep-Beep-
3	Cutoff voltage	3short	Beep-Beep-Beep-
4	Timing	4short	Beep-Beep-Beep-Beep-
5	Startup mode	1long	Beeeep--
6	PWM frequency	1long&1short	Beeeep--Beep
7	Voltage cutoff option	1long&2short	Beeeep--Beep-Beep
8	Battery cells	1long&3short	Beeeep--Beep-Beep--Beep
9	Restore factory default	1long&4short	Beeeep--Beep-Beep--Beep-Beep
10	Exit	2long	Beeeep--Beeeep--

Note:
Usually, 1 long tone "Beeeep--" equals to 5 short tone "beep-", for example: 1 long tone "Beeeep--" and 1 short tone "beep-" equals to 6.

When motor emits "Exit" tone, move throttle to the zero position in 3 seconds, then motor emits special tone "♪765765", it will exit the programming mode.



Item parameter

After motor emits a item tone, move the throttle to the zero throttle position, then will enters this item, and motor will emits the parameter tone in a loop. please see the table below)



Move throttle stick to the top position after a certain tone that the parameter you want, the parameter is selected, then motor emits special tone "♪1212", this parameter will be stored. Just wait If you still want select other item, it will go back to the Level 1 menu to select item, the operate method is the same.



Prompt tone	1	2	3	4	5	6	7	8
Item	1short	2short	3short	4short	1long	1long&1short	1long&2short	1long&3short
1.Brake	NO	Soft	Heavy	Very Heavy				
2.Battery type	Lipo	NiCb/NiMh						
3.Cutoff voltage	2.8V	3.0V	3.2V					
4.Timing	0°	3.75°	7.5°	11.25°	15°	18.75°	22.5°	26.25°
5.Startup mode	Normal	Soft	Very Soft					
6.PWM frequency	12KHz	8KHz						
7.Voltage cutoff option	Reduce cutoff	Cut off						
8.Battery cells	Auto	2S	3S	4S				

*Shadow parts are factory default value

If don't want select other parameter, move throttle to the zero position in 3 seconds, then motor emits special tone "♪765765", it will exit the programming mode.





[DART SL Extreme ZOHD](#) [pdf] User Guide

SL Extreme ZOHD