



Dangbei DBPADGO1 PadOnGo Smart Screen User Manual

[Home](#) » [Dangbei](#) » Dangbei DBPADGO1 PadOnGo Smart Screen User Manual 

Dangbei DBPADGO1 PadOnGo Smart
Screen User Manual

Dangbei

PadOnGo
Smart Screen

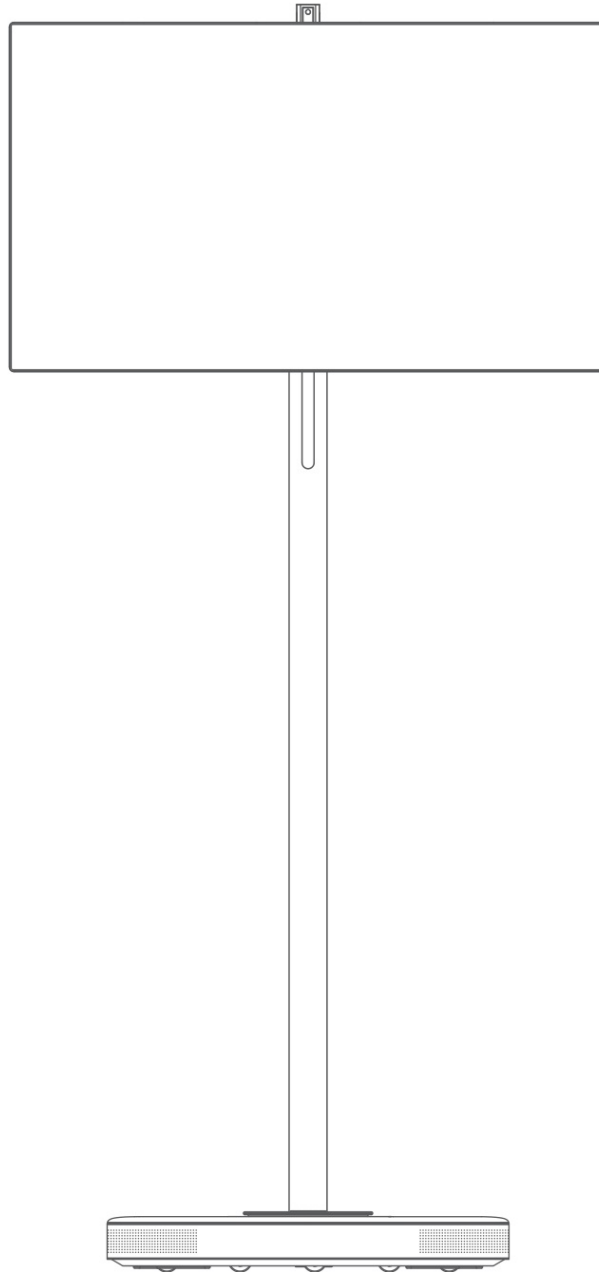

User Manual

Read before Use

Please read the product instructions carefully:

Thank you for purchasing and using these products. For your safety and interests, please read the Product Instructions carefully before using the product.

About the Product Instructions:

The trademarks and names mentioned in the Product Instructions are the property of their respective owners.

All Product Instructions shown are for illustration purposes only.

The actual product may vary due to product enhancements.

We shall not be liable for any personal injury, property damage, or other damages caused by the failure of the user to comply with the Product Instructions or precautions.

Packing List

Before using the product, please check that all items are included in the box.

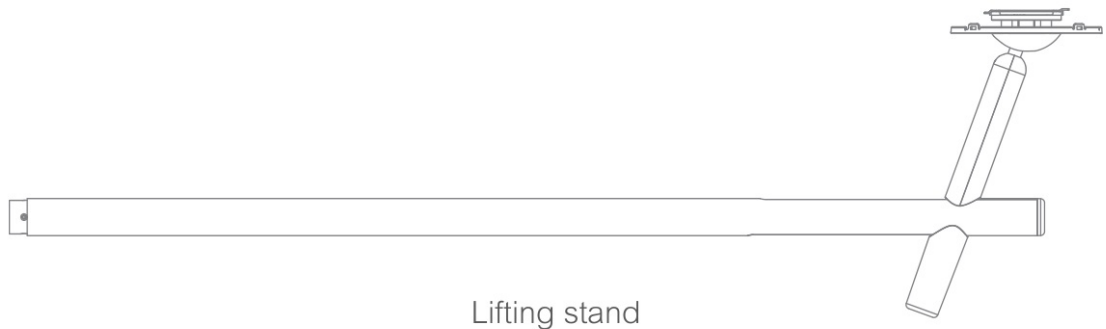

Lifting stand

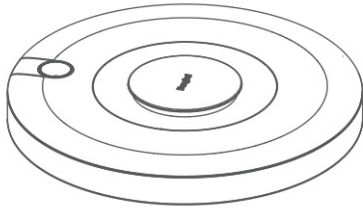

Mobile power base

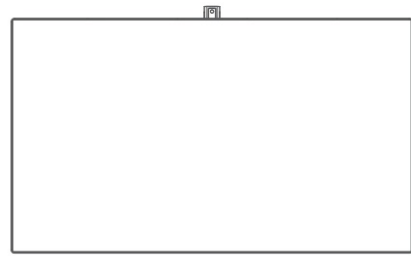

Display screen



Installation Tools



Disassembly tool

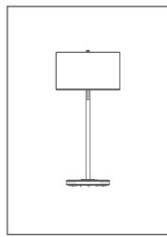

User manual

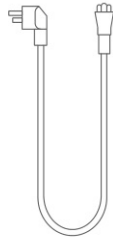

Power cord

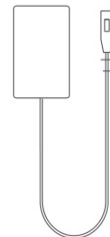

Power adapter

Installation Instructions

1) Open the packaging box and take out the first layer as a whole.
Then take out the mobile power base from the second layer.

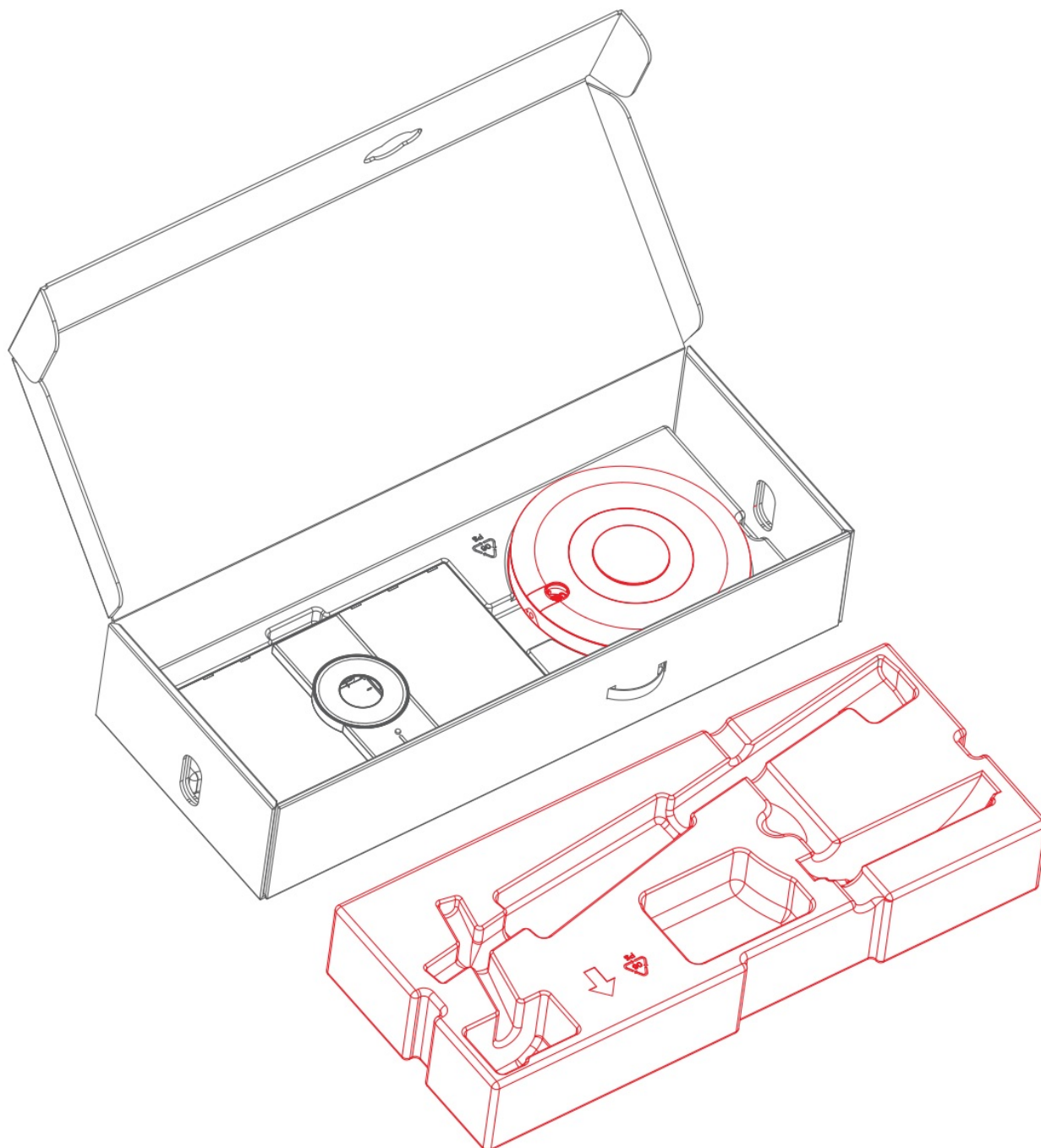

2) Place the mobile power base in the first layer as shown in the figure below, aligning the round groove on the base with the concave groove on the packaging.
Then insert the lifting stand into the mobile power base.

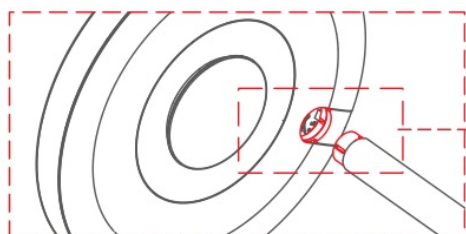
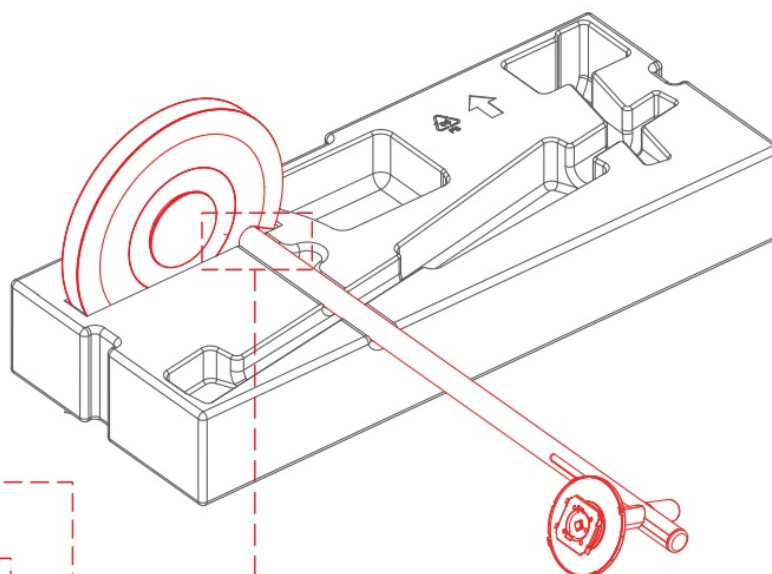
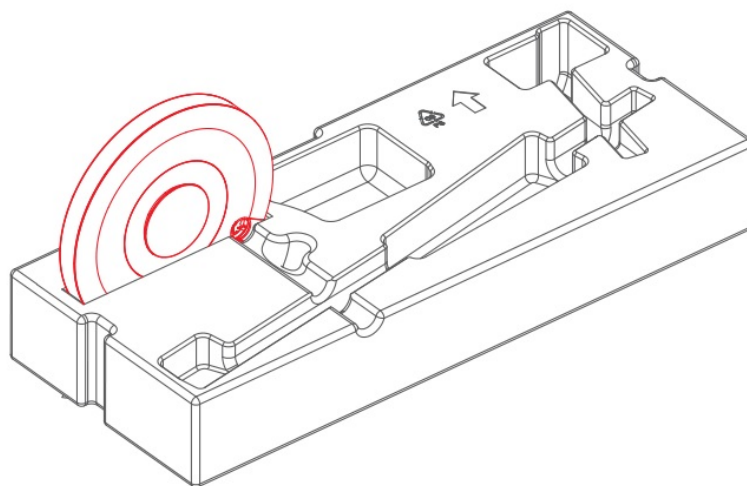

Note: Please insert the stand tightly for fixing screws in the later steps.

Align with this slot and insert

3) Find the installation tools in the package, take out the hexagonal wrench and four screws, and secure the screws.

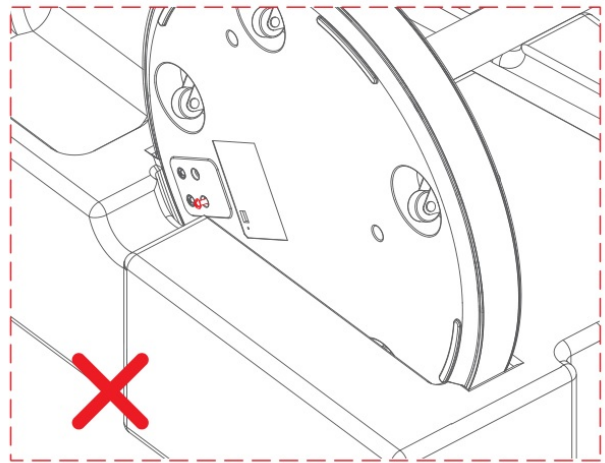
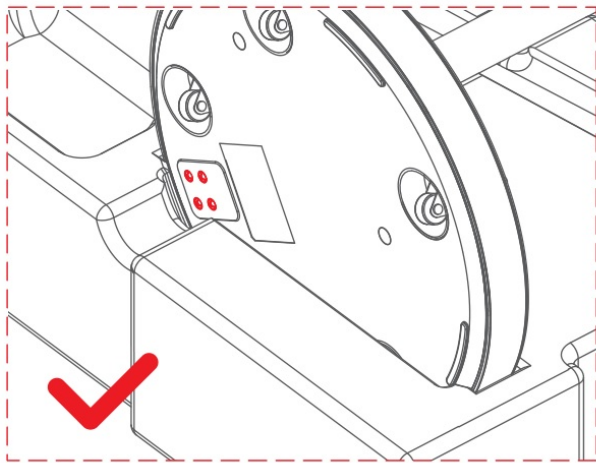
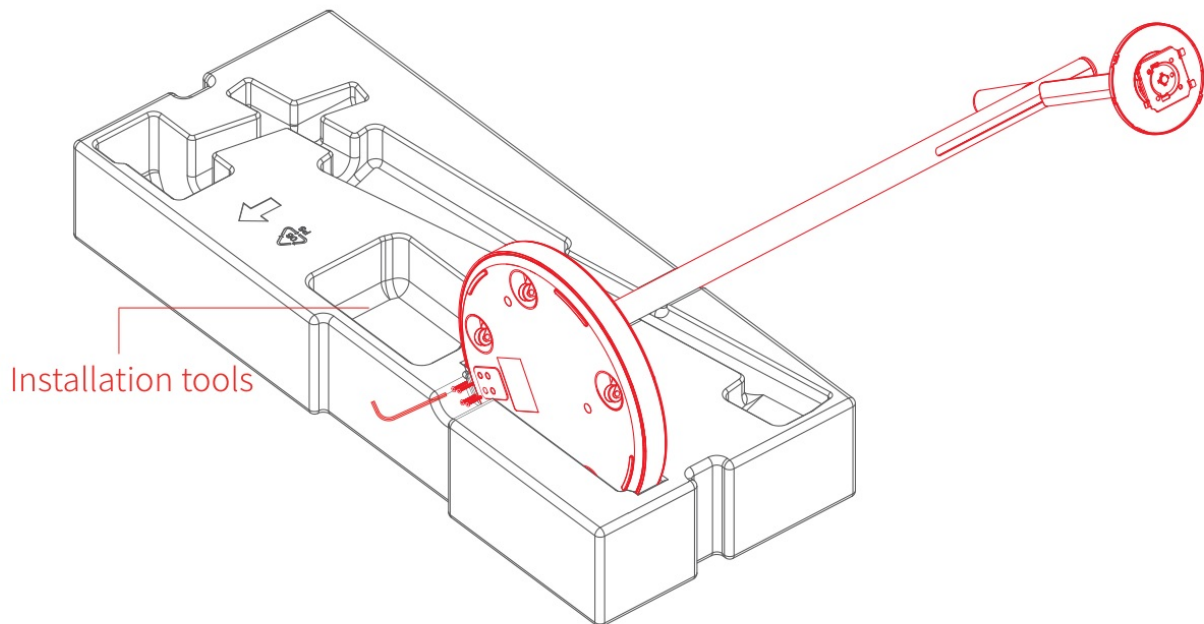

Notes:

- Make sure that the lifting stand and mobile power base are connected firmly to avoid product damage or injury.
- It is recommended to use the diagonal fixing method, first lock the two diagonal screws and then fix the other two screws, which can make it easier to complete this step.

4) Place the assembled mobile stand upright on a level ground. Take out the display screen and on the back of the screen, find the hanging grooves as indicated by the arrows below.

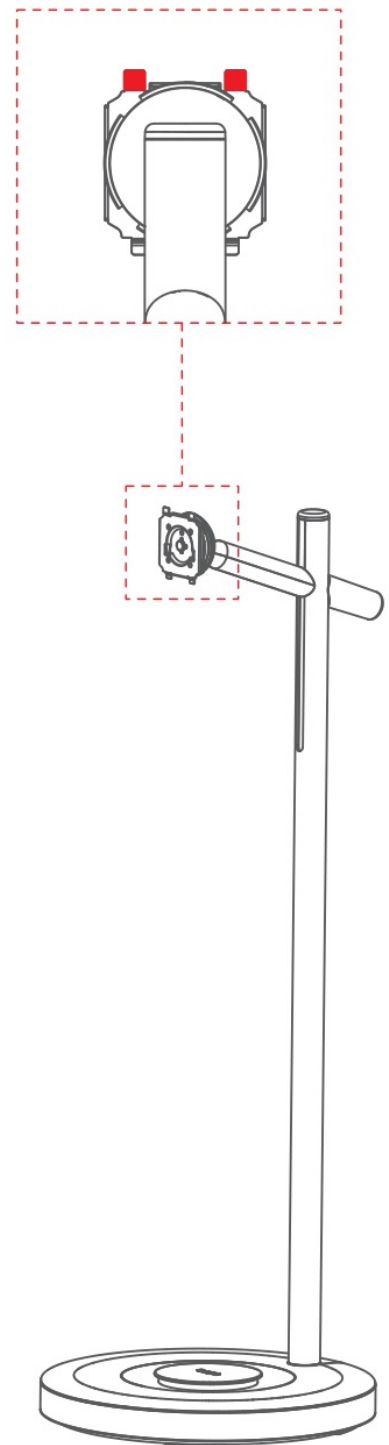
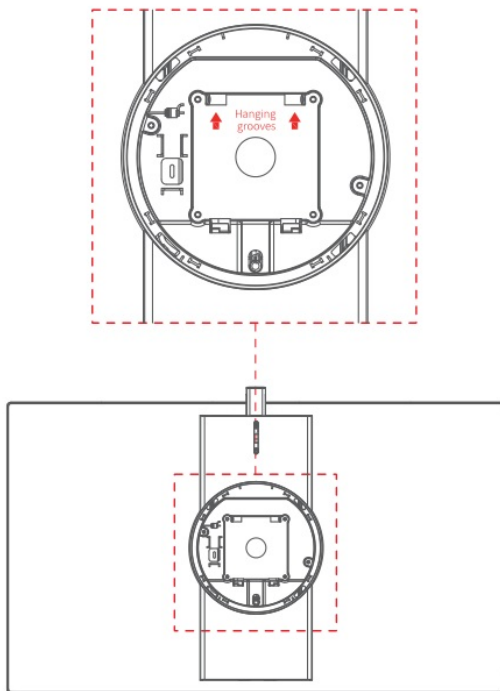

5) Hold the display screen with both hands with the back facing you, as shown in the figure. Insert the two hooks on the top of the stand into the hanging grooves. When you hear a click sound, the screen is successfully installed.

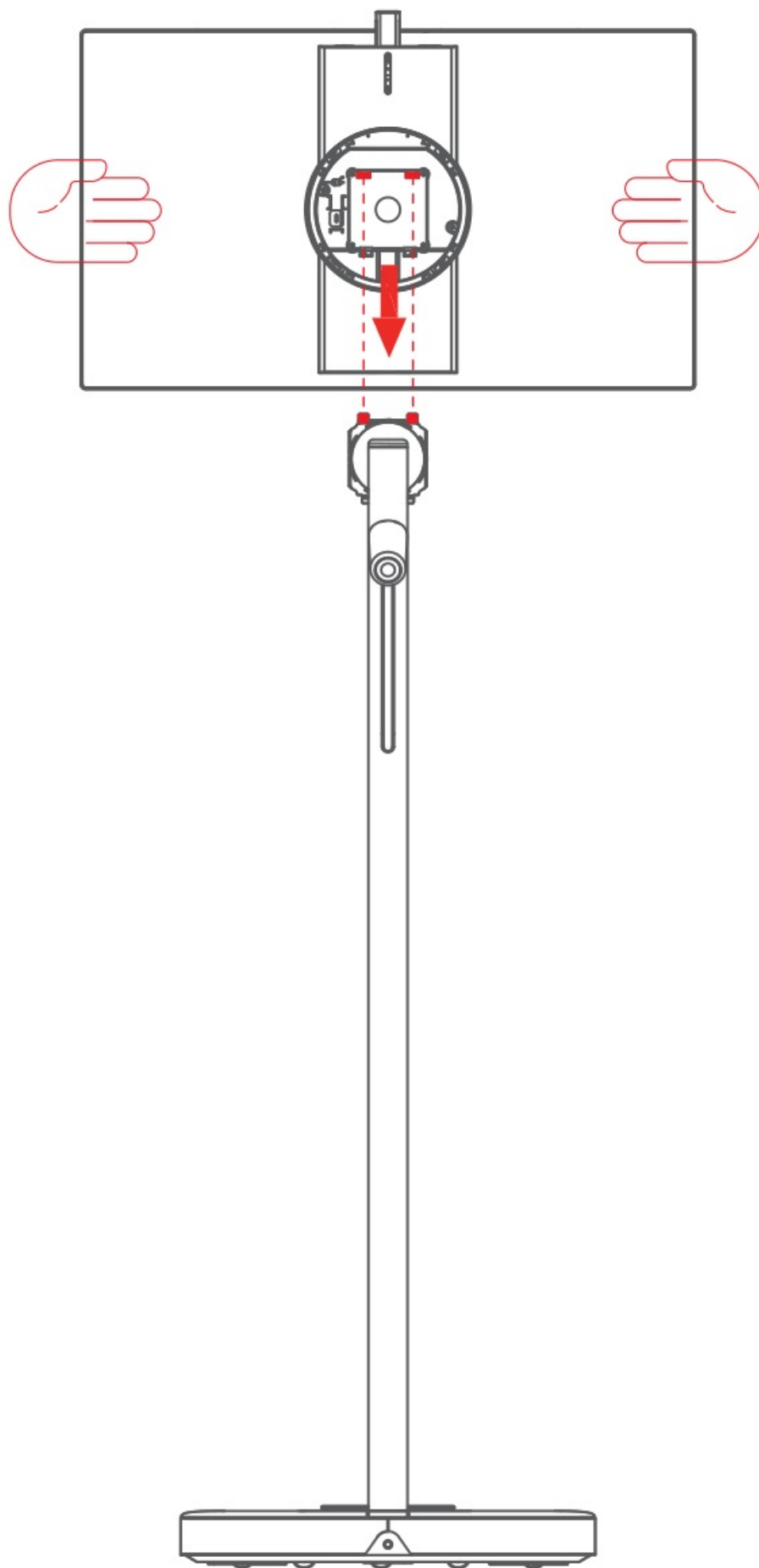

Note:

- The side with buttons and camera is the top of the screen. Do not invert it.

6) Organize the power cord on the stand counterclockwise as shown in the figure, then insert it into the power port on the back of the screen. Press and hold the power button for 3 seconds to turn on the screen and ensure a successful connection.

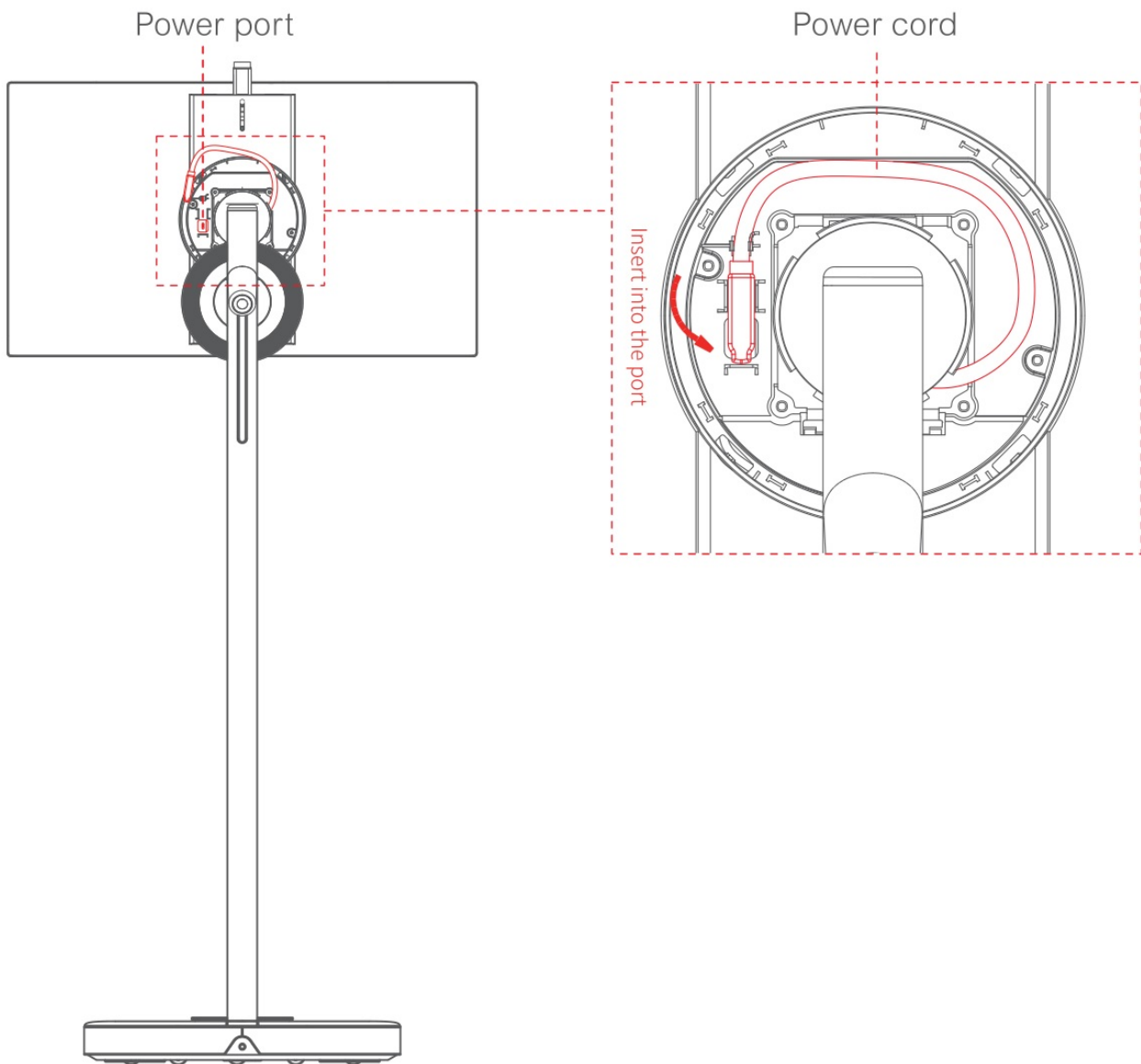

Notes:

- The power port on the screen is brand specific. Only use the provided TYPE-C power.
- Make sure that the cord is connected correctly and firmly to prevent product damage or injury.
- If the screen doesn't turn on normally, check the cable connection or try using the power adapter with the base.

7) Organize the power cord into the groove, then rotate the screen 90° counterclockwise. Align the triangular mark on the back of the screen with the red mark on the ring cover and install the cover.

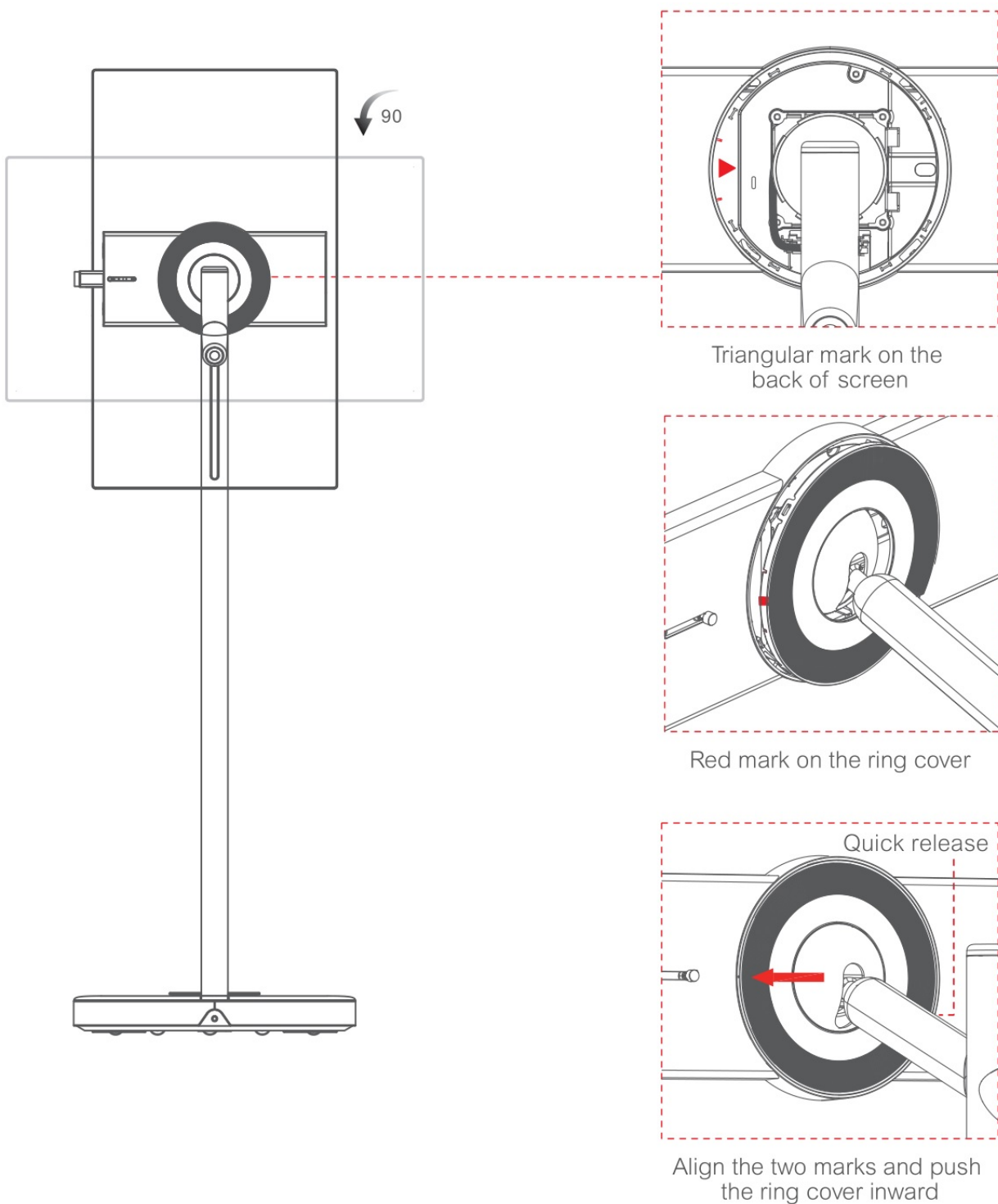

Notes:

- It is recommended to turn on the screen before installing the ring cover to ensure that the power cord has been securely plugged.
- If you need to remove the ring cover, find the quick release on the edge of the cover, then use the disassembly tool to pry it up.
- Disassembly operation has the risk of damaging the product and personal injury, please operate with caution.

Important:

- Please place and move the product in an upright position. The product may fall and cause product failure or injury.

- Be careful not to get your hands or fingers stuck in the stand or the height adjustment area.
- When moving the device, please hold the stand in the middle to avoid product damage or injury.
- If there is foreign objects on the base wheels, please use a cotton cloth to gently wipe it away.
- If the base cover is dirty, you can remove it for cleaning and then reassemble on the base after drying.

Product Overview

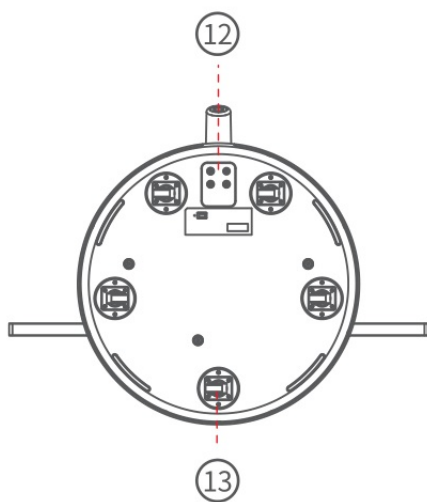
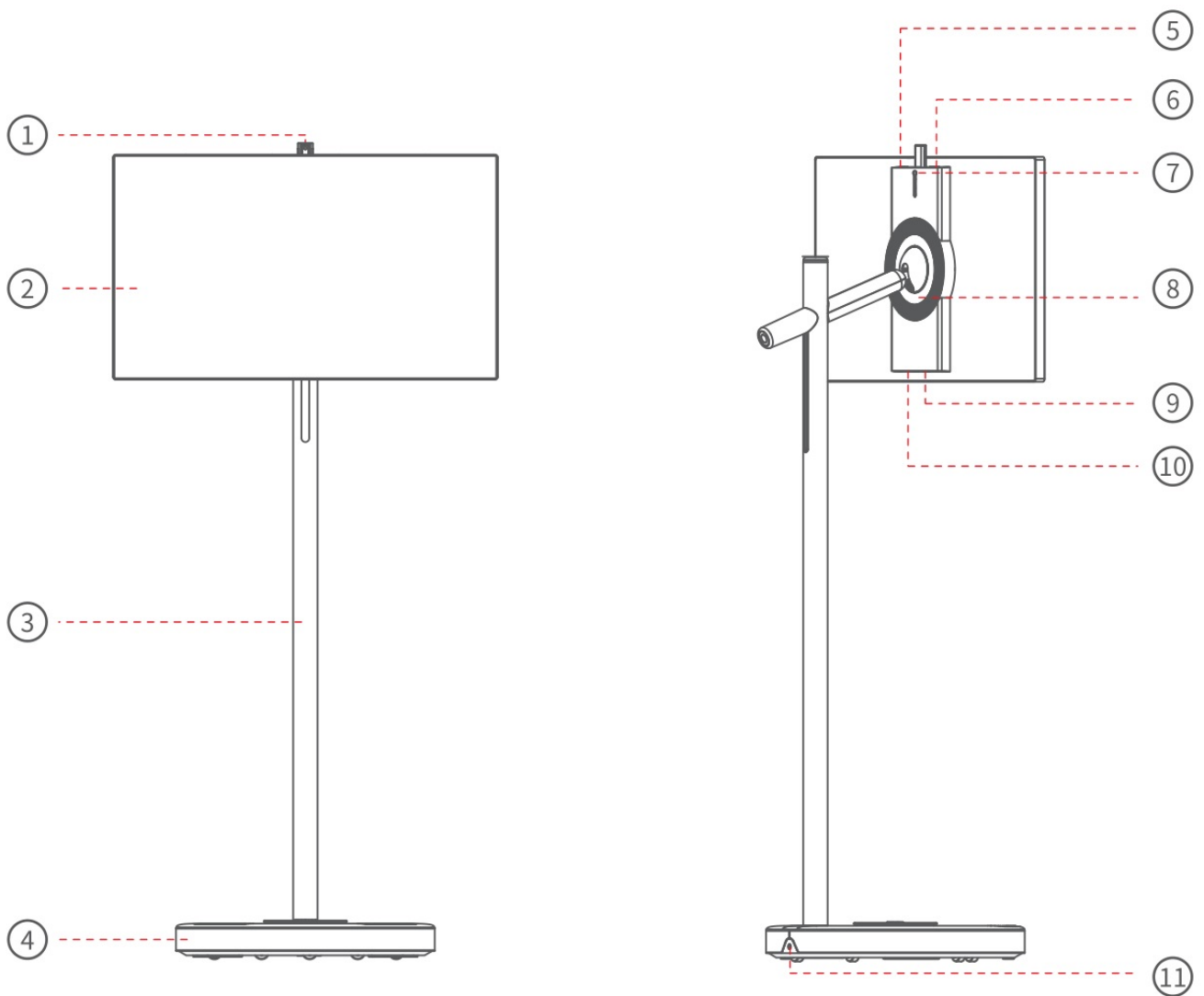

- ① Camera
- ② Display touch screen
- ③ Lifting stand
- ④ Mobile power base
- ⑤ Power on/off
- ⑥ Volume control
- ⑦ Camera toggle switch
- ⑧ Screen release lever
- ⑨ HDMI
- ⑩ USB3.0
- ⑪ DC IN
- ⑫ Lifting stand fixing screws
- ⑬ Universal wheel

Power On

- When turning on the product for the first time, connect the adaptor first so that the product turns on properly.
- Press and hold the power button for 3 seconds to turn on the device.

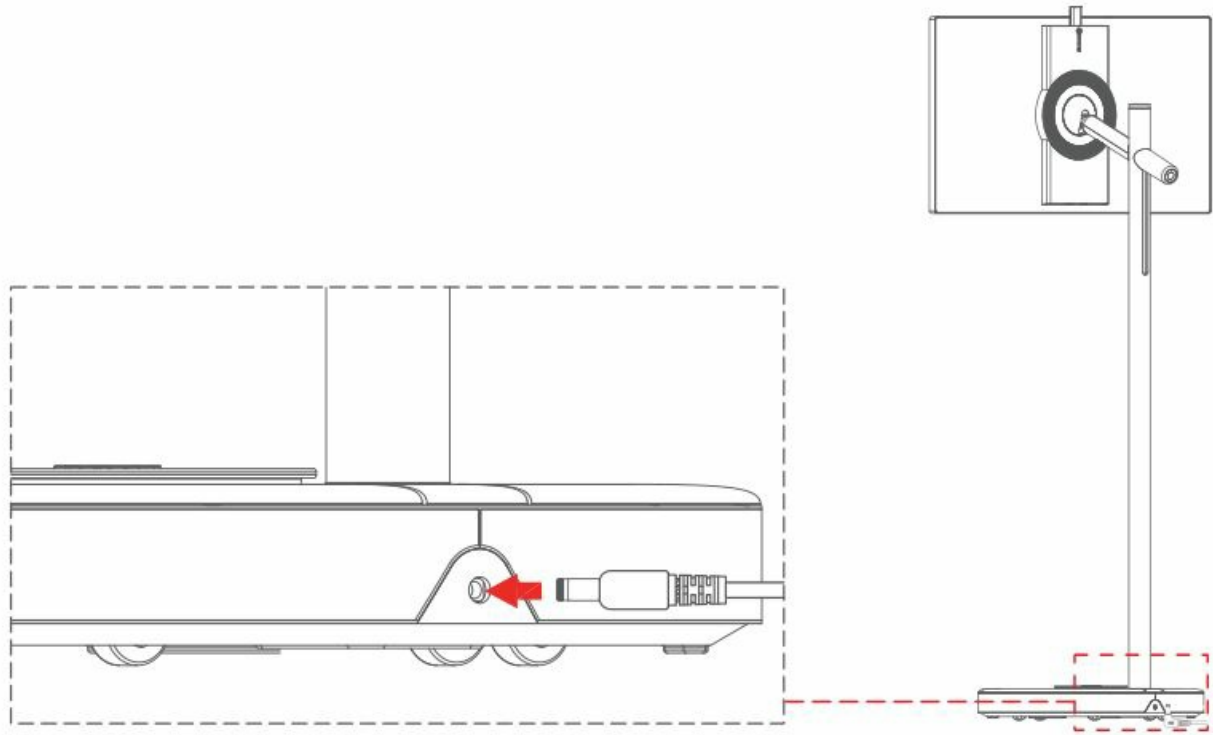

Notes:

- When connecting or disconnecting the power adapter, hold the plug and connect or disconnect it horizontally.
- Make sure it is fully inserted. Do not move it once it is connected.

Using the Button

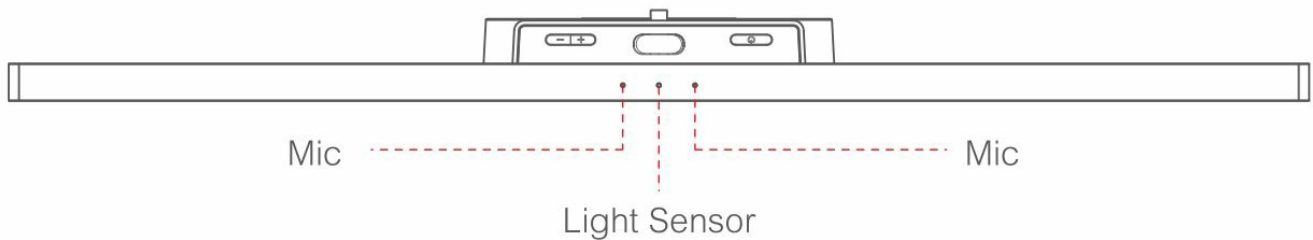

Button	Description
Power on/off	Press to turn the screen on/off. Press and hold for 3s to power the device on/off
Volume +	Press to increase volume
Volume —	Press to decrease volume

Note:

- Please do not use foreign objects to block the Mic or light sensor to avoid abnormal voice control and adaptive brightness control.

Using the Touch Screen

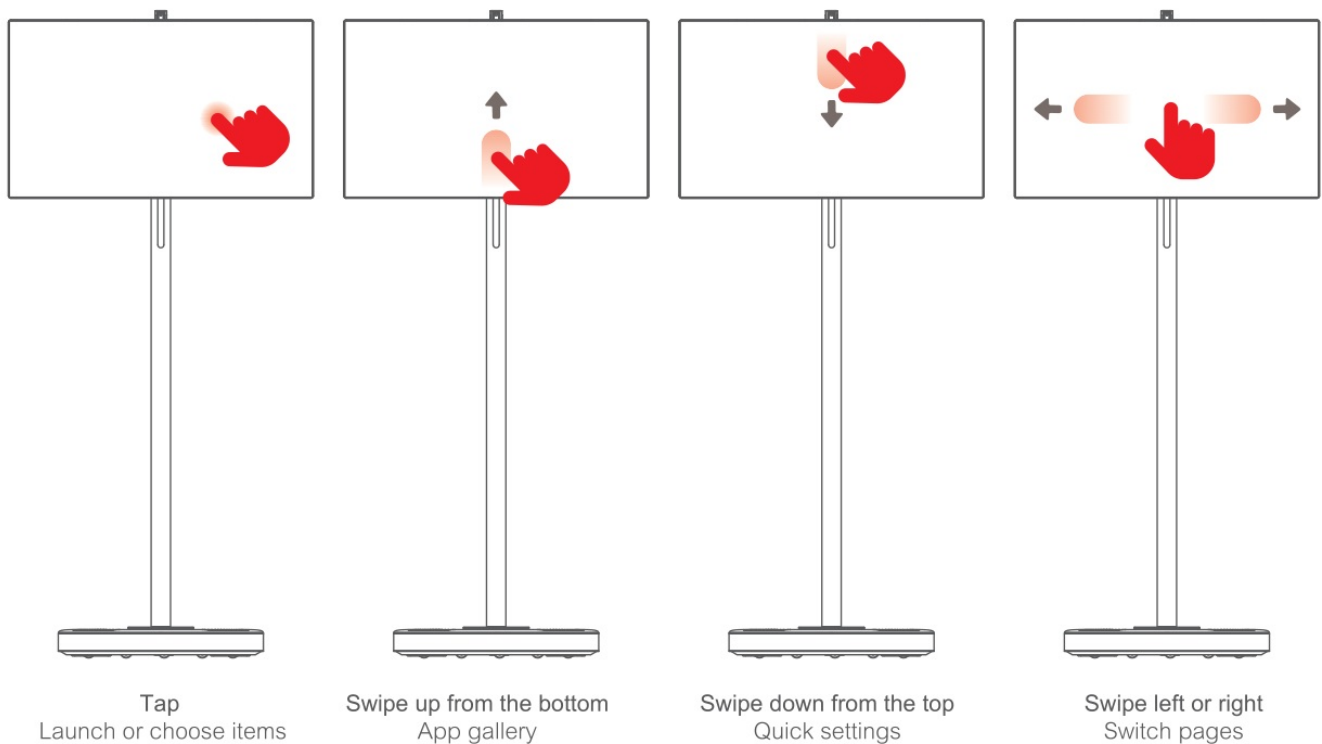

Connecting to Wi-Fi



Connecting to Wi-Fi

- Go to Settings, and select Network & internet.
- Tap Internet, select your network and enter the correct password.

Adjusting the Angle and Height

The height and angle of the display can be adjusted for comfortable viewing.

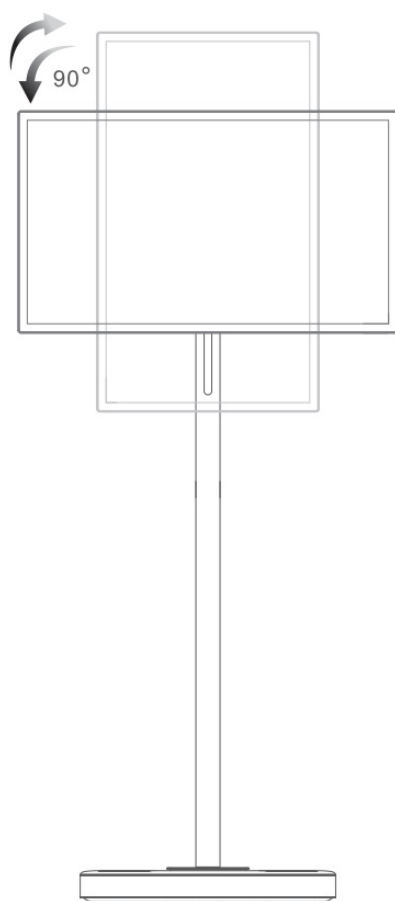

Tilt angle: $25\pm3^\circ$
Recline angle: $30\pm3^\circ$

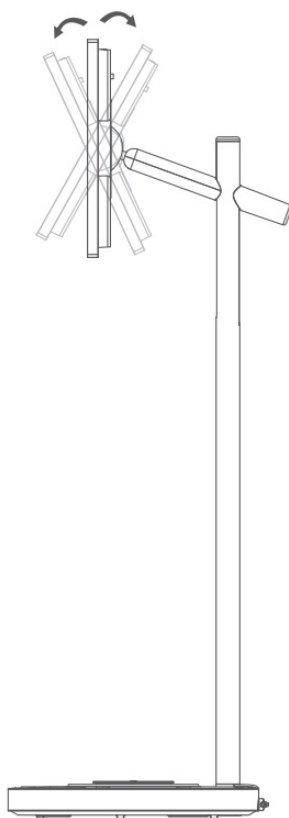

Adjustable height:
7.87 inch (20 cm)

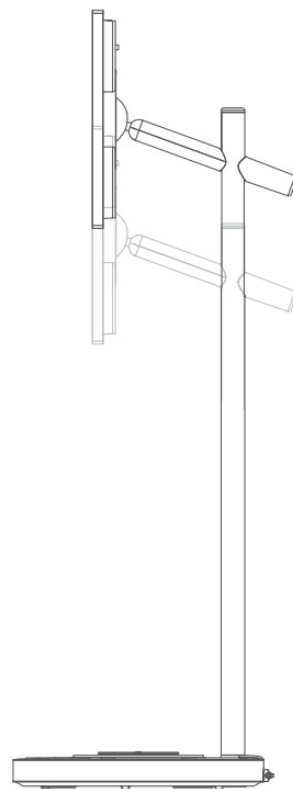

Notes:

- The display defaults to landscape mode. Some apps do not support portrait mode.
- Please adjust the screen within the specified angle and height range.
- Do not let your hands or fingers get stuck in the area where the screen is adjusted.
- Do not insert foreign objects into the gaps of the lifting stand to avoid jamming the track.

Using the Built-In Battery

This product has a battery built into the stand, which allows use of the product for a period of time without an additional power supply.

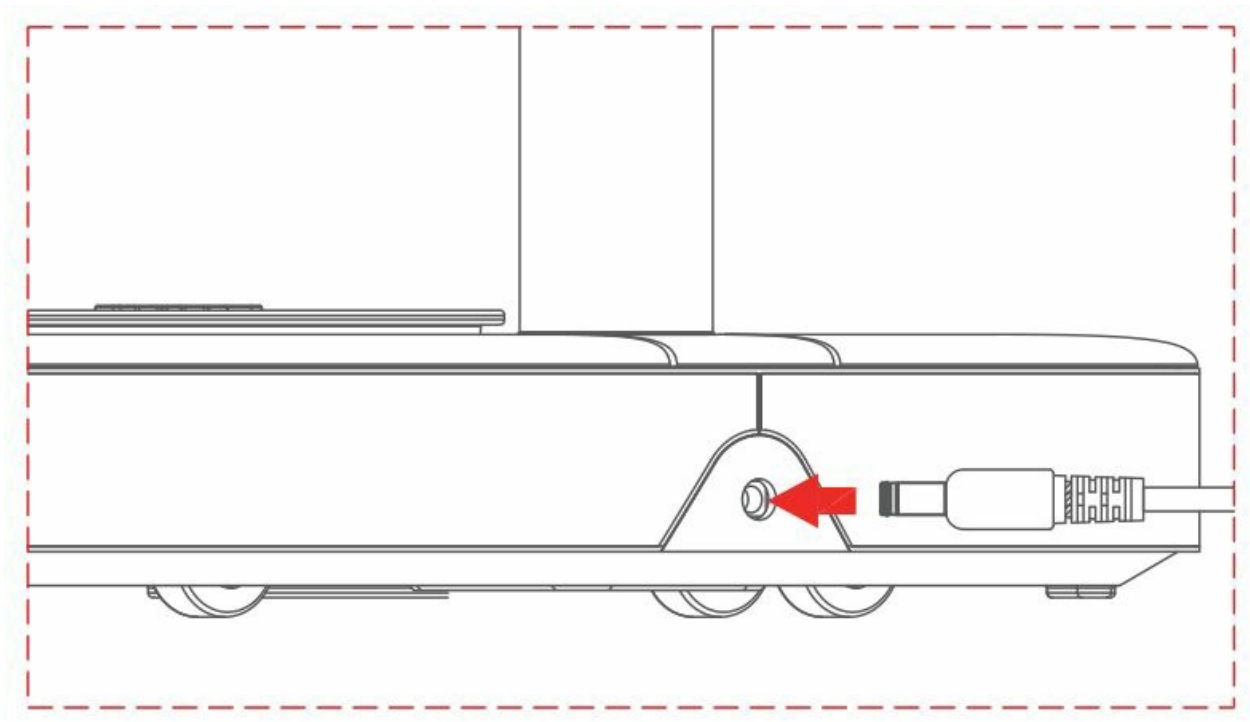

Notes:

- It takes about 6 hours to fully charge the battery.
- The battery life and usage time after charging decrease in proportion to the period and duration of use of the product.
- Battery charging may not be possible at temperatures below 0°C.
- Even when not in use, the remaining charge of the battery will naturally decrease.
- For a longer battery life, charge the battery after using it for a certain period of time instead of keeping the battery charged.
- Keeping the battery level at 50 % helps extend battery life.
- The usage time shown in this manual is based on measurements conducted by Dangbei.
The actual time may vary depending on usage.
- The usage time may vary depending on factors such as the external device connected, operating temperature, period of use, and user settings.

Warning

- There is a risk of explosion if the wrong battery model is used for replacement.
- The battery must be disassembled and replaced by professionals. Users should not disassemble or replace the battery by themselves.
- Do not disassemble, impact, squeeze, or throw the battery into fire. If it swells, do not continue to use it. Do not place it in a high temperature environment. Do not use it after it has been immersed in water.

Connections

Other devices, such as HDMI, can be connected to the product.

HDMI connection

The HDMI port at the bottom of the screen can support input from external devices.

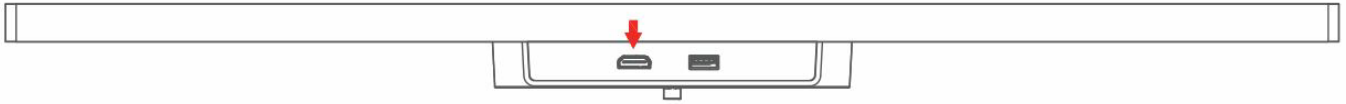

Notes:

- Use a certified cable or device with the HDMI logo attached.
If you do not use a certified HDMI cable or device, the screen may not display or a connection error may occur.
- It is recommended to use HDMI cables that support HDMI 2.0 or above.
- If you connect a gaming device to the product, use the cable supplied with the gaming device.
- If you connect a computer or laptop to the product, some displays may be abnormal, depending on the graphics card of the external device.

USB connection

The USB port of this product is a standard USB 3.0 port. It can be used to connect external devices such as U disks, mobile hard drives, keyboards and mice, etc.

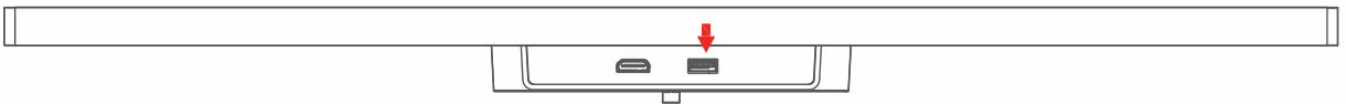

Troubleshooting

1. No display or sound

- a. Check if the product is turned on properly.
- b. Check if the adapter is properly connected to the power source.
- c. Check if the power port on the back of the screen is properly connected.
- d. Check if the four mounting screws on the power base are tightened.

2. Product suddenly turns off

- a. Check if the battery is drained.
- b. Check if the automatic shutdown function is activated on the set time.
- c. If the battery overheats, the product automatically turns off to protect itself.

3. No signal from external HDMI

- a. Restart the product and try again.
- b. Reconnect the HDMI cable.
- c. Restart the external device while the product is turned on.

4. Abnormal display

- a. This screen contains millions of pixels. You may see tiny black dots and/or brightly coloured dots at a size of 1 ppm on the screen. This does not indicate a malfunction and does not affect the performance and reliability of the product. This phenomenon also occurs in third-party products and is not subject to exchange or refund.
- b. You may find different brightness and colour of the screen depending on your viewing position. This phenomenon occurs due to the characteristic of the screen.
It is not related with the product performance, and it is not malfunction.

Safety Precautions

This product has been designed with safety in mind and has undergone rigorous testing to ensure personal safety. Incorrect installation or usage may result in hazards such as electric shock or fire. To ensure safety, prolong the product's lifespan, and guarantee optimal performance, please carefully read all usage instructions before using this product, adhere to the following safety precautions, and store the user manual properly for future reference.

- If any of the following occur, unplug the product immediately and contact your local customer service:
 1. If you smell smoke or other odors coming from the product.
 2. When the power cord or plug is damaged or worn.
 3. When the product is damaged due to falling or collision, or if any liquid or foreign object enters the product.
- When cleaning the screen, make sure to unplug the power cord, and refrain from using liquid cleaners or spray cleaners directly on the screen. Instead, use a soft damp cloth to wipe the screen. If it remains unclean, use LED screen cleaner.
- Do not use accessories not authorized by the manufacturer, as this may pose risks.
- Opening or moving the casing may expose high voltage or other dangers.
Do not attempt to repair the product yourself; contact qualified technicians for comprehensive repairs.
- In the event of the following situations, unplug the product and contact qualified technicians for repair:
 - a. When the power cord or plug is damaged or worn.
 - b. If the display screen falls or the casing is damaged.
 - c. If the display screen exhibits obvious abnormalities.
- Please store the monitor in an environment with temperatures ranging from 0°C to 40°C.
- A display may fall, causing serious personal injury or death. Many injuries, particularly to children, can be avoided by taking simple precautions such as:
 - a. Always educate children about the dangers of climbing on furniture to reach the display or its controls.
 - b. Never place a display in an unstable location.
 - c. Never place items that might tempt children to climb, such as toys and remote controls, on the top of the display or furniture on which the display is placed.
- Prolonged display of the same image or the presence of long-standing static elements such as text or icons on the screen may result in "image retention," where a faint trace remains on the screen for a significant period after shutdown. This phenomenon is not covered under warranty.
 - Healthy product usage:
 1. Ensure adequate lighting conditions when viewing the screen, as insufficient light or prolonged screen viewing may harm your eyesight.
 2. Adjust the volume to avoid excessively high levels that may damage your hearing.
- If the product will not be used for an extended period due to reasons such as extended absence, it's essential to power off the product and unplug the power cord.

Warning:

- This product should only be used with the type of power supply indicated on its nameplate. If you have any doubts about the type of power supply you are using, please consult the official customer service.
- Do not dismantle the adapter or power cord, as it may result in fire or electric shock.
- Avoid damaging the power cord:

1. Do not modify the power cord.
2. Do not place heavy objects on the power cord.
3. Keep the power cord away from heat sources.
4. When unplugging the power plug, do not pull the power cord. Please hold the power plug by hand and then unplug the power cord.

- Do not place open flames (such as lit candles) near this product, as it may cause electric shock or fire.
- Do not place containers filled with water on this product to avoid water droplets or splashes, which may cause electric shock or fire.
- Do not insert any sharp objects, metal, or liquid into the ventilation holes, or touch the signal connectors, to prevent circuit shorts and product damage, which may also pose an electric shock hazard.
- Use a soft cloth to clean the charging port. If the charging port is dirty or has foreign objects on it, the battery may not charge normally or may cause a fire.
- Do not use this product during heavy rain, especially during thunderstorms. Please unplug the power plug promptly to prevent lightning strikes.
- Do not attempt to disassemble or assemble this product by yourself, as it may cause electric shock or fire.
- Keep small accessories out of reach of children to prevent accidental swallowing.
- Ensure that minors do not play, frolic, chase, run, jump, or handle this product in any way to avoid tipping or damaging the product.
- Do not place heavy objects on top of the product.
- Do not use the product as a stepping stool.
- Do not rub, strike, twist, or squeeze the display screen with hard objects.
- When cleaning this product, unplug the power plug, use a soft cloth to wipe it. Do not use industrial chemicals, and be careful to prevent foreign objects from entering the machine.
- Incorrect cleaning methods (such as using cleaning solutions or water) may result in damage to the product's appearance, erasing printed information on the product, or even causing liquid to enter the internal components, rendering the machine unable to display.
- When moving this product, disconnect all cable connections and move it slowly to prevent it from falling.
- Do not immediately use the machine after moving it from a cold place to a warm place, as this may cause condensation inside the product and lead to malfunctions.
- Do not place this product in areas with strong electromagnetic fields, as it may be affected and damaged by electromagnetic waves.
- If the display screen is broken and the solution splashes onto the skin, rinse immediately with water for 15 minutes and consult a doctor. When manually transporting this product, grasp it by the four corners and support the bottom, avoiding applying pressure to the screen.
- This product's base contains a built-in battery, so handle it with care during use!
- If the battery leaks liquid, stop using it immediately to avoid contact with your skin and eyes. Accidental contact may cause blindness or burns. If any unusual symptoms occur where the liquid has touched the body, wash the affected area thoroughly with plenty of water and seek medical advice.
- When charging the battery, do not use any other power source or circuit outside the specified range. There is a risk of battery damage or fire.
- If the battery is completely discharged and left unused for a long time, it may become completely unable to charge or reduce its usage lifespan.
- Do not disconnect, disassemble, or short-circuit the battery. Doing so may cause electric shock, injury, or fire.
- Dispose of the battery properly. Improper disposal of the battery may lead to explosions or fires. Battery

disposal guidelines may vary depending on the country and region.

Statement



HDMI High-Definition Multimedia Interface, and the HDMI Logo are trademarks or registered trademarks of HDMI Licensing Administrator, Inc.



Excessive blue light of display products can cause eye fatigue, insomnia and other adverse reactions. This product is a low blue TÜV Rheinland certified products, by reducing the blue light component technology, can reduce eye fatigue and other adverse reactions to some extent. In order to protect your eyesight, it is still recommended avoiding watching for a long time. If you feel eye strain, it can be relieved by looking into the distance or doing eye health exercises.



There are strict restrictions on the flicker capability within the frequency range visible and invisible to the human body.



We declares that this device is in compliance with the essential requirements and other relevant provisions of Directive 2014/53/EU.



Satisfies all the technical regulations applicable to the product within the scope of UK Radio Equipment Regulations (SI 2017/1206) UK Electrical Equipment (Safety) Regulations (SI 2016/1101) and UK Electromagnetic Compatibility Regulations (SI 2016/1091).

This equipment has been tested and found to comply with the limits for a Class B digital device, pursuant to Part 15 of the FCC Rules. These limits are designed to provide reasonable protection against harmful interference in a residential installation.

This equipment generates uses and can radiate radio frequency energy and, if not installed and used in accordance with the instructions, may cause harmful interference to radio communications. However, there is no guarantee that interference will not occur in a particular installation. If this equipment does cause harmful interference to radio or television reception, which can be determined by turning the equipment off and on, the user is encouraged to try to correct the interference by one or more of the following measures:

- Reorient or relocate the receiving antenna.
- Increase the separation between the equipment and receiver.
- Connect the equipment to an outlet on a circuit different from that to which the receiver is connected.
- Consult the dealer or an experienced radio/TV technician for help.

Changes or modifications not expressly approved by the party responsible for compliance could void the user's authority to operate the equipment.

Statement

This device operating frequency:

2402-2480MHz(EIRP 20dBm),2412-2472MHz(EIRP 20dBm),5150~5250MHz(EIRP 23dBm),
5250~5350MHz(EIRP 20dBm),5470~5725MHz(EIRP 27dBm),5725~5850MHz(EIRP 13.98dBm).

THIS DEVICE COMPLIES WITH DHHS RULES 21 CFR CHAPTER I SUBCHAPTER J. CAN ICES-3 (B)/NMB-3 (B)

This Class B digital apparatus complies with Canadian ICES-003.

This device contains licence-exempt transmitter(s)/receiver(s) that comply with Innovation, Science and Economic Development Canada's licence-exempt RSS(s).
Operation is subject to the following two conditions:

1. This device may not cause interference.
2. This device must accept any interference, including interference that may cause. undesired operation of the device

For projectors only

The distance between user and products should be no less than 20cm.

5150-5350MHz band is restricted to indoor use only.



WARNING: This product can expose you to Lead, which is known to the State of California to cause cancer and birth defects or other reproductive harm. For more information go to www.P65Warnings.ca.gov.

EU DECLARATION OF CONFORMITY



Product : Smart screen machine

Trademark : Dangbei

Model Designation : DBPADGO1

Manufacturer's Name : Shenzhen Dangs Science and Technology Co., Ltd.

Manufacturer's Address : 901, GDC Building, Gaoxin Mid 3rd Road,
Maling Community, Yuehai Sub-district, Nanshan District, Shenzhen, China.

Manufacturer's Phone : 86-755-26907499

We, Shenzhen Dangs Science and Technology Co., Ltd. declare under our sole responsibility that the above referenced product is in conformity with the applicable requirements of the following directives:

RED Directive: 2014/53/EU

RoHS Directive: 2011/65/EU (EU) 2015/863

WEEE Directive: 2012/19/EU

REACH Regulation: 2006/1907/EC

Conformity with these directives has been assessed for the product by demonstrating compliance to the following harmonized standards and/or regulations:

EN 62311:2008
EN IEC 62368-1:2020+A11:2020
EN 301489-1 V2.2.3 (2019-11)
EN 301489-3 V2.3.2 (2023-01)
EN 301489-17 V3.2.4 (2020-09)
EN 55032:2015+A11:2020
EN 55035:2017+A11:2020
EN 61000-3-2:2019+A1:2021
EN 61000-3-3:2013+A2:2021
EN 301893 V2.1.1 (2017-05)
EN 300440 V2.1.1 (2017-03)
EN 300328 V2.2.2 (2019-07)
2011/65/EU (EU) 2015/863
2006/1907/EC
2012/19/EU

Signed for and on behalf of: Shenzhen Dangs Science and Technology Co., Ltd.
Place : Shenzhen, China
Name: Libing Zhang

Signature: 

Date: 2024-02-07

Position: Certification Engineer

UKCA DECLARATION OF CONFORMITY



Product : Smart screen machine
Trademark : Dangbei
Model Designation : DBPADGO1
Manufacturer's Name : Shenzhen Dangs Science and Technology Co., Ltd.
Manufacturer's Address : 901, GDC Building, Gaoxin Mid 3rd Road,
Maling Community, Yuehai Sub-district, Nanshan District, Shenzhen, China.
Manufacturer's Phone : 86-755-26907499

We, Shenzhen Dangs Science and Technology Co., Ltd. declare under our sole responsibility that the above referenced product is in conformity with the applicable requirements of the following directives:

RoHS Directive: SI 2022 No.622
REACH Directive: SI 2019 No.758
RED Directive: SI 2017 No. 1206
PSTI Directive: SI 2023 No.1007

Conformity with these directives has been assessed for the product by demonstrating compliance to the following harmonized standards and/or regulations:

BS EN IEC 62311:2008
BS EN IEC 62368-1:2020+A11:2020
ETSI EN 301489-1 V2.2.3 (2019-11)
ETSI EN 301489-3 V2.3.2 (2023-01)
ETSI EN 301489-17 V3.2.4 (2020-09)
BS EN 55032:2015+A11:2020
BS EN 55035:2017+A11:2020
BS EN 61000-3-2:2019+A1:2021
BS EN 61000-3-3:2013+A2:2021
ETSI EN 301893 V2.1.1 (2017-05)
ETSI EN 300440 V2.1.1 (2017-03)
ETSI EN 300328 V2.2.2 (2019-07)
SI 2022 No.622
SI 2019 No.758 and its amendment(UK REACH)
EISI EN 303 645 V2.1.1(2020-06)
ISO/IEC 29147:2018

Signed for and on behalf of: Shenzhen Dangs Science and Technology Co., Ltd.
Place: Shenzhen, China
Name: Libing Zhang

Signature:
Date: 2024-02-07
Position: Certification Engineer

Contents
1 Documents / Resources
1.1 References

Documents / Resources

	Dangbei DBPADGO1 PadOnGo Smart Screen [pdf] User Manual DBPADGO1, DBPADGO1 PadOnGo Smart Screen, PadOnGo Smart Screen, Smart Screen, S creen
---	--

References

- [P65Warnings.ca.gov](#)
- [TÜV Rheinland - Home | US | TÜV Rheinland](#)
- [User Manual](#)