



Danfoss VHX-MONO Valve Set For Floor Connection User Guide

[Home](#) » [Danfoss](#) » Danfoss VHX-MONO Valve Set For Floor Connection User Guide 



Mounting guide Danfoss VHX-MONO valve set for floor connection

Contents

- [1 VHX-MONO Valve Set For Floor Connection](#)
- [2 Documents / Resources](#)
 - [2.1 References](#)

VHX-MONO Valve Set For Floor Connection

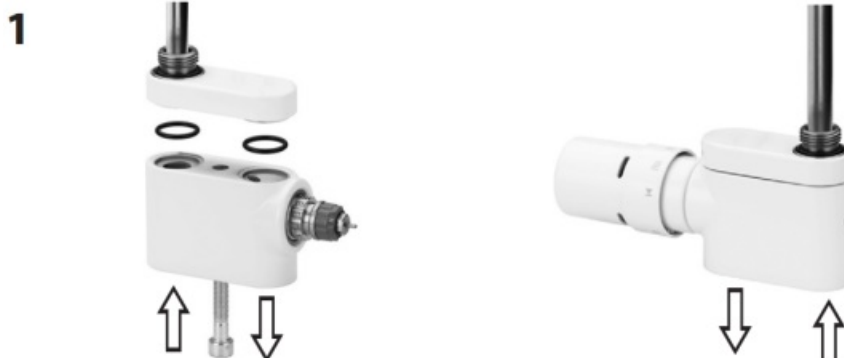

Free connection (left or right) – return always on thermostat side.

2

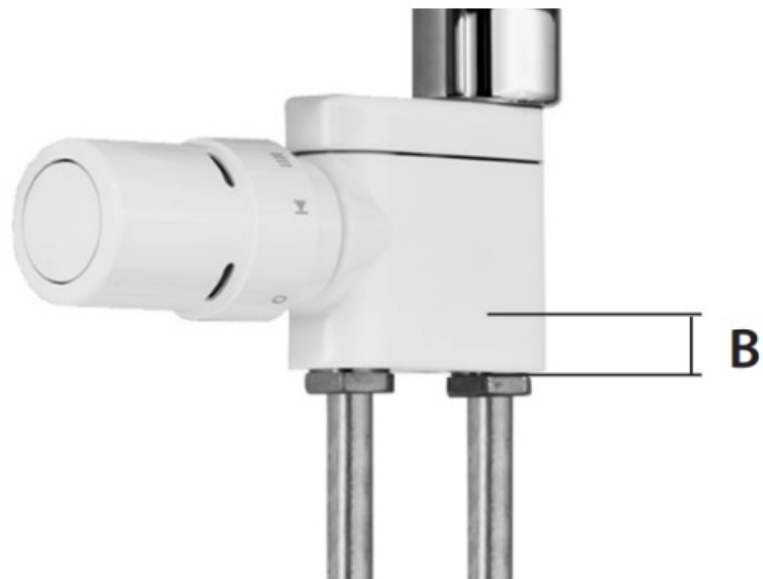



Be aware of measurement B when cutting pipes.

4

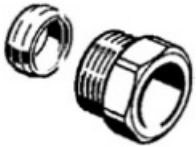
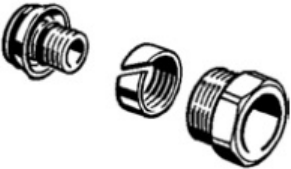

Connect valve housing on pipes.

	Dimension	Danfoss code	B (mm)
Fittings for soft steel and copper tubes 	8	013G4108	18
	10	013G4110	18
	12	013G4112	18
	14	013G4114	18
	15	013G4115	24
	16	013G4116	24
Fittings for VPE PEX tubes 	12 x 1.1	013G4143	16
	12 x 2	013G4142	16
	14 x 2	013G4144	16
	15 x 2.5	013G4147	16
	16 x 2	013G4146	16
Fittings for AluPEX tubes 	12 x 2	013G4172	16
	14 x 2	013G4174	16
	16 x 2	013G4176	16

5



Fix valve flange to radiator connections.

6



Lower the radiator until the flange is supported by the valve.

7



Mark position and mount radiator on wall.

8



Tighten valve to radiator. NB! Remember gaskets.

Presetting and k -values for $X_p = 0.5 - 2K$

Valve setting	1	2	3	4	5	6	7	N
kv-value (m ³ /h)	0.12	0.15	0.20	0.25	0.30	0.36	0.38	0.40

Preset kv on valve and connect thermostat, if not already done.

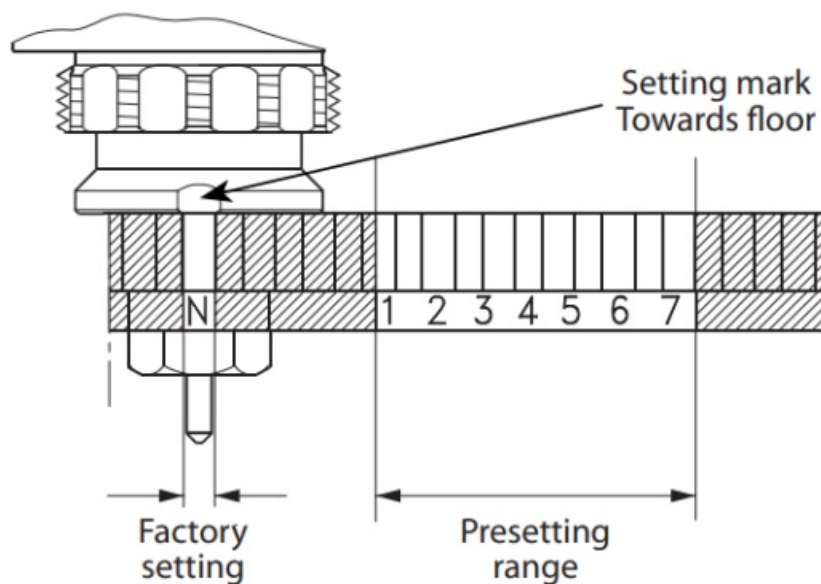

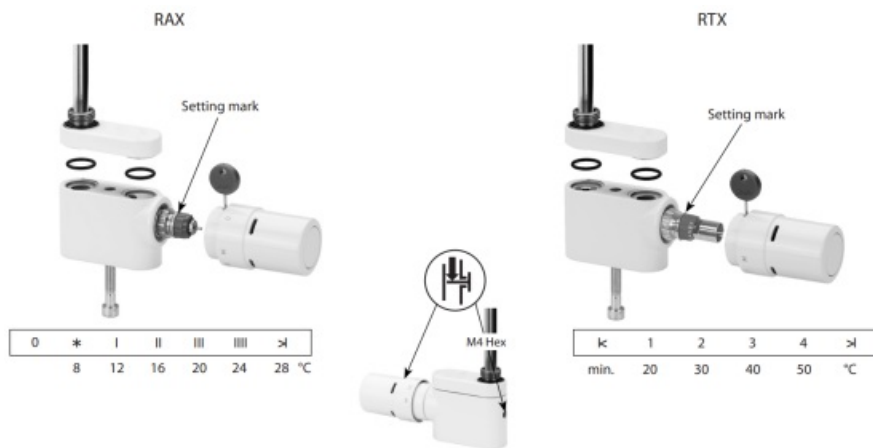

013R9432 VIUYJ302 © Danfoss 07/2007

Documents / Resources

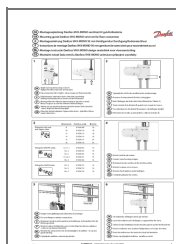

[Danfoss VHX-MONO Valve Set For Floor Connection](#) [pdf] User Guide

013G4108, 013G4110, 013G4112, 013G4114, 013G4115, 013G4116, 013G4142, 013G4143, 013G4144, 013G4146, 013G4147, 013G4172, 013G4174, 013G4176, VHX-MONO Valve Set For Floor Connection, VHX-MONO, Valve Set For Floor Connection, For Floor Connection, Floor Connection

References

- [User Manual](#)

[Manuals+](#), [Privacy Policy](#)

This website is an independent publication and is neither affiliated with nor endorsed by any of the trademark owners. The "Bluetooth®" word mark and logos are registered trademarks owned by Bluetooth SIG, Inc. The "Wi-Fi®" word mark and logos are registered trademarks owned by the Wi-Fi Alliance. Any use of these marks on this website does not imply any affiliation with or endorsement.