



Danfoss Vane Type Single Pumps User Manual

[Home](#) » [Danfoss](#) » Danfoss Vane Type Single Pumps User Manual 

Contents

- [1 Danfoss® Vane Type Single Pumps User Manual](#)
 - [1.1 Service Data](#)
 - [1.2 Model Code](#)
- [2 Documents / Resources](#)
 - [2.1 References](#)
- [3 Related Posts](#)

Danfoss® Vane Type Single Pumps User Manual

ENGINEERING
TOMORROW



Vane Type Single Pump
25V(M)--A(M)(F)-**-22-***

AX432877718852en-000101

Service Data

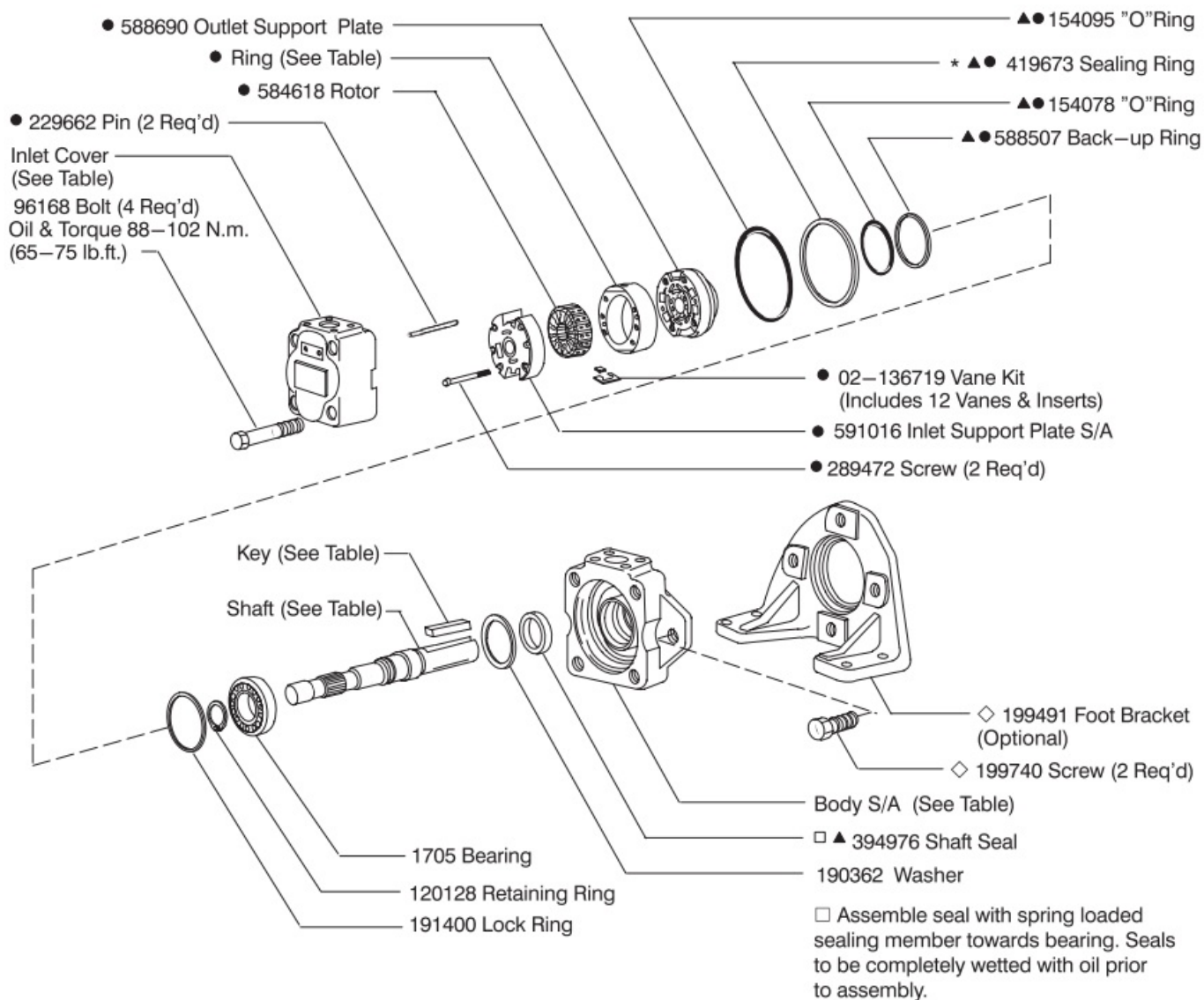

SHAFT	TYPE	KEY
238755	(1) keyed	9955
238929	(11) splined	—
860076	(192N) keyed	472270

MODEL	INLET COVER	BODY S/A
25V**A/C	224309	—
25V**B/D	242215	—
25V**A/D	—	942353
25V**B/C	—	942378
25VM**A	224309	02–136917
25VM**AM	478502	02–136918

MODEL	RING	● CART KIT	F3 CART KIT
25V12	584610	02–102532	02–102540
25V14	584612	02–102533	02–102541
25V17	584614	02–102534	02–102542
25V21	584616	02–102535	02–102543

● Included in cartridge kit

▲ Included in seal kit 922850
F3 equivalent seal kit 919656

◇ Included in foot bracket kit FB-B-10

* Install 419673 sealing ring into body, then install cartridge kit.

Model Code

(F3) - 25V (M) - ** A (M) (F) - * * - 22 - *



1 Special seals

2 Series designation

25V – 40 to 67 cm³/r
(2.47 to 4.13 in³/r)

3 Pilot designation

M – Metric per ISO 3019/2 100A2HW
Omit – Standard pilot

4 Geometric displacement

(Rated capacity (USgpm) at
1200 rpm, 6.9 bar (100 psi))

Code	cm ³ /r	in ³ /r
12	40	2.47
14	45	2.78
17	55	3.39
21	67	4.13

5 Port connections

A – SAE 4 bolt flange

6 Port connection modifier

M – Metric port connection
(4 bolt flange)
Omit – Inch thread port connection
(4 bolt flange)

7 Mounting

F – Foot mounting
Omit – Flange mounting

8 Shaft

1 – Straight keyed
11 – Splined
192N – Straight keyed (M pilot only)

9 Outlet positions

(Viewed from cover end of pump)

A – Opposite inlet port
B – 90° CCW from inlet
C – Inline with inlet
D – 90° CW from inlet

10 Design

11 Rotation

(Viewed from shaft end of pump)

L – Left hand for counterclockwise
R – Right hand for clockwise

NOTE:

To reverse cartridge kit rotation, remove the two screws and reverse the location of the inlet support plate and outlet support plate. Re-install the two screws hand tight. Use pump cover to align all sections of the cartridge. Carefully remove the cover and tighten the screws.

NOTE:

For satisfactory service life of these components in industrial applications, use full flow filtration to provide fluid which meets ISO cleanliness code 16/13 or cleaner. OFP, OFR, and OFRS series filters are recommended.

NOTE:

When ordering spare cartridge parts, it is recommended they be obtained in cartridge kits. Kits are assembled and tested by Danfoss for either right or left hand rotation. If left hand rotation is required, it should be specified on parts order by adding suffix "L" to cartridge kit number.

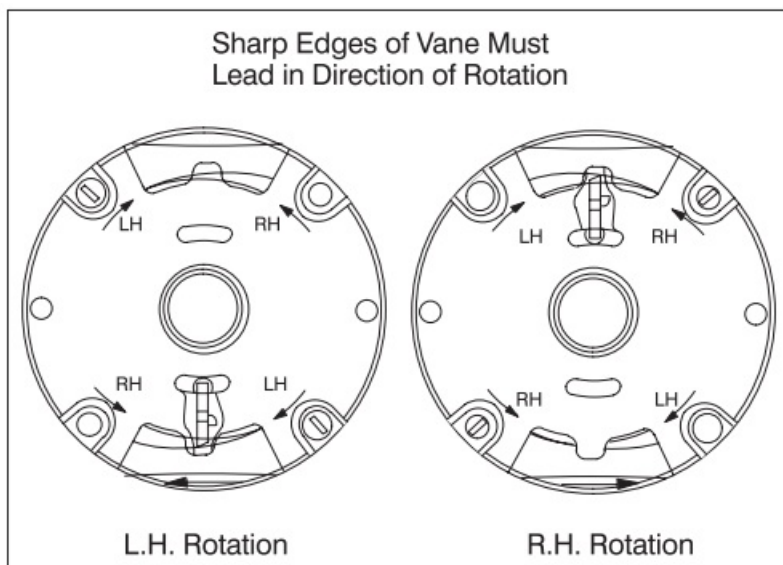

Products we offer:

- Cartridge valves
- DCV directional control valves
- Electric converters
- Electric machines
- Electric motors
- Gear motors
- Gear pumps
- Hydraulic integrated circuits (HICs)
- Hydrostatic motors
- Hydrostatic pumps
- Orbital motors
- PLUS+1® controllers
- PLUS+1® displays
- PLUS+1® joysticks and pedals
- PLUS+1® operator interfaces
- PLUS+1® sensors
- PLUS+1® software
- PLUS+1® software services, support and training
- Position controls and sensors
- PVG proportional valves
- Steering components and systems
- Telematics

Danfoss Power Solutions is a global manufacturer and supplier of high-quality hydraulic and electric components. We specialize in providing state-of-the-art technology and solutions that excel in the harsh operating conditions of the mobile off-highway market as well as the marine sector. Building on our extensive applications expertise, we work closely with you to ensure exceptional performance for a broad range of applications. We help you and other customers around the world speed up system development, reduce costs and bring vehicles and vessels to market faster.

Danfoss Power Solutions – your strongest partner in mobile hydraulics and mobile electrification.

Go to www.danfoss.com for further product information.

We offer you expert worldwide support for ensuring the best possible solutions for outstanding performance. And with an extensive network of Global Service Partners, we also provide you with comprehensive global service for all of our components.

Local address:

Danfoss
Power Solutions (US) Company
2800 East 13th Street
Ames, IA 50010, USA
Phone: +1 515 239 6000

Danfoss
Power Solutions GmbH & Co. OHG
Krokamp 35
D-24539 Neumünster, Germany
Phone: +49 4321 871 0

Danfoss
Power Solutions ApS
Nordborgvej 81
DK-6430 Nordborg, Denmark
Phone: +45 7488 2222

Danfoss
Power Solutions Trading
(Shanghai) Co., Ltd.
Building #22, No. 1000
Jin Hai Rd Jin Qiao, Pudong New District
Shanghai, China 201206
Phone: +86 21 2080 6201



Danfoss can accept no responsibility for possible errors in catalogues, brochures and other printed material. Danfoss reserves the right to alter its products without notice. This also applies to products already on order provided that such alterations can be made without subsequent changes being necessary in specifications already agreed.

All trademarks in this material are property of the respective companies. Danfoss and the Danfoss logotype are trademarks of Danfoss A/S. All rights reserved.

Documents / Resources

	<p>Danfoss Vane Type Single Pumps [pdf] User Manual Vane Type Single Pumps, Vane Type Pumps, Single Pumps, Pumps, AX432877718852en-000101</p>
---	---

References

-  [Daikin Sauer Danfoss - Home](#)
-  [Danfoss - Engineering Tomorrow | Danfoss](#)
-  [Hydro-Gear Drivetrain Solutions | Home](#)

Manuals+.