

**Danfoss**

**Type T 2  
Thermostatic  
Expansion Valve**



# Danfoss Type T 2 Thermostatic Expansion Valve Installation Guide

[Home](#) » [Danfoss](#) » Danfoss Type T 2 Thermostatic Expansion Valve Installation Guide 

## Contents

- [1 Danfoss Type T 2 Thermostatic Expansion Valve](#)
- [2 Product Information](#)
- [3 Product Usage Instructions](#)
- [4 Features and Benefits](#)
- [5 Installation](#)
- [6 Temperature ranges](#)
- [7 Documents / Resources](#)
  - [7.1 References](#)

**Danfoss**

**Danfoss Type T 2 Thermostatic Expansion Valve**

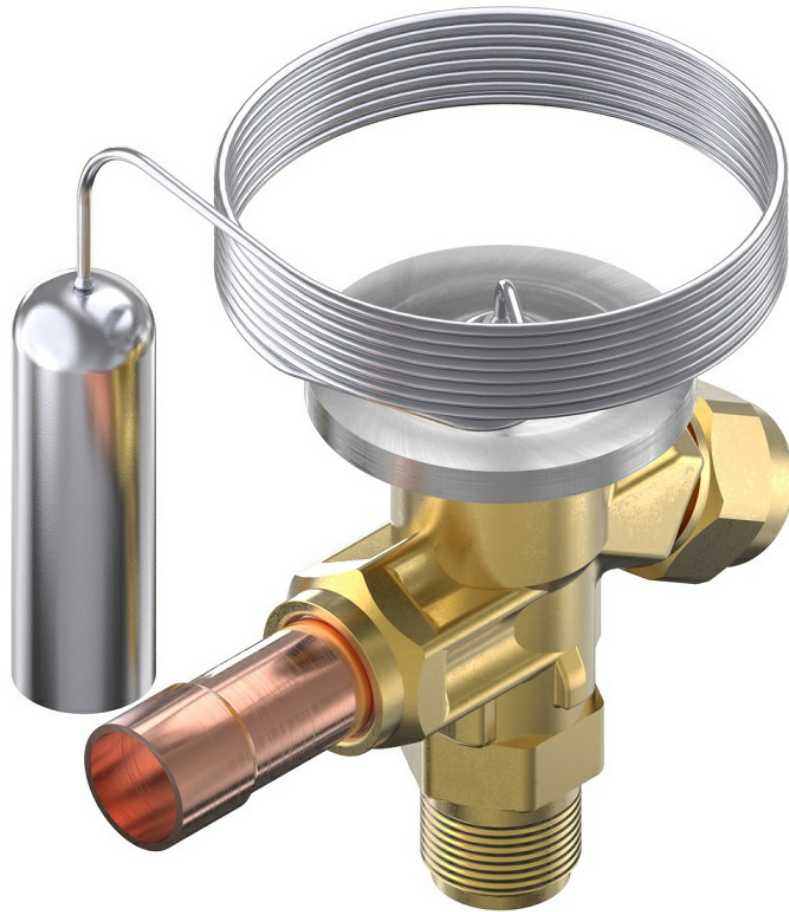

## Product Information

### Specifications:

- **Part Number:** 068R9536
- **Product Type:** Thermostatic Expansion Valve
- **Type:** T 2/TE 2
- **Refrigerant:** Refer to product label for specific refrigerant
- **Max. Working Pressure:** 34 bar/500 psig
- **Max. Test Pressure:** 37.5 bar/544 psig

## Product Usage Instructions

### Installation Guide:

1. Ensure the system is powered off and depressurized before installation.
2. Identify the correct location for the thermostatic expansion valve based on system requirements.
3. Securely attach the valve following the manufacturer's guidelines and using the appropriate tools.
4. Connect the refrigerant lines as per the product label instructions.

### Operation:

Once installed, ensure the valve is set to the appropriate temperature range for the refrigerant being used. Monitor system pressure regularly to ensure it stays within the specified limits.

### Maintenance:

Regular maintenance is essential for optimal performance. Inspect the valve for any leaks or damage periodically and replace if necessary. Follow the manufacturer's guidelines for maintenance procedures.

### **FAQ (Frequently Asked Questions)**

- **Q: What refrigerant should I use with this valve?**

A: Refer to the product label for the recommended refrigerant type.

- **Q: What is the maximum working pressure of this valve?**

A: The maximum working pressure is 34 bar/500 psig.

### **Features and Benefits**

- Fast and easy to install
- Wide temperature range
- Interchangeable orifices assembly
- Available with Maximum Operating Pressure
- Long service life and easy maintenance

### **Installation**

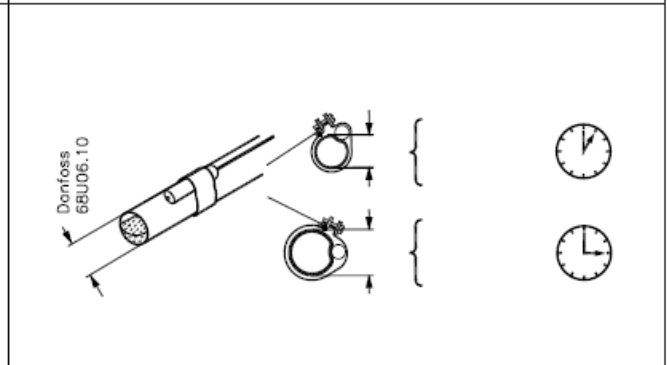
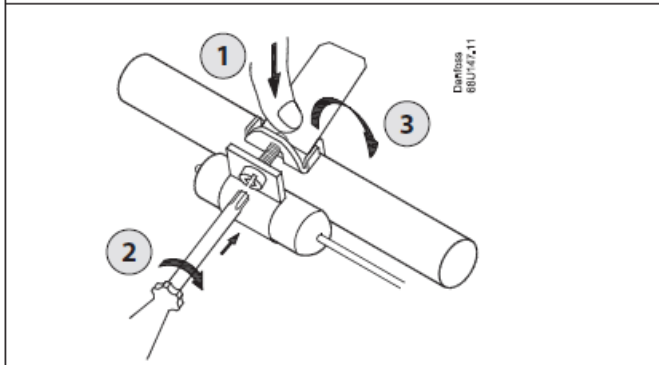
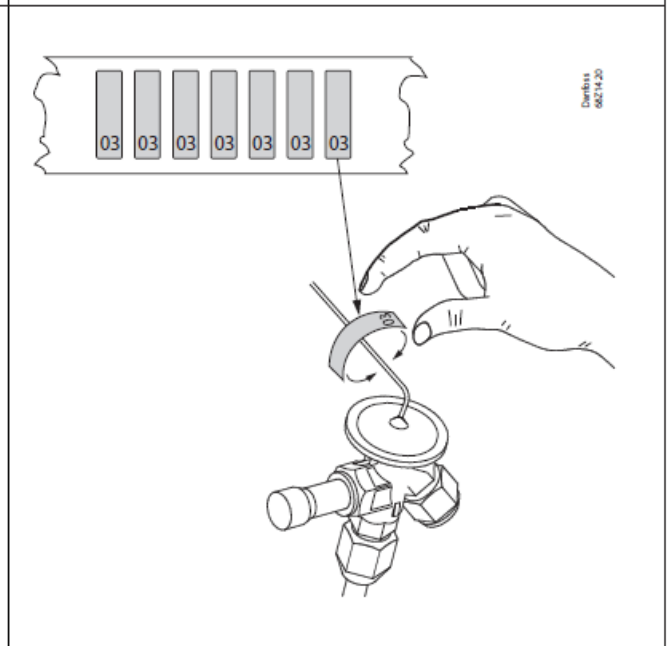
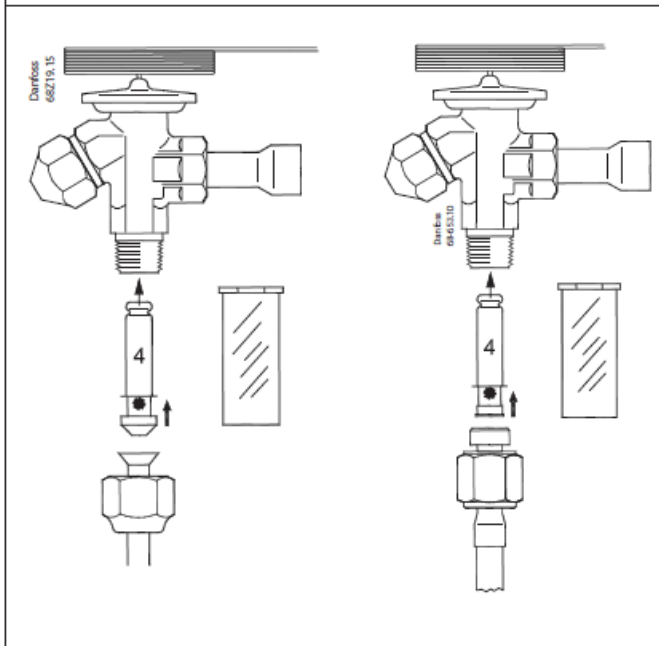
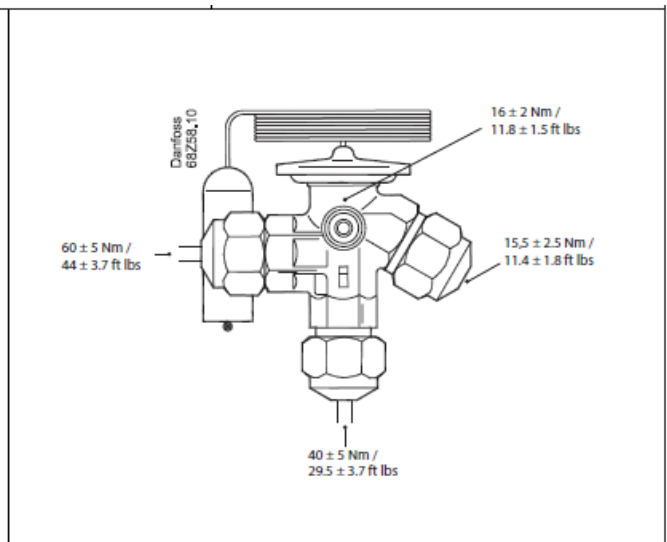
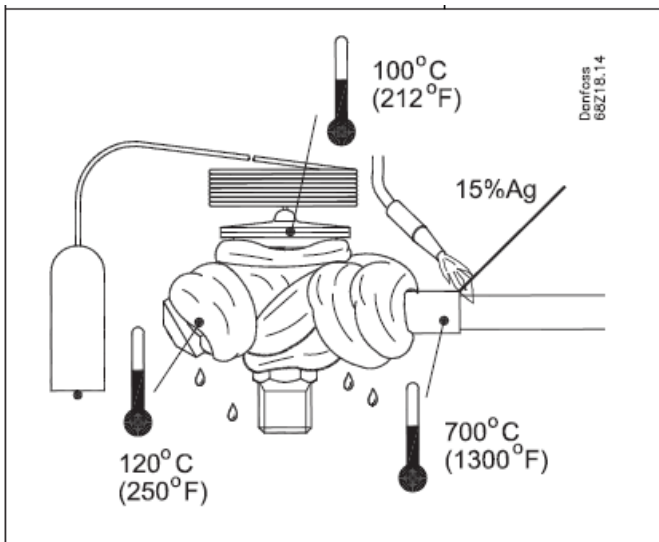

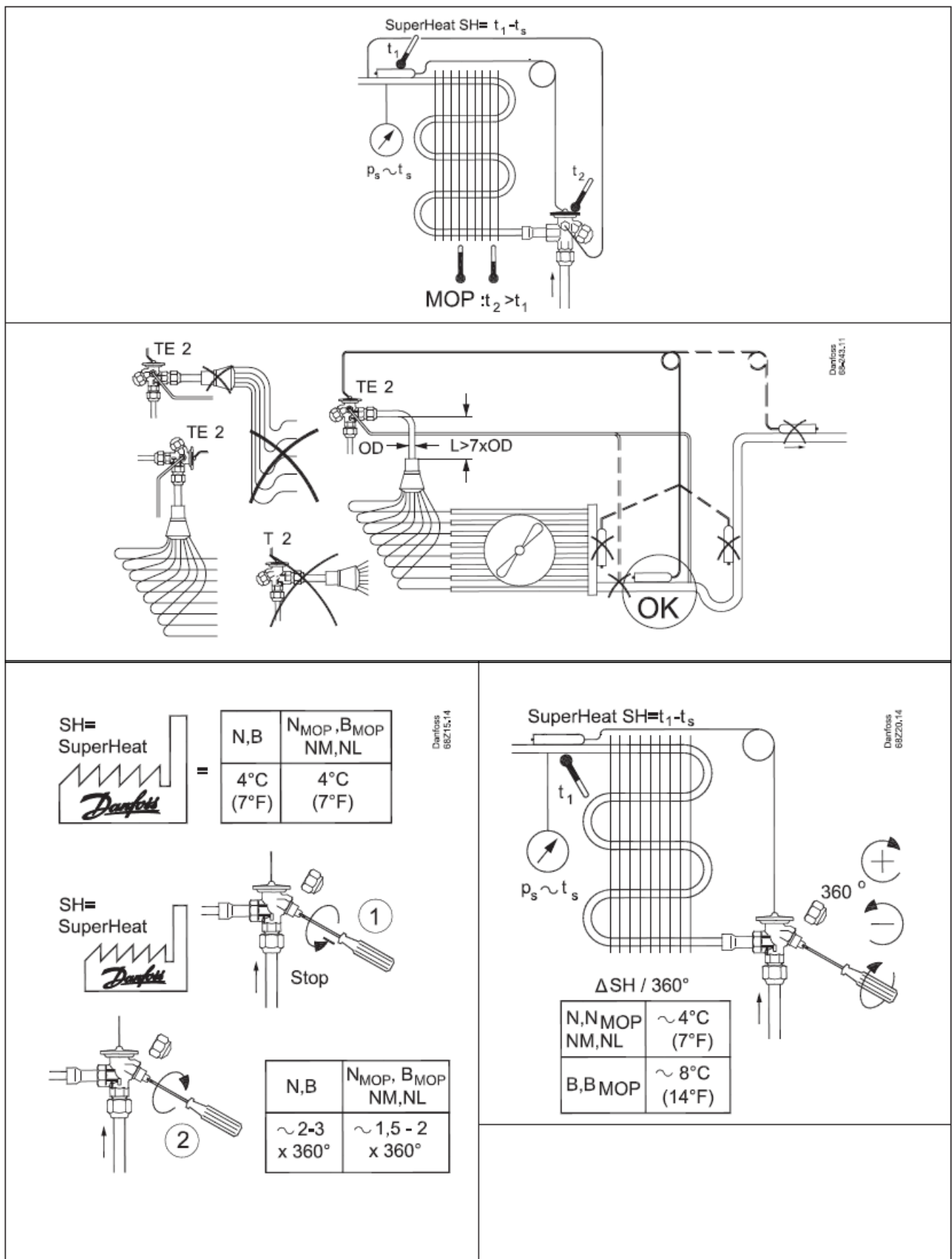

## Temperature ranges

- N = -40 – 10 °C / -40 – 60 °F
- NM = -40 – -5 °C / -40 – 25 °F
- NL = -40 – -15 °C / -40 – 5 °F
- B = -60 – -25 °C / -75 – -15 °F

Any information, including, but not limited to information on the selection of the product, its application or use, product design, weight, dimensions, capacity, or any other technical data in product manuals, catalog descriptions, advertisements, etc., and whether made available in writing, orally, electronically, online or via download, shall be considered informative and is only binding if and to the extent, explicit reference is made in a quotation or order confirmation. Danfoss cannot accept any responsibility for possible errors in catalogs, brochures, videos, and other material. Danfoss reserves the right to alter its products without notice. This also applies to products ordered but not delivered provided that such alterations can be made without changes to the form, fit, or function of the product.

All trademarks in this material are property of Danfoss A/S or Danfoss group companies. Danfoss and the Danfoss logo are trademarks of Danfoss A/S. All rights reserved.

© Danfoss | Climate Solutions | 2024.10.

**Documents / Resources**

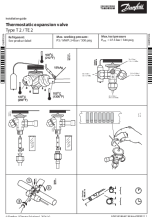
	<p><a href="#">Danfoss Type T 2 Thermostatic Expansion Valve</a> [pdf] Installation Guide Type T 2, Type T 2 Thermostatic Expansion Valve, Thermostatic Expansion Valve, Expansion Valve, Valve</p>
---	---

**References**

- [User Manual](#)

[Manuals+](#), [Privacy Policy](#)

This website is an independent publication and is neither affiliated with nor endorsed by any of the trademark owners. The "Bluetooth®" word mark and logos are registered trademarks owned by Bluetooth SIG, Inc. The "Wi-Fi®" word mark and logos are registered trademarks owned by the Wi-Fi Alliance. Any use of these marks on this website does not imply any affiliation with or endorsement.