

Danfoss TS710 – V2 Single Channel Timer Installation Guide

Contents

- 1 TS710 – V2 Single Channel Timer**
 - 1.1 Installation Guide**
 - 1.2 TS710 – V2 Single Channel Timer FP720 – V2 Two Channel Programmer**
 - 1.3 Installation Guide**
 - 1.4 1. Installation Steps**
 - 1.5 2. Dimensions and Wiring**
 - 1.6 3. Technical Specifications**
- 2 Documents / Resources**
 - 2.1 References**
- 3 Related Posts**

TS710 – V2 Single Channel Timer

Installation Guide

TS710 – V2 Single Channel Timer FP720 – V2 Two Channel Programmer



www.danfoss.com

Installation Guide

1. Installation Steps

User Guide can be downloaded from: heating.danfoss.com.

1. Installation must be done by an authorized electrician.
2. Remove and mount timer/programmer back plate

direct to wall or on wall box, and wire as required for application, see fig. 1 & 2 on page 16. The backplate included within the product packaging should be used for the installation.

3. Remove battery backup tab, see fig. 3 on page 17.
4. Locate hooks at top of timer/programmer into top of back plate, lower into position and tighten retaining screws.

2. Dimensions and Wiring

See fig. 4 for dimensions and fig. 5 for wiring diagram on page 18 and page 19.

3. Technical Specifications

Speci cations	TS710 – V2	FP720 – V2
Operation	Continuous use	
Operating voltage	230 Vac \pm 10 % 50/60 Hz	
Output	Volt free	2 x 230 Vac
Switch rating	3A (1) at 230 Vac	
Switch type	1x SPDT Type 1B	2x SPDT Type 1B internally linked
Terminals	max 2.5 mm ² wires	
IP rating	IP30 (installed)	
Construction	EN60730-2-7	
Control pollution situation	Degree 2	
Rated impulse voltage	4 kV	
Software classi cation	A	
Storage conditions	Relative Humidity 5 – 95% Ambient (storage and shipping) -10 to 60°C	

This product is an electronic heating timer/programmer for control of domestic central heating and domestic hot water.

Fig. 1

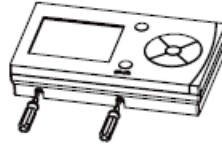

Fig. 2

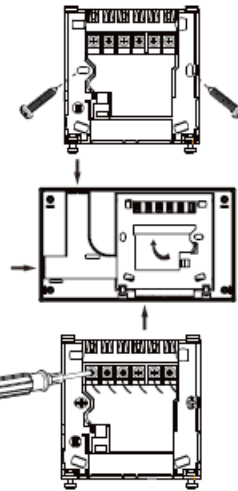

Fig. 3

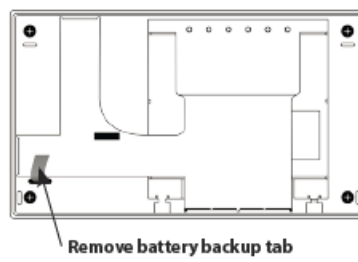
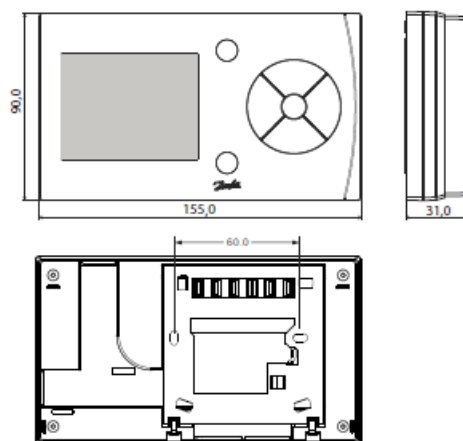
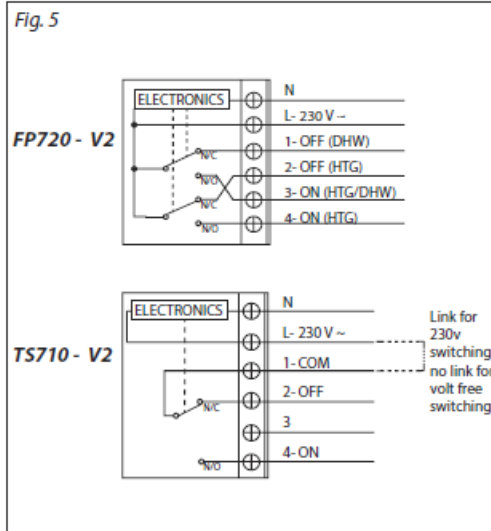

Fig. 4





Danfoss Ltd.
22 Wycombe End, HP9 1NB,

Danfoss A/S
Climate Solutions • danfoss.com • +45 7488 2222

Any information, including, but not limited to information on selection of product, its application or use, product design, weight, dimensions, capacity or any other technical data in product manuals, catalogues descriptions, advertisements, etc. and whether made available in writing, orally, electronically, online or via download, shall be considered informative, and is only binding if and to the extent, explicit reference is made in a quotation or order confirmation. Danfoss cannot accept any responsibility for possible errors in catalogues, brochures, videos and other material. Danfoss reserves the right to alter its products without notice. This also applies to products ordered but not delivered provided that such alterations can be made without changes to form, t or function of the product. All trademarks in this material are property of Danfoss A/S or Danfoss group companies. Danfoss and the Danfoss logo are trademarks of Danfoss A/S. All rights reserved.

Documents / Resources



[Danfoss TS710 - V2 Single Channel Timer](#) [pdf] Installation Guide
TS710, FP720, TS710 - V2 Single Channel Timer, TS710 - V2, Single Channel Timer, Channel Timer

References

- [Engineering Tomorrow | Danfoss](#)
- [Danfoss Climate Solutions for heating | Efficient solutions for superior comfort | Danfoss](#)
- [Danfoss Climate Solutions for heating | Efficient solutions for superior comfort | Danfoss](#)
- [User Manual](#)

This website is an independent publication and is neither affiliated with nor endorsed by any of the trademark owners. The "Bluetooth®" word mark and logos are registered trademarks owned by Bluetooth SIG, Inc. The "Wi-Fi®" word mark and logos are registered trademarks owned by the Wi-Fi Alliance. Any use of these marks on this website does not imply any affiliation with or endorsement.