

Danfoss TR6 Thermostatic Expansion Valve Type

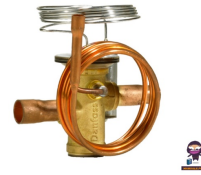

# Danfoss TR6 Thermostatic Expansion Valve Type Installation Guide

[Home](#) » [Danfoss](#) » Danfoss TR6 Thermostatic Expansion Valve Type Installation Guide 

## Contents

- [1 Danfoss TR6 Thermostatic Expansion Valve Type](#)
- [2 Product Information](#)
- [3 Product Usage Instructions](#)
- [4 Installation](#)
- [5 Factory setting](#)
- [6 Documents / Resources](#)
  - [6.1 References](#)



**Danfoss TR6 Thermostatic Expansion Valve Type**



## Product Information

### Specifications:

- **Product Name:** Thermostatic Expansion Valve Type TR6
- **Refrigerants:** R22/R407C, R410A, R32, and R454B
- **Max. Working Pressure:** 49 bar / 711 psig
- **Flow Direction:** A to B (Normal), B to A (Reverse)
- **Qnom. A to B [kW / TR]:** 100%
- **Qnom. B to A [kW / TR]:** 80%
- **Adjustable Setting:** Min. 5% Ag
- **Connection Size:** 19 mm / 3/4 in.
- **Torque:** 10 Nm / 7 ft-lb

## Product Usage Instructions

### Fixed Setting:

For normal flow direction (A to B), ensure that the valve is set to position A. For reverse flow direction (B to A), adjust the valve to position B.

### Adjustable Setting:

To adjust the valve, turn the specified number of turns from the factory setting based on the refrigerant being used. Refer to the table for the number of turns required for each refrigerant type.

### Installation:

1. Ensure proper flow direction as per application requirements.
2. Connect the valve using the specified connection size.
3. Apply the recommended torque for tightening the valve.

### Factory Settings:

The factory settings for different refrigerants are as follows:

- R22/R407C MAH SS = 4 K or customer specification
- R410A MAH & LAH SS = 3 K or customer specification
- R32 LAH SS = 3K or customer specification
- R454B LAH SS = 3K or customer specification

## Installation

Thermostatic expansion valve  
Type TR6

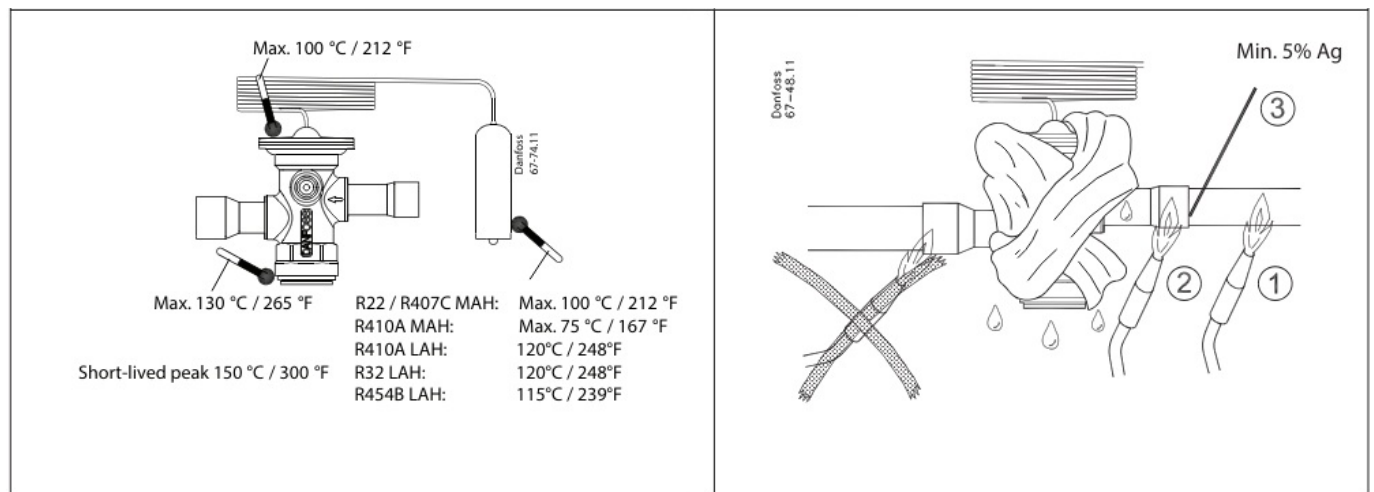
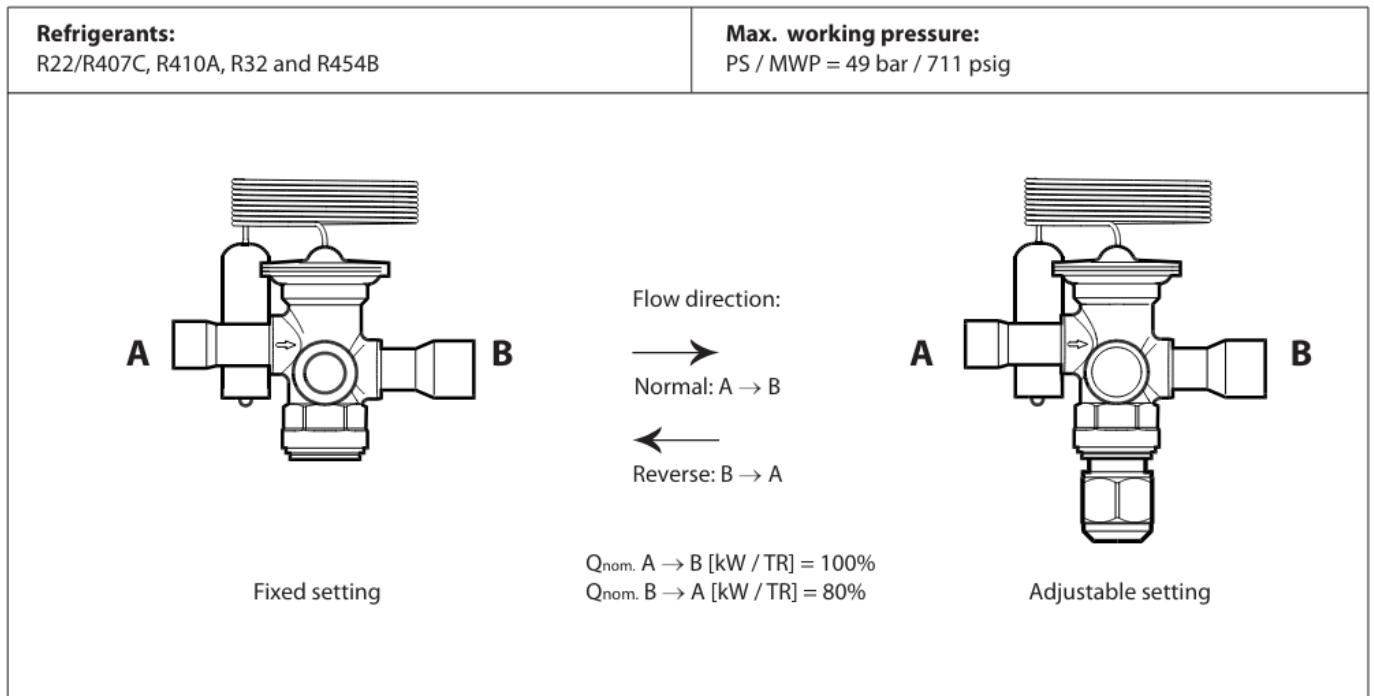

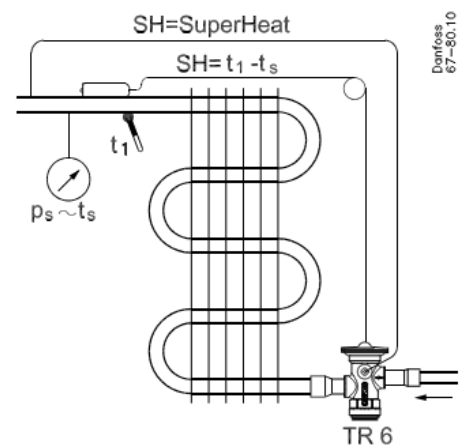
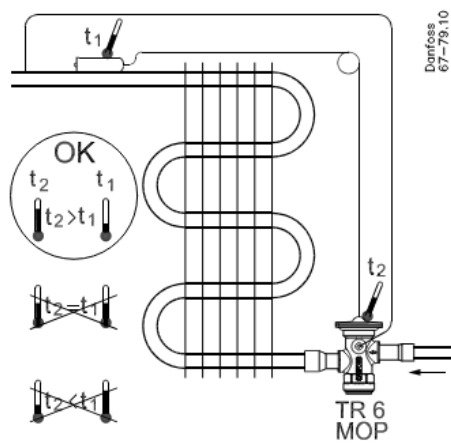
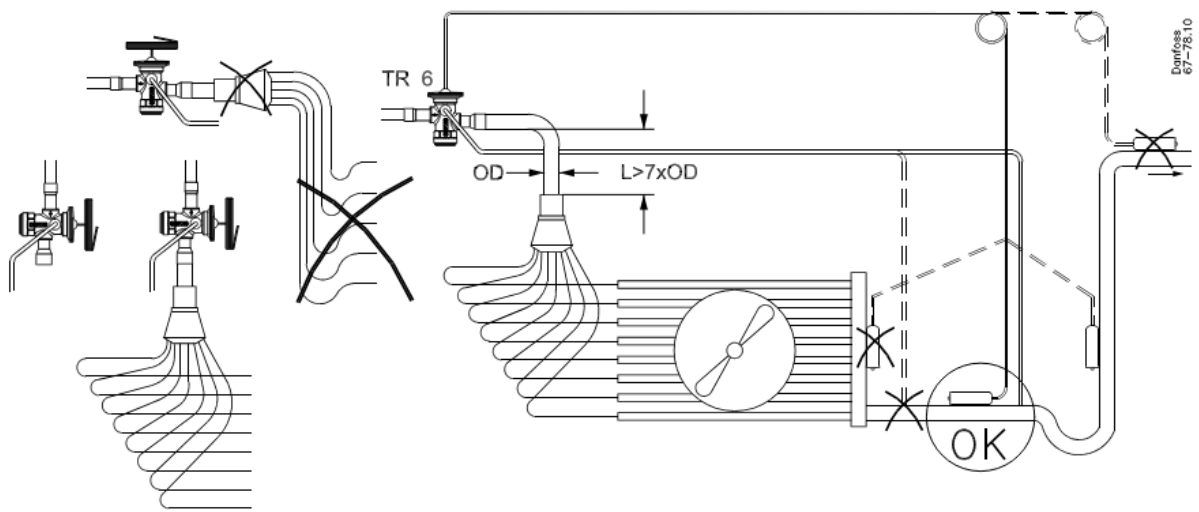
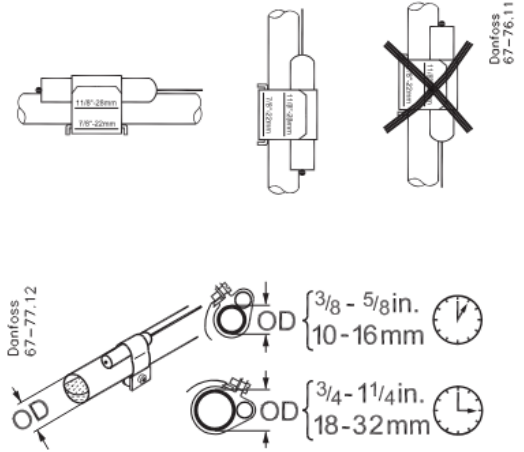
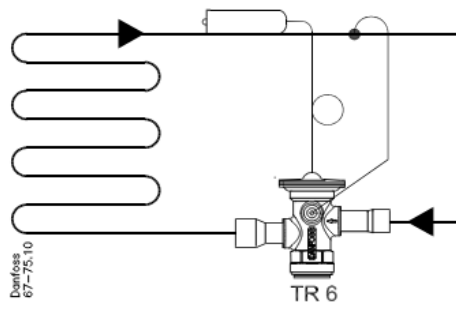

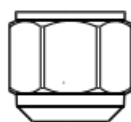
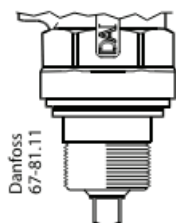

= 19 mm /  $\frac{3}{4}$  in.

Torque = 10 Nm / 7 ft-lb

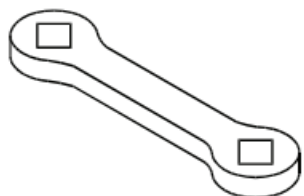

$\Delta$  SH / 1 turn / 360°  $\approx$

R22 / R407C MAH: 1.0 °C / 1.8 °F

R410A MAH: 0.8 °C / 1.1 °F

R410A LAH: 1.4 °C / 2.5 °C

R32 LAH: 1.4 °C / 2.5 °C

R454B LAH: 1.3 °C / 2.3 °F

## Factory setting

- R22/R407C MAH  
SS = 4 K or according to customer specification
- R410A MAH & LAH  
SS = 3 K or according to customer specification
- R32 LAH  
SS: 3K or according to customer specification
- R454B LAH  
SS: 3K or according to customer specification

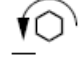
Refrigerant	Number of turns from SS to <b>tight</b> spring 	Number of turns from SS to <b>loose</b> spring 
R22 / R407C MAH	+7.25	-4.25
R410A MAH	+9.5	-2
R410A LAH	+4.75	-4
R32 LAH	+5.25	-3.5
R454B LAH	+4	-4.25

Danfoss A/S

Climate Solutions • [danfoss.com](https://danfoss.com) • +45 7488 2222

Any information, including, but not limited to information on selection of product, its application or use, product design, weight, dimensions, capacity or any other technical data in product manuals, catalogues descriptions, advertisements, etc. and whether made available in writing, orally, electronically, online or via download, shall be considered informative, and is only binding if and to the extent, explicit reference is made in a quotation or order confirmation. Danfoss cannot accept any responsibility for possible errors in catalogues, brochures, videos and other material.

Danfoss reserves the right to alter its products without notice. This also applies to products ordered but not delivered provided that such alterations can be made without changes to form, fit or function of the product. All trademarks in this material are property of Danfoss A/S or Danfoss group companies. Danfoss and the Danfoss logo are trademarks of Danfoss A/S. All rights reserved.

© Danfoss | Climate Solutions | 2023.05

## Frequently Asked Questions (FAQ)

**Q:** What is the maximum working pressure of the valve?

**A:** The maximum working pressure is 49 bar / 711 psig.

**Q:** How do I know which setting to use for a specific refrigerant?

**A:** Refer to the factory settings provided in the manual or consult with a professional for guidance based on the refrigerant type.

---

## Documents / Resources

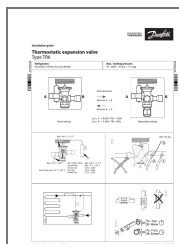

[Danfoss TR6 Thermostatic Expansion Valve Type](#) [pdf] Installation Guide  
TR6 Thermostatic Expansion Valve Type, Thermostatic Expansion Valve Type, Expansion Valve Type, Valve Type, Type

## References

- [User Manual](#)

[Manuals+](#), [Privacy Policy](#)

This website is an independent publication and is neither affiliated with nor endorsed by any of the trademark owners. The "Bluetooth®" word mark and logos are registered trademarks owned by Bluetooth SIG, Inc. The "Wi-Fi®" word mark and logos are registered trademarks owned by the Wi-Fi Alliance. Any use of these marks on this website does not imply any affiliation with or endorsement.