

Danfoss TPOne-B Electronic Programmable Room Thermostat



Danfoss TPOne-B Electronic Programmable Room Thermostat User Guide

[Home](#) » [Danfoss](#) » Danfoss TPOne-B Electronic Programmable Room Thermostat User Guide 

Contents

- [1 Danfoss TPOne-B Electronic Programmable Room Thermostat](#)
- [2 Specifications](#)
- [3 Installation Instructions](#)
- [4 Wiring](#)
- [5 Mounting](#)
- [6 User Interface](#)
- [7 Display](#)
- [8 Setup Wizard](#)
- [9 Set Temperatures](#)
- [10 Setup Schedule](#)
- [11 Installer Settings](#)
- [12 FAQ](#)
- [13 Documents / Resources](#)
 - [13.1 References](#)
- [14 Related Posts](#)



Danfoss TPOne-B Electronic Programmable Room Thermostat



Specifications

- **Operating Voltage:** 2.5 – 3VDC (2x AA batteries)
- **Output relay:** SPDT Type 1B
- **Setting temperature range:** [Temperature Range]
- **Operating temperature range:** [Temperature Range]
- **Switch rating:** [Switch Rating]
- **Switch type:** [Switch Type]
- **Battery lifetime:** [Battery Lifetime]
- **IP rating:** IP20
- **Control:** On/off control, Chrono-proportional control
- **Operating mode:** [Operating Mode]
- **Construction:** [Construction]
- **Pollution Degree Rating:** [Pollution Degree Rating]
- **Rated impulse voltage:** 4kV
- **Ball pressure test:** [Ball Pressure Test]
- **Dimensions (mm):** H67 x L154 x P30
- **Software Classification:** Class A
- **Battery backup time:** 2 Hours

Installation Instructions

Please note: This product should only be installed by a qualified electrician or competent heating installer and should be by local wiring regulations.

Full product instructions can be found at www.danfoss.com

Thermostat positioning

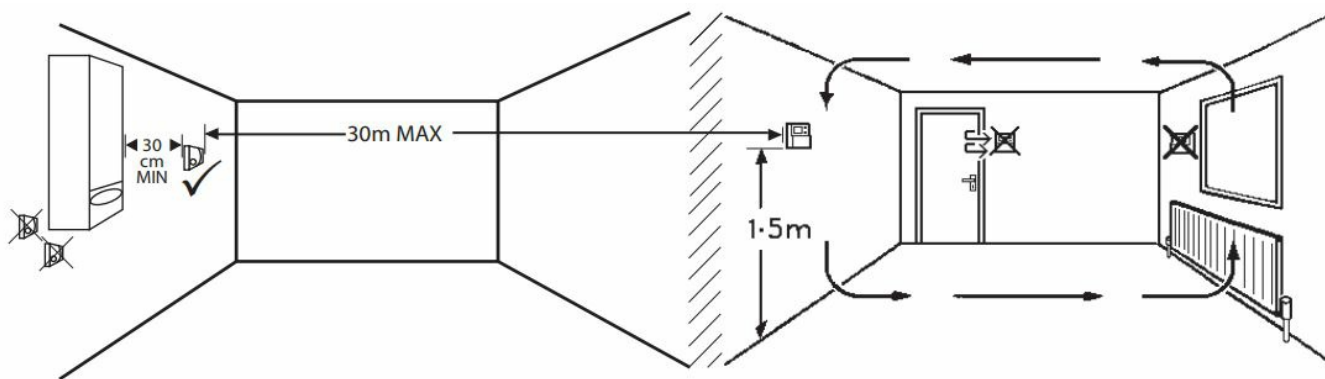

Specifications	TPOne-B
Operating Voltage	2.5 – 3VDC (2x AA batteries)
Output relay	Volt Free
Setting temperature range	5-35°C
Operating temperature range	0-45°C
Switch rating	3A (1) at 230Vac
Switch type	1 x SPDT Type 1B
Battery lifetime	Min. 2 years
IP rating	IP20
On/off control	Yes
Chrono-proportional control	Yes
Operating mode	Heating
Construction	EN 60730-2-9, EN 60730-2-7
Pollution Degree Rating	Degree 2
Rated impulse voltage	4 kV
Ball pressure test	75°C
Dimensions (mm)	H67 x W154 x D30
Software Classification	A
Battery backup time	2 Hours

ErP Class

The products represented within this document are classified according to, and allow completion of, the Energy Related Product (ErP) Directive System Package fiche and the ErP system data label. ErP Labelling obligation is applicable from 26th September 2015.

ERP Class	Product Function and ErP Description	Additional efficiency gain
ErP Product Class 4	TPI Room Thermostat, for use with on/off output heaters An electronic room thermostat that controls both thermostat cycle rate and in-cycle on/off ratio of the heater proportional to room temperature. TPI control strategy reduces mean water temperature, improves room temperature control accuracy and enhances system efficiency.	2%

Wiring

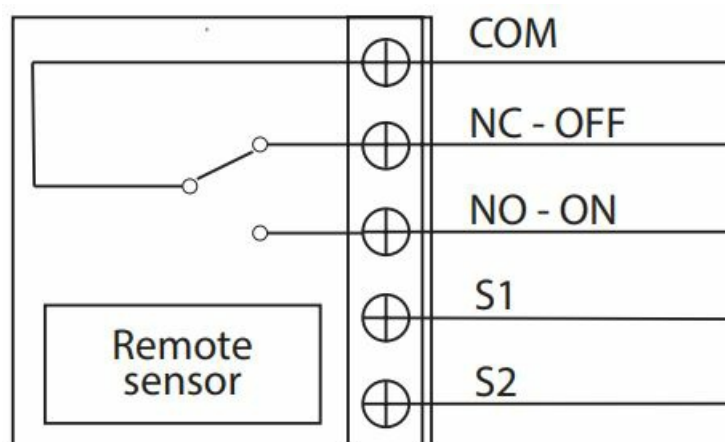

- Remote sensor inputs



- Remote room or limit sensor
- Window switch contact

Mounting

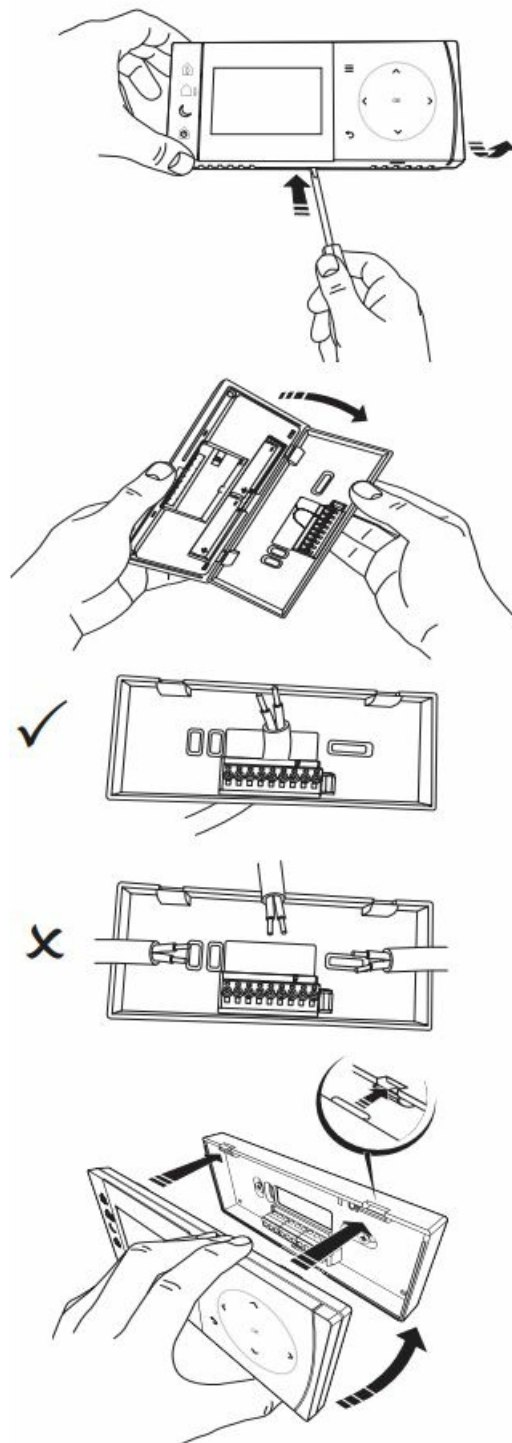





User Interface

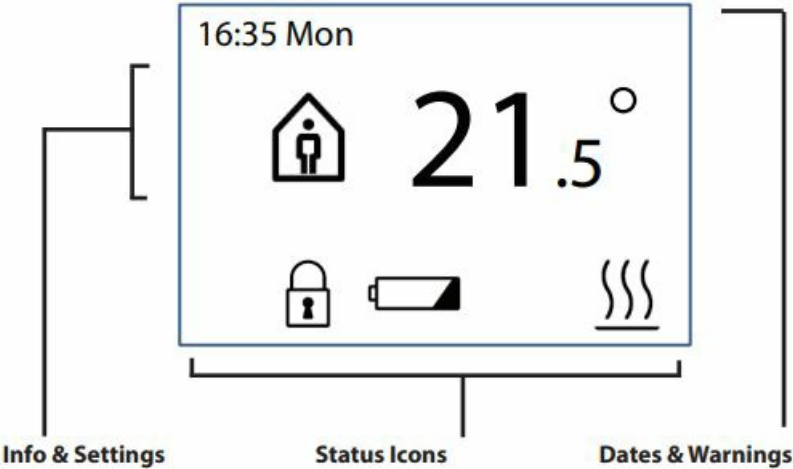

	Home
	Away
	Asleep
	Standby
	Menu
OK	Select / Confirm
	Menu Back

Display



	Button Lock
	Battery Low
	Heat Calling

Setup Wizard

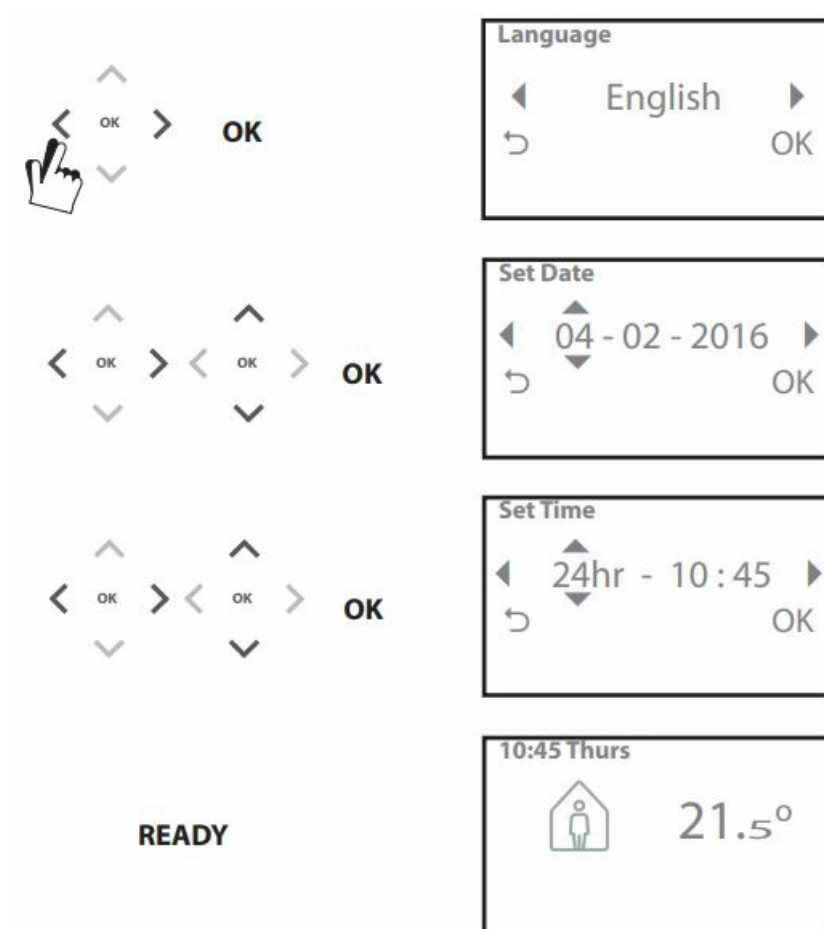

Set Temperatures

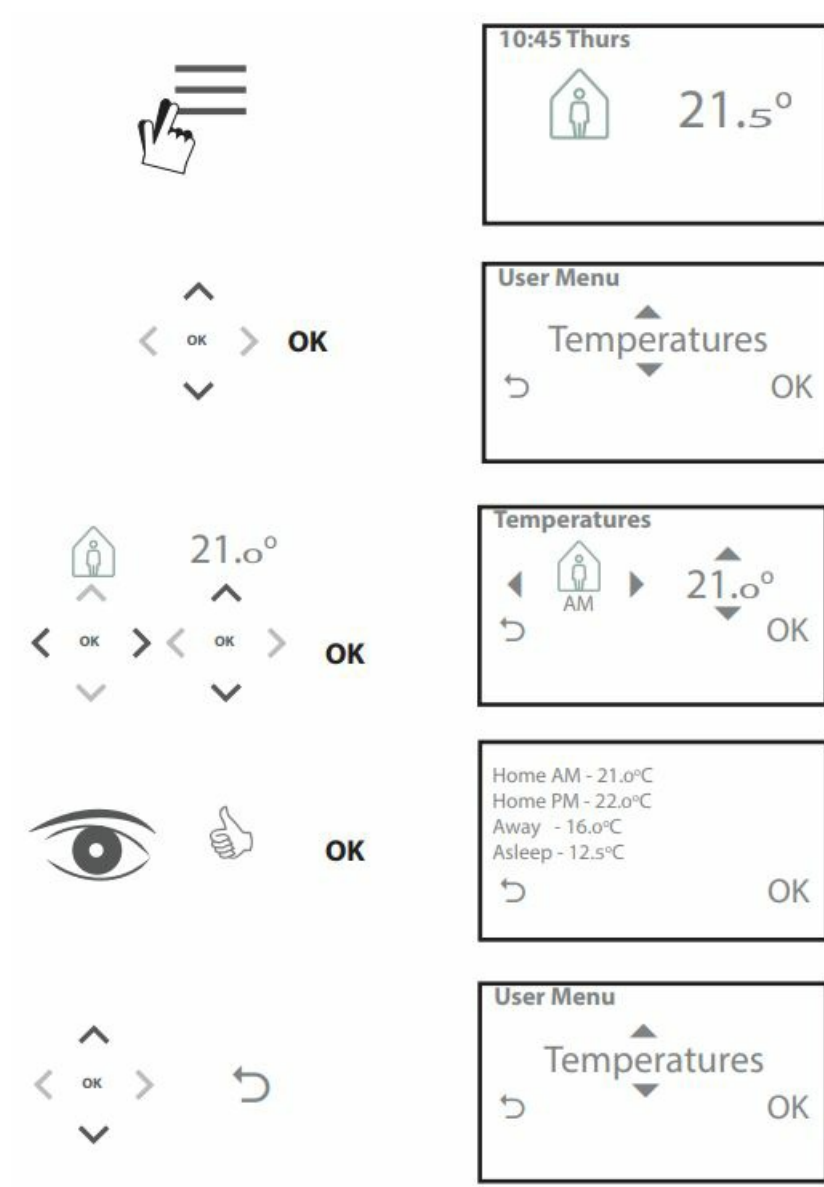

Setup Schedule

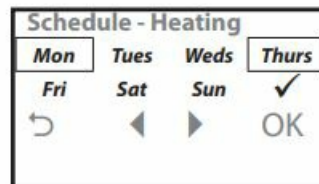
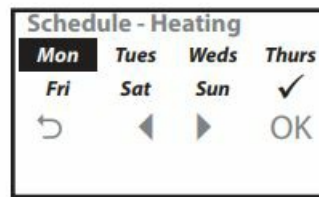
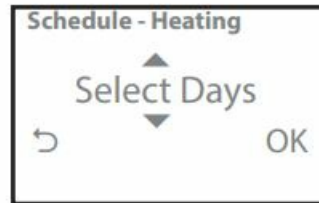
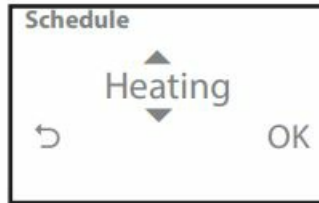
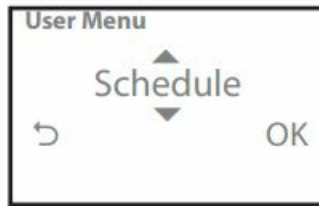
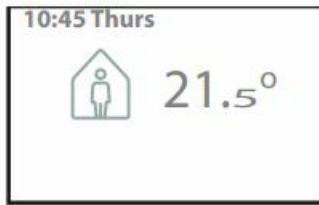

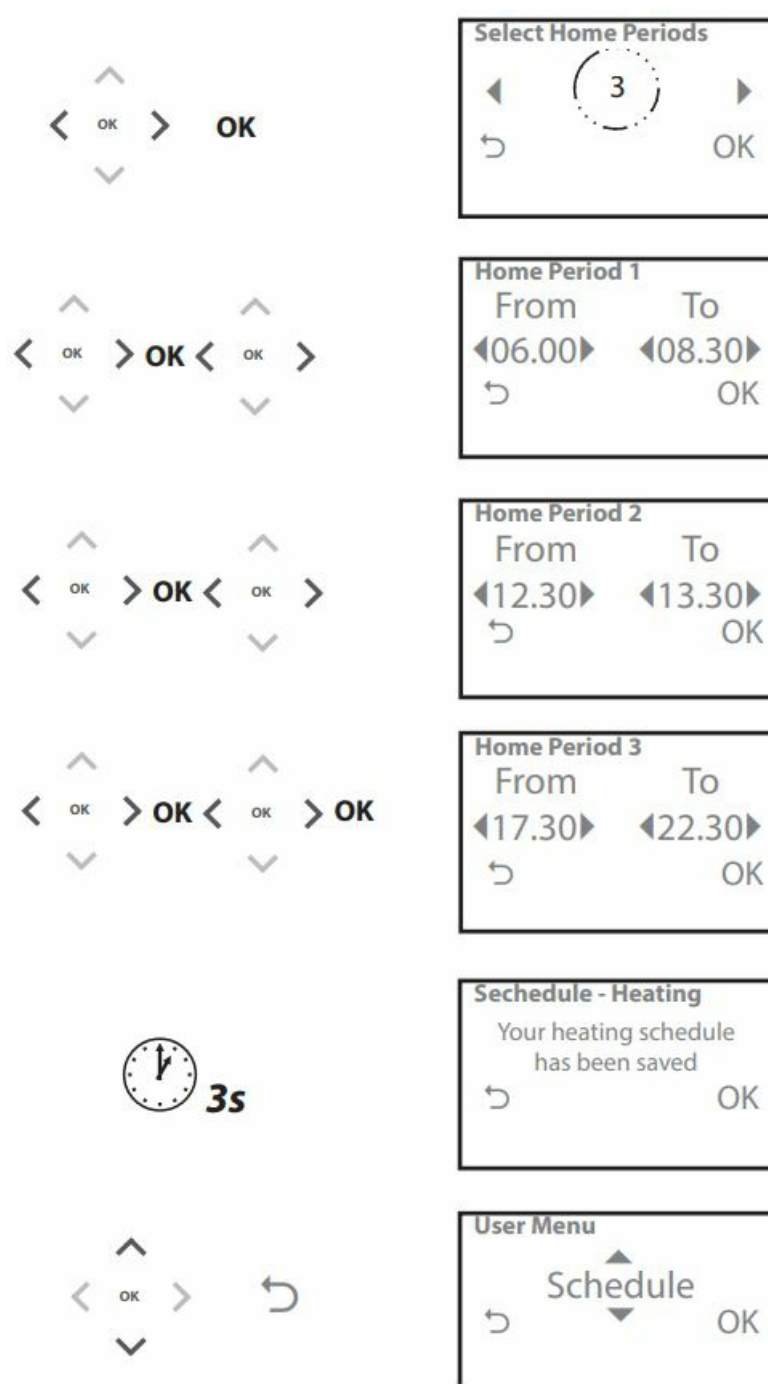

Menu

- Click & Save
- Heating Mode
- Schedule
- Temperatures
- Holiday

Settings

- Set Date
- Set Time
- Button Click
- Backlight

- Temperature Scale
- Language
- User Reset
- Information

Installer Settings

- Control Type
- Start-up
- Method
- Pump
- Exercise
- Temperature
- Limits
- Frost Protect
- Temperature
- Override
- Daylight
- Saving
- Button Lock
- Display Idle
- Mode
- Service
- Interval
- Service Demo
- Installer Lock

Information and Warnings

- Window
- Open
- Product Lock
- Optimized
- Start
- Delayed
- Start
- Frost Risk
- Low Heat
- Service Due
- Heat
- Reduced
- High Floor
- Temperature

- Sensor Fail
- External
- Sensor Fail

FAQ

- **Q: Can I install the product myself?**
 - A: No, this product should only be installed by a qualified electrician or competent heating installer.
- **Q: What is the battery lifetime?**
 - A: The battery lifetime is [Battery Lifetime].

EU: Danfoss A/S 6430 Nordborg, Denmark
GB: Danfoss Ltd. Unit 4 Uxbridge Business Park, Sanderson Road UB8 1 DH, GB

Danfoss A/S
Climate Solutions

- danfoss.com
- +45 0330 8086 888
- customerservice.uk@danfoss.com

Any information, including, but not limited to information on the selection of the product, its application or use, product design, weight, dimensions, capacity or any other technical data in product manuals, catalog descriptions, advertisements, etc., and whether made available in writing, orally, electronically, online or via download, shall be considered informative and is only binding if and to the extent, explicit reference is made in a quotation or order confirmation. Danfoss cannot accept any responsibility for possible errors in catalogs, brochures, videos, and other material. Danfoss reserves the right to alter its products without notice. This also applies to products ordered but not delivered provided that such alterations can be made without changes to the form, fit, or function of the product. All trademarks in this material are property of Danfoss A/S or Danfoss group companies. Danfoss and the Danfoss logo are trademarks of Danfoss A/S. All rights reserved.



© Danfoss Climate Solutions | 01/2024 AN427239705966en-000201 (013R9607)

Documents / Resources



[Danfoss TPOne-B Electronic Programmable Room Thermostat](#) [pdf] User Guide
TPOne-B Electronic Programmable Room Thermostat, TPOne-B, Electronic Programmable Room Thermostat, Programmable Room Thermostat, Room Thermostat, Thermostat

References

-  [Engineering Tomorrow | Danfoss](#)
-  [Engineering Tomorrow | Danfoss](#)
- [User Manual](#)