

*Danfoss*  
**MSV-O DN15  
Series  
Manual  
Balancing  
Valve**



## Danfoss MSV-O DN15 Series Manual Balancing Valve Instructions

[Home](#) » [Danfoss](#) » Danfoss MSV-O DN15 Series Manual Balancing Valve Instructions 

### Contents

- [1 Danfoss MSV-O DN15 Series Manual Balancing Valve](#)
- [2 Instructions for use](#)
- [3 FAQ](#)
- [4 Documents / Resources](#)
  - [4.1 References](#)
- [5 Related Posts](#)



**Danfoss MSV-O DN15 Series Manual Balancing Valve**



## Specifications

- Type: Manual balancing valve
- Model: MSV-O
- Size: DN15 – DN50
- Pressure Rating: PN 20

## Manual balancing valve

## Instructions for use

### Fitting

Before fitting the valve the installer must ensure that the pipe system is clean and:

1. the valve can be turned 360 degrees if threaded pipe is used.
2. the valve is oriented according to the flow arrow.

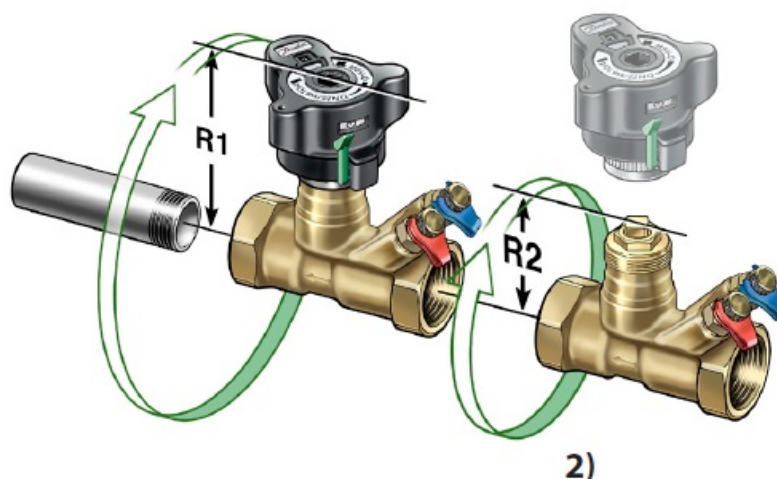

## Removal of handle

1. The union nut become accessible when the green lock is released.
2. Turn scale to 0.0 and unscrew the union nut.

### Calibration

3. Before refitting handle ensure that the setting displays 0.0

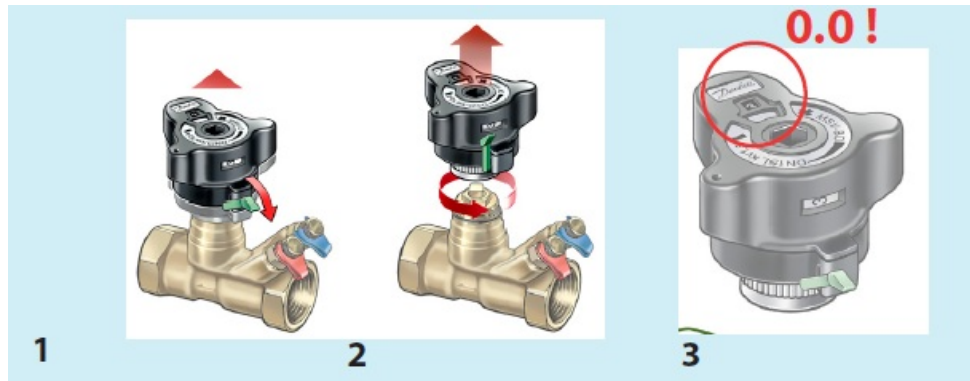

### Open and close

An indicator shows:

- White = open valve
- Red = closed valve

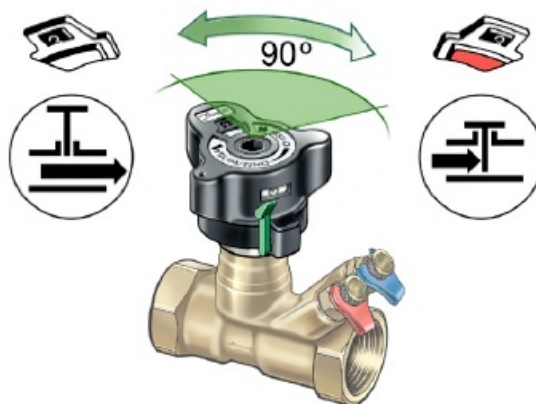

### Setting the flow

1. When valve is open the lock is released. Allen key can also be used.
2. The handle pops up and the required flow may be set. Flow diagrammed are found in <http://heating.danfoss.com>
3. Lock the setting by pressing the handle until click.

### Seal

4. The setting may be protected using a sealing strip.

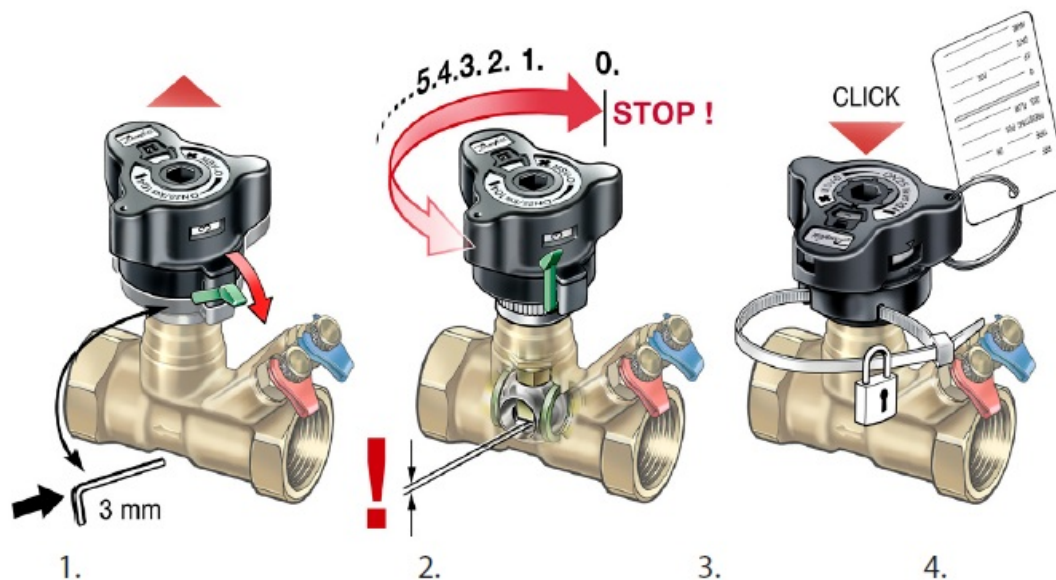

## FAQ

- How do I know if the valve is open or closed?
  - An indicator shows white for an open valve and red for a closed valve.
- Where can I find flow diagrams for setting the required flow?
  - Flow diagrams can be found at <http://heating.danfoss.com>.

## Documents / Resources

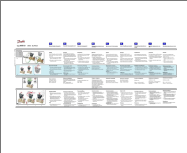
	<p><b>Danfoss MSV-O DN15 Series Manual Balancing Valve</b> [pdf] Instructions  MSV-O DN15, MSV-O DN20, MSV-O DN25, MSV-O DN32, MSV-O DN40, MSV-O DN50, MSV-O DN15 Series Manual Balancing Valve, MSV-O DN15 Series, Manual Balancing Valve, Balancing Valve</p>
---	---

## References

- [Heating | Danfoss | Danfoss](#)
- [Danfoss Schweiz | Klima | Kälte | Heizung | Antriebe | Hydraulik | Danfoss](#)
- [Engineering Tomorrow | Danfoss](#)
- [Danfoss Climate Solutions for heating | Efficient solutions for superior comfort | Danfoss](#)
- [User Manual](#)

[Manuals+](#), [Privacy Policy](#)

This website is an independent publication and is neither affiliated with nor endorsed by any of the trademark owners. The "Bluetooth®" word mark and logos are registered trademarks owned by Bluetooth SIG, Inc. The "Wi-Fi®" word mark and logos are registered trademarks owned by the Wi-Fi Alliance. Any use of these marks on this website does not imply any affiliation with or endorsement.