

Danfoss
KP 98
Thermostat
Type Cross
Ambient



Danfoss KP 98 Thermostat Type Cross Ambient Installation Guide

[Home](#) » [Danfoss](#) » Danfoss KP 98 Thermostat Type Cross Ambient Installation Guide 

Contents

- [1 Danfoss KP 98 Thermostat Type Cross Ambient](#)
- [2 Thermostat](#)
- [3 Technical data](#)
- [4 Mounting](#)
- [5 Electrical connections](#)
- [6 Testing](#)
- [7 Specifications](#)
- [8 FAQs](#)
- [9 Documents / Resources](#)
 - [9.1 References](#)

Danfoss

Danfoss KP 98 Thermostat Type Cross Ambient



Thermostat

(Cross ambient = adsorption charged)

Fig. 1

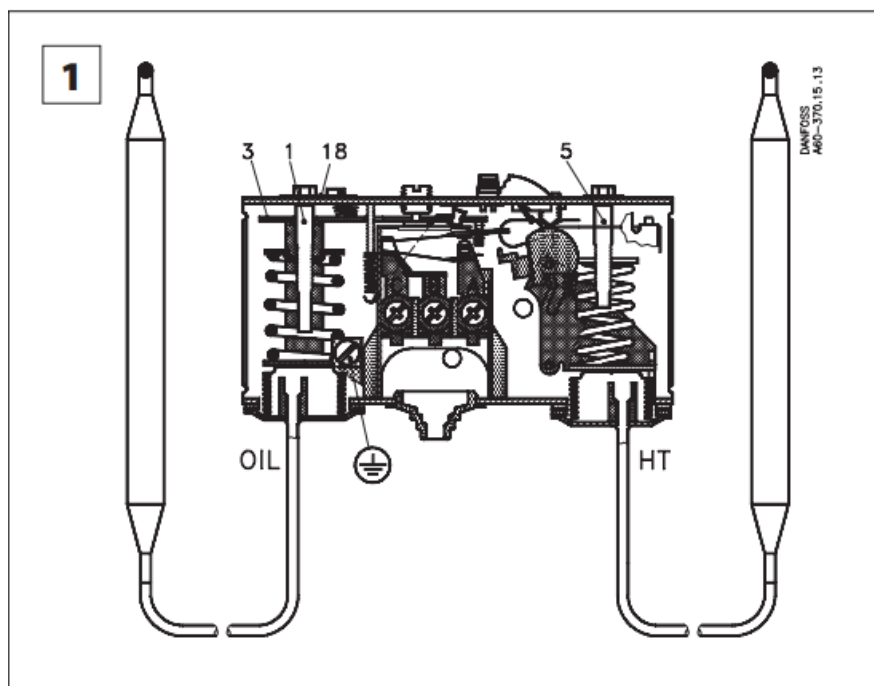

1. Setting spindle, "OIL" (LT) (setting of max. oil temperature)
2. Main arm
3. Setting spindle, "HT" (setting of max. high-pressure gas temperature)
4. Locking plate

Technical data

Function

The function at a rise or drop in temperature appears from the figures 8 and 9. Permissible ambient temperature for thermostat housing. -40 – 65 °C (80 °C for max. 2 hours) Max. permissible bulb temperature “OIL” sensor on 060L113166: 150 °C. “HT” bulb: 250 °C Enclosure and tightness IP30 in accordance with EN 60529 / IEC 529. This grade of enclosure is obtained when the unit is fitted on a flat panel or on a bracket. The bracket must be placed in such a way that all open holes are covered.

Contact load

See the scale of the unit.

Application in accordance with UL-requirements:

- 120 V AC; 16 FLA, 96 LRA
- 240 V AC; 8 FLA, 48 LRA
- 240 V DC; 12 W pilot duty

Mounting

The two bulbs are to be placed as shown on fig. 3, 4 and 6.

Fig. 2

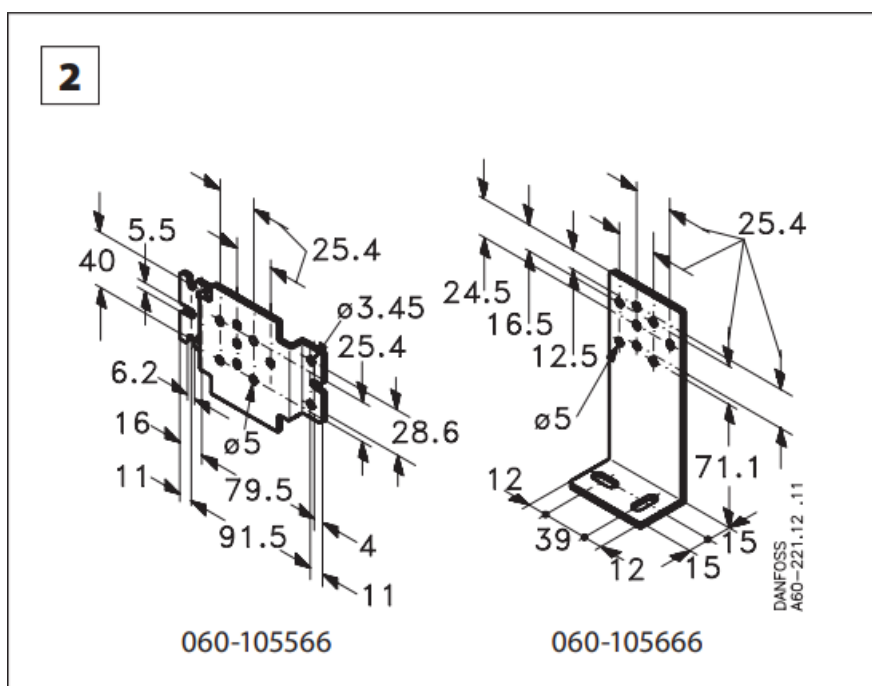

2 types of mounting brackets with screws and washers. To be ordered separately. NB: If other screws are used, make sure that they do not project more than 1.5 mm into the unit.

Fig. 3

Compressor with KP 98.

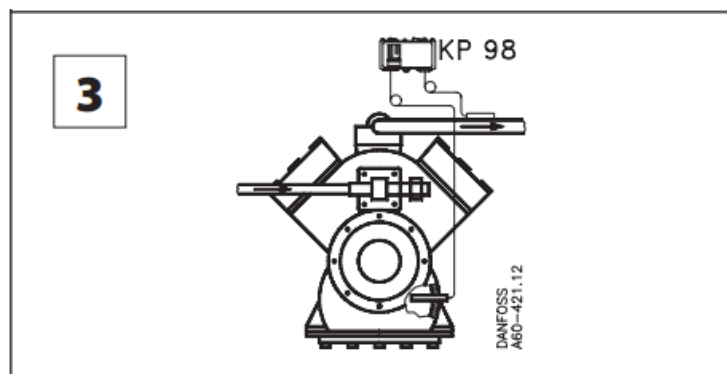

Fig. 4
Sensor fitted to tube.

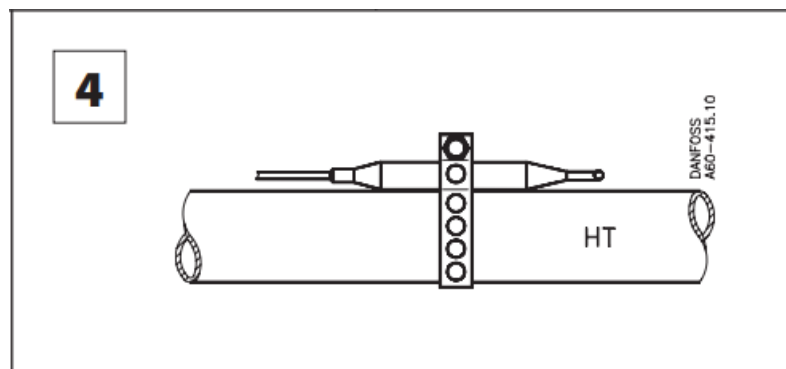

Fig. 5
Clamp. To be ordered separately.

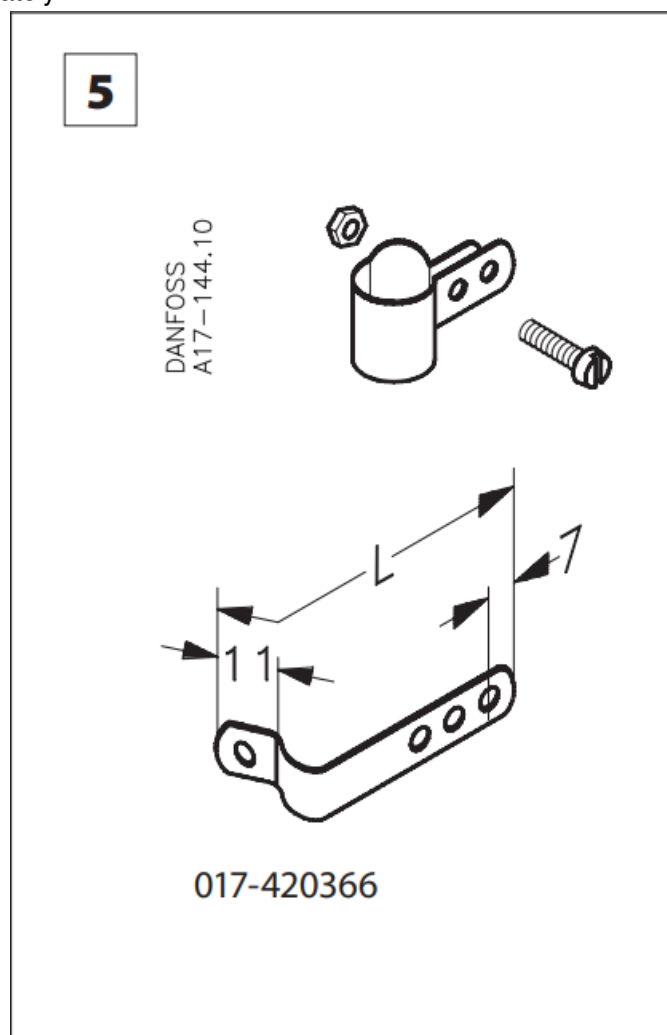

Fig. 6
Bulb in pocket.

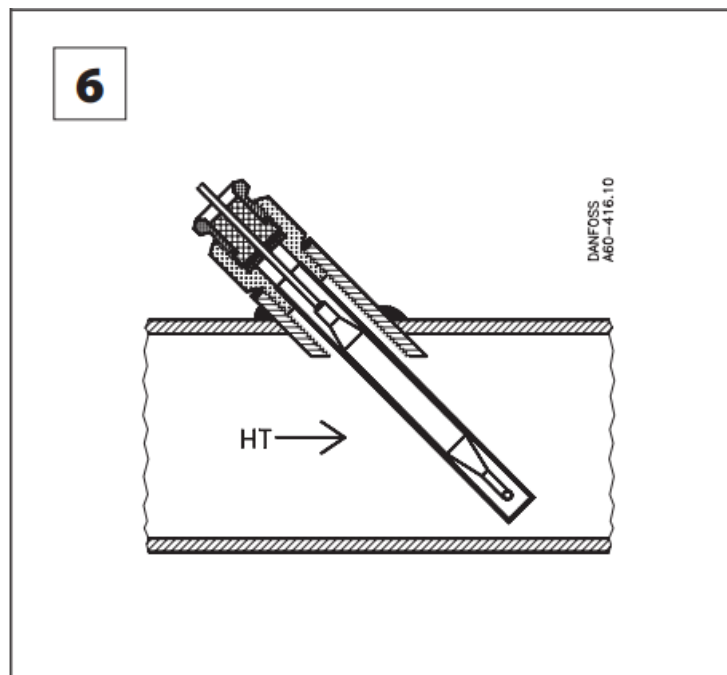
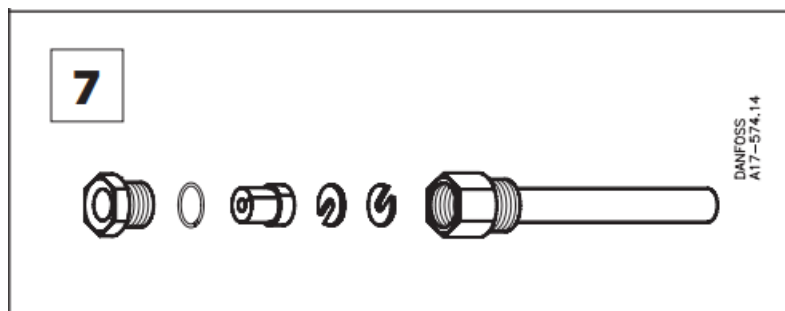
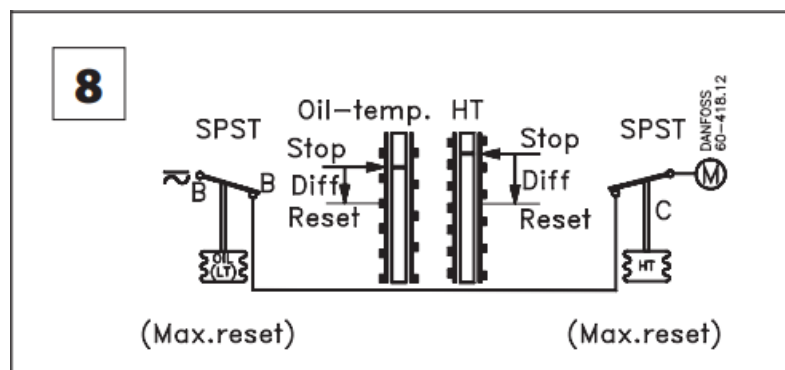

Fig. 7
Sensor pocket. To be ordered separately. To improve the heat transfer from pocket to bulb a heat conducting paste can be used. Code No. 041E0110.



Electrical connections

Fig. 8



CAUTION!

Disconnect the power supply before wiring connections are made or service is performed to avoid possible electrical shock or damage to equipment. Never touch live parts with your fingers or with any tool.

Fig. 9
Cable entry of plastic is supplied. Can be used for 6 – 14 mm cable.

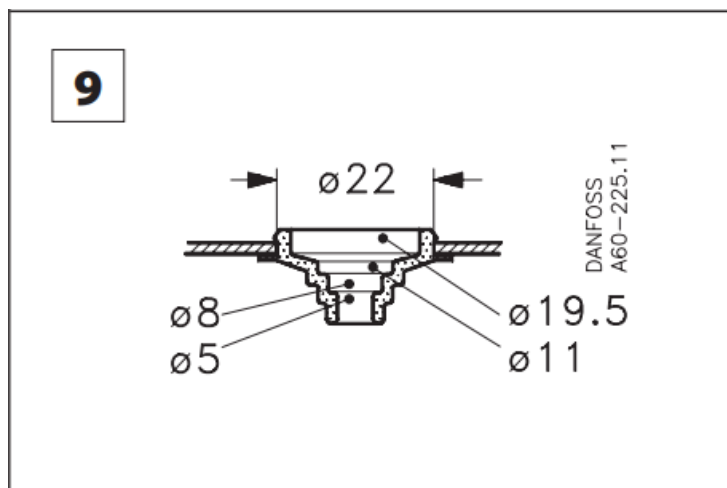
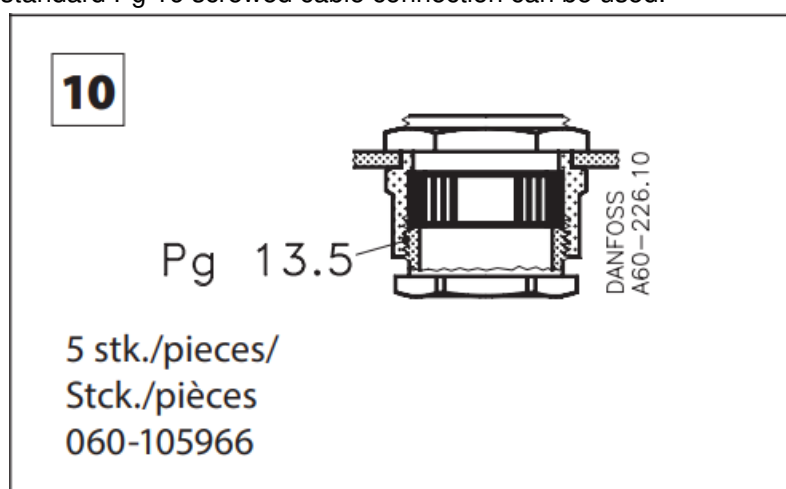

Fig. 10

Pg 13.5 screwed cable connection with special nut to be ordered separately. Can be used for 6 – 14 mm cable. For 8 – 16 mm cable a standard Pg 16 screwed cable connection can be used.



Testing

Fig. 11

The main arm (3) is tilted. When testing, the “RESET” knobs must be activated simultaneously with the tilting of the main arm (3). NB. Use only the testing method shown.

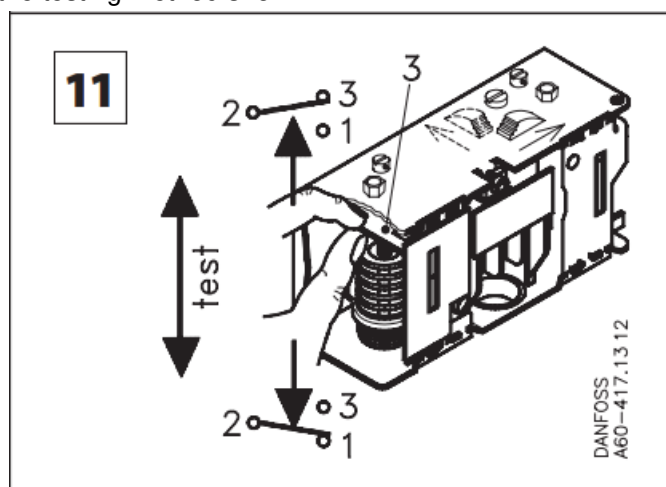

Setting

Fig. 8 and 12

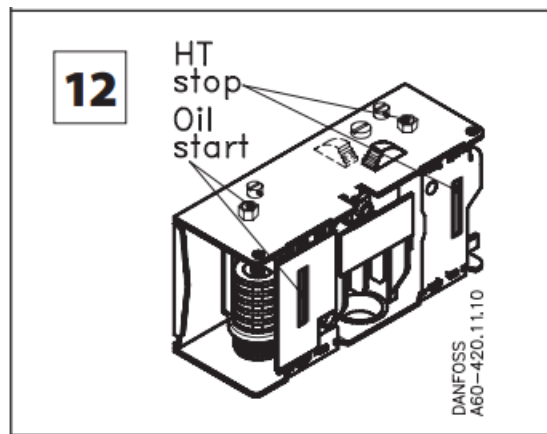

- “START” = starting temperature
- “STOP” = stop temperature
- “DIFF” = differential

Fig. 8 and 12

The highest oil and high-pressure gas temperatures are set on the “OIL” and “HT” scales, respectively. The “OIL” differential is fixed at 14 °C. The “HT” differential is fixed at 25 °C. The plant is restarted after stop by depressing the “RESET” buttons. Restart cannot take place until the temperature has dropped by a value equal to the difference in question. Locking the setting

Fig. 13 and 14

Both the “OIL” and the “HT” spindles can be locked with the locking plate. If sealing is required a sealing screw is used.

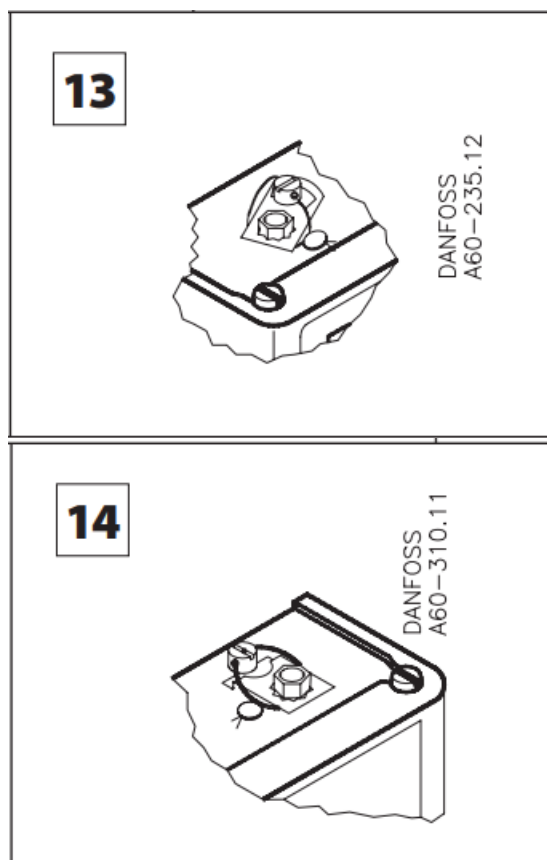
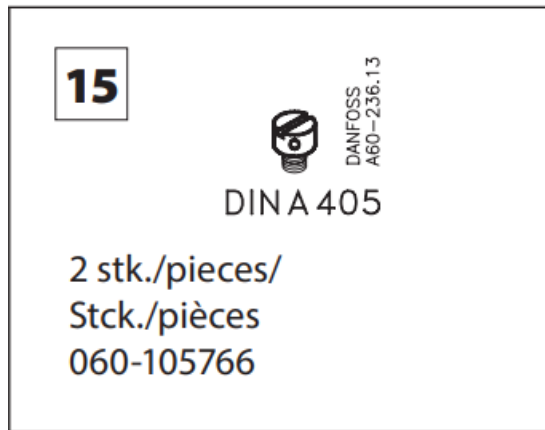

Fig. 15

Sealing screw. To be ordered separately.



Specifications

- Thermostat Type: KP 98 (cross ambient)
- Function: Cross ambient = adsorption charged
- Electrical Requirements: 120 V AC; 16 FLA, 96 LRA / 240 V AC; 8 FLA, 48 LRA / 240 V DC; 12 W pilot duty

FAQs

Q: How do I lock the OIL and HT spindles?

A: Both spindles can be locked using the locking plate provided. For sealing purposes, use the sealing screw.

Q: What are the electrical requirements for the thermostat?

A: The thermostat operates on 120 V AC; 16 FLA, 96 LRA / 240 V AC; 8 FLA, 48 LRA / 240 V DC; 12 W pilot duty.

Documents / Resources

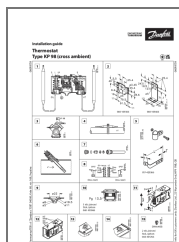

[Danfoss KP 98 Thermostat Type Cross Ambient](#) [pdf] Installation Guide

KP 98 Thermostat Type Cross Ambient, KP 98, Thermostat Type Cross Ambient, Type Cross Ambient, Cross Ambient

References

- [User Manual](#)

[Manuals+ Privacy Policy](#)

This website is an independent publication and is neither affiliated with nor endorsed by any of the trademark owners. The "Bluetooth®" word mark and logos are registered trademarks owned by Bluetooth SIG, Inc. The "Wi-Fi®" word mark and logos are registered trademarks owned by the Wi-Fi Alliance. Any use of these marks on this website does not imply any affiliation with or endorsement.