



Danfoss HRB Series Invertwell AC Drives and Controls Installation Guide

[Home](#) » [Danfoss](#) » **Danfoss HRB Series Invertwell AC Drives and Controls Installation Guide** 



Installation Guide

Contents

- [1 Accessories HRB, HFE Coupling](#)
- [2 Documents / Resources](#)
 - [2.1 References](#)

Accessories HRB, HFE Coupling

1

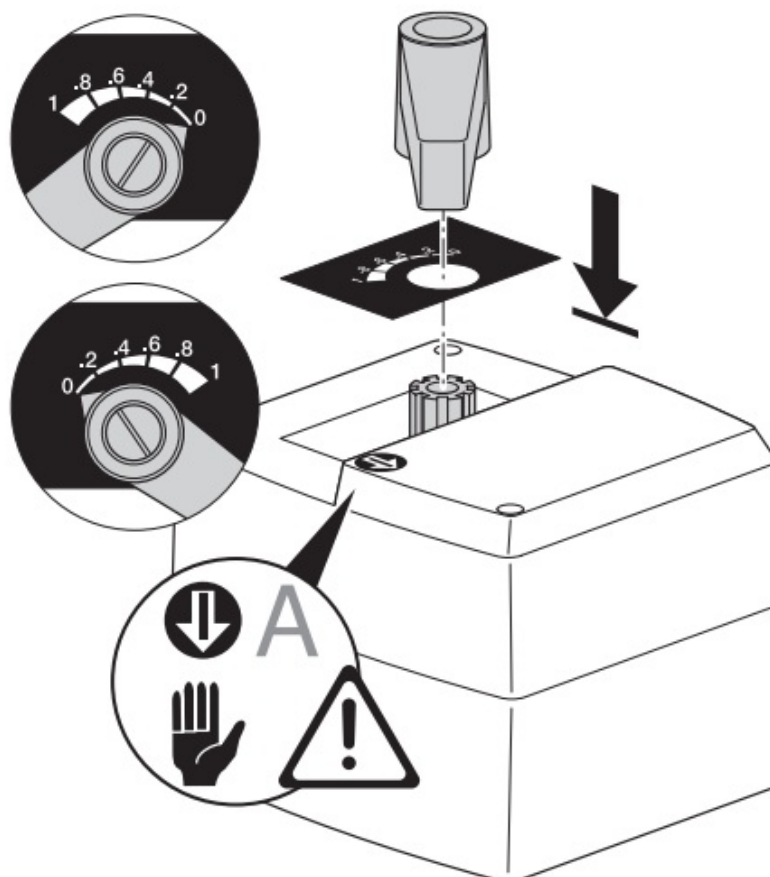

2

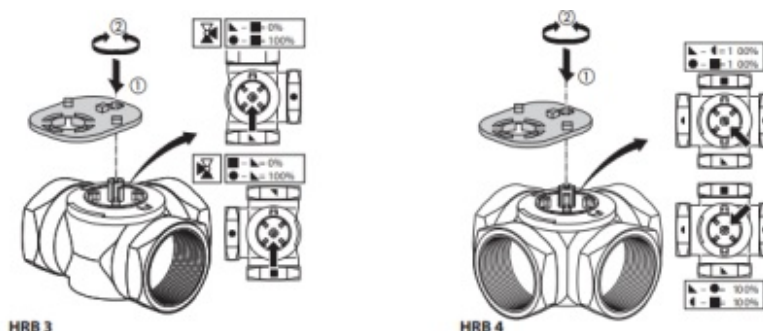

3

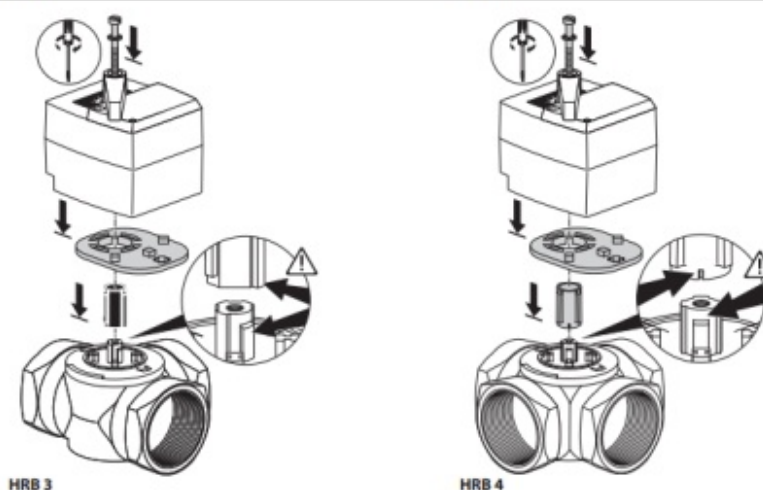

4

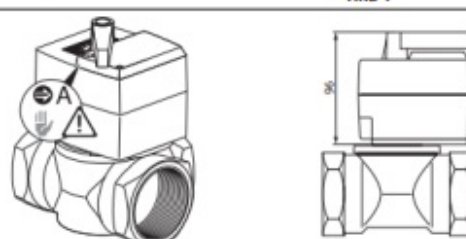

Danfoss reserves the right to alter its products without notice.

This also applies to products already on order provided that such alterations can be made without subsequential changes being necessary in specifications already agreed.

All trademarks in this material are property of the respective companies. Danfoss and the Danfoss logotype are trademarks of Danfoss A/S. All rights reserved.



082G4235/VI.LS.A3.00

Produced by Danfoss A/S

© 01/2010

Documents / Resources

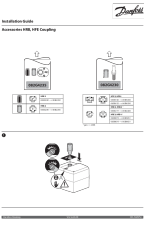
	<p>Danfoss HRB Series Invertwell AC Drives and Controls [pdf] Installation Guide</p> <p>HRB 3 065B2220, HRB 4 065B2240, HFE 3 065B5120, HFE 4 065B5250, HRE 3 065B5019, HRE 4 065B5051, HRB Series Invertwell AC Drives and Controls, HRB Series, Invertwell AC Drives and Controls, AC Drives and Controls, Drives and Controls, Controls</p>
---	--

References

- [User Manual](#)

Manuals+, Privacy Policy

This website is an independent publication and is neither affiliated with nor endorsed by any of the trademark owners. The "Bluetooth®" word mark and logos are registered trademarks owned by Bluetooth SIG, Inc. The "Wi-Fi®" word mark and logos are registered trademarks owned by the Wi-Fi Alliance. Any use of these marks on this website does not imply any affiliation with or endorsement.