



# Danfoss FCP 106 Remote Mounting of LCP Frequency Converter Instruction Manual

[Home](#) » [Danfoss](#) » Danfoss FCP 106 Remote Mounting of LCP Frequency Converter Instruction Manual 

## Contents

- [1 Danfoss FCP 106 Remote Mounting of LCP Frequency Converter](#)
- [2 Product Usage Instructions](#)
- [3 Items Supplied](#)
- [4 More Items Required](#)
- [5 Safety Instructions](#)
- [6 DISCHARGE TIME](#)
- [7 Mechanical Installation](#)
- [8 Electrical Installation for FCP 106 and FCM 106](#)
- [9 FAQ](#)
- [10 Documents / Resources](#)
  - [10.1 References](#)



Danfoss FCP 106 Remote Mounting of LCP Frequency Converter



## Specifications

- Voltage: 3×400 V
- Power range: 4 kW (1 hp)
- Minimum waiting time: 1 minute

## Product Usage Instructions

### Mechanical Installation

1. Fit the gasket on the LCP as shown in Illustration 1.1.
2. Cut out the panel with the dimensions shown in Illustration 1.2.
3. Position the LCP with the gasket onto the panel as shown in Illustration 1.2.
4. Position the bracket on the back of the LCP and slide it down.
5. Fasten the bracket to the LCP using the supplied screws. Tighten to 1.3 Nm.

### Electrical Installation for FCP 106 and FCM 106

**Notice:** Remote mounting of the LCP is intended for setup and maintenance only, not for permanent installation.

1. Connect the LCP cable at the panel as shown in Illustration 1.3.
2. Connect the LCP cable at the frequency converter as shown in Illustration 1.4.

## Items Supplied

- LCP cable, IP54
- Gasket
- Screws
- Mounting plate brackets (2)

## More Items Required

Local control panel (LCP), ordering number 130B1107.

## Safety Instructions

For important information about safety precautions for installation, refer to the VLT® DriveMotor FCP 106/FCM 106 Operating Instructions.

### WARNING

### DISCHARGE TIME

The frequency converter contains DC-link capacitors, which can remain charged even when the frequency converter is not powered. High voltage can be present even when the warning LED indicator lights are off. Failure to wait the specified time after the power has been removed before performing service or repair work can result in death or serious injury.

- Stop the motor.
- Disconnect AC mains and remote DC-link power supplies, including battery back-ups, UPS, and DC-link connections to other frequency converters.
- Disconnect or lock the PM motor.
- Wait for the capacitors to discharge fully. The minimum duration of waiting time is specified in Table 1.1.
- Before performing any service or repair work, use an appropriate voltage-measuring device to make sure that the capacitors are fully discharged.

Voltage [V]	Power range <sup>1)</sup> [kW (hp)]	Minimum waiting time (minutes)
3x400	0.55–7.5 (0.75–10)	4

### Discharge Time

1) Power ratings relate to normal overload (NO), see VLT® DriveMotor FCP 106/FCM 106 Operating Instructions.

## Mechanical Installation

1. Fit gasket on LCP, see Illustration 1.1.

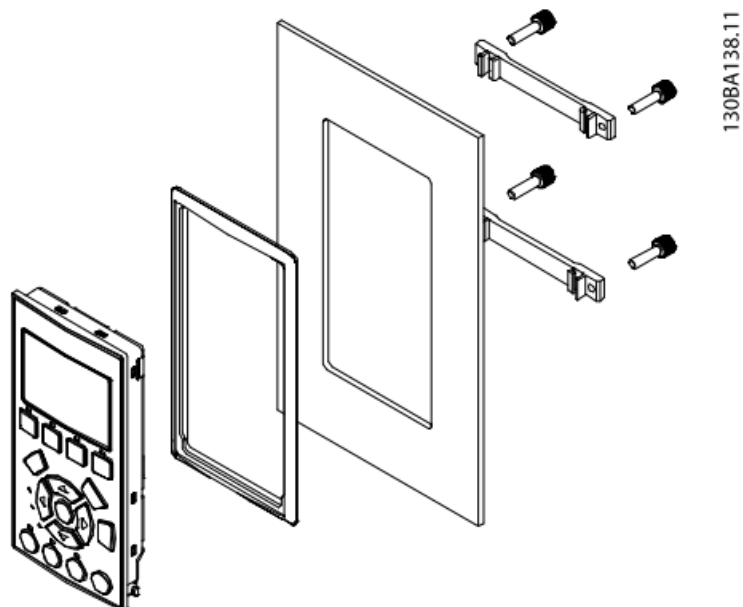

**Illustration 1.1 Fit Gasket on LCP**

2. Cut out the panel with the dimensions shown in Illustration 1.2.
3. Position LCP with gasket onto the panel as shown in Illustration 1.2.

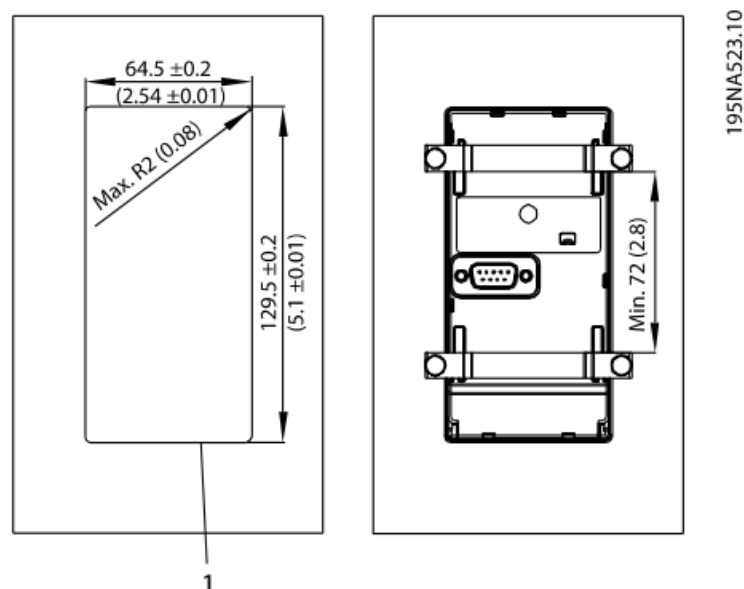

1	Panel cut out.
---	----------------

**Illustration 1.2 Mounting of LCP on Panel**

4. Position the bracket on the back of the LCP, then slide down.
5. Fasten the bracket to the LCP using the screws supplied. Tightening torque is 1.3 Nm.

## Electrical Installation for FCP 106 and FCM 106

### NOTICE

For FCP 106 and FCM 106, remote mounting of the LCP is intended for set-up and maintenance purposes only and is not suited for permanent installation. The LCP cable has ingress protection class IP54 and is not UL listed or UL recognized.

1. Connect LCP cable at the panel as shown in Illustration 1.3.
2. Connect the LCP cable at the frequency converter as shown in Illustration 1.4.

Danfoss can accept no responsibility for possible errors in catalogues, brochures and other printed material. Danfoss reserves the right to alter its products without notice. This also applies to products already on order provided that such alterations can be made without subsequential changes being necessary in specifications already agreed. All trademarks in this material are the property of the respective companies. Danfoss and the Danfoss logotype are trademarks of Danfoss A/S. All rights reserved.

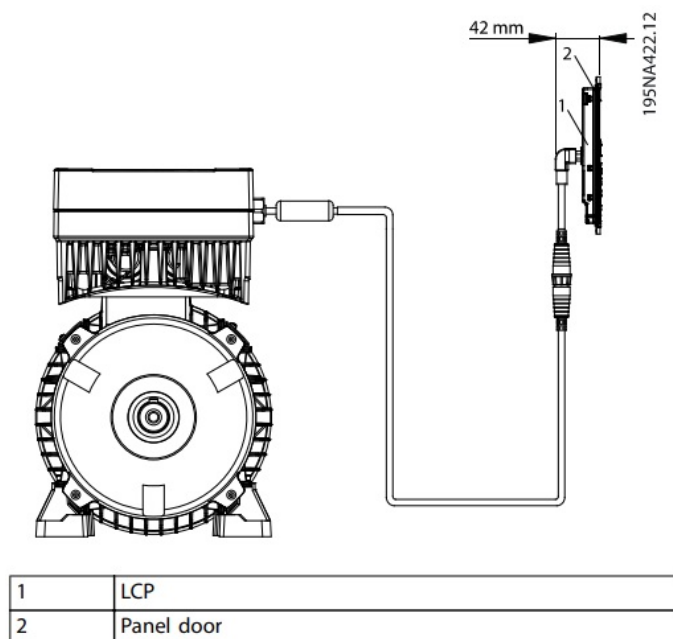

Illustration 1.3 Connection at Panel

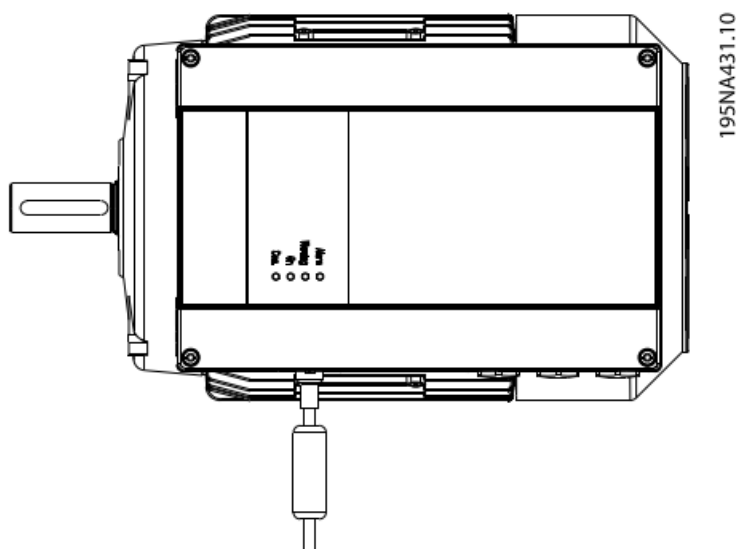

Illustration 1.4 Connection at Frequency Converter

Danfoss A/S Ulsnaes 1  
DK-6300 Graasten  
[vlt-drives.danfoss.com](http://vlt-drives.danfoss.com)

## FAQ

**Q: What is the purpose of the minimum waiting time specified?**

**A:** The minimum waiting time after power removal ensures that the DC-link capacitors are fully discharged to

prevent any risk of electrical shock when performing service or repair work.

**Q: Can the LCP be permanently remote-mounted for FCP 106 and FCM 106?**

**A:** No, remote mounting of the LCP is only intended for temporary setup and maintenance purposes due to its IP54 protection class and lack of UL listing or recognition.

## Documents / Resources

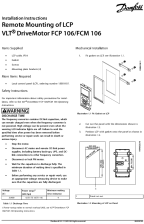
	<p><a href="#">Danfoss FCP 106 Remote Mounting of LCP Frequency Converter [pdf]</a> Instruction Manual FCP 106, FCM 106, FCP 106 Remote Mounting of LCP Frequency Converter, FCP 106, Remote Mounting of LCP Frequency Converter, Mounting of LCP Frequency Converter, Frequency Converter, Converter</p>
-----------------------------------------------------------------------------------	-----------------------------------------------------------------------------------------------------------------------------------------------------------------------------------------------------------------------------------------------------------------------------------------------------------

## References

- [Global AC drive manufacturer - Danfoss Drives | Danfoss](#)
- [User Manual](#)

[Manuals±](#), [Privacy Policy](#)

This website is an independent publication and is neither affiliated with nor endorsed by any of the trademark owners. The "Bluetooth®" word mark and logos are registered trademarks owned by Bluetooth SIG, Inc. The "Wi-Fi®" word mark and logos are registered trademarks owned by the Wi-Fi Alliance. Any use of these marks on this website does not imply any affiliation with or endorsement.