



Danfoss ESMD Temperature Sensor Installation Guide

[Home](#) » [Danfoss](#) » Danfoss ESMD Temperature Sensor Installation Guide

Danfoss ESMD Temperature Sensor
Installation Guide

ENGINEERING
TOMORROW



Installation Guide

ESMD



ESMD

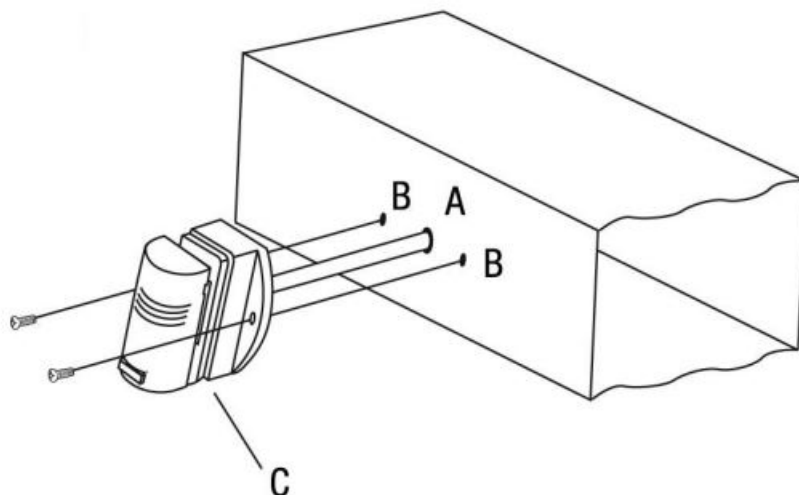

1. Drill a 6.5 mm hole in the middle of the air duct at a place where the temperature sensor is not influenced by stratified air, heat or humidifiers. Place the temperature sensor in the air duct (A).
2. Drill two 4 mm holes through the flange holes (B) of the ESMD. It is recommended to mount the ESMD with the cable inlet facing down. Use two 5 mm self-cutting screws (not delivered) for mounting the ESMD.
3. Make a small hole in the black rubber cable inlet and put the cable through the inlet (C).
Press the orange tabs to connect wires. Polarity not important.
4. Mount white front cover onto the ESMD.

Dimensions

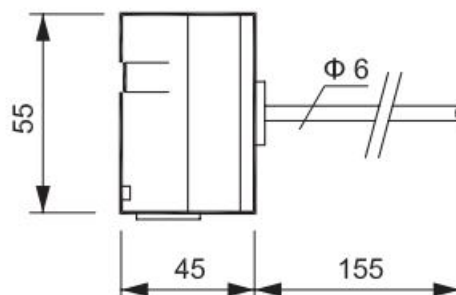
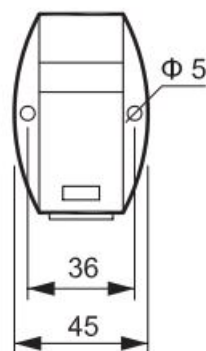
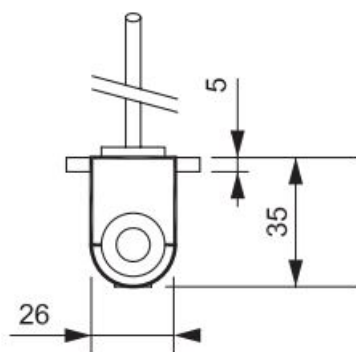

DANFOSS
87H1933,10



ESMD: www.danfoss.com



<https://www.youtube.com/user/DanfossHeating>

-> Playlists -> How-to Videos -> District Energy installation videos



Danfoss A/S

Climate Solutions • danfoss.com • +45 7488 2222

Any information, including, but not limited to information on selection of product, its application or use, product design, weight, dimensions, capacity or any other technical data in product manuals, catalogues descriptions, advertisements, etc. and whether made available in writing, orally, electronically, online or via download, shall be considered informative, and is only binding if and to the extent, explicit reference is made in a quotation or order confirmation. Danfoss cannot accept any responsibility for possible errors in catalogues, brochures, videos and other material. Danfoss reserves the right to alter its products without notice. This also applies to products ordered but not delivered provided that such alterations can be made without changes to form, fit or function of the product.

All trademarks in this material are property of Danfoss A/S or Danfoss group companies. Danfoss and the Danfoss logo are trademarks of Danfoss A/S. All rights reserved.

© Danfoss | DCS-SGDPT/DK | 2021.09

AN39112983089001-000101

Contents [[hide](#)

1 Documents / Resources

1.1 References

2 Related Posts

Documents / Resources

	Danfoss ESMD Temperature Sensor [pdf] Installation Guide ESMD, Temperature Sensor, Sensor, ESMD
	Danfoss ESMD Temperature Sensor [pdf] Installation Guide ESMD Temperature Sensor, ESMD, Temperature Sensor, Sensor

References

-  [Danfoss - Engineering Tomorrow | Danfoss](#)

