



Danfoss DP Control Valve Inserts Installation Guide

[Home](#) » [Danfoss](#) » Danfoss DP Control Valve Inserts Installation Guide 



**ENGINEERING
TOMORROW**

Installation Guide

**dp control valve inserts / 73695790 dp control valve inserts
for VFG 22(221), VFQ 22(221), AFQM 2, AFQMP 2**

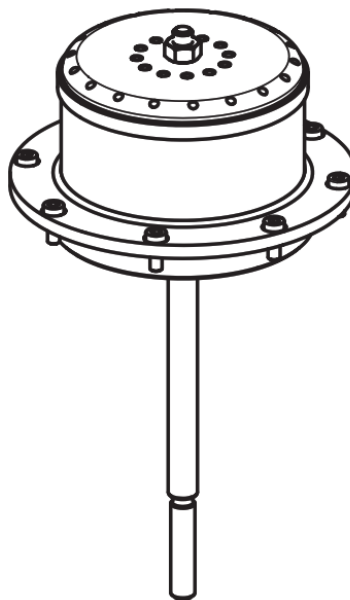

Contents

1 DP Control Valve

Inserts

2 Danfoss A/S

3 Documents / Resources

4 Related Posts

DP Control Valve Inserts

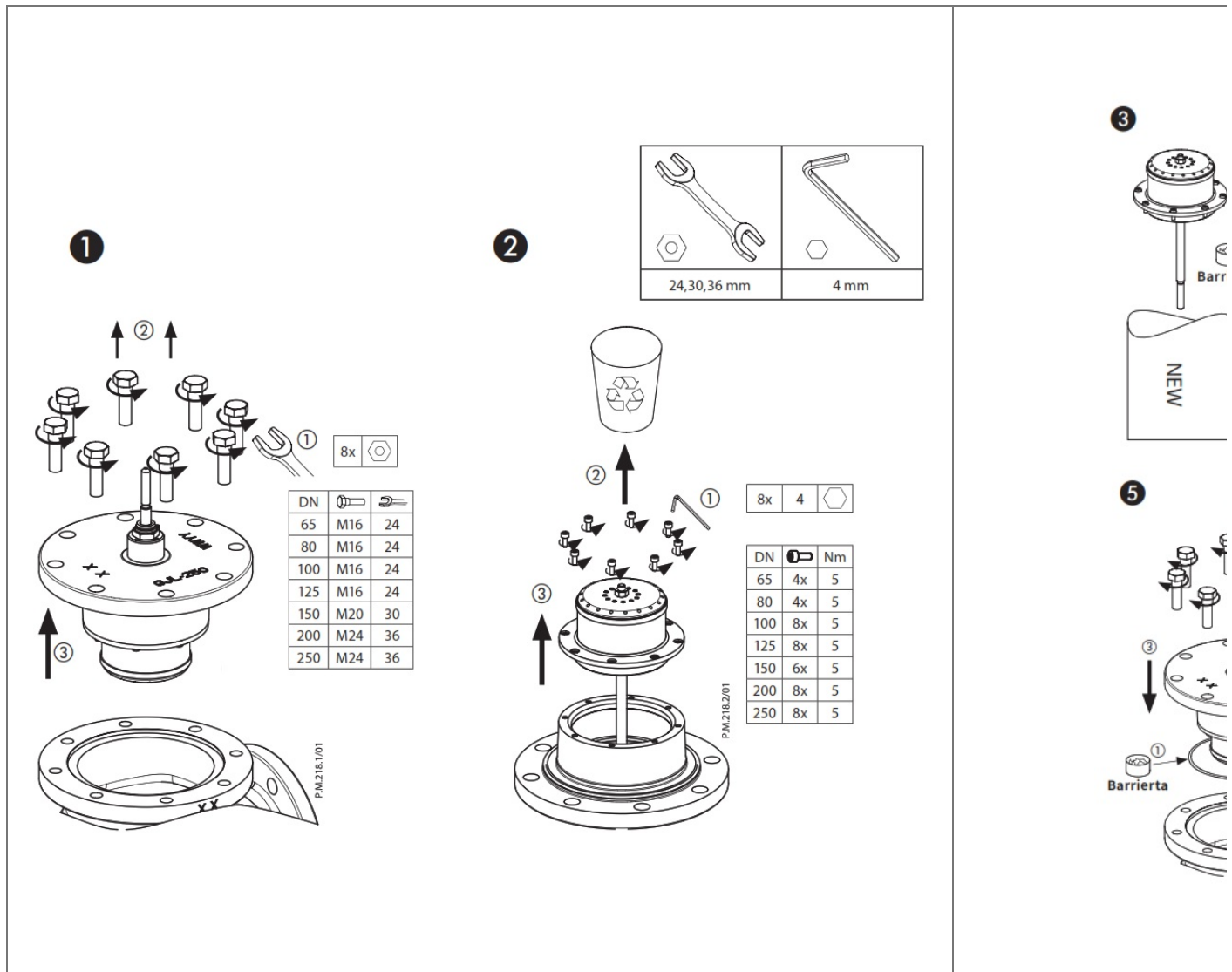

Danfoss A/S

Climate Solutions « danfoss.com + +45 7488 2222 Any information, including, but not limited to information on selection of product, its application or use, product design, weight dimensions, capacity of any other technical data in product manuals, catalogs descriptions, advertisements, etc, and whether made available in writing, orally, electronically, online or via download, shall be considered informative, and is only binding if and to the extent, explicit reference is made in a quotation or order confirmation. Danfoss cannot accept any responsibility for possible errors in catalogs, brochures, videos, and other material. Danfoss reserves the right to alter its products without notice. This also applies to products ordered but not delivered provided that such alterations can be made without changes to the form, fit or junction of the product. All trademarks in this material are property of Danfoss A/S or Danfoss group companies. Danfoss and the Danfoss logo are trademarks of Danfoss A/S. All rights reserved.

Documents / Resources

	<p>Danfoss DP Control Valve Inserts [pdf] Installation Guide</p> <p>DP Control Valve Inserts, DP Control Inserts, Valve Inserts, Control Valve Inserts, Inserts, VFG 22 221, VFQ 22 221, AFQM 2, AFQMP 2</p>
---	--

[Manuals+](#)