



# Danfoss DN15 Balancing Valve Instruction Manual

[Home](#) » [Danfoss](#) » Danfoss DN15 Balancing Valve Instruction Manual 

## Contents

- [1 Danfoss DN15 Balancing Valve](#)
- [2 Product Information](#)
- [3 Fitting](#)
- [4 Frequently Asked Questions](#)
- [5 Documents / Resources](#)
  - [5.1 References](#)
- [6 Related Posts](#)



**Danfoss DN15 Balancing Valve**

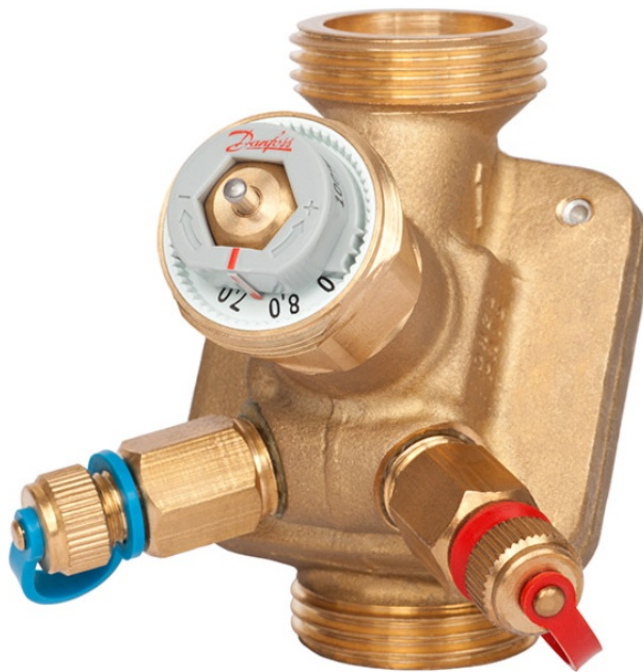

## Product Information

### Specifications

- Model: MSV-BD DN15 – 50
- Pressure Rating: PN 20

### Fitting

Before fitting the valve the installer must ensure that the pipe system is clean and:

1. The valve can be turned 360° if threaded pipe is used.
2. The valve is oriented according to the flow arrow.

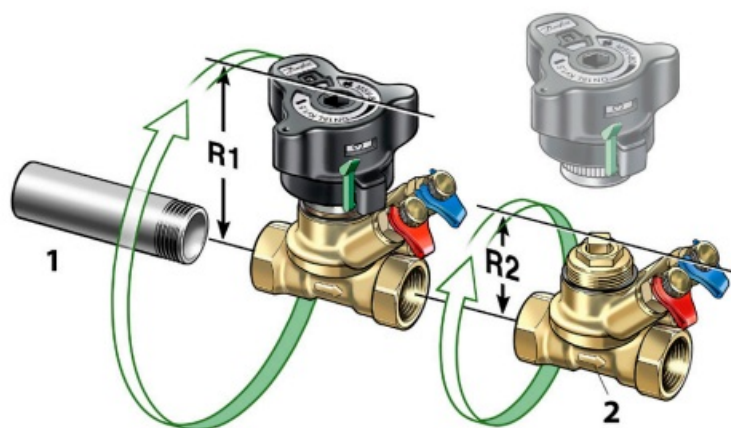

### Removal of handle

1. The union nut become accessible when the green lock is released.
2. Turn scale to 0.0 and unscrew the union nut.

## Calibration

3. Before refitting handle ensure that the setting displays 0.0

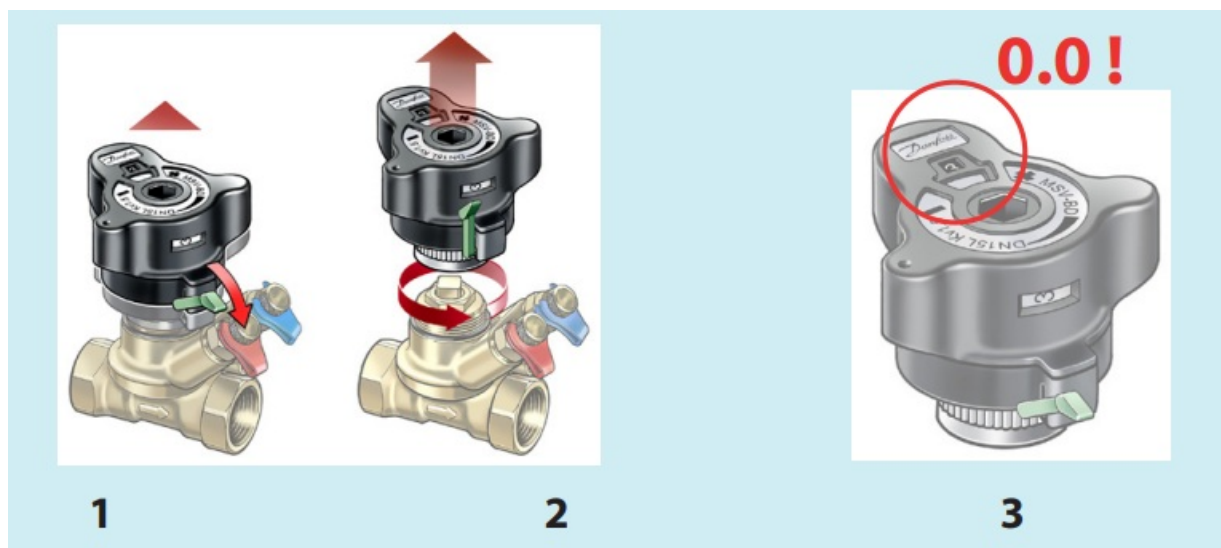

## Open and close

An indicator shows:

- White = open valve
- Red = closed valve

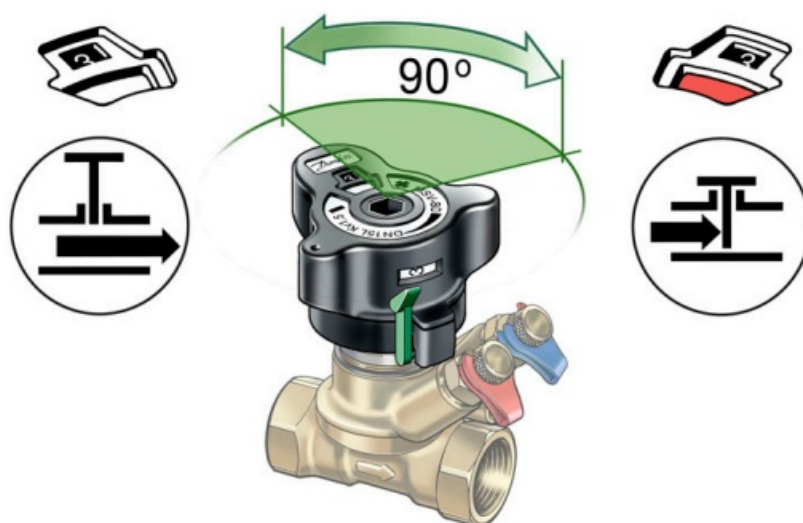

## Setting the flow

1. When valve is open the lock is re-leased. Allen key can also be used.
2. The handle pops up and the required flow may be set. Flow diagrams are found on <http://heating.danfoss.com>
3. Lock the setting by pressing the handle until click.

## Seal

4. The setting may be protected using a sealing strip.

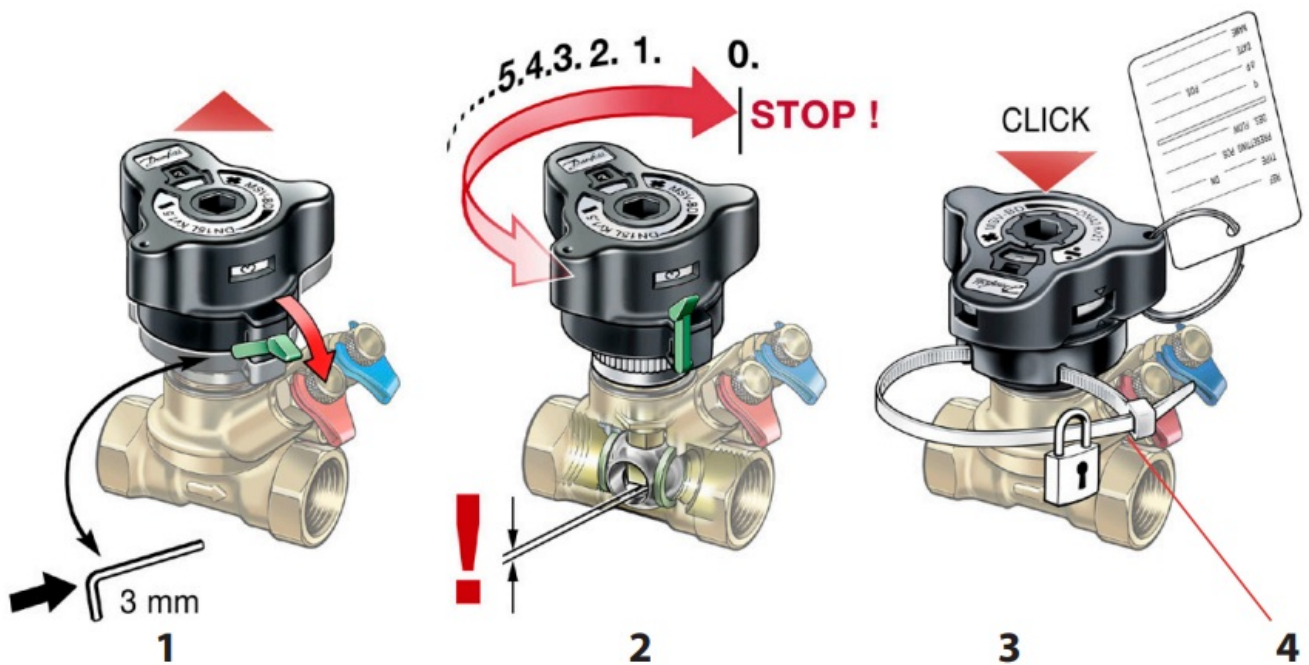

## Drain

- The measuring station can be turned to any position.
- The red test plug drains the inlet side of valve and blue the outlet.
- Max. 3 turns, see illustration.
- The accessory drain connection is to be used to attach a hose.

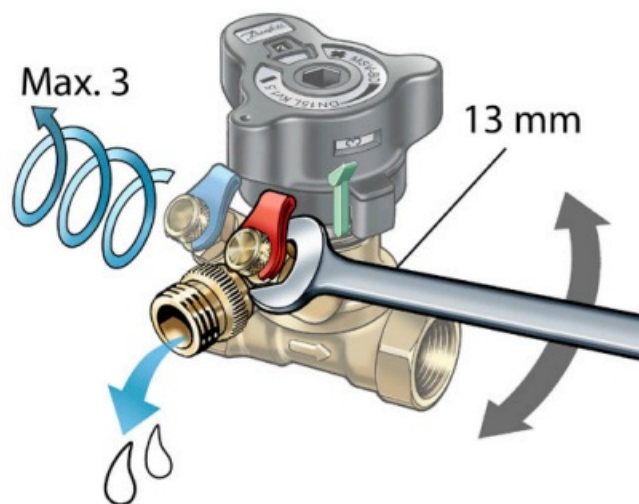

## Frequently Asked Questions



- **How do I know if the valve is open or closed?**  
An indicator displays white for open and red for closed valve positions.
- **Can I use this valve with non-threaded pipes?**  
No, this valve is designed for use with threaded pipes.
- **Where can I find more information on flow adjustments?**  
Refer to the flow diagrams available on <http://heating.danfoss.com> for assistance with setting the flow.

## Documents / Resources



[Danfoss DN15 Balancing Valve](#) [pdf] Instruction Manual  
DN15 - 50, PN 20, 04080, 80, 168, DN15 Balancing Valve, DN15, Balancing Valve, Valve

## References

-  [Engineering Tomorrow | Danfoss](#)
-  [Danfoss Climate Solutions for heating | Efficient solutions for superior comfort | Danfoss](#)
-  [Pagrindinis puslapis | Danfoss](#)
- [User Manual](#)

[Manuals+](#), [Privacy Policy](#)

This website is an independent publication and is neither affiliated with nor endorsed by any of the trademark owners. The "Bluetooth®" word mark and logos are registered trademarks owned by Bluetooth SIG, Inc. The "Wi-Fi®" word mark and logos are registered trademarks owned by the Wi-Fi Alliance. Any use of these marks on this website does not imply any affiliation with or endorsement.