



Danfoss DN 15 Change Over 6 Flexo User Guide

[Home](#) » [Danfoss](#) » Danfoss DN 15 Change Over 6 Flexo User Guide 



ENGINEERING
TOMORROW
Operating Guide
AB-QM 4.0 ChangeOver6 Flexo
DN 15, PN16

Contents

- [1 DN 15 Change Over 6 Flexo](#)
- [2 Recommended installing position](#)
- [3 Installation](#)
- [4 Sizing](#)
- [5 Documents / Resources](#)
 - [5.1 References](#)

DN 15 Change Over 6 Flexo



<https://assets.danfoss.com/documents/402876/41477237908752en-010102.pdf>

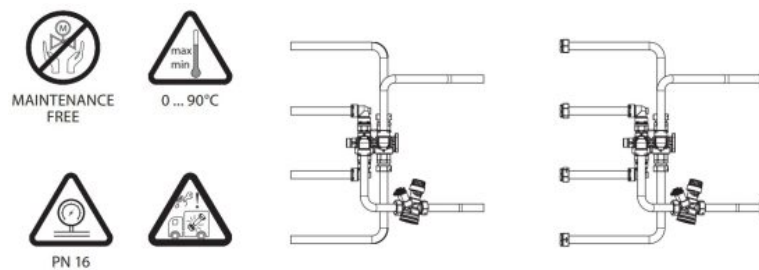

Recommended installing position

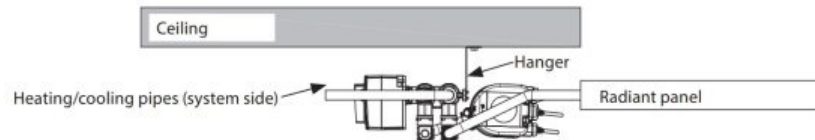

The recommended installing position is as shown in the picture. Hairpins from factory setting are inserted based on this position.

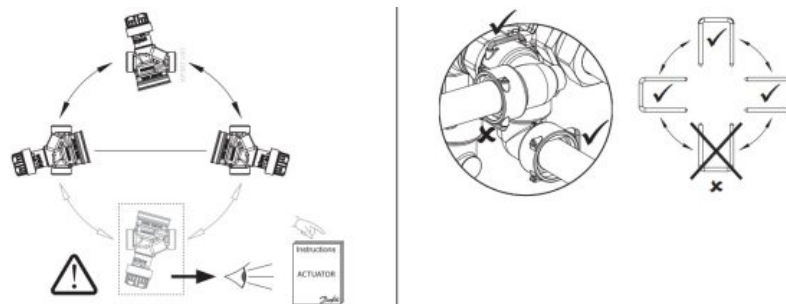

In any installed position of the set, assure that hairpins must be inserted sideways or from top to bottom (do not insert the hairpins from bottom side of click fits).

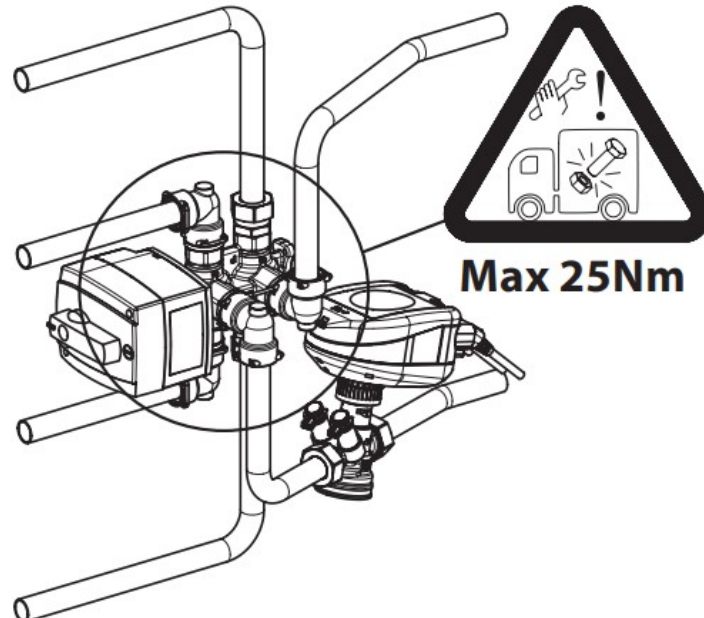

All the connections, fittings and hairpins must be re-tightened after transportation.

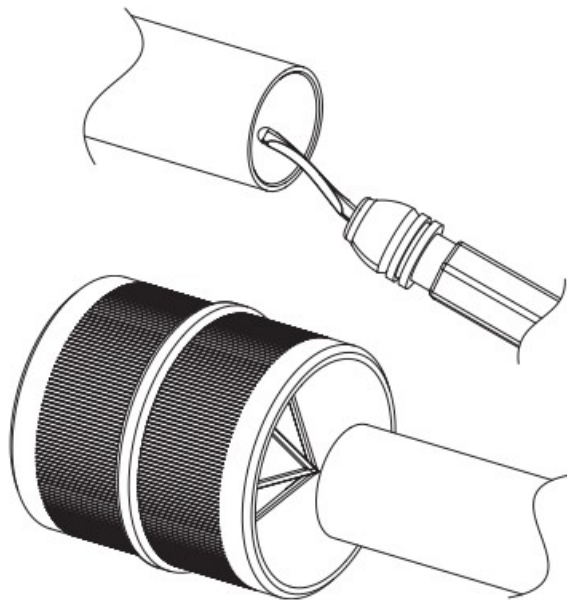

For the 18mm straight pipe variant, deburring must be done by customer before installation and it must be ensured that metal chips do not get into the pipe system.

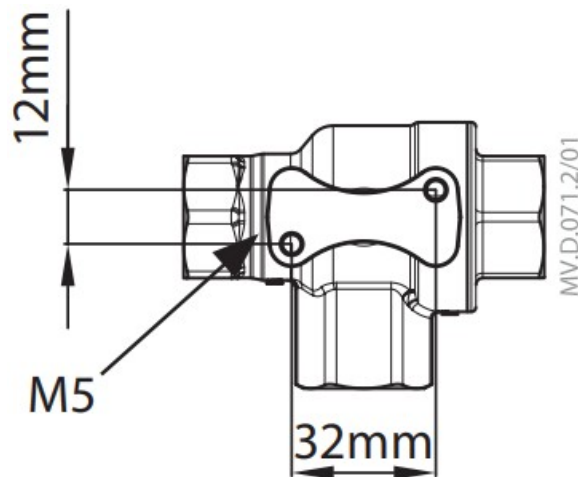

The AB-QM 4.0 CO6 Flexo Set valve must be properly supported. The holes with M5 thread at ChangeOver6 valve can be used for fixing/hanging.

Installation



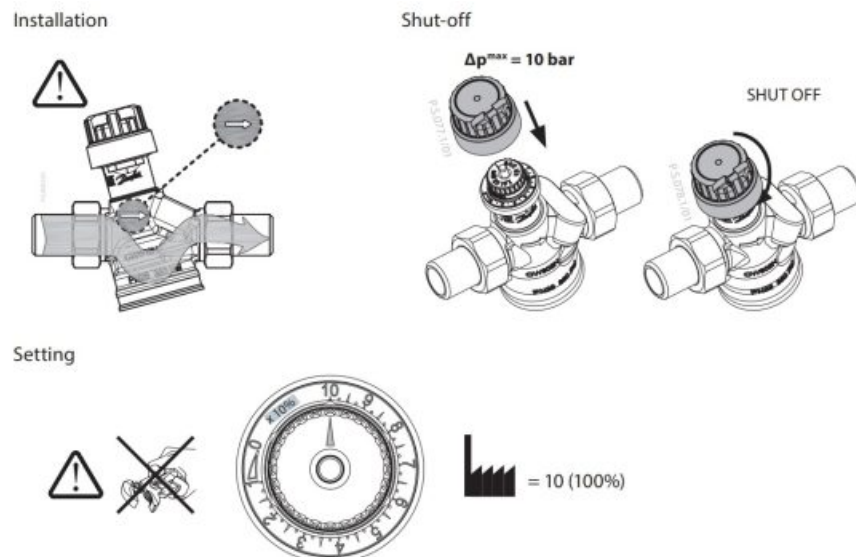

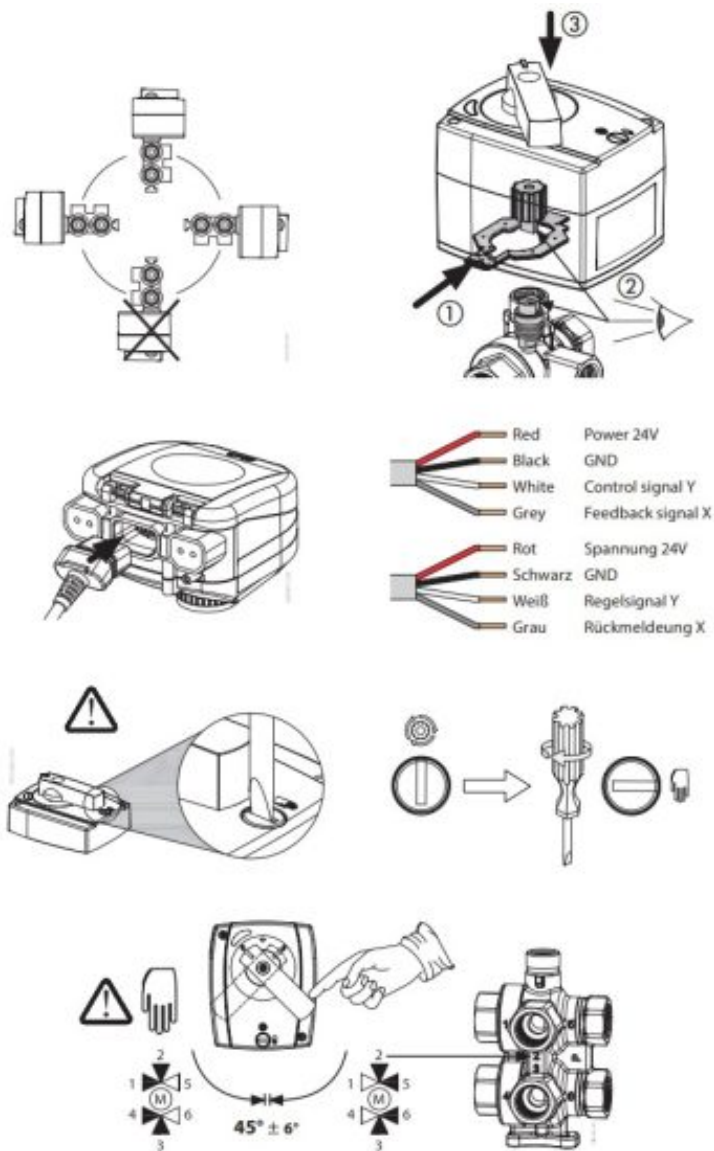
⚠ Ensure the system can compensate for thermal expansion in the pipes without deformation or twisting of the set.



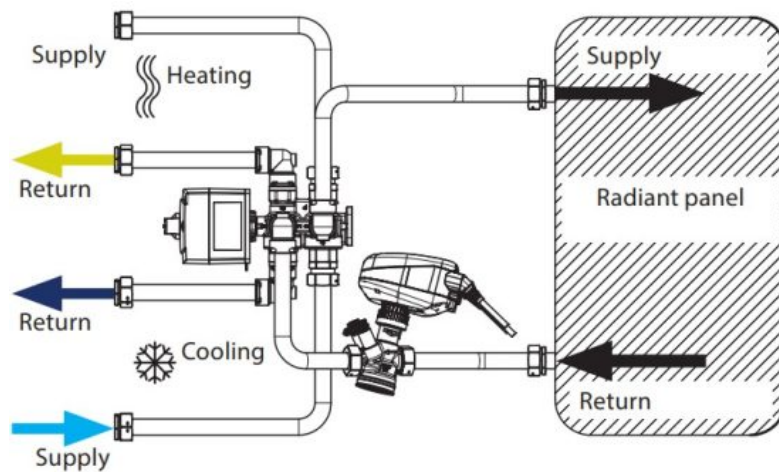

The 6 ports of the ChangeOver6 valve allow the following flow directions.



	Control Signal from NovoCon: Cooling
	Port 1 to port 2 and port 3 to port 4
	Control Signal from NovoCon: Heating
	Port 5 to port 2 and port 3 to port 6
	Heating or cooling distribution pipes
	Ports 7,4, 5 and 6
	Terminal unit pipes
	Ports 2 and 3

Sizing

Setting	DN15 LF			DN 15		
	L/h	L/s	GPM	L/h	L/s	GPM
10%	20	0.006	0.09	65	0.018	0.29
15%	30	0.008	0.13	98	0.027	0.43
20%	40	0.011	0.18	130	0.036	0.57
25%	50	0.014	0.22	163	0.045	0.72
30%	60	0.017	0.26	195	0.054	0.86
35%	70	0.019	0.31	228	0.063	1.00
40%	80	0.022	0.35	260	0.072	1.14
45%	90	0.025	0.40	293	0.081	1.29
50%	100	0.028	0.44	325	0.090	1.43
55%	110	0.031	0.48	358	0.099	1.57
60%	120	0.033	0.53	390	0.108	1.72
65%	130	0.036	0.57	423	0.117	1.86
70%	140	0.039	0.62	455	0.126	2.00
75%	150	0.042	0.66	488	0.135	2.15
80%	160	0.044	0.70	520	0.144	2.29
85%	170	0.047	0.75	553	0.154	2.43
90%	180	0.050	0.79	585	0.163	2.58
95%	190	0.053	0.84	618	0.172	2.72
100%	200	0.056	0.88	650	0.181	2.86

Operating Guide
NovoCon® S

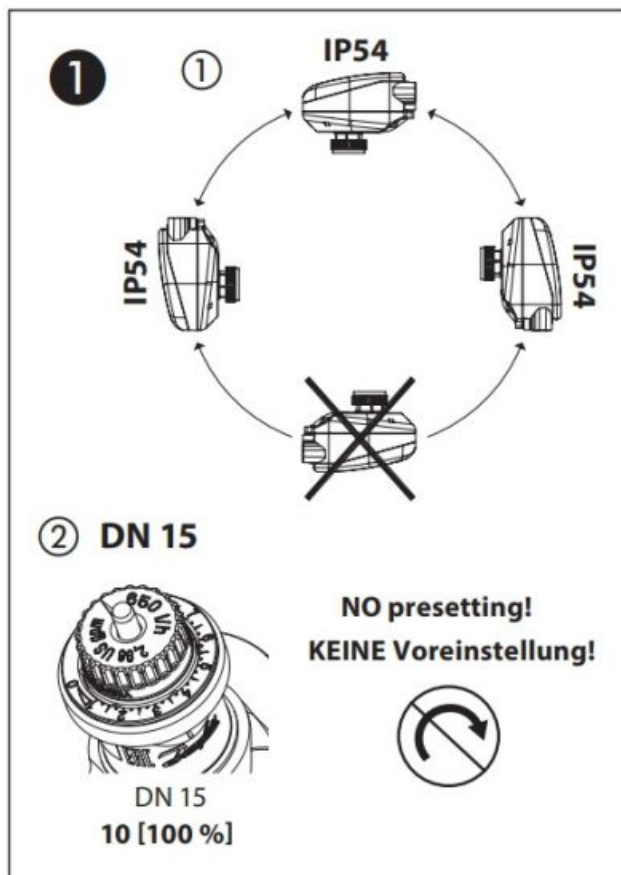

When using NovoCon S – no presetting of AB-QM 4.0 valve is needed.

Danfoss A/S

Climate Solutions danfoss.com +45 7488 2222

Any information, including, but not limited to information on selection of product, its application or use, product design, weight, dimensions, capacity or any other technical data in product manuals, catalogues descriptions, advertisements, etc. and whether made available in writing, orally, electronically, online or via download, shall be considered informative, and is only binding if and to the extent, explicit reference is made in a quotation or order confirmation. Danfoss cannot accept any responsibility for possible errors in catalogues, brochures, videos and other material.

Danfoss reserves the right to alter its products without notice. This also applies to products ordered but not delivered provided that such alterations can be made without changes to form, fit or function of the product.

All trademarks in this material are property of Danfoss A/S or Danfoss group companies. Danfoss and the Danfoss logo are trademarks of Danfoss A/S. All rights reserved. 4| Danfoss

Danfoss

DCS-SGDPT/SI | 2024.07
AQ477249281762en-010102

Documents / Resources

	<p>Danfoss DN 15 Change Over 6 Flexo [pdf] User Guide</p> <p>4.0, DN 15, DN 15 Change Over 6 Flexo, DN 15, Change Over 6 Flexo, Over 6 Flexo, 6 Flexo, Flexo</p>
--	--

References

- [User Manual](#)

Manuals+, Privacy Policy

This website is an independent publication and is neither affiliated with nor endorsed by any of the trademark owners. The "Bluetooth®" word mark and logos are registered trademarks owned by Bluetooth SIG, Inc. The "Wi-Fi®" word mark and logos are registered trademarks owned by the Wi-Fi Alliance. Any use of these marks on this website does not imply any affiliation with or endorsement.