

AVTI Multifunctional
Self Acting Controller



Danfoss AVTI Multifunctional Self Acting Controller Instructions

[Home](#) » [Danfoss](#) » Danfoss AVTI Multifunctional Self Acting Controller Instructions 

Contents

- [1 Danfoss AVTI Multifunctional Self Acting Controller](#)
- [2 Module adaption](#)
- [3 Heat exchanger position](#)
- [4 Connection](#)
- [5 Sensor mounting](#)
- [6 Temperature setting](#)
- [7 Dimensions](#)
- [8 Frequently Asked Questions](#)
- [9 Documents / Resources](#)
 - [9.1 References](#)
- [10 Related Posts](#)



Danfoss AVTI Multifunctional Self Acting Controller



AVTI is a combined controller developed for controlling small heat units with a room heating system and a heat exchanger with instantaneous hot service water system. To ensure proper function of the AVTI the supply temperature has to be about 10 oC higher than the set temperature of the domestic hot water.



- DCW – Cold water
- DHW – Domestic hot water
- DHS – District heating supply
- DHR – District heating return
- HS – Heating system supply

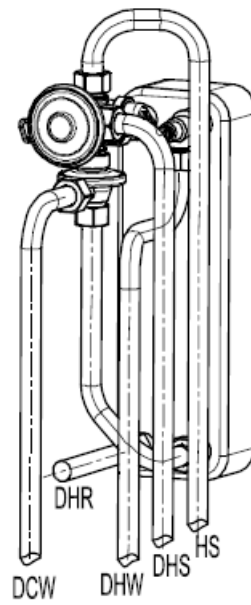

1. *Thermostatic valve*
2. *Differential pressure controller*
3. *Proportional actuator*
4. *Sensor*

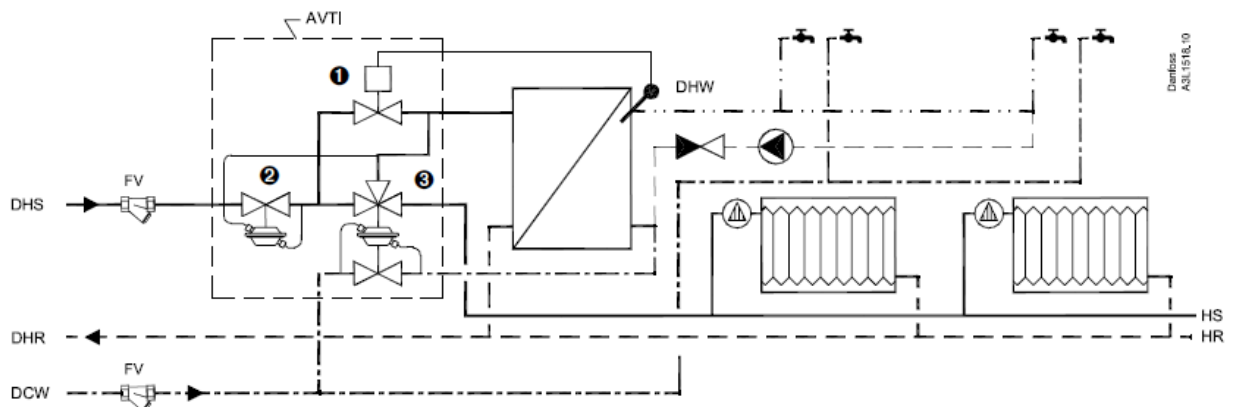
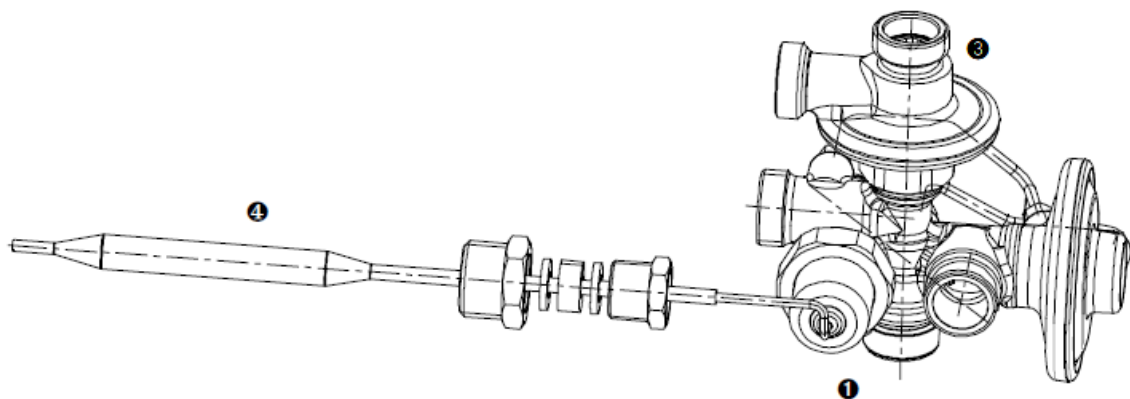

Module adaption

Proportional actuator modul ② can be rotated for 360° with releasing the nut

1. After changing the position, tighten of the nut with 15 Nm ③.

Heat exchanger position

- 4 pass plate heat exchanger
- 5 passes plate heat exchanger

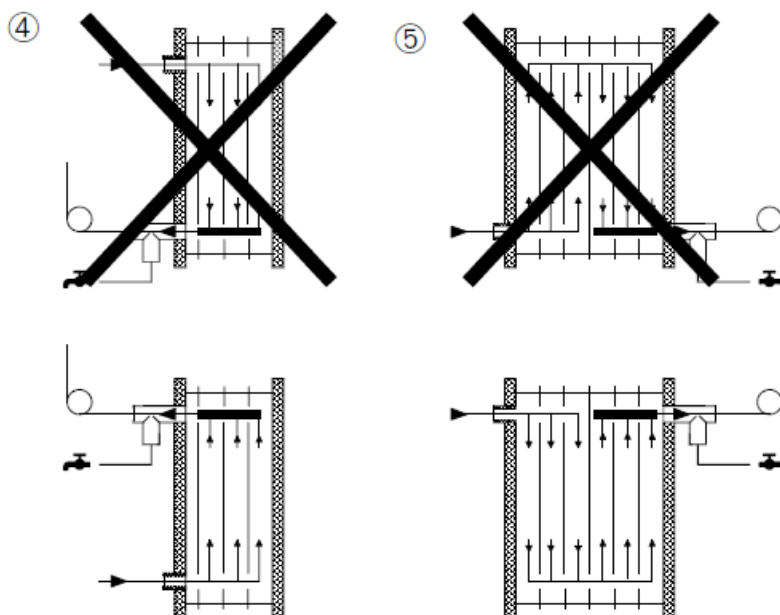
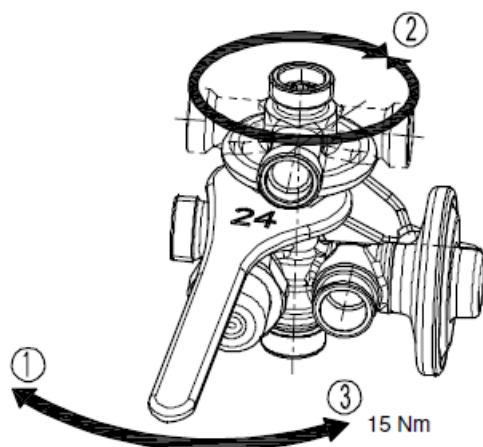

Connection

All connections must be aligned so, that stress free mounting of the controller is possible. Avoid excessive use of force when mounting the controller. For a proper functioning of the AVTI it is recommended to use filter in the system according to the system drawing.

Connecting AVTI to the system

Connect AVTI to the heating supply system

- 1 ②③ first, afterwards

- 4 ⑤ to the secondary system.

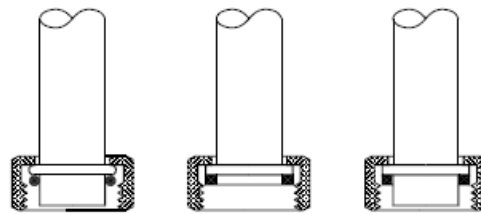
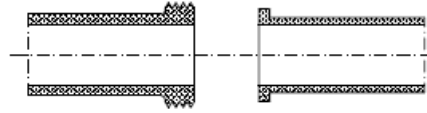
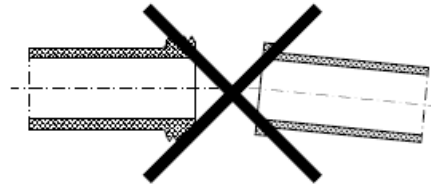

1. Primary inlet in the heat exchanger
2. To room heating system
3. From primary heating system
4. Secondary inlet in the heat exchanger
5. Cold service water supply

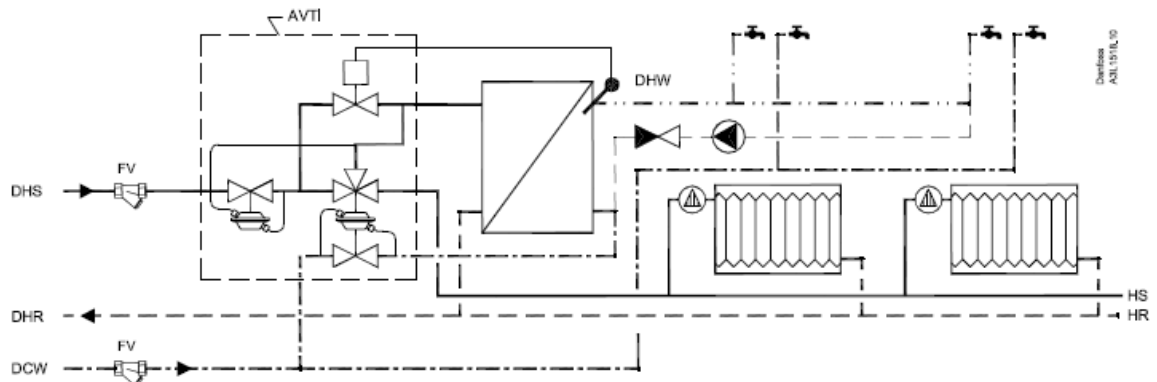
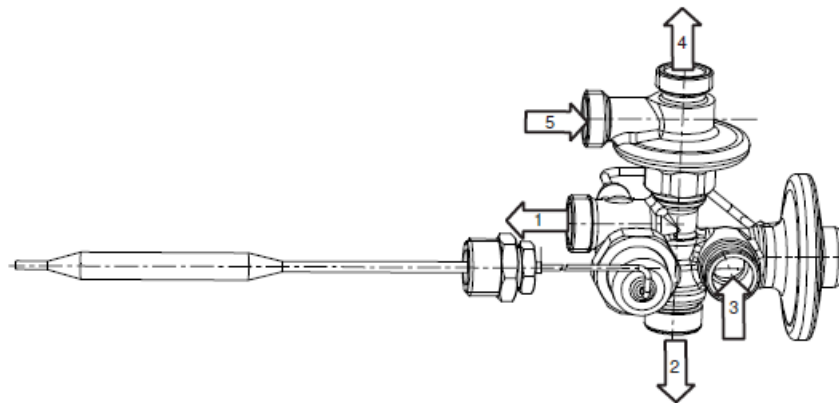

Sensor mounting

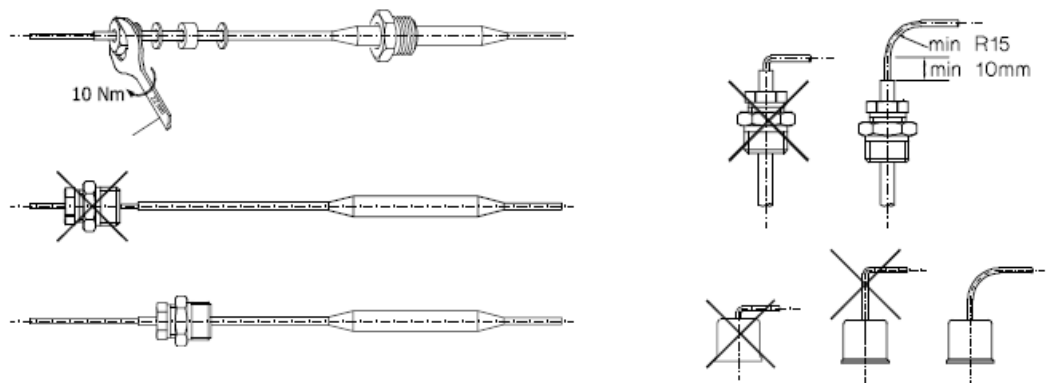

Sensor replacement

The station must be cooled down before dismounting the sensor from valve.

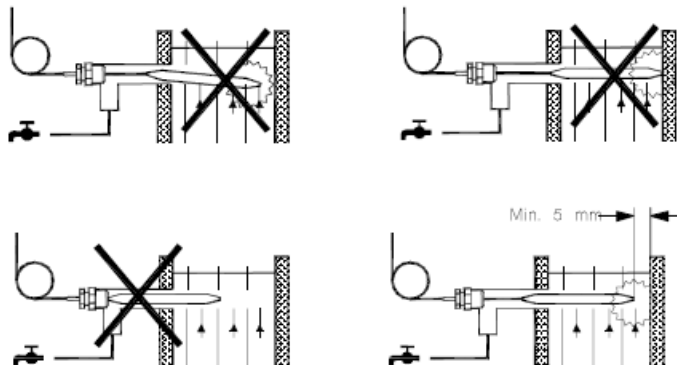
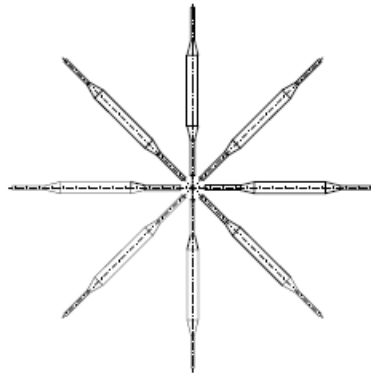

Removing the bellow element

1. *Press bellow housing to the valve*
2. Unscrew the nut

Mounting the bellow element

- ④ Press bellow housing to the valve
- ⑤ Tighten the nut (10 Nm)



①



②



③



④



⑤

Temperature setting

- AVTI-LT 45 – 55 °C
- AVTI-HT 60 – 65 °C

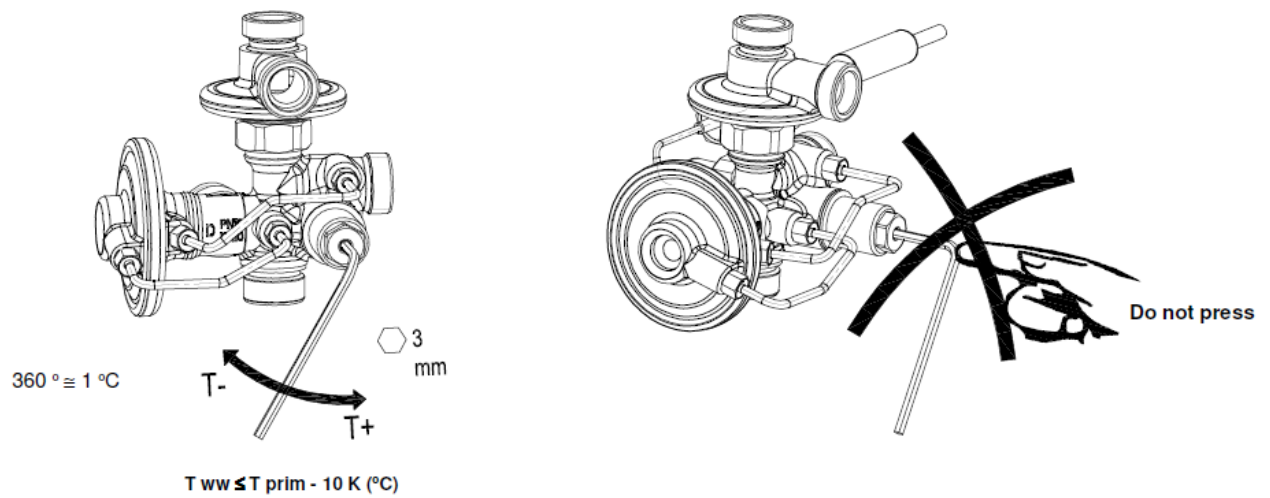

Pressure test

- Max. testing pressure = 16 bar

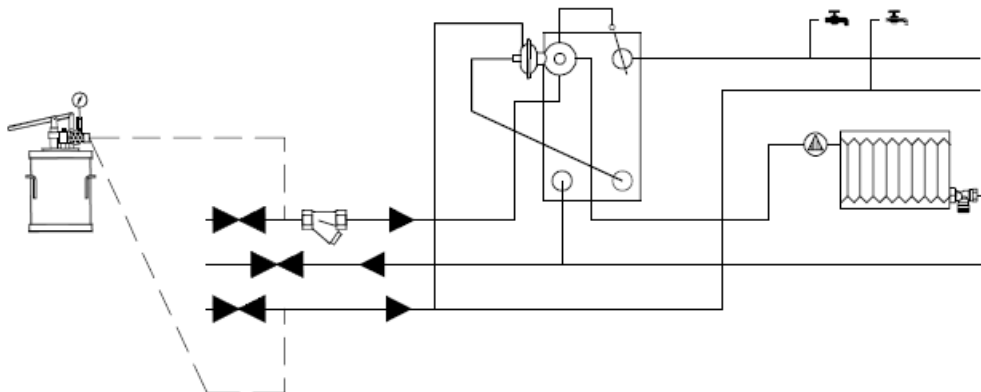

Dimensions

- DCW – Cold water
- DHS – District heating supply
- HS – Heating system supply
- HE – Heat exchanger

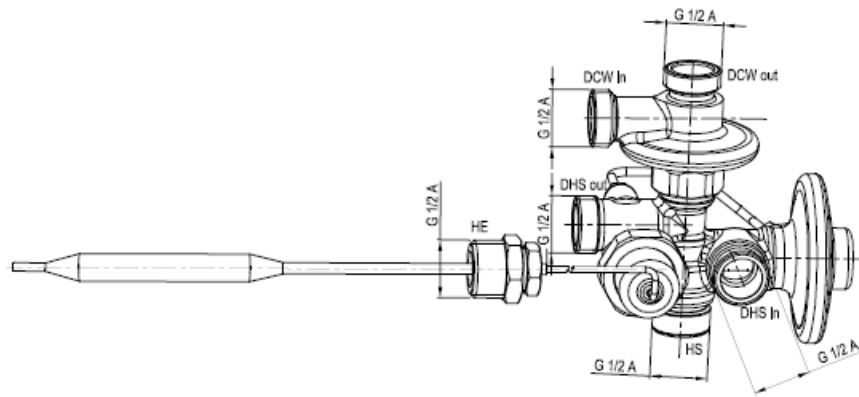

Frequently Asked Questions

- **Q: What is the recommended supply temperature for AVTI?**

A: The supply temperature should be approximately 10°C higher than the set temperature for domestic hot water.

- **Q: How should I adjust the proportional actuator module?**

A: Loosen the nut to rotate the module 360° and then tighten it with 15 Nm torque after changing its position.

- **Q: What type of heat exchanger should I use with AVTI?**

A: Depending on your system, choose between a 1-pass plate heat exchanger or a 2-pass plate heat exchanger.

Documents / Resources

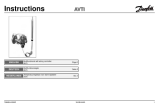
	<p>Danfoss AVTI Multifunctional Self Acting Controller [pdf] Instructions AQ00008644593501-010401, 7369054-0, VI.GB.H4.6G, AVTI Multifunctional Self Acting Controller, AVTI, Multifunctional Self Acting Controller, Self Acting Controller, Acting Controller</p>
---	--

References

- [User Manual](#)

[Manuals+](#), [Privacy Policy](#)

This website is an independent publication and is neither affiliated with nor endorsed by any of the trademark owners. The "Bluetooth®" word mark and logos are registered trademarks owned by Bluetooth SIG, Inc. The "Wi-Fi®" word mark and logos are registered trademarks owned by the Wi-Fi Alliance. Any use of these marks on this website does not imply any affiliation with or endorsement.