

## Danfoss AME 685 Steam Heater Installation Guide

[Home](#) » [Danfoss](#) » Danfoss AME 685 Steam Heater Installation Guide 

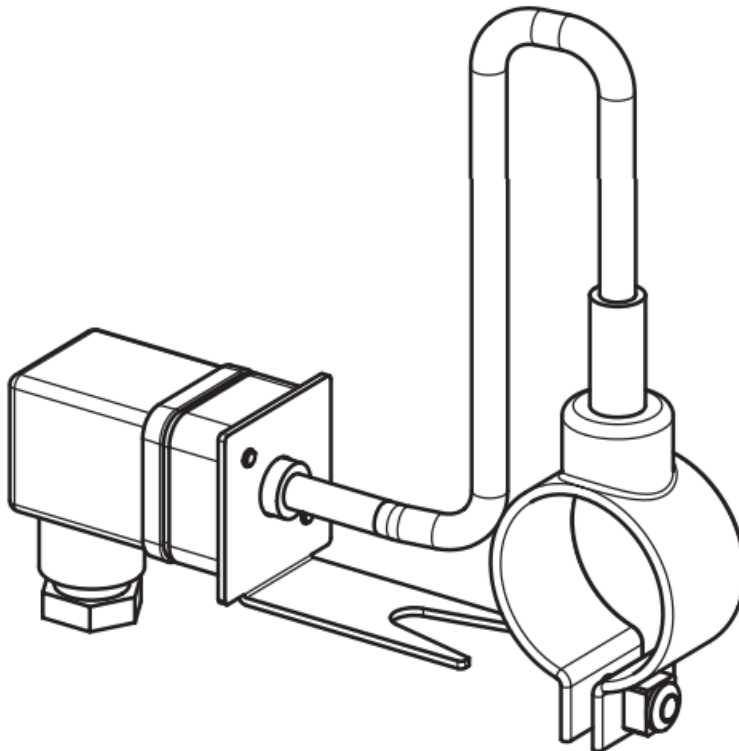









### Danfoss AME 685 Steam Heater



**Contents**

- 1 Tools
- 2 Installation Instruction
- 3 Customer Support
- 4 Documents / Resources
  - 4.1 References
- 5 Related Posts

**Tools**

	
	 4 mm
	 17 mm
	 18 mm
	 19 mm

**Installation Instruction**

AMV(E) 85/86 & VFS 2 DN 65-100, VF 2/3 DN 125-150

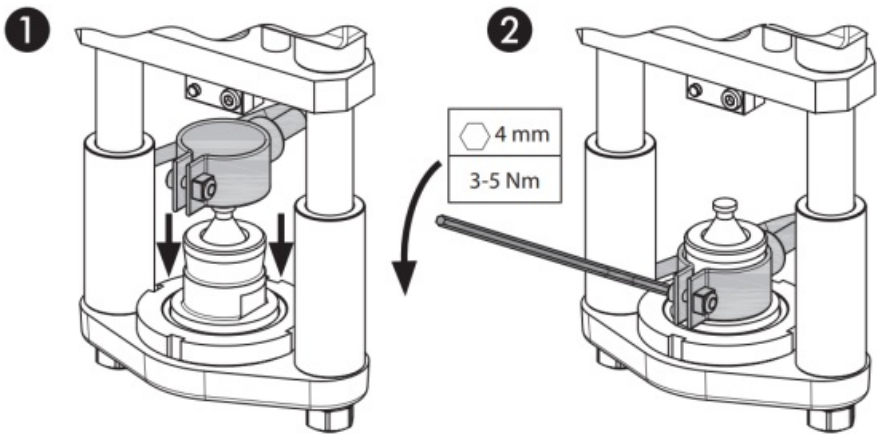

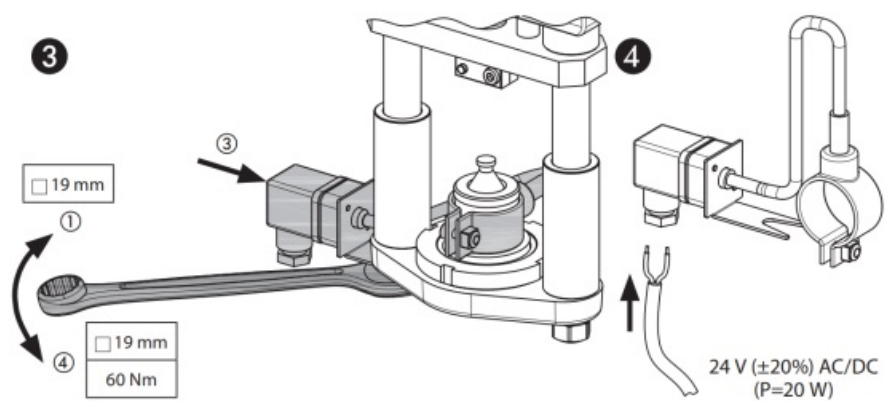

### AME 685 & VF3 DN 200-300

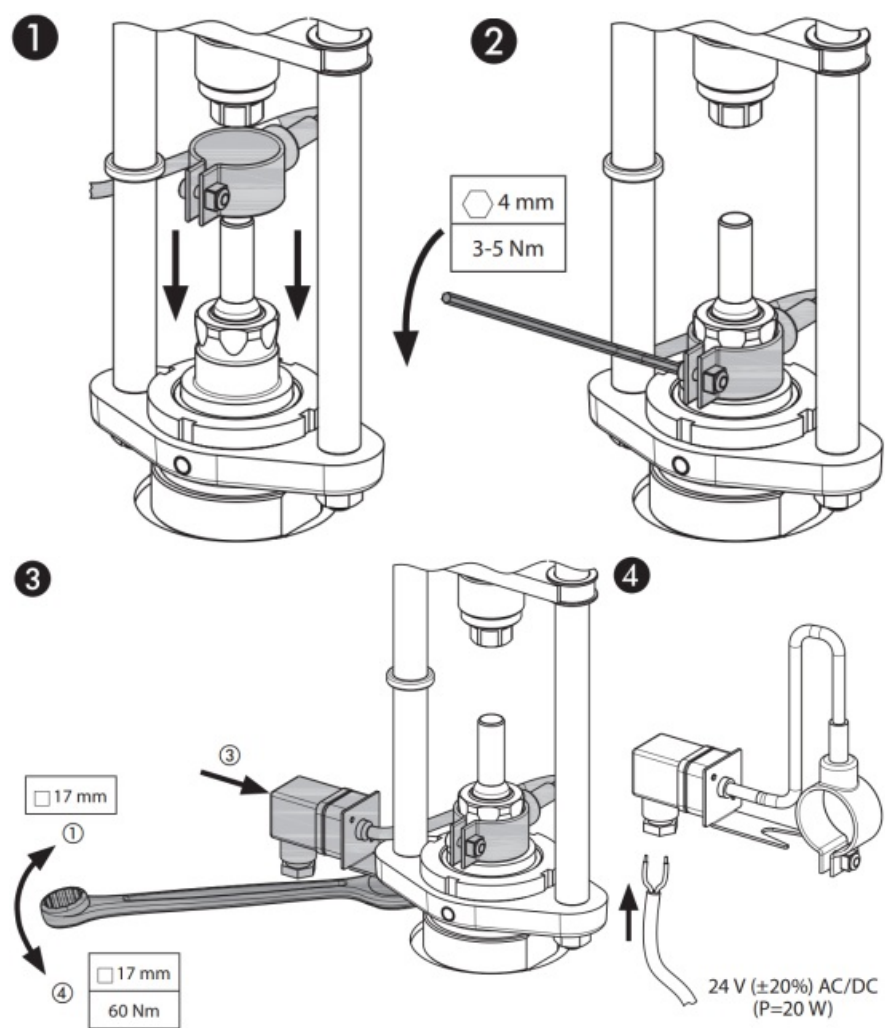

### AME 855 & VF3 DN 200-300

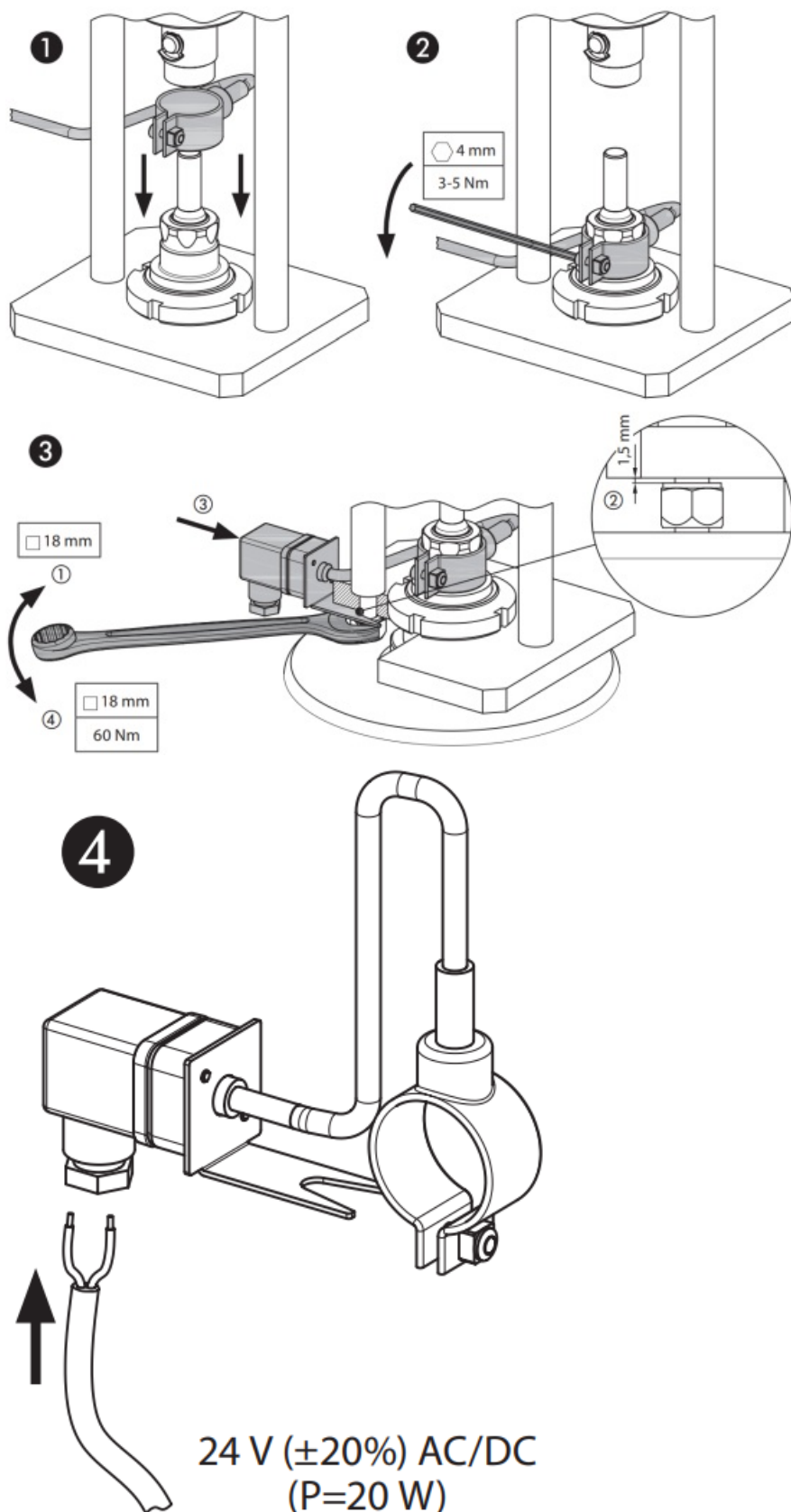

## Customer Support

### Danfoss A/S

Heating Segment [danfoss.com](http://danfoss.com) +45 7488 2222 E-Mail: [heating@danfoss.com](mailto:heating@danfoss.com)

Danfoss can accept no responsibility for possible errors in catalogues, brochures and other printed material. Danfoss reserves the right to alter its products without notice. This also applies to products already on order provided that such alterations can be made without subsequential changes being necessary in specifications already agreed. All trademarks in this material are property of the respective companies. Danfoss and all Danfoss logotypes are trademarks of Danfoss A/S. All rights reserved.



## Documents / Resources

A technical diagram from the Danfoss AME 685 Steam Heater installation guide. It shows a cross-section of the heater unit with various components labeled, including the steam inlet, water inlet, and electrical connections. The diagram is part of a larger document titled "Installation Guide Steam heater - AMV/E 85/86, AME 685/855".	<p><a href="#">Danfoss AME 685 Steam Heater</a> [pdf] Installation Guide AMV E 85-86, AME 685, AME 855, AME 685 Steam Heater, AME 685, Steam Heater, Heater</p>
----------------------------------------------------------------------------------------------------------------------------------------------------------------------------------------------------------------------------------------------------------------------------------------------------------------------------------------------	---------------------------------------------------------------------------------------------------------------------------------------------------------------------

## References

- [User Manual](#)

### Manuals+. Privacy Policy

This website is an independent publication and is neither affiliated with nor endorsed by any of the trademark owners. The "Bluetooth®" word mark and logos are registered trademarks owned by Bluetooth SIG, Inc. The "Wi-Fi®" word mark and logos are registered trademarks owned by the Wi-Fi Alliance. Any use of these marks on this website does not imply any affiliation with or endorsement.