



Danfoss AK-SM 820 System Manager Instructions

[Home](#) » [Danfoss](#) » Danfoss AK-SM 820 System Manager Instructions 

Danfoss AK-SM 820 System Manager Instructions



Contents

- [1 General mounting](#)
- [2 US mounting](#)
- [3 Documents / Resources](#)
 - [3.1 References](#)
- [4 Related Posts](#)

General mounting

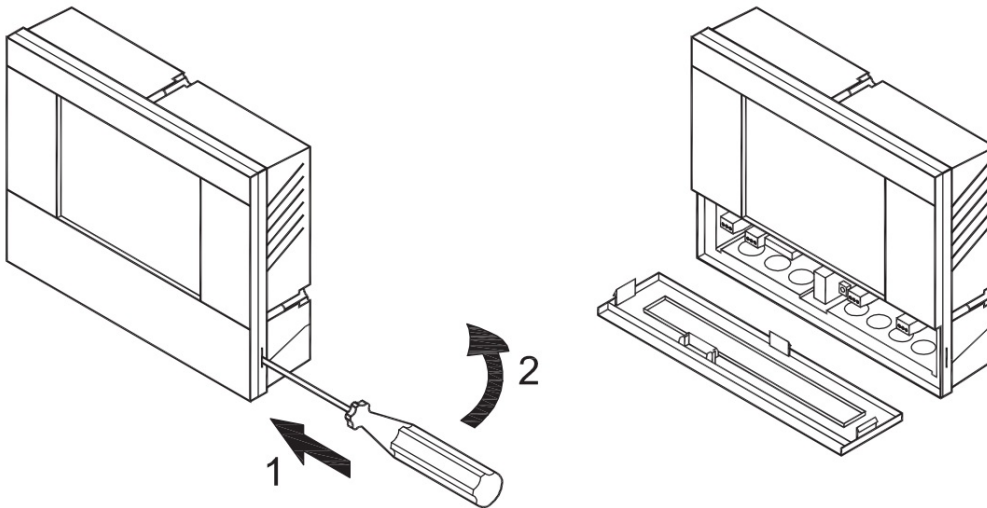

-10° < t_{amb} < 55°C° 14°F
 < t_{amb} < 130° F0 – 95%
 RH, non condensing IP 20

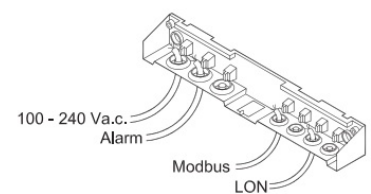
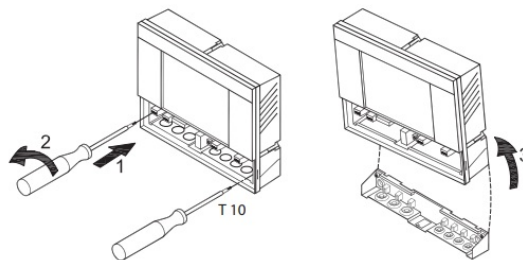
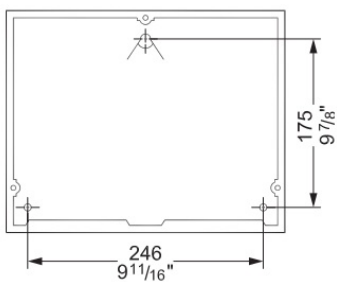
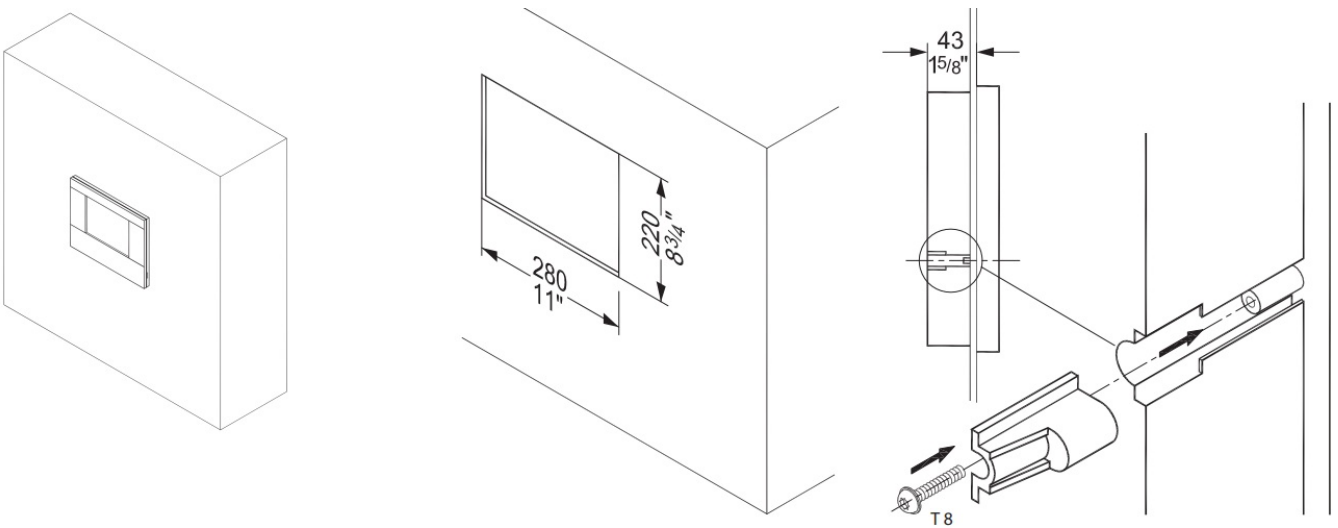

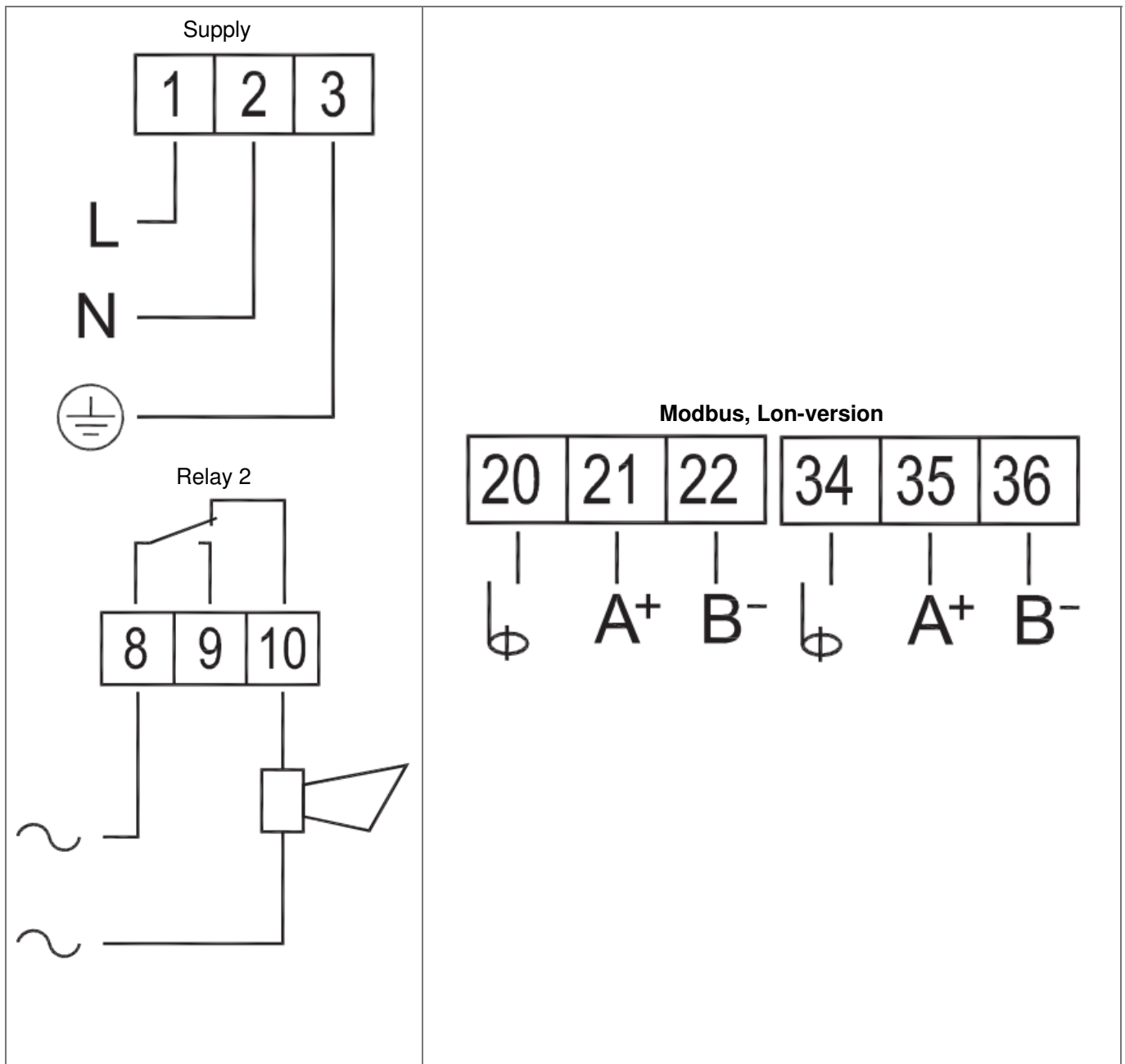

US mounting

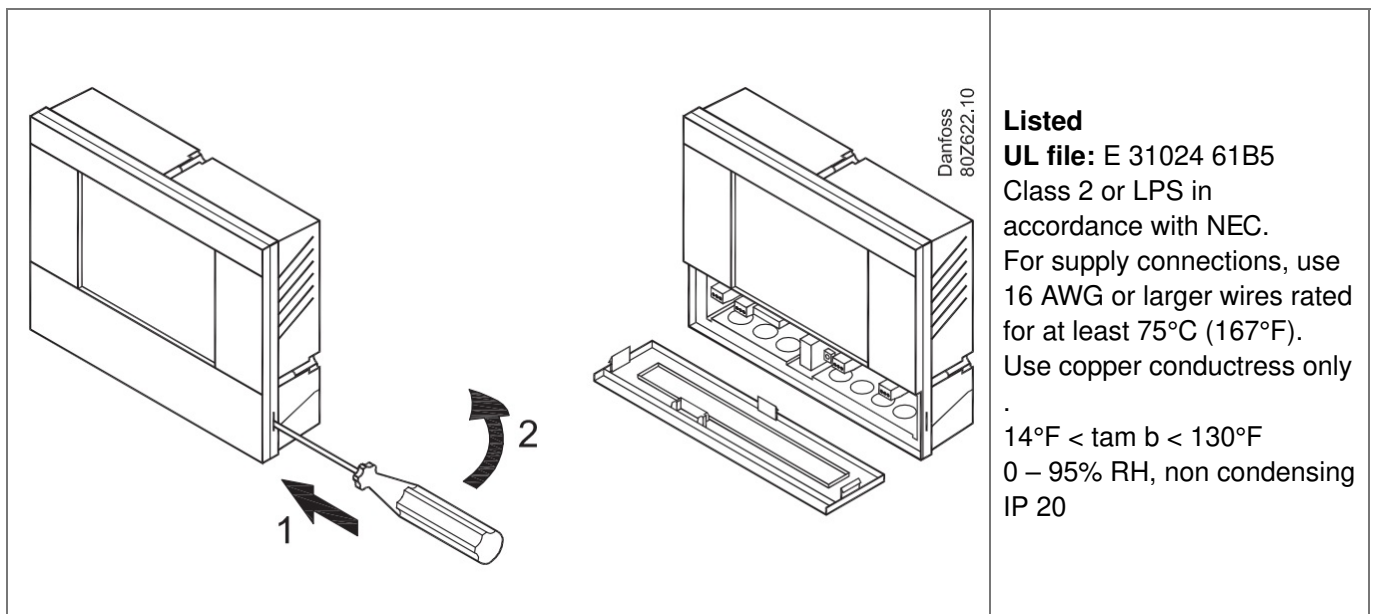

Panel mounting

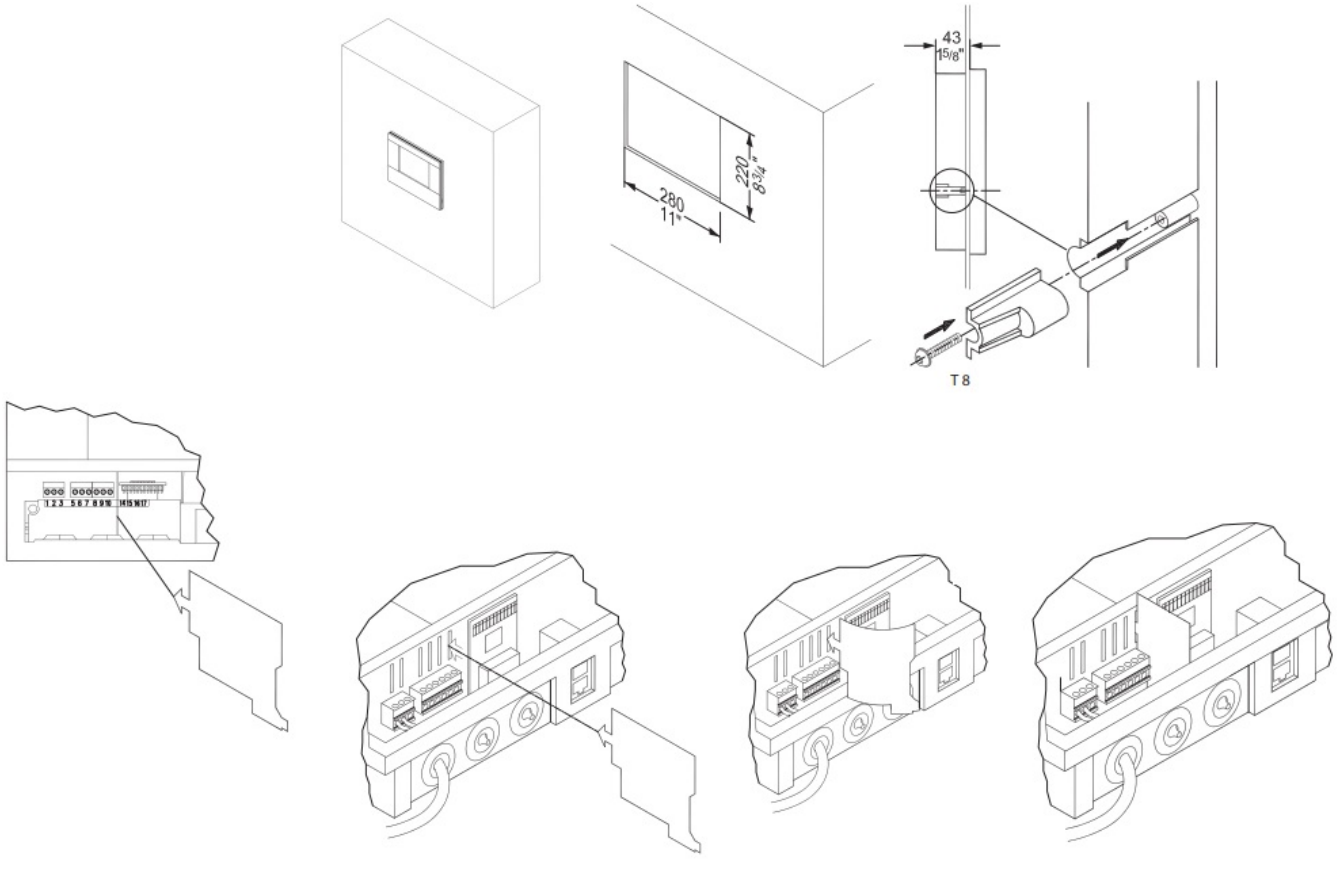

Mod bus, Lon-version

Mod bus

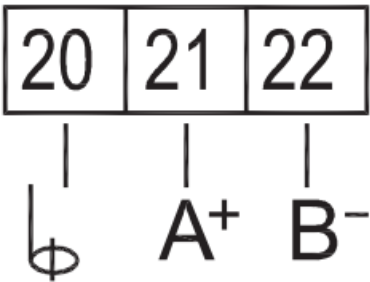

LON

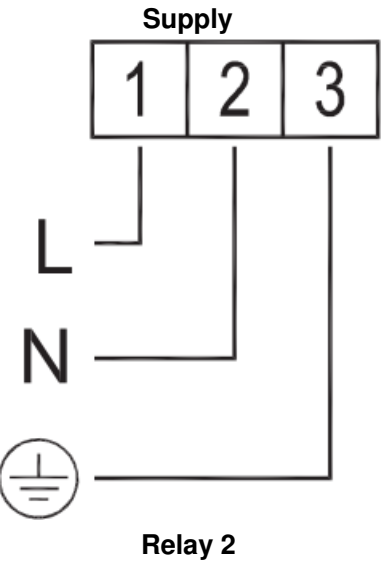
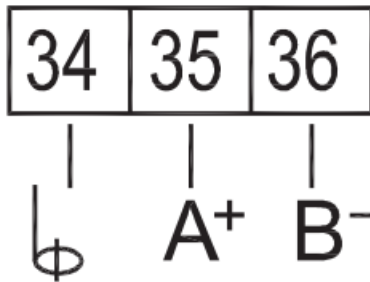

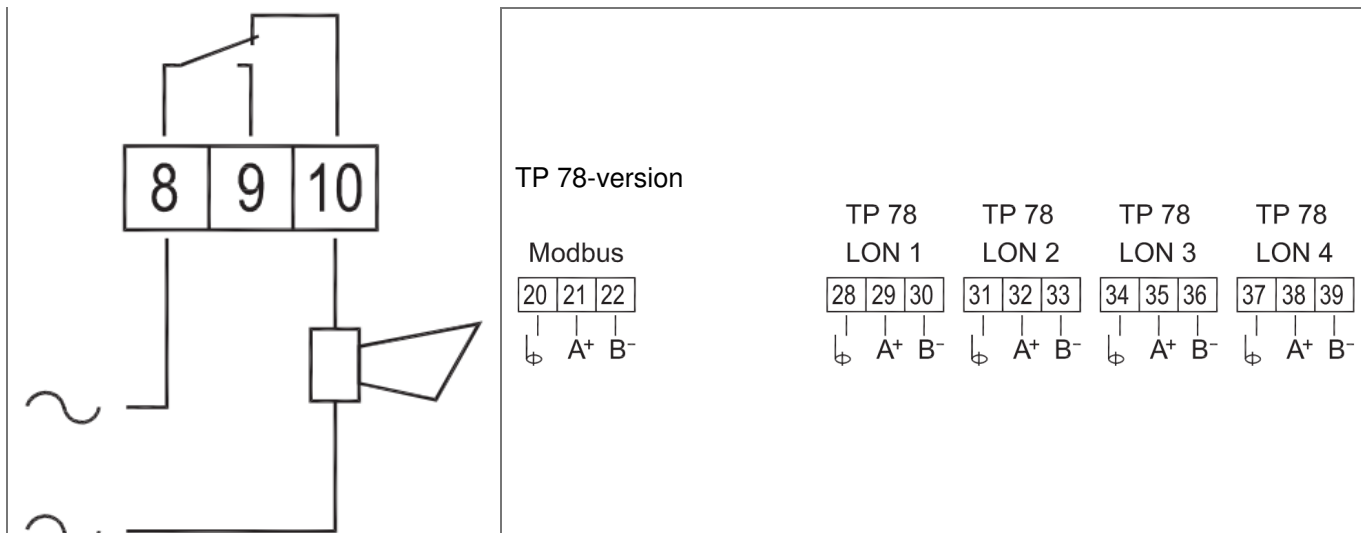

For safety reasons both supply voltage

and relay voltage must be the same.

The cable installation of the data communication cable must comply with the requirements mentioned in the document "Data communication between ADAP-KOOL® Refrigeration controls". Literature sheet number = RC8AC

Termination

OFF



ON



Danfoss

Modbus

OFF



ON



Danfoss

LON

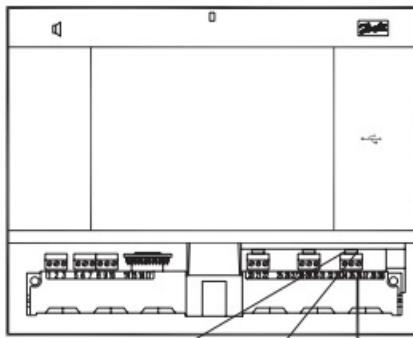

Term.
switch
off ☐ on ☒

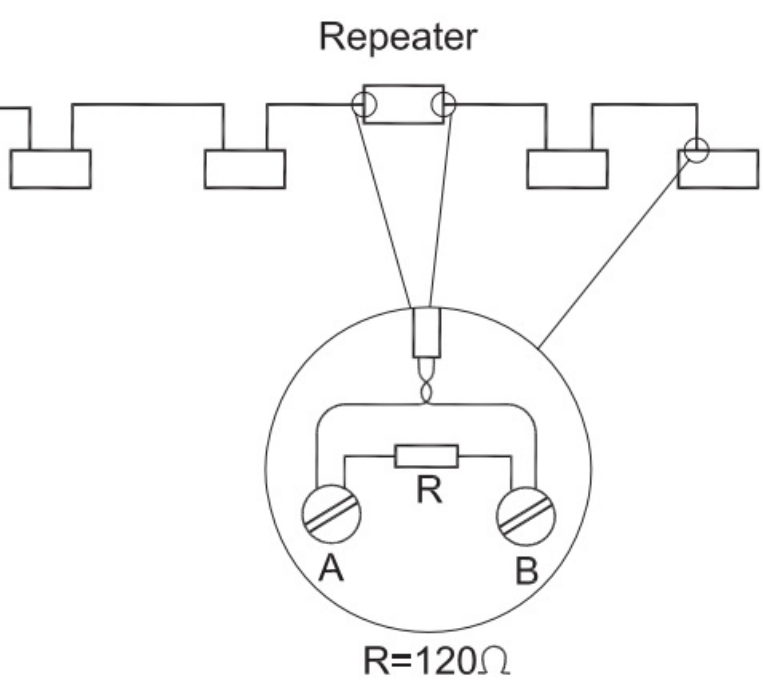

If a rep

eater is used, make sure the terminators are used (included with repeater).
Use the included 120 Ohm terminator on last device.

Address
Direction

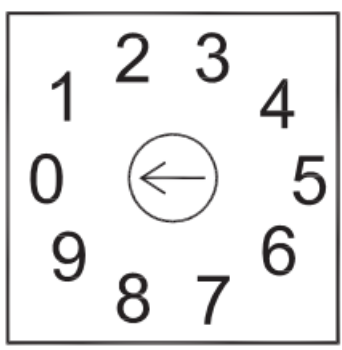

0 = Mater
1 - 9 = Slave

IP

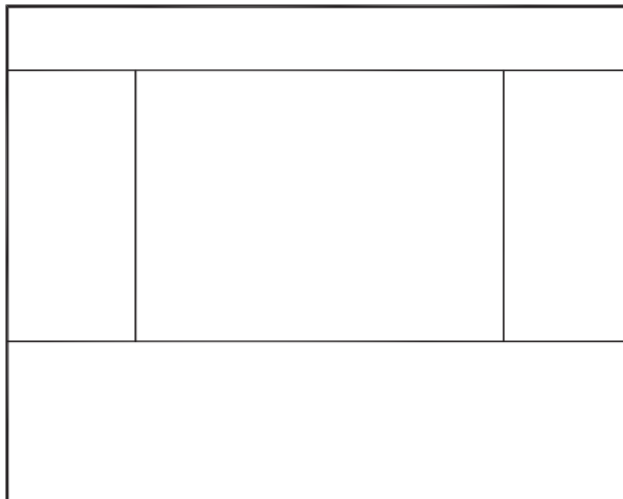

LAN Use shielded ether net cable

Initial settings

 ENGINEERING TOMORROW
AK-SM 800 Initial settings wizard

1. Press "Next"
2. Select language
3. Set Date / Time
4. Set Engineering unit preferences
5. Set Users / Password
Default: User = Supervisor / Password = 12345
6. Set Communications
7. OK and Finish (reset)

Configuration
See manual: USCO.PI.R1.H1.–

The Product contains electrical components And may not be disposed together with domestic waste.
Equipment must be separate collected with Electrical and Electronic waste. According to Local and currently valid legislation.



AK-SM 820/850/880 Instructions RI8PU953 © Danfoss 01/2019 3



Documents / Resources

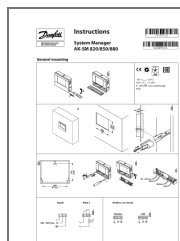

[Danfoss AK-SM 820 System Manager](#) [pdf] Instructions
AK-SM 820 System Manager, AK-SM 820, System Manager, Manager

References

- [User Manual](#)

[Manuals+](#), [Privacy Policy](#)

This website is an independent publication and is neither affiliated with nor endorsed by any of the trademark owners. The "Bluetooth®" word mark and logos are registered trademarks owned by Bluetooth SIG, Inc. The "Wi-Fi®" word mark and logos are registered trademarks owned by the Wi-Fi Alliance. Any use of these marks on this website does not imply any affiliation with or endorsement.