

Danfoss 080Z2822 Gas Sensor Strobe and Horn

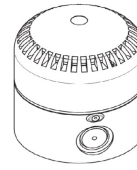

Danfoss 080Z2822 Gas Sensor Strobe and Horn Installation Guide

[Home](#) » [Danfoss](#) » Danfoss 080Z2822 Gas Sensor Strobe and Horn Installation Guide 

Contents

- [1 Danfoss 080Z2822 Gas Sensor Strobe and Horn](#)
- [2 Product Usage Instructions](#)
- [3 FAQ](#)
- [4 Specification](#)
- [5 Wiring](#)
- [6 Dimensions and appearance](#)
- [7 Supply voltage to DGS is DC](#)
- [8 Assembly](#)
- [9 Switch a sounds](#)
- [10 Documents / Resources](#)
 - [10.1 References](#)



Danfoss 080Z2822 Gas Sensor Strobe and Horn

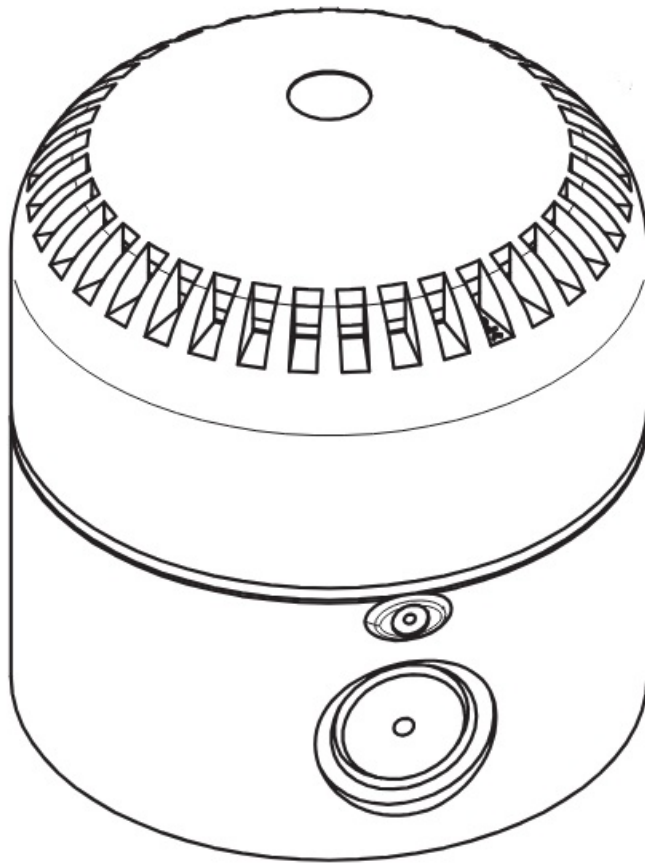

Specifications

- Product: Danfoss Gas Sensor Strobe and Horn
- Code Number: 080Z2822
- Model: 80Z975
- IP Rating: IP65
- Class: Class 2

Product Usage Instructions

Wiring

The wiring for the Danfoss Gas Sensor Strobe and Horn is as follows:

- Danfoss 80Z976: [\[Details\]](#)
- Danfoss 80Z978: [\[Details\]](#)
- Danfoss 80Z982: [\[Details\]](#)
- Danfoss 80Z983: [\[Details\]](#)
- Danfoss 80Z981: [\[Details\]](#)

Dimensions and Appearance

The product dimensions and appearance are as follows:

- Model: Danfoss 80Z974

- Features: [Details]

Sound Setting

To set the sound preferences for the Danfoss Gas Sensor Strobe and Horn:

- Switch on/off based on the desired tone.
- Adjust volume and light settings using the provided controls.
- Refer to the provided table for different tone types, frequencies, and descriptions.

Warnings

Important warnings for using the product:

- Installation must be done by qualified personnel.
- Do not dispose of the product as common waste.
- Rapid flashing lights may induce photosensitive epilepsy under certain circumstances.
- Always disconnect power before servicing the product.

FAQ

- **Q: Can I adjust the sound settings on the Danfoss Gas Sensor Strobe and Horn?**
 - A: Yes, you can adjust the sound settings using the provided controls to select different tones and adjust volume levels.
- **Q: What are the precautions I need to take during installation?**
 - A: Make sure installation is carried out by qualified individuals, and always disconnect power before servicing the product.

Specification

- Alarm Sounder
- Current consumption 12 V DC: 23 mA (Siren) / 30 mA (Flash) / 38 mA Siren + Flash
- Current consumption 24 V DC: 32 mA (Siren) / 28 mA (Flash) / 45 mA Siren + Flash
- Operating voltage: 12 – 24 V DC
- IP rating: IP 65
- Operating temp.: -40 – +55 °C
- Sound output: intermittent 1000 Hz, max. = 94 dB(A)
- 1m Med = 85 dB(A)
- 1m Min = 73 dB (A) 1m
- Number of user-selectable tones: 32
- Lens colour: Red
- Material: PC

Fuse wire protection: On the power supply line the rating of the supply fuse must be according to the voltage.

Wiring

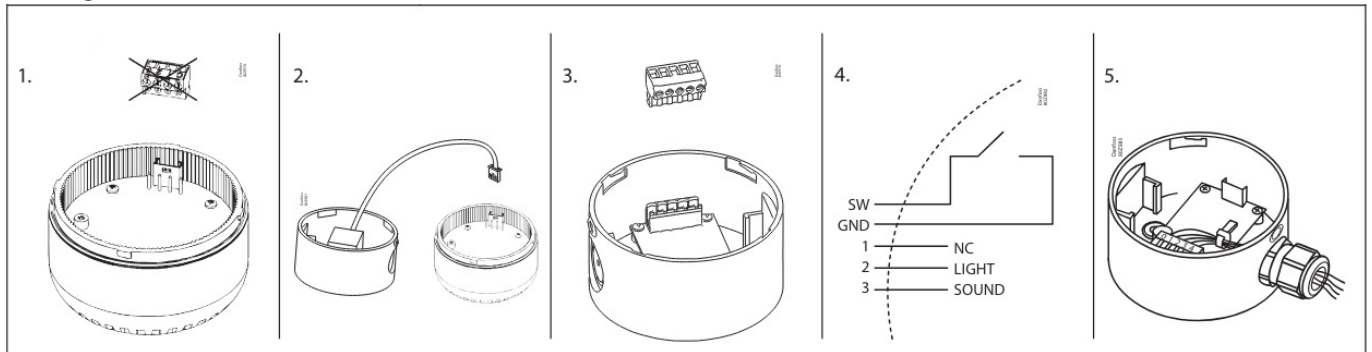

Dimensions and appearance

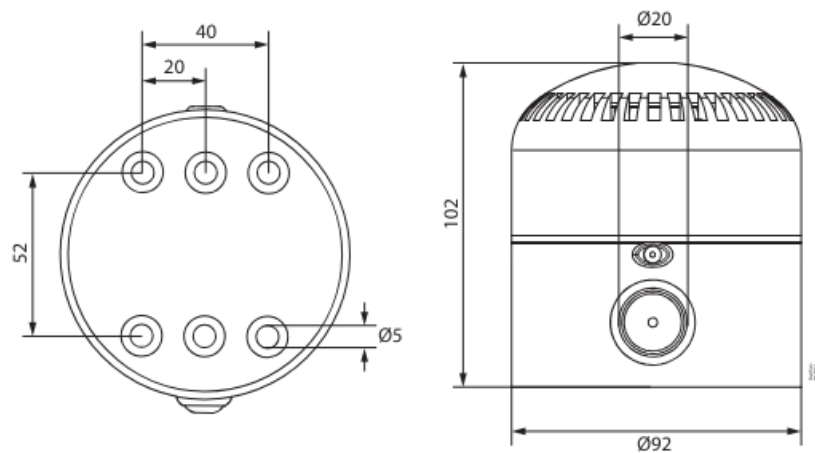

Supply voltage to DGS is DC

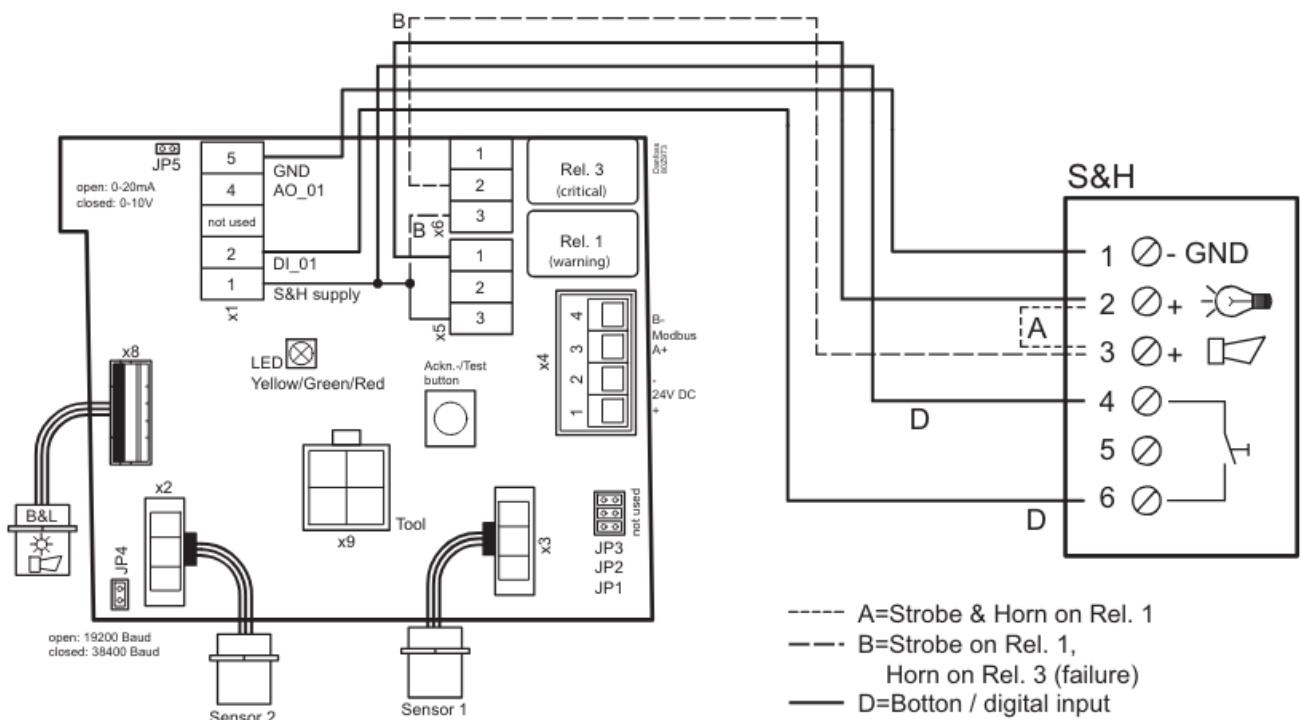

Warnings:

Installation has to be done by qualified personnel. Not to be disposed of as common waste. The possibility exists that rapid flashing lights, under certain circumstances, might induce photosensitive epilepsy. Disconnect power before servicing

Assembly

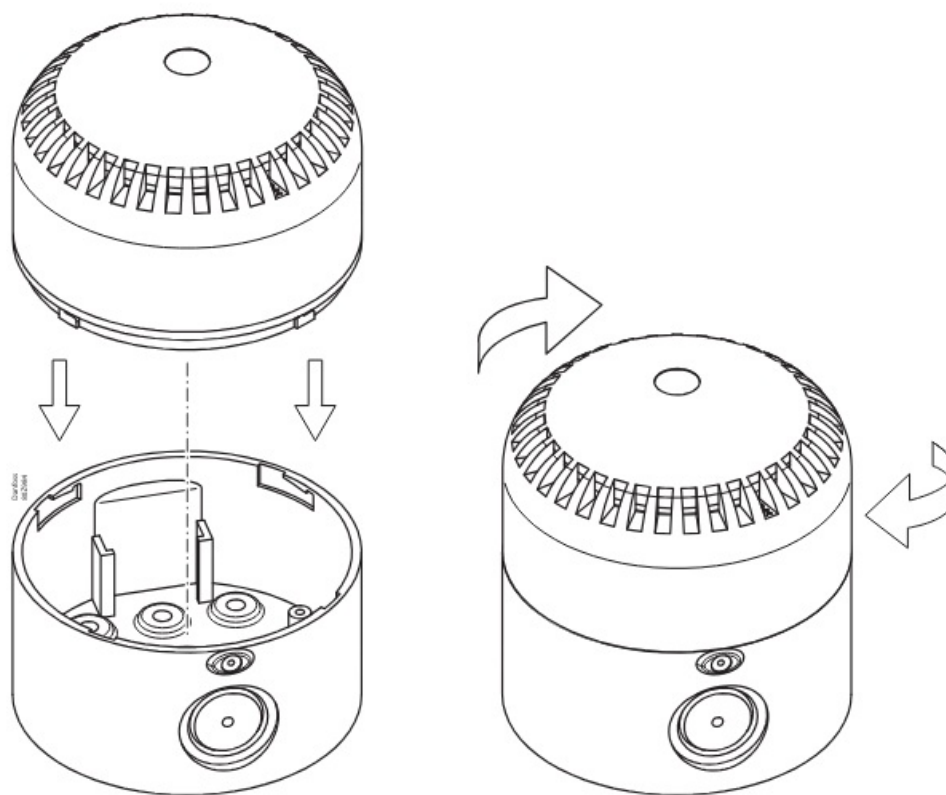

Sound setting

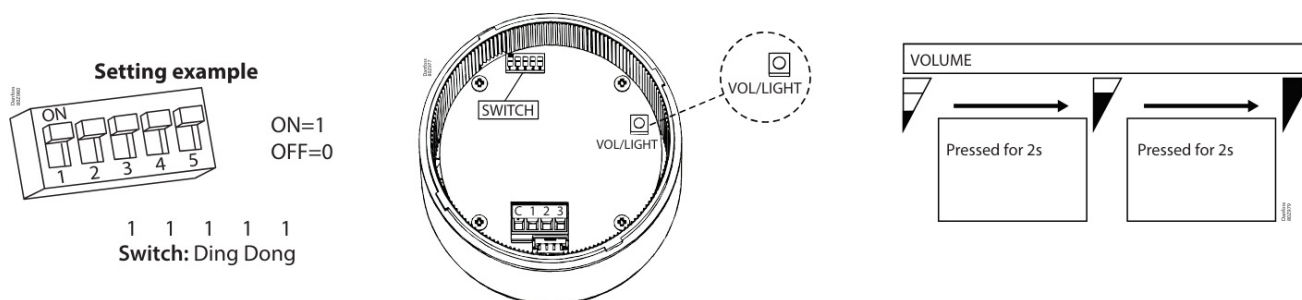

Switch a sounds

No.	Tone	Tone type	F(Hz)	Times	Description	DIP Switch				
1.	Intermittent	-----	1000	0.35s/0.35s	General Purpose	0	0	0	0	0
2.	Bi-tone		440 – 560	0.565s/0.565s	Standard - Evacuation	0	0	0	0	1
3.	Bi-tone		800 – 970	0.25s/0.25s	BS5839-1:2002	0	0	0	1	0
4.	Bi-tone		800 – 970	0.8s/0.8s	General Purpose	0	0	0	1	1
5.	Bi-tone		1000 – 2000	1s/1s	General Purpose	0	0	1	0	0
6.	Intermittent	-----	420	0.625s ON/0.625s OFF	Australia as1670 Alert Tone	0	0	1	0	1
7.	Intermittent	-----	660	0.15s ON/0.15s OFF	Swedish (Air Raid)	0	0	1	1	0
8.	Intermittent	-----	660	1.8s ON/1.8s OFF	Swedish (Local Warning)	0	0	1	1	1
9.	Intermittent	-----	660	0.5s ON/0.5s OFF	Swedish General Purpose	0	1	0	0	0
10.	Intermittent	-----	720	0.7s ON/0.3s OFF	General Purpose	0	1	0	0	1
11.	Intermittent	-----	750	0.33s ON/0.5s OFF	General Purpose	0	1	0	1	0
12.	Intermittent	-----	800	0.25s ON/1s OFF	General Purpose	0	1	0	1	1
13.	Intermittent		970 – 800	0.35s/0.35s/0.35s OFF X 3 1.5s OFF	ISO 8201	0	1	1	0	0
14.	Intermittent	--- --	970	0.5s ON/0.5s OFF X 3 1.5s OFF	ISO 8201 Low Tone	0	1	1	0	1
15.	Intermittent	-----	970	0.25s ON/0.25s OFF	General Purpose	0	1	1	1	0
16.	Intermittent	-----	2850	1s ON/1s OFF	General Purpose	0	1	1	1	1
17.	Intermittent	-----	2850	0.25s ON/0.25s OFF	General Purpose	1	0	0	0	0
18.	Linear	=====	300	-	General Purpose	1	0	0	0	1
19.	Linear	=====	660	-	Swedish (All Clear)	1	0	0	1	0
20.	Linear	=====	750	-	General Purpose	1	0	0	1	1
21.	Linear	=====	2850	-	General Purpose	1	0	1	0	0
22.	Sweep		500 – 1200	3.5s ON/0.5s OFF	Netherlands-NEN2575:2000	1	0	1	0	1
23.	Sweep		500 – 1200	0.5s ON/0.5s OFF X 3 1.5s OFF	Australia as1670	1	0	1	1	0
24.	Sweep		800 – 970	0.5s ON/0.5s OFF X 3 1.5s OFF	ISO 8201	1	0	1	1	1
25.	Sweep		1000 – 1700	CYCLE 0.25s	Standard	1	1	0	0	0
26.	Sweep		1000 – 1700	CYCLE 0.8s	Standard	1	1	0	0	1
27.	Sinusoidal		1000 – 3000	CYCLE 0.64s	Standard	1	1	0	1	0
28.	Single Shot Ding Dong		700 – 600	0.4s/0.7s	Single Shot Ding Dong	1	1	0	1	1
29.	White Noise	=====	Random	-	Standard	1	1	1	0	0
30.	Intermittent White Noise	-----	Random	0.5s ON/0.5s OFF	Standard	1	1	1	0	1
31.	Ding Dong		700 – 600	0.9s/1.4s/1s OFF	Repeating Ding Dong	1	1	1	1	0
32.	Ding Dong		554 – 440	0.9s/1.4s/1s OFF	Repeating Ding Dong	1	1	1	1	1

Documents / Resources

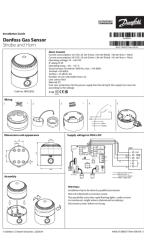
	<p>Danfoss 080Z2822 Gas Sensor Strobe and Horn [pdf] Installation Guide</p> <p>080Z2822 Gas Sensor Strobe and Horn, 080Z2822, Gas Sensor Strobe and Horn, Sensor Stro be and Horn, Strobe and Horn, Horn</p>
---	--

References

- [User Manual](#)

This website is an independent publication and is neither affiliated with nor endorsed by any of the trademark owners. The "Bluetooth®" word mark and logos are registered trademarks owned by Bluetooth SIG, Inc. The "Wi-Fi®" word mark and logos are registered trademarks owned by the Wi-Fi Alliance. Any use of these marks on this website does not imply any affiliation with or endorsement.