

DALS DCP-TR60-BK Voltage Smart Transformer



DALS DCP-TR60-BK Voltage Smart Transformer Installation Guide

[Home](#) » [dals](#) » DAL S DCP-TR60-BK Voltage Smart Transformer Installation Guide 

Contents

- [1 DAL S DCP-TR60-BK Voltage Smart Transformer](#)
- [2 ITEMS INCLUDED IN THE BOX](#)
- [3 WARRANTY](#)
- [4 INSTALLATION INSTRUCTION](#)
- [5 Concrete or deck installation](#)
- [6 Smart connection guide](#)
- [7 FCC COMPLIANCE](#)
- [8 Documents / Resources](#)
 - [8.1 References](#)

dals

DALS DCP-TR60-BK Voltage Smart Transformer



MODEL

MODEL MODÈLE	WATTS	LUMENS	KELVIN	CRI	INPUT ENTRÉE	DIMMABLE INTENSITÉ RÉGLABLE *
DCP-45HP20	7 W	600 lm	RGB + CCT 2200-4000K	80	24V DC	✓

Dais Connect App™

- Landscape transformer, model DCP-TR60-BK, DCP-TR200-BK, DCP-PTR36 or DCP-TR300-BK is required for installation. Sold separately.

ITEMS INCLUDED IN THE BOX

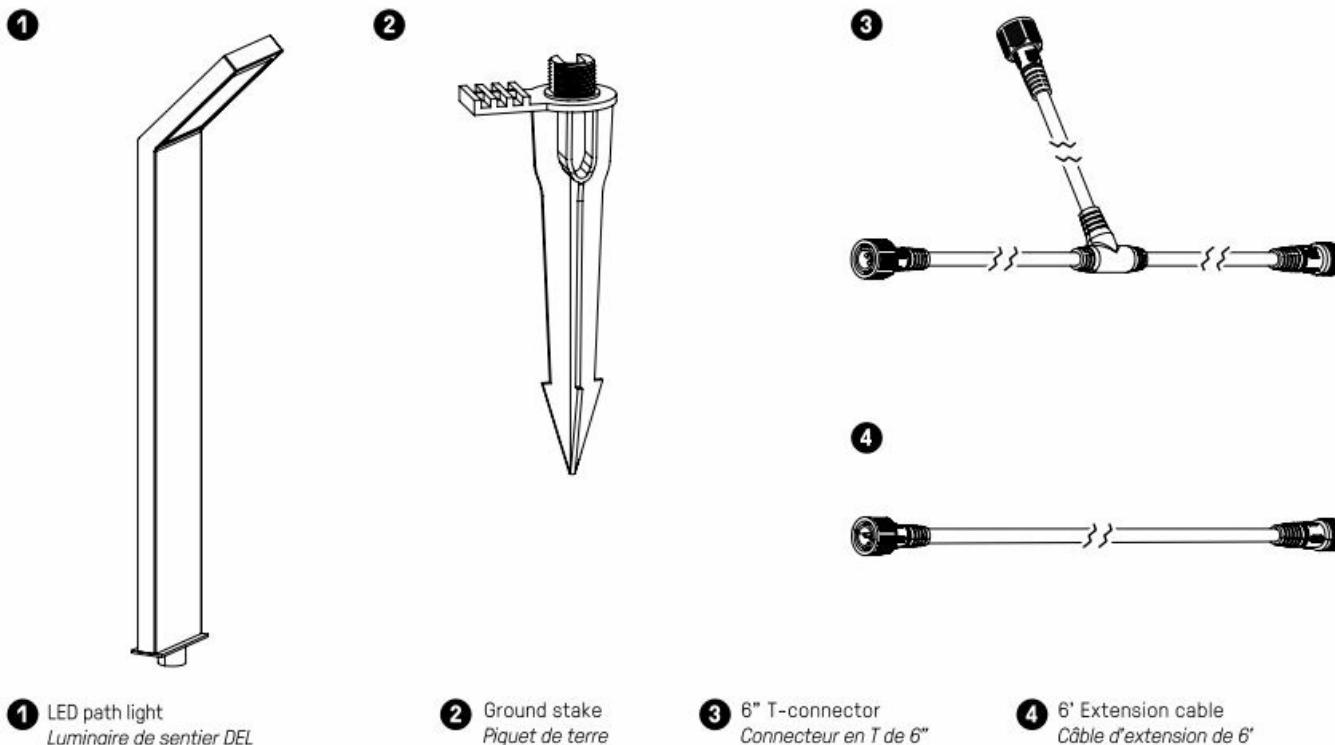

COMPATIBLE ACCESSORIES (SOLD SEPARATELY):

- **DCP-TR60-BK:** Transformer – Max. 60W
- **DCP-TR200-BK:** Transformer – Max. 200W
- **DCP-PTR36:** Plug-in driver – 36W
- **DCP-ACC-MS12:** Metal ground stake 12"
- **DCP-ACC-MS06:** 6" metal stake
- **DCP-TR300-BK:** Transformer – Max. 300W
- **DCP-ACC-MB:** Mounting bracket
- **DCP-EXT20FT:** 20' extension cable
- **DCP-EXT6FT:** 6' extension cable
- **DCP-EXT-T:** 6" T-connector

WARRANTY

- DALS offers a 5-year warranty from the date of purchase which covers repairs or replacements of defective parts of the housing, optics, and electronics.
- To contact DALS customer service call 1 en 430 1818 or send an e-mail to info@dals.com.

BEFORE YOU START

- BEFORE STARTING INSTALLATION, SHUT THE LINE FEED POWER OFF USING THE CIRCUIT BREAKER.
- Instructions on the risk of fire, electric shock, or injury to persons. Installation must be done according to local electrical codes. Installation should be done by a certified electrician.
- This class B digital apparatus complies with Canadian ICES-005. This digital apparatus does not exceed the Class B limits for radio-noise emissions from digital apparatus as set out in the Radio Interference Regulations

of the Canadian Department of Communications.

INSTALLATION INSTRUCTION

- Ensure that the power from the transformer is turned off.
- Run the wire through the middle of the ground stake and attach the fixture to the ground stake by turning it until it is fully inserted.
- Connect the fixture.
- With your foot, insert the stake into the ground.
- Turn the power back on.

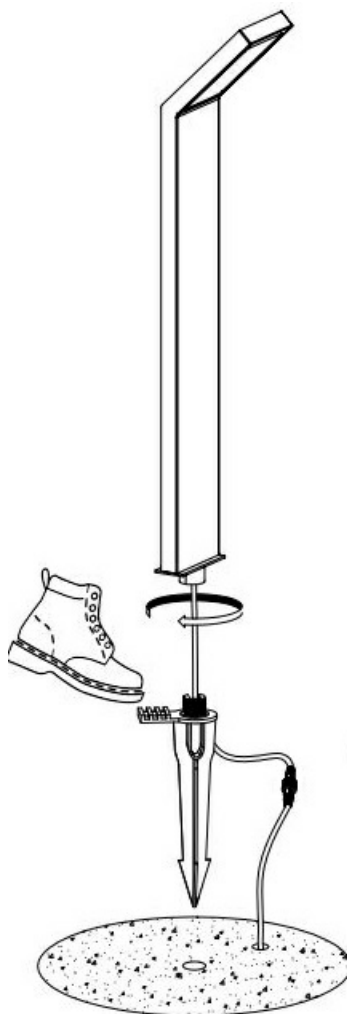

Concrete or deck installation

Use the mounting bracket DCP-ACC-MB (sold separately) to install the fixture on concrete or wood.

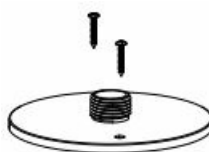

Smart connection guide

- BEFORE YOU START BEFORE STARTING INSTALLATION, SHUT THE LINE FEED POWER OFF USING THE CIRCUIT BREAKER.
- Instructions on the risk of fire, electric shock, or injury to persons. Installation must be done according to local

electrical codes. Installation should be done by a certified electrician.

- This class B digital apparatus complies with Canadian ICES-005. This digital apparatus does not exceed the Class B limits for radio-noise emissions from digital apparatus as set out in the Radio Interference Regulations of the Canadian Department of Communications.

1. Download the Dais Connect app from the Apple App Store or the Google Play Store and register for a new account if this is your first time.

- The app requires a valid email address since it will need a verification code for you to log in.

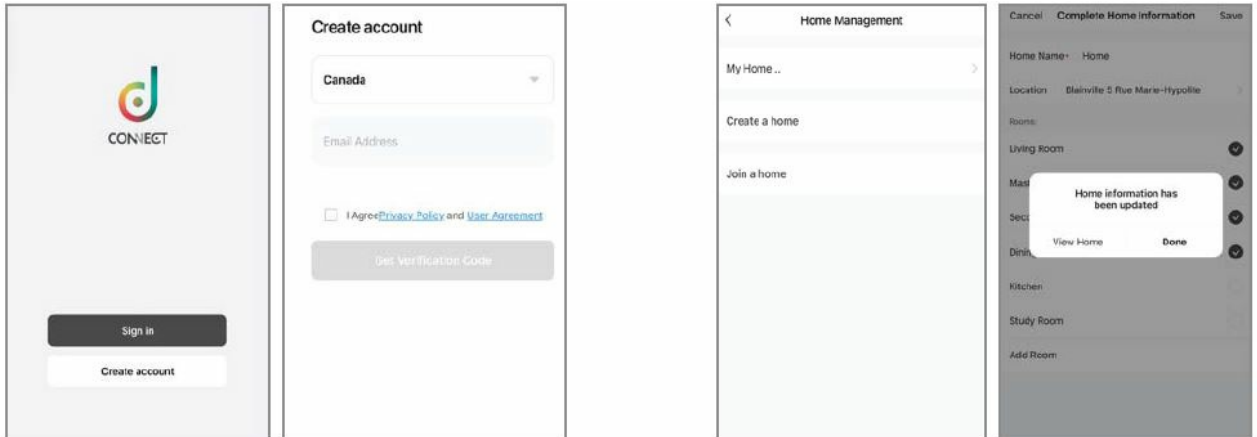

2. Configure your profile and set your home inside the app. This will allow you to control light groups and create advanced automation based on your location.
3. In the Dais Connect app, press on the “+” sign in the upper right corner and select “Add Device”. If your product supports bluetooth pairing, it will show up right away at the top under “Add Device”.
- If you have an older Wi-Fi product. select the product from the list and follow the instructions from the app.

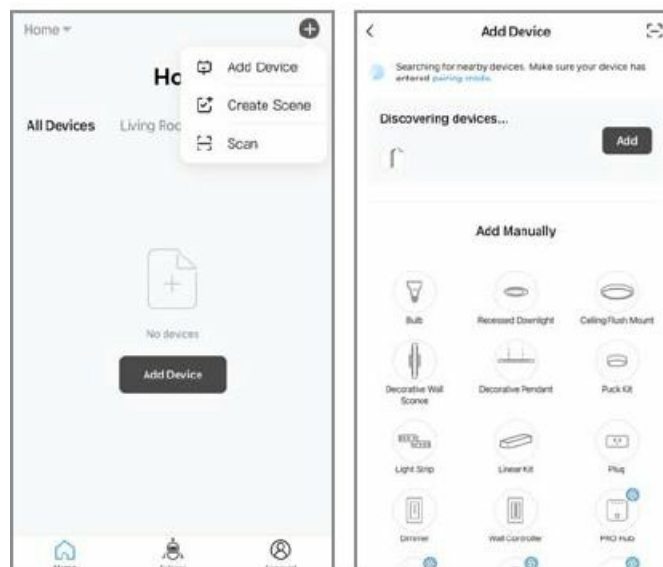

4. In this next step, your light will be added to the app. If you are connecting multiple products at once, they will be added in a batch. From here you can either click “Done” at the bottom or click on the “pen” to rename the light.



5. Optional/Optional Rename your light and add it to one of your rooms.

6. Control your lights! Now that a group has been assigned, use your remote to control your lights.

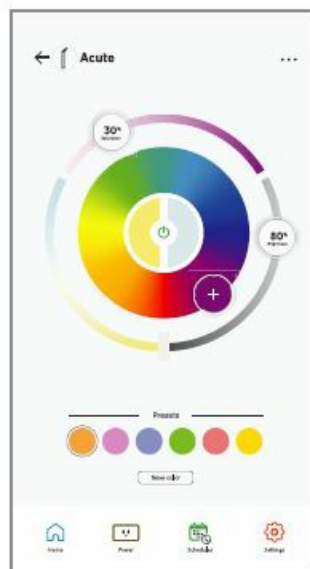

FCC COMPLIANCE

FCC STATEMENT

1. This device complies with Part 15 of the FCC Rules. Operation is subject to the following two conditions:
 1. This device may not cause harmful interference,
 2. This device must accept any interference received, including interference that may cause undesired operation.
2. Changes or modifications not expressly approved by the party responsible for compliance could void the user's authority to operate the equipment.

This equipment has been tested and found to comply with the limits for a Class B digital device, according to part 15 of the FCC Rules. These limits are designed to provide reasonable protection against harmful interference in a residential installation. This equipment generates, uses, and can radiate radio frequency energy and, if not installed and used under the instructions, may cause harmful interference to radio communications. However, there is no guarantee that interference will not occur in a particular installation. If this equipment does cause harmful interference to radio or television reception, which can be determined by turning the equipment off and on, the user is encouraged to try to correct the interference by one or more of the following measures:

- Reorient or relocate the receiving antenna.
- Increase the separation between the equipment and the receiver.
- Connect the equipment to an outlet on a circuit different from that to which the receiver is connected.
- Consult the dealer or an experienced radio/ TV technician for help.

FCC Radiation Exposure Statement:

This equipment complies with FCC radiation exposure limits set forth for an uncontrolled environment. To avoid the possibility of exceeding the FCC radio frequency exposure limits, Human proximity to the antenna shall not be less than 20cm (8 inches) during normal operation

IC COMPLIANCE CANICES-5(“)/NMB-5

Industry Canada Notice

1. This device contains license-exempt transmitter(s)/receiver(s) that comply with Innovation, Science, and Economic Development Canada's license-exempt RSS(s). Operation is subject to the following two conditions:
 1. This device may not cause interference.
 2. This device must accept any interference, including interference that may cause undesired operation of the device
2. Changes or modifications not expressly approved by the party responsible for compliance could void the user's authority to operate the equipment.

ISED RF Exposure Statement

This equipment complies with ISED radiation exposure limits set forth for an uncontrolled environment. To avoid the possibility of exceeding the ISED radio frequency exposure limits, Human proximity to the antenna shall not be less than 20cm (7.9 inches) during normal operation

- **1 877430 1818**
 - www.dals.com

Documents / Resources

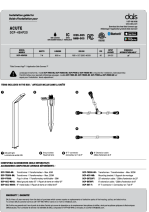
	<p>DALS DCP-TR60-BK Voltage Smart Transformer [pdf] Installation Guide DCP-TR60-BK Voltage Smart Transformer, DCP-TR60-BK, Voltage Smart Transformer, Smart T ransformer, Transformer</p>
---	---

References

- [User Manual](#)

Manuals+. Privacy Policy

This website is an independent publication and is neither affiliated with nor endorsed by any of the trademark owners. The "Bluetooth®" word mark and logos are registered trademarks owned by Bluetooth SIG, Inc. The "Wi-Fi®" word mark and logos are registered trademarks owned by the Wi-Fi Alliance. Any use of these marks on this website does not imply any affiliation with or endorsement.