



dahua IPC-HFW8241X-3D Stereo Vision Network Camera User Guide

[Home](#) » [Dahua](#) » dahua IPC-HFW8241X-3D Stereo Vision Network Camera User Guide 

Contents

- 1 dahua IPC-HFW8241X-3D Stereo Vision Network Camera User Guide
- 2 1 Introduction
 - 2.1 1.1 Cable
 - 2.2 1.2 Connecting Alarm Input/output
- 3 2 Network Configuration
 - 3.1 2.1 Initializing Device
 - 3.2 2.3 Logging in to Web Interface
- 4 3.1 Packing List
 - 4.1 3.2 Dimensions
 - 4.2 3.3 Installing Device
 - 4.3 3.3.1 Installation Method
 - 4.4 3.3.2 Installing SD Card (Optional)
 - 4.5 3.3.3 Attaching Device
- 5 Detaching bottom cover(Optional)
- 6 Cable going through wall
- 7 Cable going through side cable tray
- 8 3.3.4 Installing Waterproof Connector
 - 8.1 3.3.5 Adjusting Angle
- 9 Read More About This Manual & Download PDF:
- 10 Documents / Resources
- 11 Related Posts



1 Introduction

1.1 Cable

- Cable type might vary with different devices, and the actual product shall prevail.
 - Waterproof all the cable joints with insulating tape and waterproof tape to avoid short circuit and water damage.
- For the detailed operation, see the FAQ Manual.

Figure 1-1 Cable list

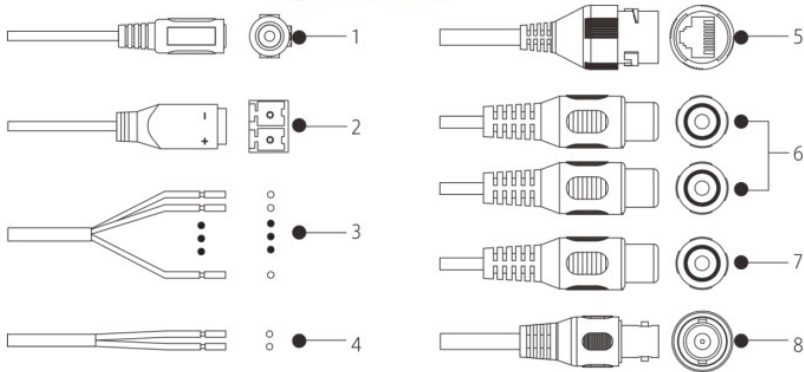

For more information about cable ports, see Table 1-1.

Table 1-1 Cable information

No.	Port Name	Description
1	12V DC power input	<p>Inputs 12V DC power. Be sure to supply power as instructed in the manual.</p> <p>Device abnormality or damage could occur if power is not supplied correctly.</p>
2	Power output	Supplies 12V DC 2W power for external devices.
3	Alarm I/O	Alarm signal input/output. Please refer to Table 1-2 for more details.
4	RS-485	<p>Controls external PTZ and so on.</p> <p>RS-485 port is available on select models.</p>

No.	Port Name	Description
5	Ethernet	<ul style="list-style-type: none"> Connects to network with network cable. Provides power to the device with PoE. <p>PoE is available on select models.</p>
6	Audio input	RCA port. Connects to sound pickup to receive audio signal.
7	Audio output	RCA port. Connects to speaker to output audio signal.
8	Video output	<p>BNC port. Outputs analog video signal, and connects TV monitor to check image.</p> <p>Video output port is available on select models.</p>

For more information about I/O port, see [Table 1-2](#).

Table 1-2 Alarm information]

Port	Port Name	Function
Alarm I/O	ALARM_OUT	Outputs alarm signal to alarm device.
	ALARM_OUT_GND	When connecting to alarm device, only the ALARM_OUT port and ALARM_OUT_GND port with the same number can be used together.
	ALARM_IN	Receives the switch signal of external alarm source.
	ALARM_IN_GND	Connect different alarm input devices to the same ALARM_IN_GND port.

1.2 Connecting Alarm Input/output

Alarm input/output is available on select models.

Step 1 Connect alarm input device to the alarm input end of the I/O port. See Figure 1-2.

Device collects different states of alarm input port when the input signal is idling and grounded.

- Device collects logic “1” when input signal is connected to +3V to +5V or idling.
- Device collects logic “0” when input signal is grounded.

Figure 1-2 Alarm input

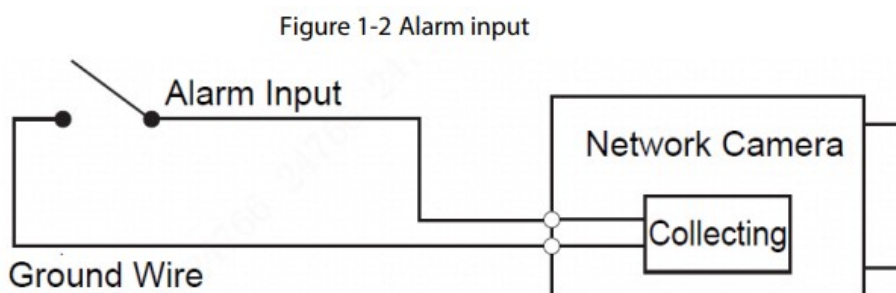

Step 2 Connect alarm output device to the alarm output end of the I/O port. The alarm output is relay switch output, which can only connect to NO alarm devices.

N1 and C1 or N2 and C2 constitute a switch to provide the alarm output, which is shown in Figure 1-3. The switch is open normally and closed when there is alarm output.

Figure 1-3 Alarm output

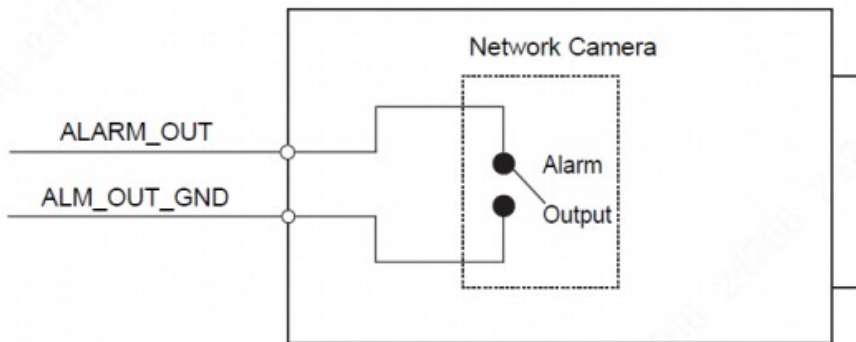

Step 3 Log in to web interface, and configure alarm input and alarm output in alarm setting.

- The alarm input on the web interface is corresponding to the alarm input end of the I/O port. There will be high level and low level alarm signal generated by the alarm input device when alarm occurs, set the input mode to NO if the signal is high level and to NC if the signal is low level.
- The alarm output on the web interface is corresponding to the alarm output end of the device, which is also the alarm output end of the I/O port.

2 Network Configuration

Device initialization and IP setting can be finished with the “ConfigTool” or in web interface. For more information, see the Web Operation Manual.

- Device initialization is available on select models, and it is required at first use and after device is being reset.
- Device initialization is available only when the IP addresses of the device (192.168.1.108 by default) and the PC stays in the same network segment.
- Plan useable network segment properly to connect the device to the network.
- The following figures and interfaces are for reference only, and the actual product shall prevail.

2.1 Initializing Device

Step 1 Double-click “ConfigTool.exe” to open the tool.

Step 2 Click .

The Modify IP interface is displayed. See Figure 2-1.

Figure 2-1 Modify IP

Step 8 Select the options according to your needs, and then click OK.

The Initialization interface is displayed after initialization is completed. Click the success icon () or the failure icon () for the details.

Step 9 Click Finish.

The device status in the Modify IP interface (Figure 2-1) turns to Initialized.

- **2.2 Modifying Device IP Address**

You can modify IP address of one or multiple devices in one time. This section is based on modifying IP addresses in batches.

- Modifying IP addresses in batches is available only when the corresponding devices have the same login password.

Step 1 Do “Step 1” to “Step 4” in “2.1 Initializing Device” to search devices in your network segment.

Step 2 Select the devices whose IP addresses need to be modified, and then click Modify IP.

The Modify IP Address interface is displayed. See Figure 2-3.

Figure 2-3 Modify IP Address

The screenshot shows a 'Modify IP Address' window. At the top, there's a title bar with the text 'Modify IP Address' and a close button. Below the title bar, there are two radio buttons under the label 'Mode': 'Static' (which is selected) and 'DHCP'. Underneath, there are three input fields: 'Start IP', 'Subnet Mask', and 'Gateway'. To the right of the 'Start IP' field, there is a checkbox labeled 'Same IP'. At the bottom of the window, there is a grey bar containing the text 'Selected number of devices: 11' and an 'OK' button.

Step 3 Select Static mode, and then enter start IP, subnet mask, and gateway.

- IP addresses of multiple devices will be set to the same if you select the Same IP check box.
- If DHCP server is available in the network, devices will automatically obtain IP addresses from DHCP server when you select DHCP.

Step 4 Click O

2.3 Logging in to Web Interface

Step 1 Open IE browser, enter the IP address of the device in the address bar, and then press Enter. If the setup wizard is displayed, finish the settings as instructed.

Step 2 Enter the user name and password in the login box, and then click Login.

Step 3 For the first login, click Click Here to Download Plugin, and then install the plugin as instructed.

The main interface is displayed when the installation is finished. See Figure 2-4.

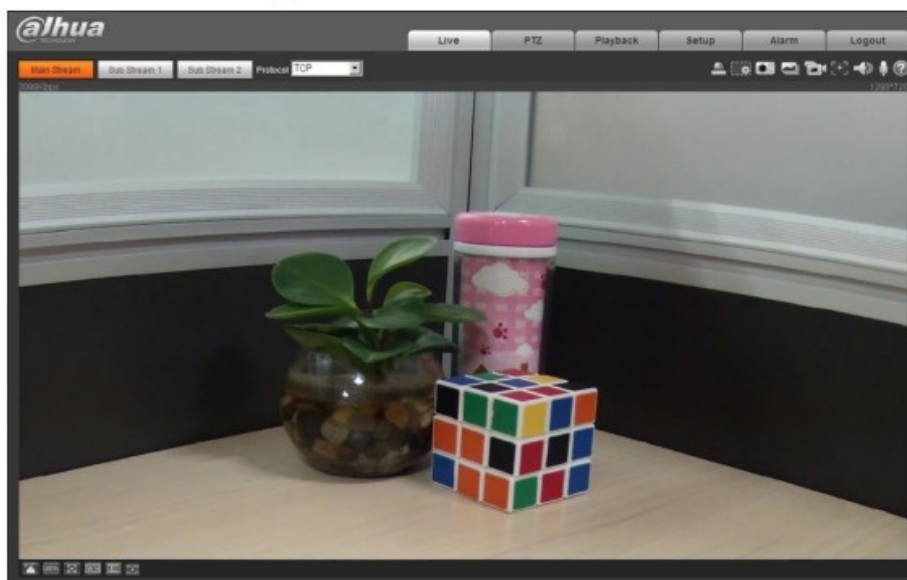

3.1 Packing List

- The tool required for the installation such as electric drill is not provided in the package.
- The operation manual and related tool are contained in the disk or the QR code, and the actual packing shall prevail.

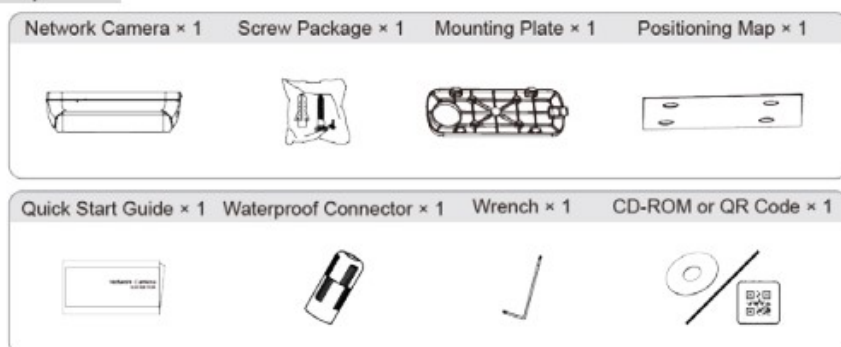

3.2 Dimensions

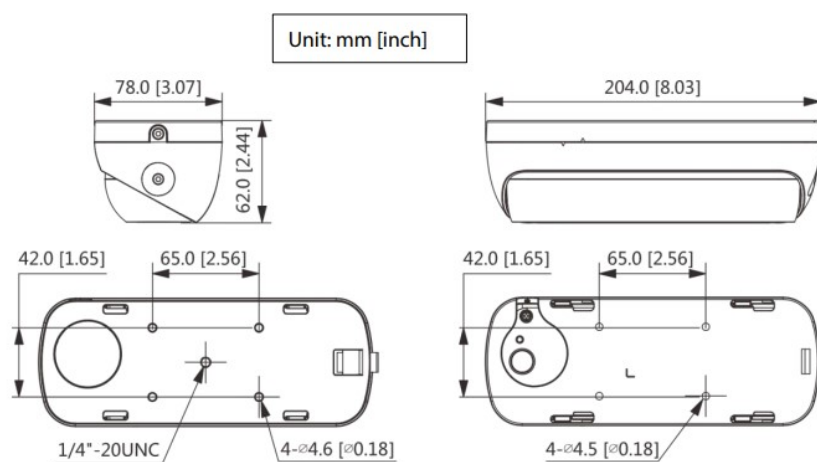

3.3 Installing Device

3.3.1 Installation Method

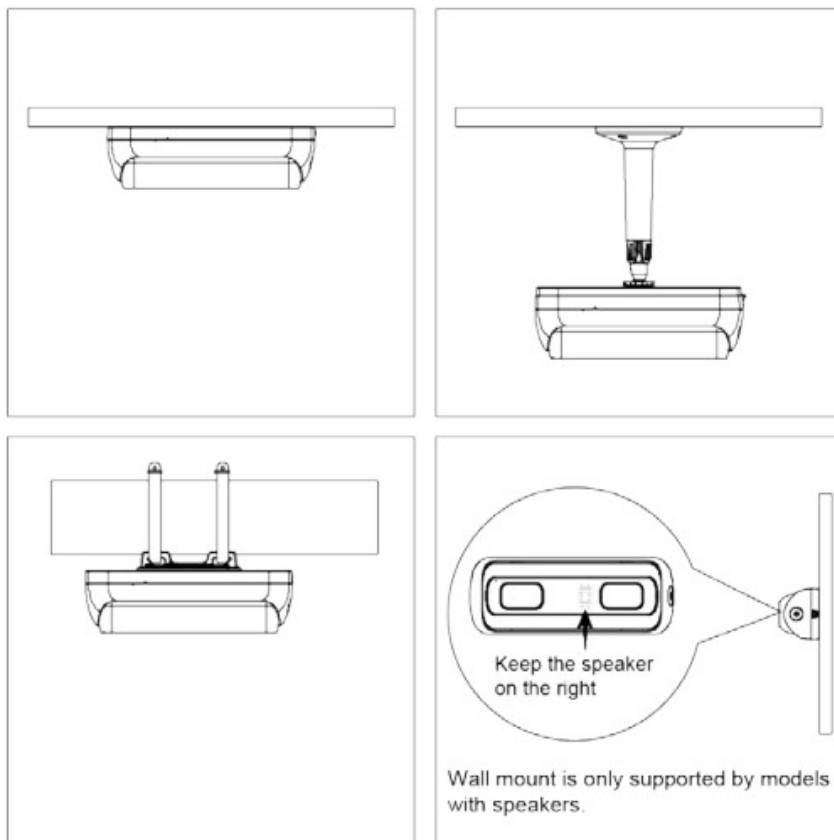

3.3.2 Installing SD Card (Optional)

- Disconnect the power before installing or removing the SD card.
- It can connect to TV monitor through the second video port and check image

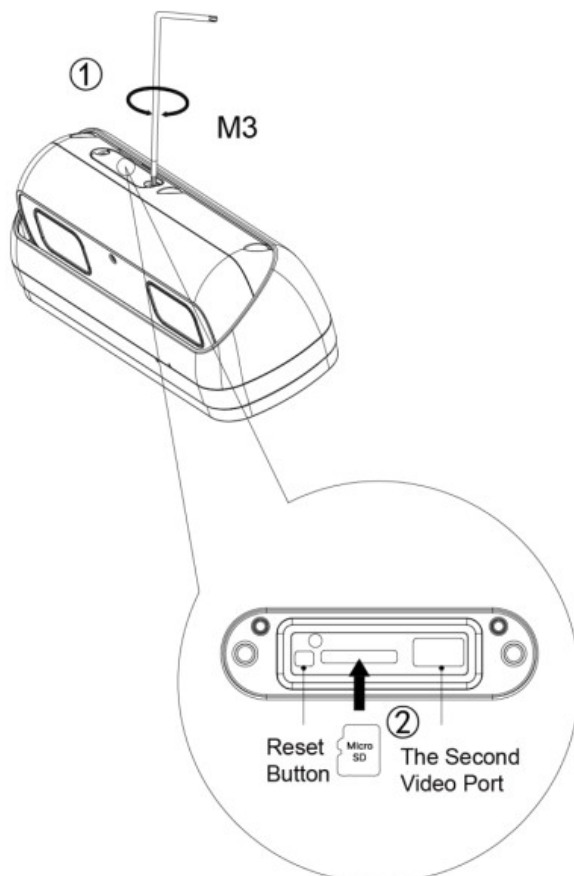

3.3.3 Attaching Device

You can install the camera through the mounting plate, and install it directly without the mounting plate.

- Make sure the mounting surface is strong enough to hold at least 3 times total weight of the device and bracket.
- To guarantee monitoring effect, it is recommended that the device shall be installed at a height between 3m and 5m, and the angle between monitoring direction and ground is between 20° and 30°.

Detaching bottom cover(Optional)

You need to detach the device from bottom cover with the wrench, and then install the device when installing the device directly

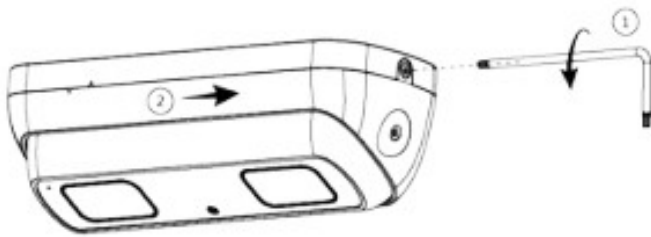

Cable going through wall

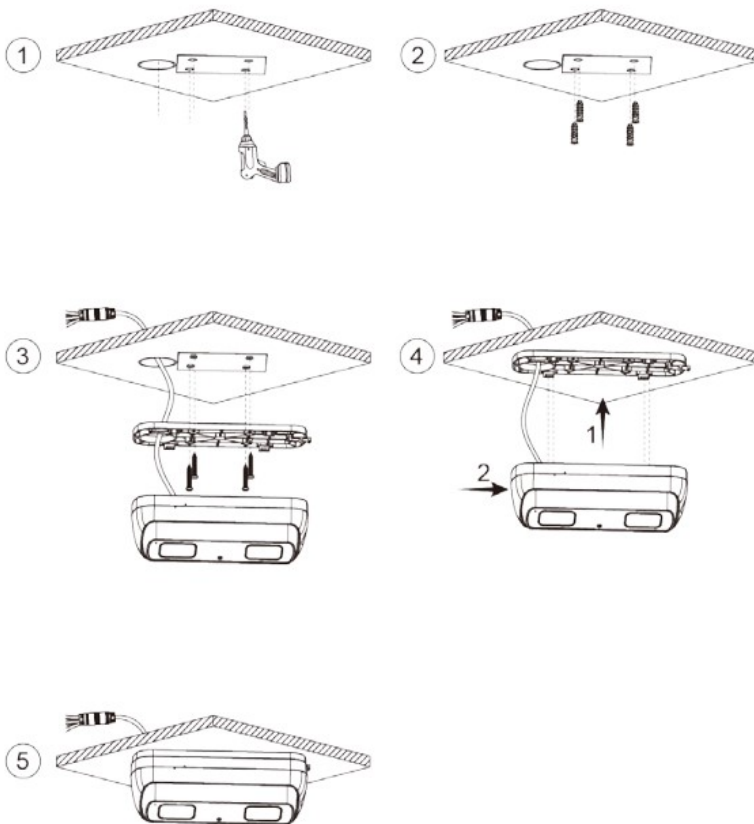

Cable going through side cable tray

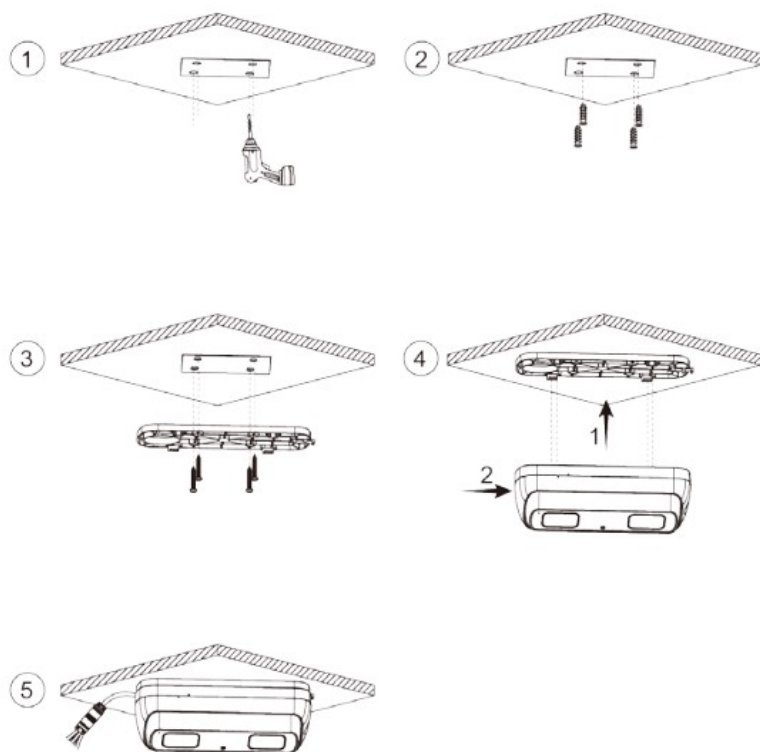

3.3.4 Installing Waterproof Connector

This part is needed only when there is waterproof connector in the package and the device is used outdoors.

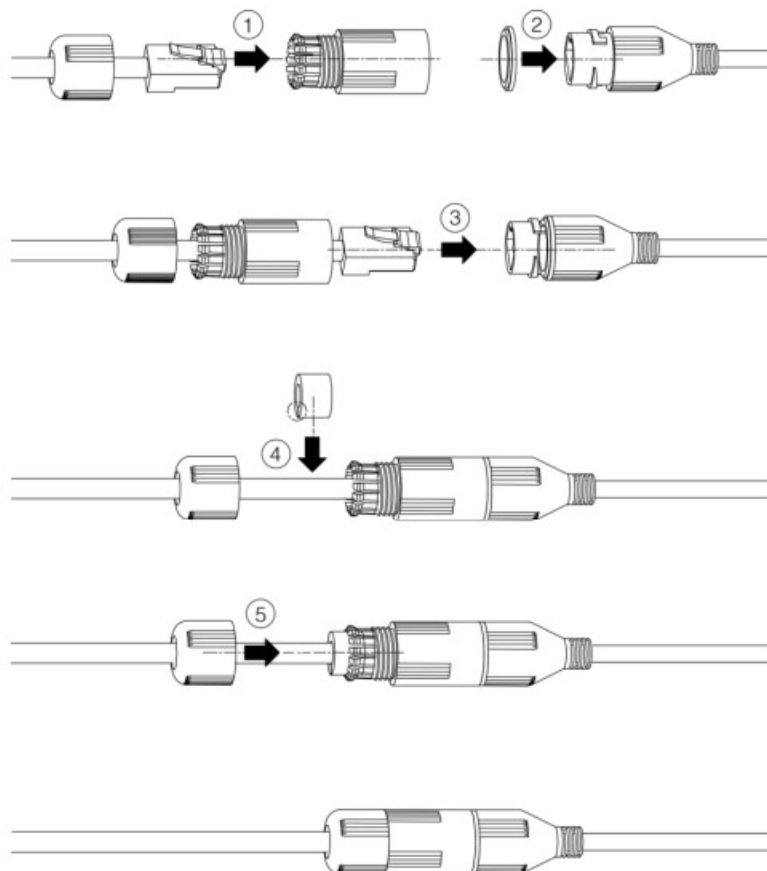

3.3.5 Adjusting Angle

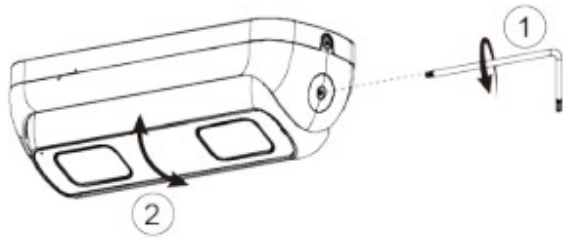

Read More About This Manual & Download PDF:

Documents / Resources

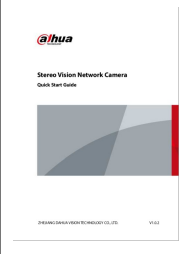
	<p>dahua IPC-HFW8241X-3D Stereo Vision Network Camera [pdf] User Guide IPC-HFW8241X-3D, Stereo Vision Network Camera, IPC-HFW8241X-3D Stereo Vision Network Camera, Vision Network Camera, Network Camera, Camera</p>
---	---