



dahua HDW1439T Color Fixed Focal Eyeball Network Camera Instruction Manual

[Home](#) » [Dahua](#) » dahua HDW1439T Color Fixed Focal Eyeball Network Camera Instruction Manual 



Entry Series

DH-IPC-HDW1439T-A-LED-S4

4MP Entry Full-color Fixed-focal Eyeball Network Camera



Contents

- 1 System Overview
- 2 Functions
- 3 Technical Specification
- 4 Ordering Information
- 5 Accessories
- 6 Dimensions (mm[inch])
- 7 Documents / Resources
 - 7.1 References

System Overview

With features of simple installation, easy operation, and high performance-cost ratio, Dahua Entry series network camera is applicable to small and medium-sized scenes, such as homes/ residences, small-sized retail stores, and other small and medium-sized enterprises.

Functions

Smart H.265+ & Smart H.264+

With advanced scene-adaptive rate control algorithm, Dahua smart encoding technology realizes the higher encoding efficiency than H.265 and H.264, provides high-quality video, and reduces the cost of storage and transmission.

Full-color

With high-performance sensor and large aperture lens, Dahua Full-color technology can display clear colorful image in the environment of ultralow illuminance. With this photosensitivity technology, the camera can capture more available light, and display more colorful image details.

Motion Detection

When moving objects appear in the monitoring image, Dahua Motion Detection technology triggers alarm or records.

- 4-MP 1/3" CMOS image sensor, low luminance, and high definition image.
- Outputs max. 4 MP (2560 × 1440)@25/30 fps.
- H.265 codec, high compression rate, ultra-low bit rate.
- Built-in warm light, and the max. illumination distance is 30 m.
- ROI, SMART H.264+/H.265+, flexible coding, applicable to various bandwidth and storage environments.
- Illumination overexposure remover (face priority), rotation mode, WDR, 3D NR, HLC, BLC, digital watermarking, applicable to various monitoring scenes.
- Abnormality detection: Motion detection, video tampering, audio detection, network disconnection, IP conflict, and illegal access.
- Built in MIC.
- 12 VDC/PoE power supply, easy for installation.
- IP67 protection.



Cyber Security

Dahua network cameras employ a series of security technologies, including security authentication and authorization, access control protocols, trusted protection, encrypted transmission and encrypted storage. These

technologies improve the camera's defense against external cyber threats and prevent malicious programs from compromising the device.

Protection (IP67, Wide Voltage)

IP67: The camera passes a series of strict test on dust and soak. It has dust-proof function, and the enclosure can work normally after soaking in 1 m deep water for 30 minutes.

Wide voltage: The camera allows $\pm 30\%$ (for some power supplies) input voltage tolerance (wide voltage range), and it is widely applied to outdoor environment with instable voltage.

Technical Specification

Camera

Image Sensor	1/3" CMOS
Max. Resolution	2560 (H) × 1440 (V)
ROM	16 MB
RAM	128 MB
Scanning System	Progressive
Electronic Shutter Speed	Auto/Manual 1/3 s–1/100,000 s
Min. Illumination	0.004 lux@F1.0
S/N Ratio	>56 dB
Illumination Distance	30 m (98.43 ft) (warm light)
Illuminator On/Off Control	Auto; Manual
Illuminator Number	1 (warm light)
Pan/Tilt/Rotation Range	Pan: 0°–360° Tilt: 0°–78° Rotation: 0°–360°

Lens

Lens Type		Fixed-focal			
Lens Mount		M12			
Focal Length		2.8 mm; 3.6 mm			
Max. Aperture		F1.0			
Field of View		2.8 mm: H: 97°; V: 54°; D: 115° 3.6 mm: H: 800; V: 45°; D: 94°			
Iris Control		Fixed			
Close Focus Distance		2.8 mm: 1.5 m (4.92 ft) 3.6 mm: 2.2 m (7.22 ft)			
DORI Distance	Lens	Detect	Observe	Recognize	Identify
	2.8 mm	66.0 m (216.54 ft)	26.4 m (86.61 ft)	13.2 m (43.31 ft)	6.6 m (21.65 ft)
	3.6 mm	78.0 m (255.91 ft)	31.2 m (102.36 ft)	15.6 m (51.18 ft)	7.8 m (25.59 ft)

Video

Video Compression	H.265; H.264; H.264B; MJPEG (Only supported by the sub stream)
Smart Codec	Smart H.265+; Smart H.264+
Video Frame Rate fps)	Main stream: 2560 x 1440@(1-25/30 fps) sub stream: 704 x 576@(1-25 fps)/704 x 480@(1-30 *The values above are the max. frame rates of each stream; for multiple streams, the values will be subjected to the total encoding capacity.
Stream Capability	2 streams
Resolution	4M (2560 x 1440); 3M (2304 x 1296); 1080p (1920 x 1080); 1.3M (1280 x 960); 720p (1280 x 720); D1 (704 x 576/704 x 480); VGA (640 x 480); CIF (352 x 288/352 x 240)
Bit Rate Control	CBR/VBR
Video Bit Rate	H.264:32 kbps-6144 kbps; H.265:12 kbps-6144 kbps
Day/Night	Color/B/W
BLC	Yes
HLC	Yes
WDR	120 dB
White Balance	Auto; natural; street lamp; outdoor; manual; regional custom
Gain Control	Auto;Manual
Noise Reduction	3D NR
Motion Detection	OFF/ON (4 areas, rectangular)
Region of Interest (Rol)	Yes (4 areas)
Smart Illumination	Yes
Image Rotation	0°/90°/180°/270° (Support 90°/270° with 2560 × 1440 resolution and lower)
Mirror	Yes
Privacy Masking	4 areas

Audio

Built-in MIC	Yes
Audio Compression	G.711a; G.711Mu; G.726; PCM

Alarm

Alarm Event	Network disconnection; IP conflict; illegal access; motion detection; video tampering; audio exception; security exception
-------------	--

Network

Network Port	RJ-45 (10/100 Base-T)
SDK and API	Yes
Network Protocol	IPv4; IPv6; HTTP; TCP; UDP; ARP; RTP; RTSP; RTCP; SMTP; FTP; D HCP; DNS; DDNS; NTP; Multicast; ICMP; IGMP
Interoperability	ONVIF (Profile S/Profile T); CGI; P2P
User/Host	6 (Total bandwidth: 36 M)
Storage	FTP
Browser	IE Chrome Firefox
Management Software	DSS; DMSS
Mobile Client	iOS; Android
Cyber Security	Configuration encryption; trusted execution; Digest; security logs; WSSE; account lockout; syslog; video encryption; 802.1x; IP/MAC filtering; HTTPS; trusted upgrade; trusted boot; firmware encryption; Generation and importing of X.509 certification

Certification

Certifications	CE-LVD: EN62368-1 CE-EMC: Electromagnetic Compatibility Directive 2014/30/EU FCC: 47 CFR FCC Part 15, Subpart B
----------------	---

Power

Power Supply	12 VDC/PoE (802.3af)
Power Consumption	Basic: 2 W (12 VDC); 3.1 W (PoE) Max. (WDR+H.265+ max. Illumination): 4 W (12 VDC); 5.4 W (PoE)

Environment

Operating Temperature	-40 °C to +60 °C (-40 °F to +140 °F)
Operating Humidity	≤95%
Storage Temperature	-40 °C to +60 °C (-40 °F to +140 °F)
Protection	IP67

Structure

Casing Material	Metal
Product Dimensions	85.6 mm × Ø94.0 mm (3.37" × Ø3.70")
Net Weight	0.33 kg (0.73 lb)
Gross Weight	0.46 kg (1.01 lb)

Ordering Information

Type	Model	Description
4MP Camera	DH-IPC-HDW1439T-A-LED-S4	4MP Entry Full-color Fixed-focal Eyeball Network Camera
Accessories (Optional)	PFA13A-E	Junction Box
	PFB205W-E	Wall Mount Bracket
	PFA152-E	Pole Mount Bracket
	PFA106	Mount Adapter
	PFB220C	Junction Box
	PFM321D	12 VDC 1 A Power Adapter
	PFM900-E	Integrated Mount Tester

Accessories

Optional:



PFA13A-E
Junction
Box



PFB205W-E
Wall Mount
Bracket



PFA152-E
Pole Mount
Bracket



PFA106
Mount
Adapter



PFB220C
Junction
Box



PFM321D
12 VDC 1A
Power Adapter



PFM900-E
Integrated
Mount Tester

Junction Mount	Ceiling Mount	Wall Mount
Pole Mount (Vertical)		

Dimensions (mm[inch])

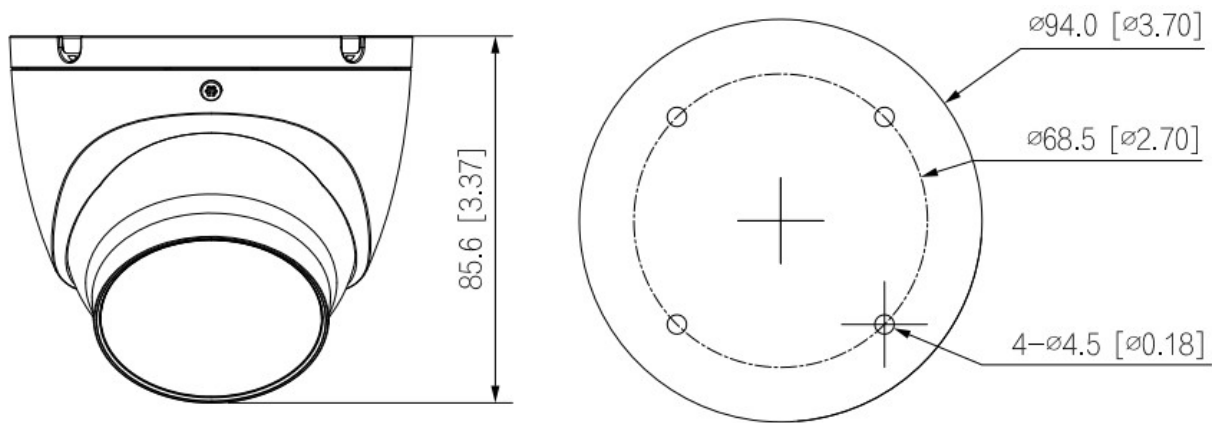

© 2022 Dahua. All rights reserved. Design and specifications are subject to change without notice.
The images, specifications and information mentioned in the document are only for reference, and might differ from the actual product.
www.dahuasecurity.com

Documents / Resources

	<p>dahua HDW1439T Color Fixed Focal Eyeball Network Camera [pdf] Instruction Manual HDW1439T Color Fixed Focal Eyeball Network Camera, HDW1439T, Color Fixed Focal Eyeball Network Camera, Fixed Focal Eyeball Network Camera, Focal Eyeball Network Camera, Eyeball Network Camera, Network Camera, Camera</p>
---	---

References

- [Dahua Technology USA Inc - Dahua Technology USA Inc](#)
- [User Manual](#)