



dahua DH-IPC-HFW1430DS-SAW 4MP IR Fixed Focal WiFi Bullet Network Camera User Guide

[Home](#) » [Dahua](#) » dahua DH-IPC-HFW1430DS-SAW 4MP IR Fixed Focal WiFi Bullet Network Camera User Guide



**DH-IPC-HFW1430DS-SAW 4MP IR Fixed Focal WiFi Bullet Network Camera
User Guide**



Contents

- [1 DH-IPC-HFW1430DS-SAW 4MP IR Fixed Focal WiFi Bullet Network Camera](#)
- [2 Series Overview](#)
- [3 Functions](#)
- [4 Technical Specification](#)
- [5 Ordering Information](#)
- [6 Accessories](#)
- [7 Documents / Resources](#)
 - [7.1 References](#)
- [8 Related Posts](#)

DH-IPC-HFW1430DS-SAW 4MP IR Fixed Focal WiFi Bullet Network Camera

Wi-Fi Series | DH-IPC-HFW1430DS-SAW
DH-IPC-HFW1430DS-SAW
4MP IR Fixed-focal Wi-Fi Bullet Network Camera

Series Overview

With features of simple installation, easy operation, and high performance-cost ratio, the Dahua Entry series network camera is applicable to small and medium-sized scenes, such as homes/residences, small-sized retail stores, and other small and medium-sized enterprises.

- 4-MP 1/3" CMOS image sensor, low luminance, and high definition image.
- Outputs max. 4 MP (2560 × 1440)@20 fps, and max. supports 3 MP (2304 × 1296)@25/30 fps.
- H.265 codec, high compression rate, ultra-low bit rate.
- Built-in IR LED. · SMART H.264 +/-H.265+, flexible coding, applicable to various bandwidth and storage environments.
- DWDR, 3D NR, BLC, and digital watermarking, are applicable to various monitoring scenes.
- Abnormality detection: Motion detection, video tampering, audio detection, no SD card, SD card full, SD card error, network disconnection, IP conflict, illegal access, SMD (human).
- Supports antenna 2.4G Wi-Fi, up to 80m range in an open area
- Supports max. 256 G Micro SD card.Built-in MIC.
- 12 VDC power supply. · IP67 protection.

Functions

Smart H.265+ & Smart H.264+ With an advanced scene-adaptive rate control algorithm, Dahua smart encoding technology realizes a higher encoding efficiency than H.265 and H.264, provides high-quality video, and reduces the cost of storage and transmission.

Cyber Security Dahua network cameras employ a series of security technologies, including security authentication and authorization, access control protocols, trusted protection, encrypted transmission, and encrypted storage. These technologies improve the camera's defense against external cyber threats and prevent malicious programs from compromising the device.

Motion Detection

When moving objects appear in the monitoring image, Dahua Motion Detection technology triggers alarms or records.

Day/Night

Dahua Day/Night function provides color images when illumination is adequate; when illuminance is inadequate, it

switches to night mode and provides the white and black image. It can guarantee that the network camera can work normally when illuminance changes.

Protection (IP67, Wide Voltage)

IP67: The camera passes a series of strict tests on dust and soak. It has a dust-proof function, and the enclosure can work normally after soaking in 1 m deep water for 30 minutes. Wide voltage: The camera allows $\pm 30\%$ (for some power supplies) input voltage tolerance (wide voltage range), and it is widely applied to outdoor environments with unstable voltage.

- 4-MP 1/3" CMOS image sensor, low luminance, and high definition
- Outputs 4 MP (2560 × 1440)@20 fps, and max. supports 3 MP (2304 × 1296)@25/30 fps.
- 265 codec, high compression rate, ultra-low bit rate.
- Built-in IR
- SMART 264 +/H.265+, flexible coding, applicable to various bandwidth and storage environments.
- DWDR, 3D NR, BLC, and digital watermarking, are applicable to various monitoring sensors.
- Abnormality detection: Motion detection, video tampering, audio detection, no SD card, SD card full, SD card error, network disconnection, IP conflict, illegal access, SMD (human).
- Supports antenna 4G Wi-Fi, up to 80m range in an open area
- Supports 256 G Micro SD card. Built-in MIC.
- 12 VDC power
- IP67



Cyber Security

Dahua network cameras employ a series of security technologies, including security authentication and authorization, access control protocols, trusted protection, encrypted transmission and encrypted storage. These technologies improve the camera's defense against external cyber threats and prevent malicious programs from compromising the device

Technical Specification

Camera

Image Sensor	1/3" CMOS
Max. Resolution	2560 (H) × 1440 (V)
ROM	16 MB
RAM	64 MB
Scanning System	Progressive
Electronic Shutter Speed	Auto/Manual 1/3 s–1/100,000 s
Min. Illumination	0.03 Lux@F2.0 (Color, 30 IRE) 0.003 Lux@F2.0 (B/W, 30 IRE) 0 lux (Illuminator on)
S/N Ratio	>56 dB
Illumination Distance	30 m (98.43 ft) (IR LED)
Illuminator On/Off Control	Auto; Manual
Illuminator Number	1 (IR LED)
Pan/Tilt/Rotation Range	Pan: 0°–360° Tilt: 0°–90° Rotation: 0°–360°

Lens

Lens Type		Fixed-focal			
Lens Mount		M12			
Focal Length		2.8 mm; 3.6 mm			
Max. Aperture		F2.0			
Field of View		2.8 mm: Horizontal: 90°; Vertical: 50°; Diagonal: 107° 3.6 mm: Horizontal: 76°; Vertical: 40°; Diagonal: 92°			
Iris Control		Fixed			
Close Focus Distance		2.8 mm: 1.0 m (3.28 ft) 3.6 mm: 1.4 m (4.59 ft)			
DORI Distance	Lens	Detect	Observe	Recognize	Identify
	2.8 mm	68 m (223.10 ft)	27.2 m (89.24 ft)	13.6 m (44.62 ft)	6.8 m (22.31 ft)
	3.6 mm	85.2 m (279.53 ft)	34.1 m (111.88 ft)	17.0 m (55.77 ft)	8.5 m (27.89 ft)

Video

Video Compression	H.264B; H.264; H.264H; H.265
Smart Codec	Smart H.265+; Smart H.264+
Video Frame Rate	Main stream: 2560 × 1440 (1–20 fps) Sub stream: 640 × 480@(1–25 fps) 640 × 480@(1–30 fps) *The values above are the max. frame rates of each stream; for multiple streams, the values will be subjected to the total encoding capacity.
Stream Capability	2 streams
Resolution	2560 × 1440 (2560 × 1440); 2304 × 1296 (2304 × 1296); 1080p (1920 × 1080); 1.3M(1280 × 960); 720p (1280 × 720)

Bit Rate Control	CBR/VBR
Video Bit Rate	H264: 24 kbps–4096 kbps H265: 9 kbps–4096 kbps
Day/Night	Auto (ICR)/Color/B/W
BLC	Yes
WDR	DWDR
White Balance	Auto; natural; street lamp; outdoor; manual; regional custom
Gain Control	Auto
Noise Reduction	3D NR
Motion Detection	OFF/ON (4 areas, rectangular)
Region of Interest (Rol)	Yes (4 areas)
Smart Illumination	Yes
Image Rotation	0°/180°
Mirror	Yes

Audio

Built-in MIC	Yes
--------------	-----

Alarm

Alarm Event	No SD card; SD card full; SD card error; network disconnection; IP conflict; illegal access; motion detection; video tampering; audio detection; intensity change; SMD (human)
-------------	--

Network

Network Port	RJ-45 (10/100 Base-T)
Wi-Fi	IEEE802.11b/g/n 2.4~2.4835GHz
Wireless Range	Up to 80 m (The performance varies based on the actual environment)
SDK and API	Yes
Cyber Security	Video encryption; Configuration encryption; Digest; WSSE; Account lockout; Security logs; Generation and importing of X.509 certification; HTTPS; Trusted boot; Trusted execution; Trusted upgrade
Network Protocol	IPv4; HTTP; TCP; UDP; ARP; RTP; RTSP; RTCP; DHCP; DNS; NTP; Multicast;
Interoperability	ONVIF (Profile S/Profile G); CGI; P2P
User/Host	6 (Total bandwidth: 36 M)
Storage	Micro SD card (support max. 256 GB, sold separately)
Browser	IE Chrome Firefox
Management Software	Smart PSS; DSS; DMSS
Mobile Client	iOS; Android

Certification

Certifications	CE-LVD: EN62368-1; CE-EMC: Electromagnetic Compatibility Directive 2014/30/EU; CE-RED: Radio Equipment Directive 2014/53/EU; FCC: 47 CFR FCC Part 15, Subpart B; FCC ID: FCC PART 15C
----------------	---

Power

Power Supply	12 VDC
Power Consumption	Basic: 2 W (12 VDC) Max. (H.265+IR intensity): 4.1 W (12 VDC)

Environment

Operating Temperature	−40 °C to +60 °C (−40 °F to +140 °F)
Operating Humidity	≤95%
Storage Temperature	−30 °C to +70 °C (−22 °F to +158 °F)
Protection	IP67

Structure

Casing	Metal
Product Dimensions	166.2 mm × 70.0 mm × 128.6 mm (6.53" × 2.76" × 5.06")
Net Weight	477.9 g (1.05 lb)
Gross Weight	696.5 g (1.50 lb)

Ordering Information

Type	Model	Description
4MP Camera	DH-IPC- HFW1430DSP-SA W- 0280B	4MP IR Fixed-focal Wi-Fi Bullet Network Camera
	DH-IPC- HFW1430DSP-SA W- 0360B	4MP IR Fixed-focal Wi-Fi Bullet Network Camera
	DH-IPC- HFW1430DSN-S AW- 0280B	4MP IR Fixed-focal Wi-Fi Bullet Network Camera
	DH-IPC- HFW1430DSN-S AW- 0360B	4MP IR Fixed-focal Wi-Fi Bullet Network Camera
Accessories	NBS05C120050VE	12V DC/0.5A Power Adapter
	PFA134	Junction Box
	PFA152-E	Pole Mount
	PFM900-E	Integrated Mount Tester
	TF-P100	MicroSD Memory Card

Accessories

Included:



NBS05C120050VE
12V DC/0.5A
Power Adapter

Optional:



PFA134
Junction Box



PFA152-E
Pole Mount



PFM900-E
Integrated
Mount Tester

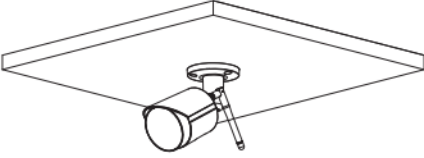
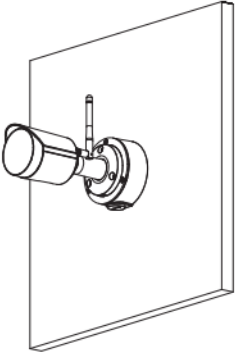
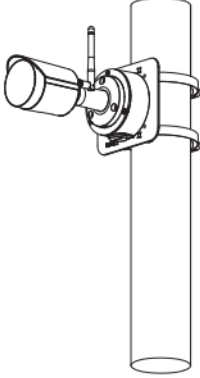

TF-P100
MicroSD
Memory Card

Ceiling Mount	Junction Mount	Pole Mount(Vertical)
		

Dimensions (mm[inch])

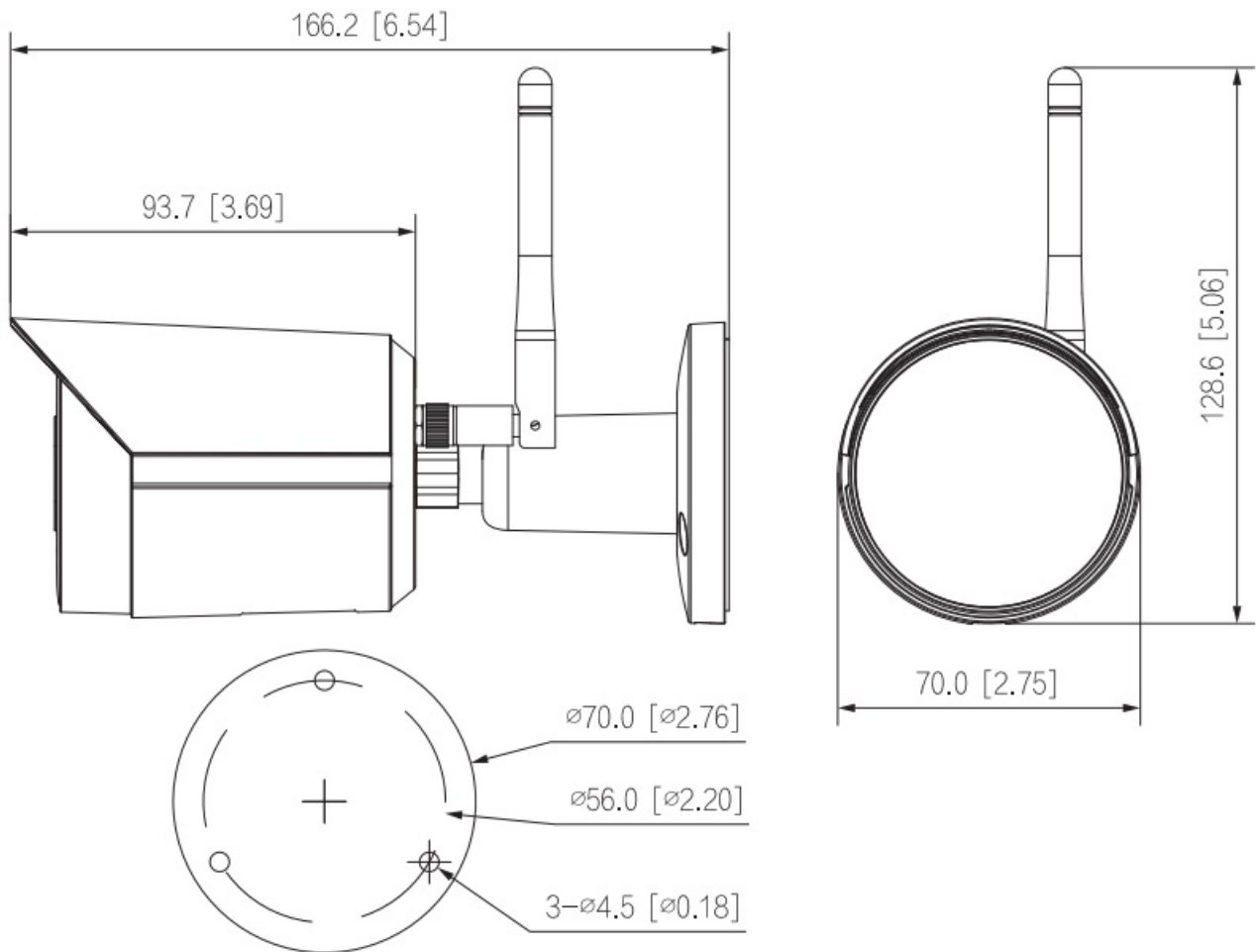

© 2022 Dahua. All rights reserved. Design and specifications are subject to change without notice.
The images, specifications and information mentioned in the document are only for reference and might differ from the actual product.

www.dahuasecurity.com



Documents / Resources

	<p>dahua DH-IPC-HFW1430DS-SAW 4MP IR Fixed Focal WiFi Bullet Network Camera [pdf] User Guide</p> <p>Wi-Fi Series, DH-IPC-HFW1430DS-SAW, DH-IPC-HFW1430DS-SAW 4MP IR Fixed Focal WiFi Bullet Network Camera, IR Fixed Focal WiFi Bullet Network Camera, Fixed Focal WiFi Bullet Network Camera, WiFi Bullet Network Camera, Bullet Network Camera, Network Camera, Camera</p>
---	--

References

- [Dahua Technology USA Inc - Dahua Technology USA Inc](#)

