



---

[Home](#) » [Dahua Technology](#) » **Dahua TECHNOLOGY Multi Sensor Panoramic Network Camera and PTZ Camera User Guide** 

## Contents [ [hide](#) ]

- [1 Dahua TECHNOLOGY Multi Sensor Panoramic Network Camera and PTZ Camera](#)
- [2 Specifications](#)
- [3 Foreword](#)
- [4 Important Safeguards and Warnings](#)
- [5 Introduction](#)
- [6 Network Configuration](#)
- [7 Smart Track Configuration](#)
- [8 Installation](#)
- [9 FAQ](#)
- [10 Documents / Resources](#)
  - [10.1 References](#)



**Dahua TECHNOLOGY Multi Sensor Panoramic Network Camera and PTZ Camera**





## Specifications

- Product: Multi-Sensor Panoramic Network Camera and PTZ Camera
- Version: V1.0.0
- Release Time: June 2025





## Foreword

### General

This manual introduces the installation and operations of the network camera. Read carefully before using the device, and keep the manual safe for future reference.

### Safety Instructions

The following signal words might appear in the manual.

Signal Words	Meaning
 WARNING	Indicates a medium or low potential hazard which, if not avoided, could result in slight or moderate injury.
 WARNING	
 CAUTION	Indicates a potential risk which, if not avoided, could result in property damage, data loss, reductions in performance, or unpredictable result.
 NOTE	Provides additional information as a supplement to the text.

### Revision History



Version	Revision Content	Release Time
V1.0.0	First release.	June 2025

## Privacy Protection Notice

As the device user or data controller, you might collect the personal data of others such as their face, audio, fingerprints, and license plate number. You need to be in compliance with your local privacy protection laws and regulations to protect the legitimate rights and interests of other people by implementing measures which include but are not limited: Providing clear and visible identification to inform people of the existence of the surveillance area and provide required contact information.

## About the Manual

- The manual is for reference only. Slight differences might be found between the manual and the product.
- We are not liable for losses incurred due to operating of the product in ways that are not in compliance with the manual.
- The manual will be updated according to the latest laws and regulations of related jurisdictions.
- For detailed information, see the paper User Manual, use our CD-ROM, scan the QR code or visit our official website. The manual is for reference only. Slight differences might be found between the electronic version and the paper version.
- All the designs and software are subject to change without prior written notice. Product updates might result in some differences appearing between the actual product and the manual. Please contact customer service for the latest program and supplementary documentation.
- There might be deviations in the description of the technical data, functions and operations, or errors in the print. If there is any doubt or dispute, we reserve the right of final explanation.
- Upgrade the reader software or try other mainstream reader software if the manual (in PDF format) cannot be opened.
- All trademarks, registered trademarks and the company names in the manual are the properties of their respective owners.



- Please visit our website, contact the supplier or customer service if any problems occur while using the device.
- If there is any uncertainty or controversy, we reserve the right of final explanation.

## **Important Safeguards and Warnings**

This section introduces content covering the proper handling of the device, hazard prevention, and prevention of property damage. Read carefully before using the device, and comply with the guidelines when using it.

### **Transportation Requirements**

- Transport the device under allowed humidity and temperature conditions.
- Pack the device with packaging provided by its manufacturer or packaging of the same quality before transporting it.
- Do not place heavy stress on the device, violently vibrate or immerse it in liquid during transportation.

### **Storage Requirements**

- Store the device under allowed humidity and temperature conditions.
- Do not place the device in a humid, dusty, extremely hot or cold site that has strong electromagnetic radiation or unstable illumination.
- Do not place heavy stress on the device, violently vibrate or immerse it in liquid during storage.

### **Installation Requirements**

#### **Warning**

- Strictly comply with the local electrical safety code and standards, and check whether the power supply is correct before operating the device.
- Please follow the electrical requirements to power the device.
  - When selecting the power adapter, the power supply must conform to the requirements of ES1 in IEC 62368-1 standard and be no higher than PS2. Please note that the power supply requirements are subject to the device label.



- We recommend using the power adapter provided with the device.
- Do not connect the device to two or more kinds of power supplies, unless otherwise specified, to avoid damage to the device.
- The device must be installed in a location that only professionals can access, to avoid the risk of non-professionals becoming injured from accessing the area while the device is working. Professionals must have full knowledge of the safeguards and warnings of using the device.
- Do not place heavy stress on the device, violently vibrate or immerse it in liquid during installation.
- An emergency disconnect device must be installed during installation and wiring at a readily accessible location for emergency power cut-off.
- We recommend you use the device with a lightning protection device for stronger protection against lightning. For outdoor scenarios, strictly comply with the lightning protection regulations.
- Ground the function earthing portion of the device to improve its reliability (certain models are not equipped with earthing holes). The device is a class I electrical appliance. Make sure that the power supply of the device is connected to a power socket with protective earthing.
- The dome cover is an optical component. Do not directly touch or wipe the surface of the cover during installation.

## **Operation Requirements**

### **Warning**

- The cover must not be opened while the device is powered on.
- Do not touch the heat dissipation component of the device to avoid the risk of getting burnt.
- Use the device under allowed humidity and temperature conditions.
- Do not aim the device at strong light sources (such as lamplight, and sunlight) when focusing it, to avoid reducing the lifespan of the CMOS sensor, and causing overbrightness and flickering.
- When using a laser beam device, avoid exposing the device surface to laser beam radiation.



- Prevent liquid from flowing into the device to avoid damage to its internal components.
- Protect indoor devices from rain and dampness to avoid electric shocks and fires breaking out.
- Do not block the ventilation opening near the device to avoid heat accumulation.
- Protect the line cord and wires from being walked on or squeezed particularly at plugs, power sockets, and the point where they exit from the device.
- Do not directly touch the photosensitive CMOS. Use an air blower to clean the dust or dirt on the lens.
- The dome cover is an optical component. Do not directly touch or wipe the surface of the cover when using it.
- There might be a risk of electrostatic discharge on the dome cover. Power off the device when installing the cover after the camera finishes adjustment. Do not directly touch the cover and make sure the cover is not exposed to other equipment or human bodies
- Strengthen the protection of the network, device data and personal information. All necessary safety measures to ensure the network security of the device must be taken, such as using strong passwords, regularly changing your password, updating firmware to the latest version, and isolating computer networks. For the IPC firmware of some previous versions, the ONVIF password will not be automatically synchronized after the main password of the system has been changed. You need to update the firmware or change the password manually.

## **Maintenance Requirements**

- Strictly follow the instructions to disassemble the device. Non-professionals dismantling the device can result in it leaking water or producing poor quality images. For a device that is required to be disassembled before use, make sure the seal ring is flat and in the seal groove when putting the cover back on. When you find condensed water forming on the lens or the desiccant becomes green after you disassembled the device, contact after-sales service to replace the desiccant. Desiccants might not be provided depending on the actual model.
- Use the accessories suggested by the manufacturer. Installation and maintenance must be performed by qualified professionals.
- Do not directly touch the photosensitive CMOS. Use an air blower to clean the dust or



dirt on the lens. When it is necessary to clean the device, slightly wet a soft cloth with alcohol, and gently wipe away the dirt.

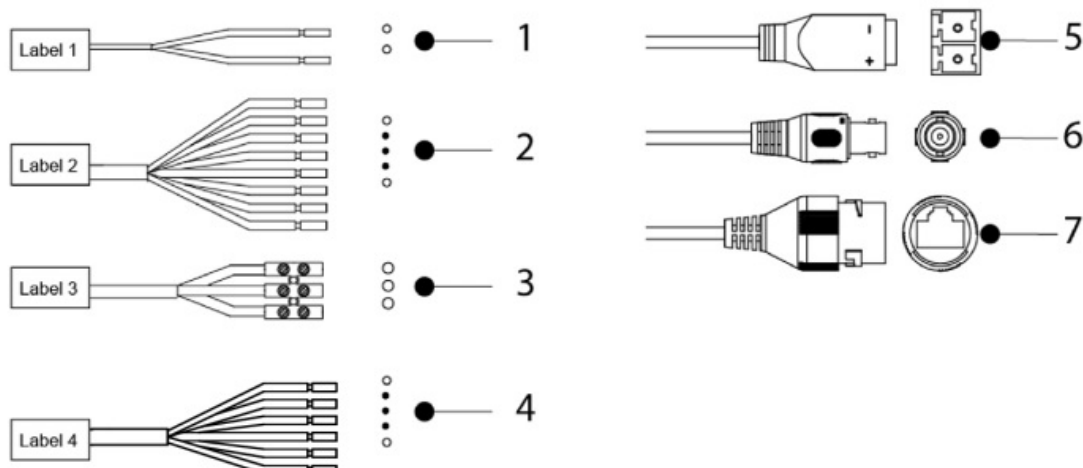
- Clean the device body with a soft dry cloth. If there are any stubborn stains, clean them away with a soft cloth dipped in a neutral detergent, and then wipe the surface dry. Do not use volatile solvents such as ethyl alcohol, benzene, diluent, or abrasive detergents on the device to avoid damaging the coating and degrading the performance of the device.
- The dome cover is an optical component. When it is contaminated with dust, grease, or fingerprints, use degreasing cotton moistened with a little ether or a clean soft cloth dipped in water to gently wipe it clean. An air gun is useful for blowing dust away.
- It is normal for a camera made of stainless steel to develop rust on its surface after being used in a strong corrosive environment (such as the seaside, and chemical plants). Use an abrasive soft cloth moistened with a little acid solution (vinegar is recommended) to gently wipe it away. Afterwards, wipe it dry.

## Introduction

### Cable

- Waterproof all the cable joints with insulating tape and waterproof tape to avoid short circuits and water damage. For details, see FAQ manual.
- This chapter comprehensively details cable composition. Note that the actual product might not include all described features. During installation, refer to this chapter to understand cable interface functionalities.

Figure 1-1 Cables





**Table 1-1 Cable information**

No.	Port name	Description
1	RS-485 port	Reserved port.
2	Alarm I/O	Includes alarm signal input and output ports, the number of I/O ports might vary on different devices. For details, see Table 1-3 .
		36 VDC power input.
		● Red: 36 VDC+
		● Black: 36 VDC-
3	Power input	● Yellow and green: Grounding wire
		Device abnormality or damage could occur if power is not
		supplied correctly.
4	Audio	Includes audio input and output ports. For detailed information, see Table 1-2 .
5	Power output	Supplies 12 VDC (2 W) power for external devices.

No.	Port name	Description
6	Video output	BNC port. Connects to TV monitor to check image when outputting analog video signal.



7	Ethernet port	<ul style="list-style-type: none"> <li>● Connects to network with network cable.</li> <li>● Provides power to the camera with PoE.</li> </ul> <p>PoE is available on select models.</p>
---	---------------	---

**Table 1-2 Audio I/O**

Port Name	Description
AUDIO_OUT	Connects to speakers to output audio signal.
AUDIO_IN 1	Connects to sound-pick-up devices to receive audio signal.
AUDIO_IN 2	
AUDIO_GND	Ground connection.

**Table 1-3 Alarm information**

Port Name	Description
ALARM_OUT	Outputs alarm signals to alarm device.
ALARM_OUT_GND	When connecting to alarm device, only the ALARM_OUT port and ALARM_OUT_GND port with the same number can be used together.
ALARM_IN	Receives the switch signals of external alarm source.
ALARM_IN_GND	Connect different alarm input devices to the same ALARM_IN_GND port.

## Connecting Alarm Input/Output



The camera can connect to external alarm input/output devices through the digital input/output port.

Alarm input/output is available on select models.

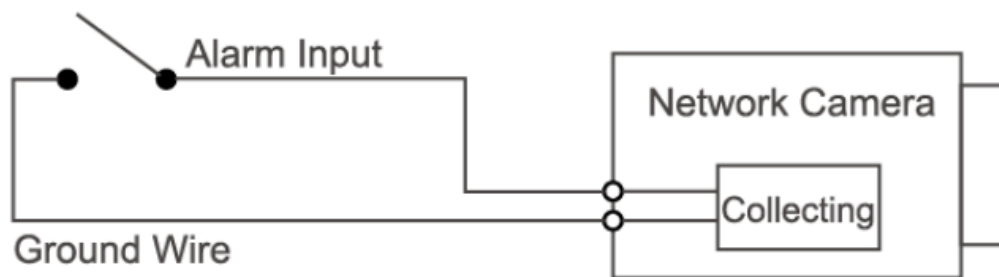
## Procedure

**Step 1** Connect the alarm input device to the alarm input end of the I/O port.

The device collects different status of the alarm input port while the input signal is idling and being grounded.

- Device collects logic “1” when the input signal is connected to +3 V to +5 V or idling.
- Device collects logic “0” when the input signal is grounded.

Figure 1-2 Alarm input



**Step 2** Connect the alarm output device to the alarm output end of the I/O port. The alarm output is a relay switch output, which can only connect to OUT\_GND alarm devices.

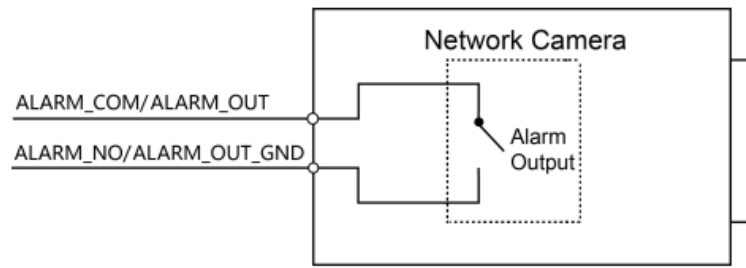
ALARM\_OUT(ALARM\_COM) and ALARM\_OUT\_GND(ALARM\_NO) constitute a switch that provides the alarm output.

The switch is open normally and closed when there is an alarm output.

ALARM\_COM might represent ALARM\_C or C; ALARM\_NO might represent N. The following figure is for reference only, please refer to the actual device for more information.



Figure 1-3 Alarm output



**Step 3** Log in to the webpage, and then configure the alarm input and alarm output in alarm settings.

- The alarm input on the webpage corresponds to the alarm input end of the I/O port. There will be high level and low level alarm signals generated by the alarm input device when an alarm occurs. Set the input mode to “NO” (default) if the alarm input signal is logic “0”, and set to “NC” if the alarm input signal is logic “1”.
- The alarm output on the webpage corresponds to the alarm output end of the device, which is also the alarm output end of the I/O port.

## Network Configuration

Device initialization and IP configurations can be managed through ConfigTool.

- Device initialization is available on select models, and is required at first-time use and after the device is reset.
- Device initialization is available only when the IP addresses of the device (192.168.1.108 by default) and the computer are on the same network segment.
- Carefully plan the network segment for the device.
- The following figures and pages are for reference only.

## Initializing the Camera

### Procedure

**Step 1** Search for the device that needs to be initialized through ConfigTool.

1. Double-click ConfigTool.exe to open the tool.
2. Click Modify IP.



3. Select the search conditions, and then click OK.

**Step 2** Select the device to be initialized, and then click Initialize.

Enter the email address for password reset. Otherwise, you can only reset the password through the XML file.

Figure 2-1 Password setting

Device initialization

1 device(s) have not been initialized

Username: admin

New Password: [masked]

Weak Medium Strong

Confirm Password: [masked]

Use a password that has 8 to 32 characters, it can be a combination of letter(s), number(s) and symbol(s) with at least two kinds of them. (excluding Single quote('), double quote("), colon(:), semicolon(;), connection symbol(&))

☒ Email Address: 1\*\*\*\*6@gmail.com (for password reset)

Select P/N: PAL

\*After you have set new password, please set password again in "Search Setting".

Next

**Step 3** Select Auto-check for updates , and then click OK to initialize the device.

If initialization fails, click  to see more information.

## Changing the Device IP Address

### Background Information

- You can change the IP address of one or more devices at a time. This section uses changing IP addresses in batches as an example.
- Changing IP addresses in batches is available only when the corresponding devices have the same login password.



## Procedure

**Step 1** Search for the device whose IP address needs to be changed through ConfigTool.

1. Double-click ConfigTool.exe to open the tool.
2. Click Modify IP.
3. Select the search conditions, enter the username and password, and then click OK.  
The username is admin, and the password should be the one that you set while initializing the device.

**Step 2** Select one or more devices, and then click Modify IP.

**Step 3** Configure the IP address.

- Static mode: Enter Start IP, Subnet Mask, and Gateway, and then the IP addresses of the devices will be modified successively starting from the first IP entered.
- DHCP mode: When the DHCP server is available on the network, the IP addresses of devices will be automatically assigned through the DHCP server.  
The same IP address will be set for multiple devices if you select the Same IP checkbox.

**Step 4** Click OK.

## Logging in to the Webpage

### Procedure

- **Step 1** Open the IE browser, enter the IP address of the device in the address bar, and then press the Enter key.  
If the setup wizard opens, follow the on-screen instructions to complete it.
- **Step 2** Enter the username and password in the login box, and then click Login.
- **Step 3** (Optional) For the first-time login, click Click Here to Download Plugin, and then install the plugin as instructed.  
The home page opens when the installation is complete.



## Smart Track Configuration

Enable smart track, and then configure the tracking parameters. When any anomaly is detected, the PTZ camera would track the target until it gets out of the surveillance range.

### Prerequisites

Heat map, intrusion, or tripwire on the panoramic camera should be configured beforehand.

### Enabling Linkage Track

Background Information

**Linkage Track** is not enabled by default. Please enable it when necessary.

### Procedure


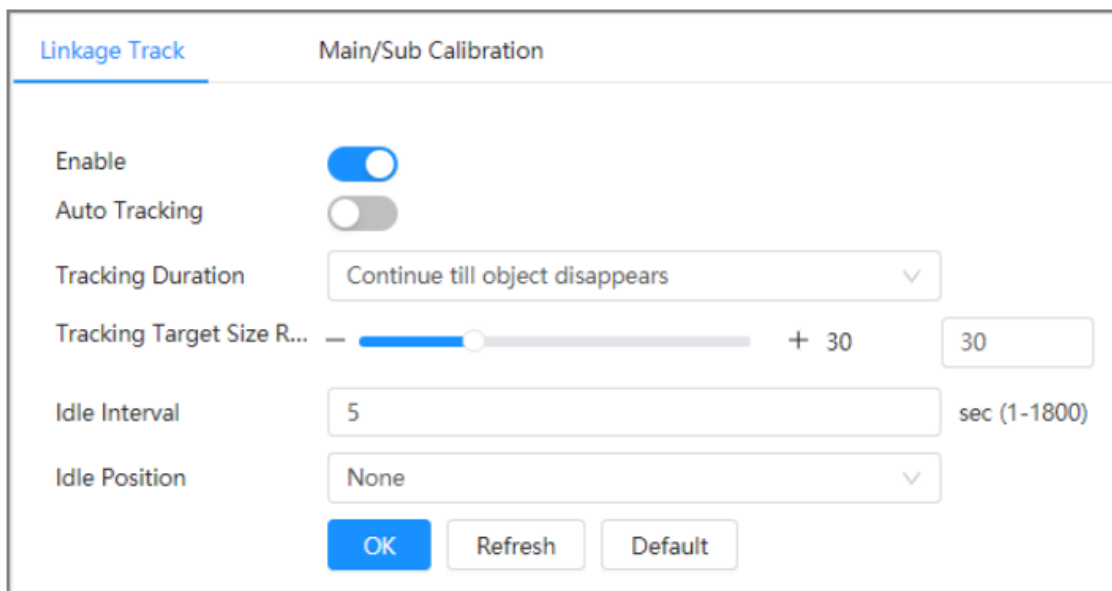
- Step 1 Select AI > Panoramic Linkage > Linkage Track.
- Step 2 Click  next to enable to enable Linkage Track.

Figure 3-1 Linkage track



Parameter	Value
Enable	Enabled
Auto Tracking	Disabled
Tracking Duration	Continue till object disappears
Tracking Target Size R...	30
Idle Interval	5 sec (1-1800)
Idle Position	None

- Step 3 Configure other parameters and then click OK. For details, see web operation manual.

### Configuring Calibration Parameter

### Background Information



Auto calibration mode is available on select models.

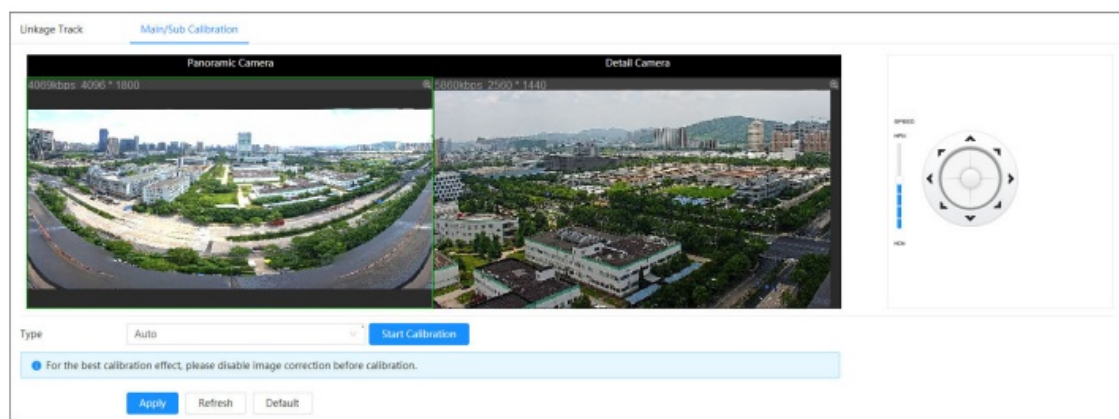
## Procedure

- Step 1 Select AI > Panoramic Linkage > Main/Sub Calibration.
- Step 2 Configure calibration parameters.

### Auto calibration

Select Auto in Type, and then click Start Calibration.

Figure 3-2 Auto calibration

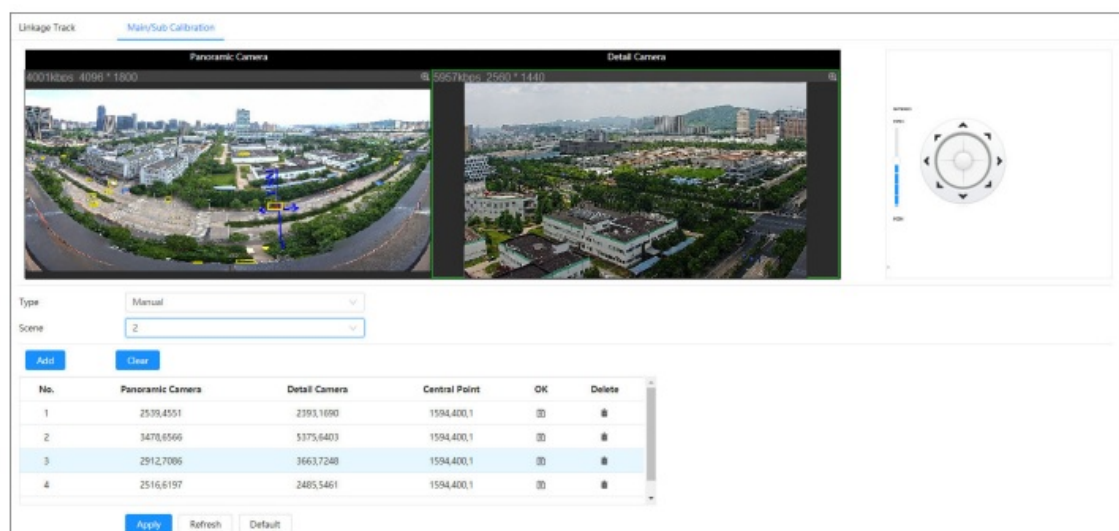


### Manual calibration

Select Manual in Type, select the scene, and then add calibration point for it in the live image.

Web pages might vary with different models.

Figure 3-3 Manual calibration





1. Adjust the speed dome lens and turn it to the same view as the chosen lens, and then click Add.

The calibration dots are displayed in both images.

2. Pair each dot in the two images, and keep the paired dots at the same spot of the live view.

3. Click .

At least 4 pairs of calibration dots are needed to ensure the views of the PTZ camera and the panoramic camera as similar as possible.

**Step 3** Click Apply.

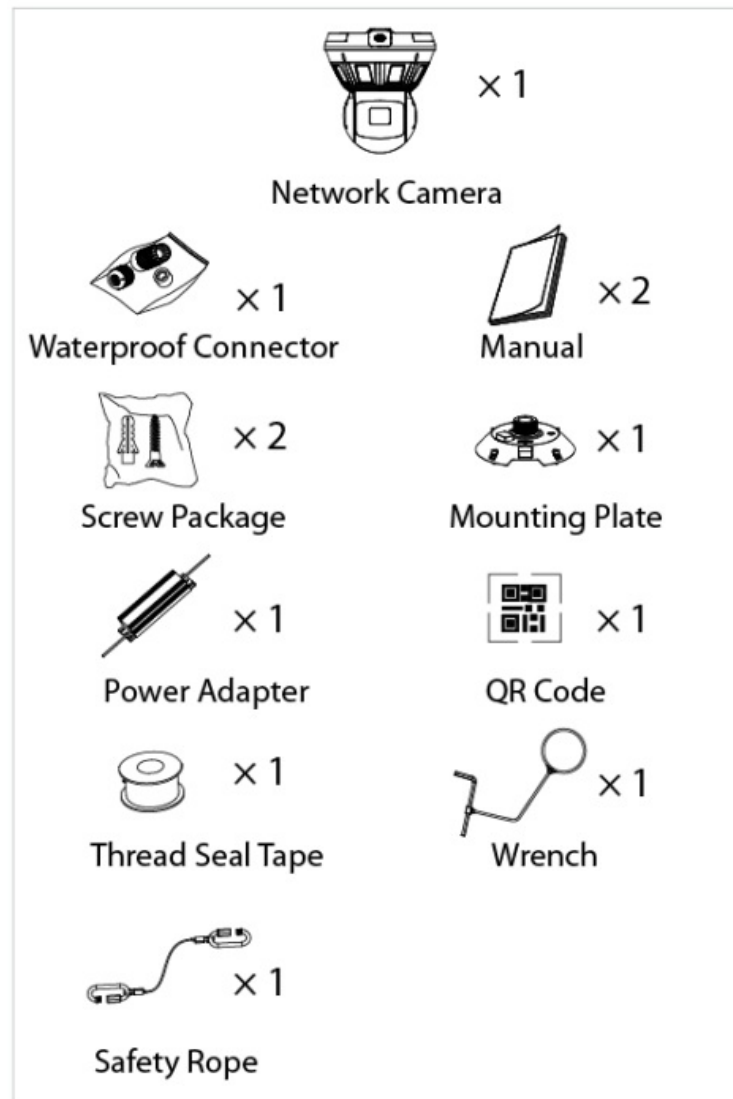
## Installation

### Packing List

- Tools required for installation, such as the electric drill, are not included in the package.
- The operation manual and information on the tools are in the QR code.



Figure 4-1 Packing list



## Installing the Camera

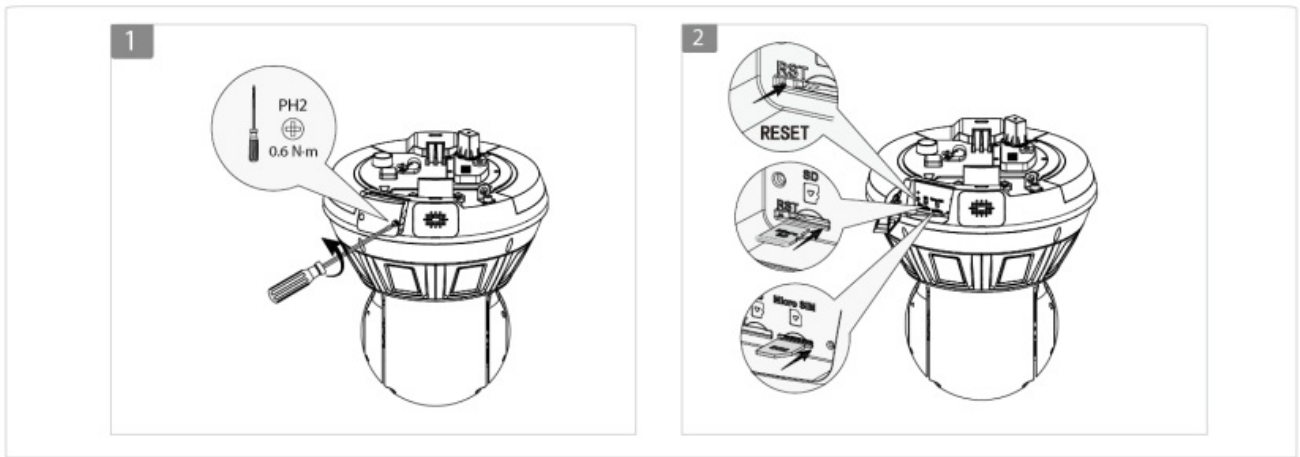
### (Optional) Installing SD/SIM Card

- SD/SIM card slot is available on select models.
- Disconnect the power before installing or removing the SD/SIM card.

You can press the reset button for 10 seconds to reset the device as needed, which will restore the device to factory settings.



Figure 4-2 Install the SD/SIM card



## Attaching the Camera

Make sure that the mounting surface is strong enough to hold at least 3 times the weight of the camera and bracket.

Figure 4-3 Wall mount

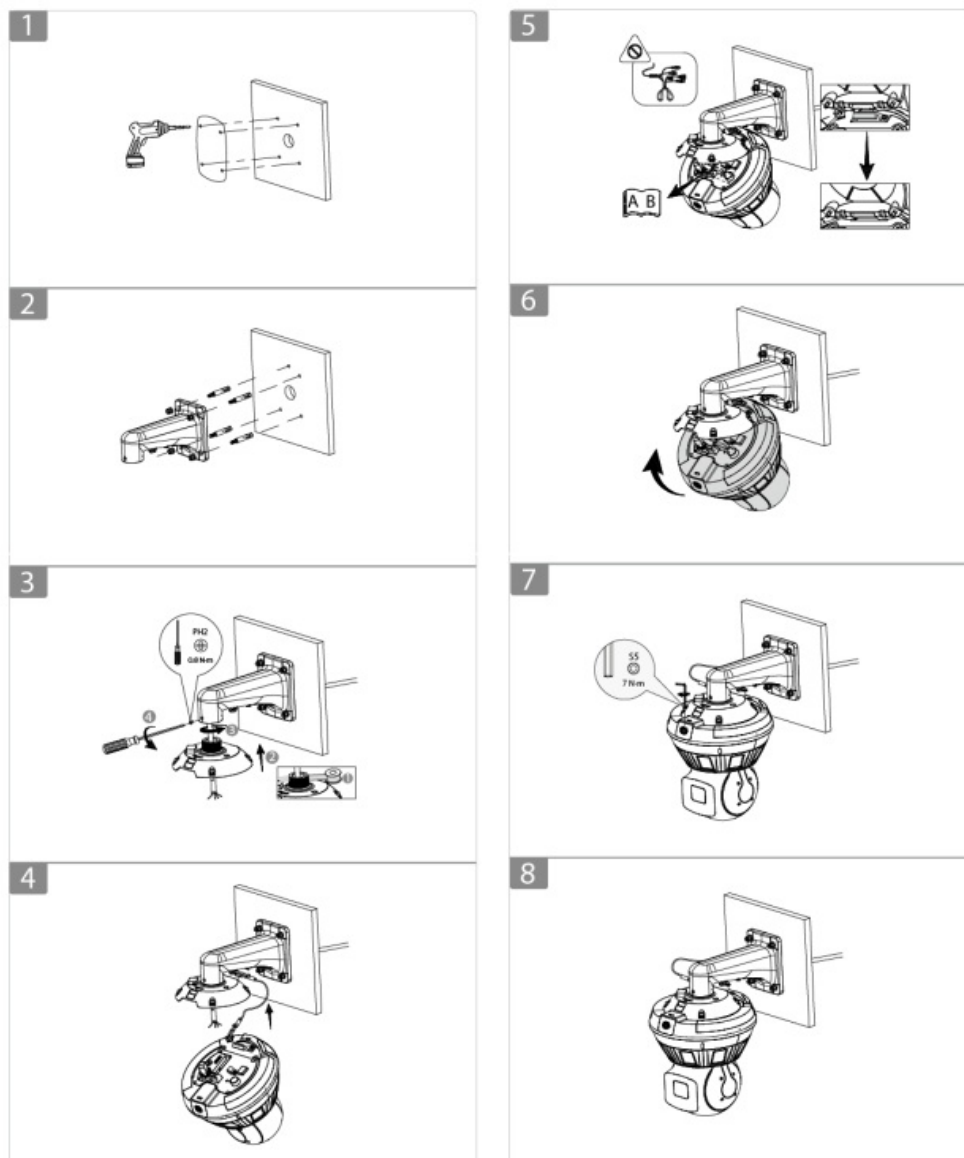
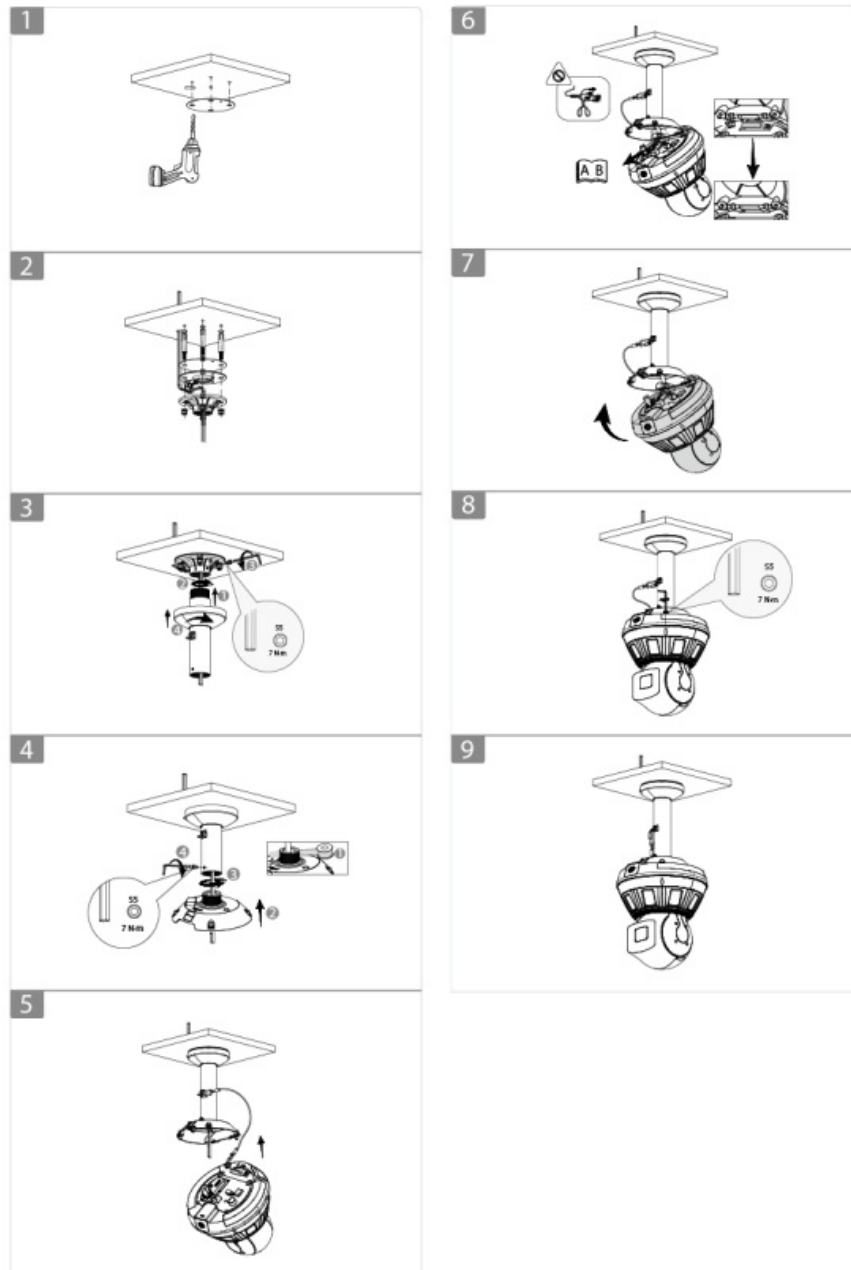




Figure 4-4 Ceiling mount

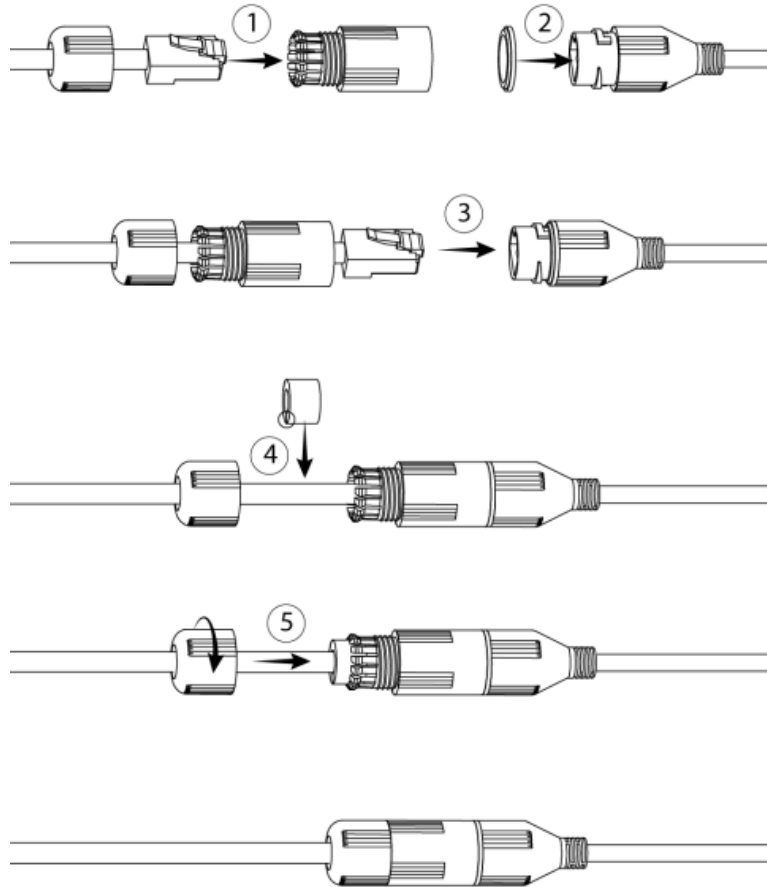


### (Optional) Installing Waterproof Connector

This section is only necessary if a waterproof connector is included in your package, and the device is installed outdoors.

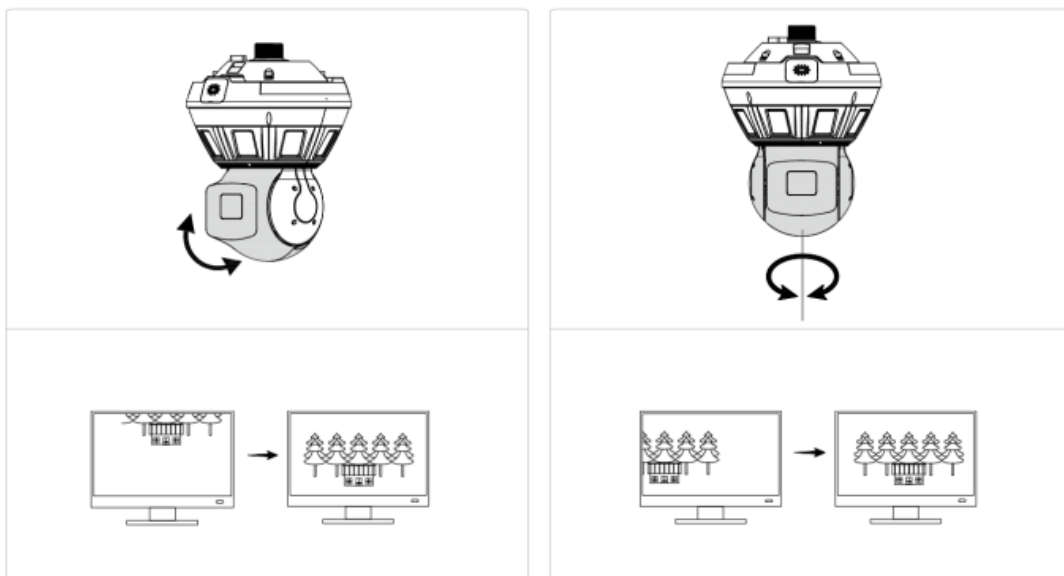


Figure 4-5 Install the waterproof connector



## Adjusting Lens Angle

Figure 4-6 Adjust the lens angle



**ENABLING A SAFER SOCIETY AND SMARTER LIVING**

ZHEJIANG DAHUA VISION TECHNOLOGY CO., LTD

Address: No.1199 Bin'an Road, Binjiang District, Hangzhou, P. R. China | Website:

[www.dahuasecurity.com](http://www.dahuasecurity.com) | Postcode: 310053



## FAQ


Q: Can I use any power adapter with the camera?

A: It is recommended to use the power adapter provided with the device to ensure compatibility and safety. When selecting an alternative adapter, ensure it meets the requirements specified in the manual.

Q: What should I do if the device is exposed to liquid during transportation?

A: If the camera comes into contact with liquid during transportation, immediately disconnect it from any power source and allow it to dry completely before attempting to use it.

## Documents / Resources

	<p><a href="#">Dahua TECHNOLOGY Multi Sensor Panoramic Network Camera and PTZ Camera [pdf]</a> User Guide</p> <p>Multi Sensor Panoramic Network Camera and PTZ Camera, Sensor Panoramic Network Camera and PTZ Camera, Panoramic Network Camera and PTZ Camera, Network Camera and PTZ Camera, PTZ Camera</p>
---	---

## References

- [User Manual](#)

■ Dahua

Technology

◆ Dahua Technology, Multi Sensor Panoramic Network Camera and PTZ Camera, Network Camera and PTZ Camera, Panoramic Network Camera and PTZ Camera, Ptz Camera, Sensor Panoramic Network Camera and PTZ Camera

---

## Leave a comment



Your email address will not be published. Required fields are marked \*

Comment \*

Name

Email

Website

☐ Save my name, email, and website in this browser for the next time I comment.

**Post Comment**

**Search:**

e.g. whirlpool wrf535swhz

**Search**

[Manuals+](#) | [Upload](#) | [Deep Search](#) | [Privacy Policy](#) | [@manuals.plus](#) | [YouTube](#)

This website is an independent publication and is neither affiliated with nor endorsed by any of the trademark owners. The "Bluetooth®" word mark and logos are registered trademarks owned by Bluetooth SIG, Inc. The "Wi-Fi®" word mark and logos are registered trademarks owned by the Wi-Fi Alliance. Any use of these marks on this website does not imply any affiliation with or endorsement.