

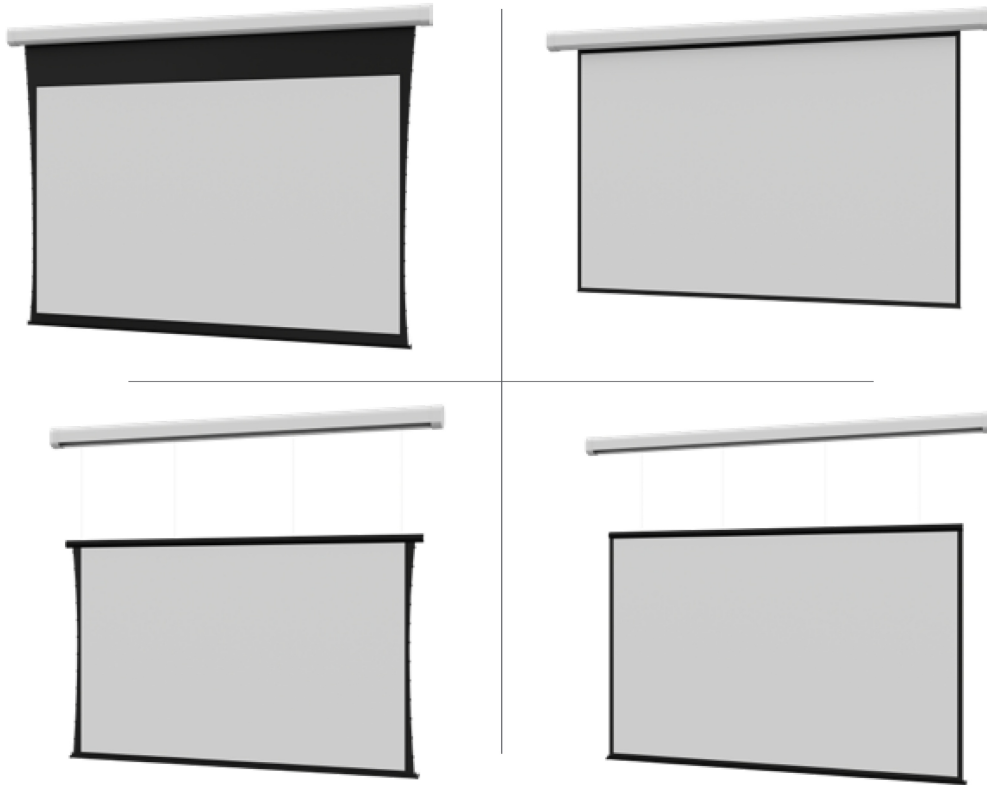
## DA-LITE DL16754 Tensioned and Non Tensioned With and Without Sightline Installation Guide

[Home](#) » [Da-Lite](#) » DA-LITE DL16754 Tensioned and Non Tensioned With and Without Sightline Installation Guide



### Contents

- 1 [DA-LITE DL16754 Tensioned and Non Tensioned With and Without Sightline](#)
- 2 [PRE-INSTALLATION](#)
- 3 [REQUIRED TOOLS](#)
- 4 [INSTALLATION](#)
- 5 [WIRING IN END CAPS](#)
- 6 [ALTERNATE WALL SWITCH FOR FOR 230V SCREENS](#)
- 7 [OPERATION OF SCREEN](#)
- 8 [THIRD PARTY CONTROL](#)
- 9 [SCREEN ADJUSTMENT](#)
- 10 [TROUBLESHOOTING](#)
- 11 [CONDITIONS FOR TRANSPORTATION AND STORAGE](#)
- 12 [Specifications:](#)
- 13 [Product Usage Instructions:](#)
  - 13.1 [Pre-Installation:](#)
  - 13.2 [Required Tools:](#)
  - 13.3 [Installation:](#)
- 14 [FAQ:](#)
  - 14.1 [Q: Can I use attachments not recommended by the manufacturer?](#)
  - 14.2 [Q: What should I do if I encounter structural strength issues during installation?](#)
- 15 [Documents / Resources](#)
  - 15.1 [References](#)
- 16 [Related Posts](#)



## INSTALLATION GUIDE

Myriad™ Reveal (tensioned and non-tensioned, with and without SightLine)

### PRE-INSTALLATION

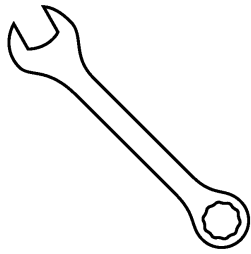
1. Carefully unpack case and remove from shipping carton.
2. Recheck measurements of screen location before installation.

Installation and calibration of the unit should only be performed by an authorized, qualified, and experienced professional. In particular, electrical work and wiring must be completed only by a qualified professional electrician who has read this manual completely and is familiar with the construction and operation of this equipment and the hazards involved.

**PLEASE NOTE:** Projection Screen must be installed in accordance with the requirements of the Local Building Codes, the Canadian Electrical Code (CEC), CAN/CSA C22.1 and the National Electric Code (NEC), NFPA 70. An appropriate disconnect device shall be provided as part of the building installation.

Connections must be made in accordance with attached wiring diagram, and wiring must comply with national and local electrical codes. All operating switches should be “off” before power is connected

### REQUIRED TOOLS



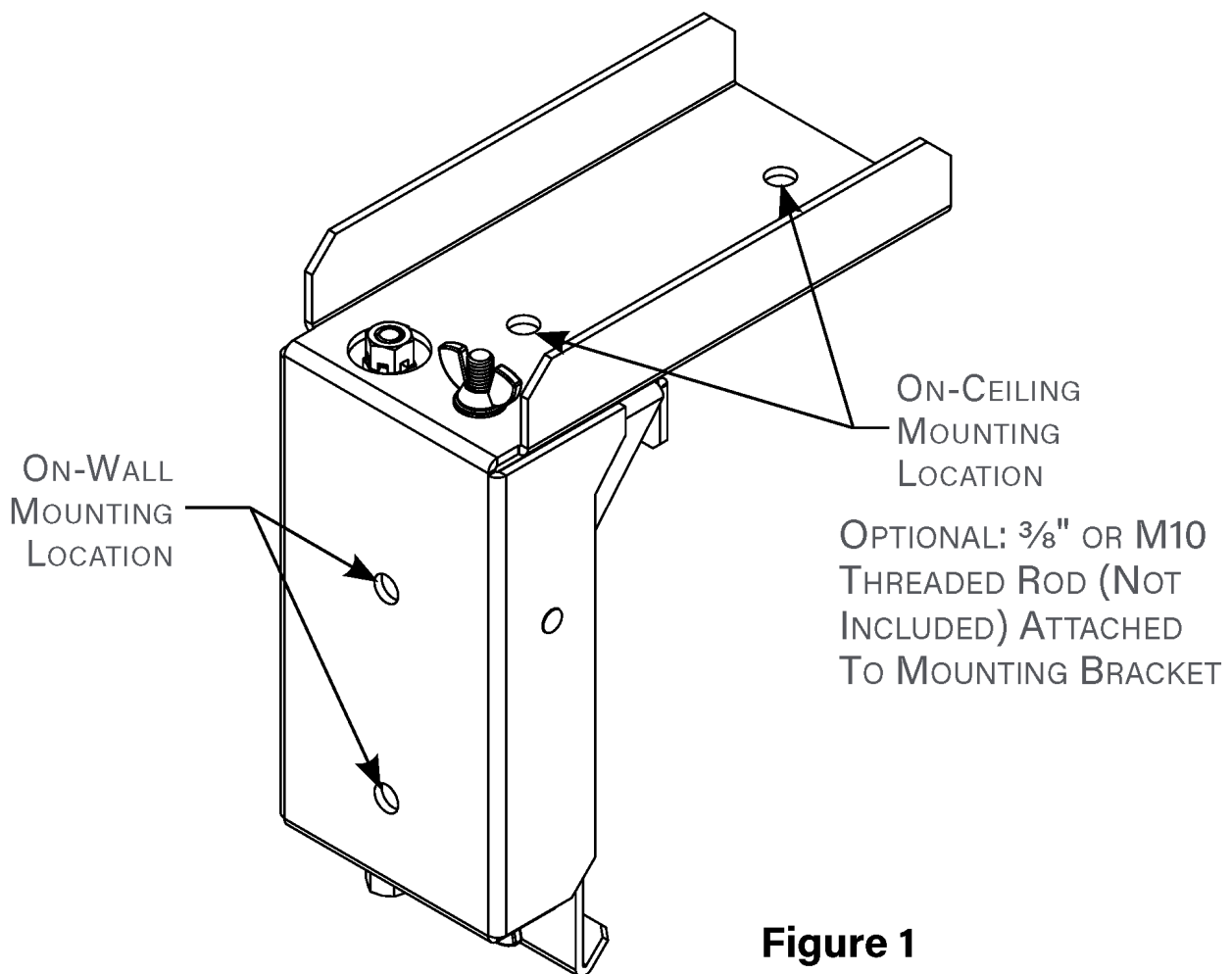
M8 open wrench  
or socket driver

## INSTALLATION

1. Remove the mounting brackets and mount them to the desired location.

a. On wall: screw into wall from back (Figure 1)

**NOTE:** For stud wall mounting, use wood stud (2 by 4) for wall mount and metal frame of the building b. On ceiling: screw into ceiling from top (Figure 1)



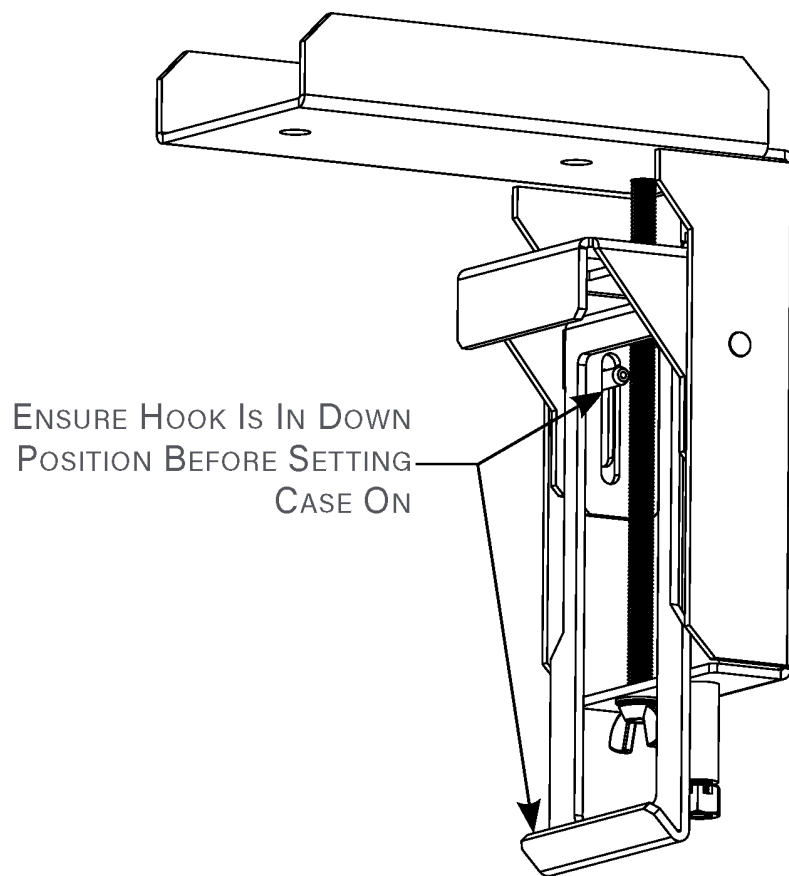
**Figure 1**

2. On ceiling suspended using 3/8" or M10 threaded rod (not included).

**NOTE:** All 3 mounting brackets must be used for wall or ceiling mount. It is recommended to place the center bracket +/- 12" [305 mm] from the center of the case and remaining brackets within 36" [915 mm] of the ends of the

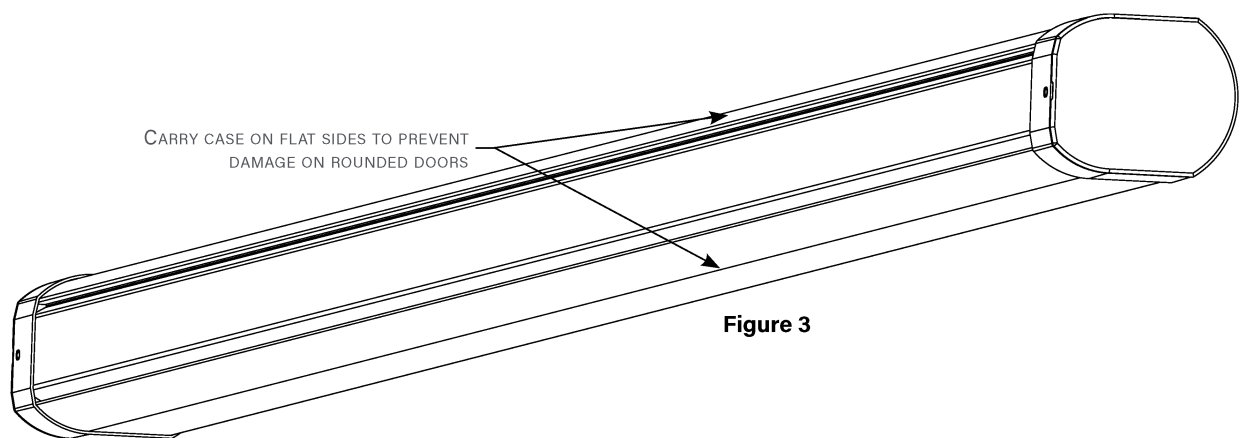
case.

3. Installer to use proper hardware per local code requirements.
4. Make sure all brackets are level.
5. Ensure the hook part of bracket is in the down position before setting the case on (Figure 2).



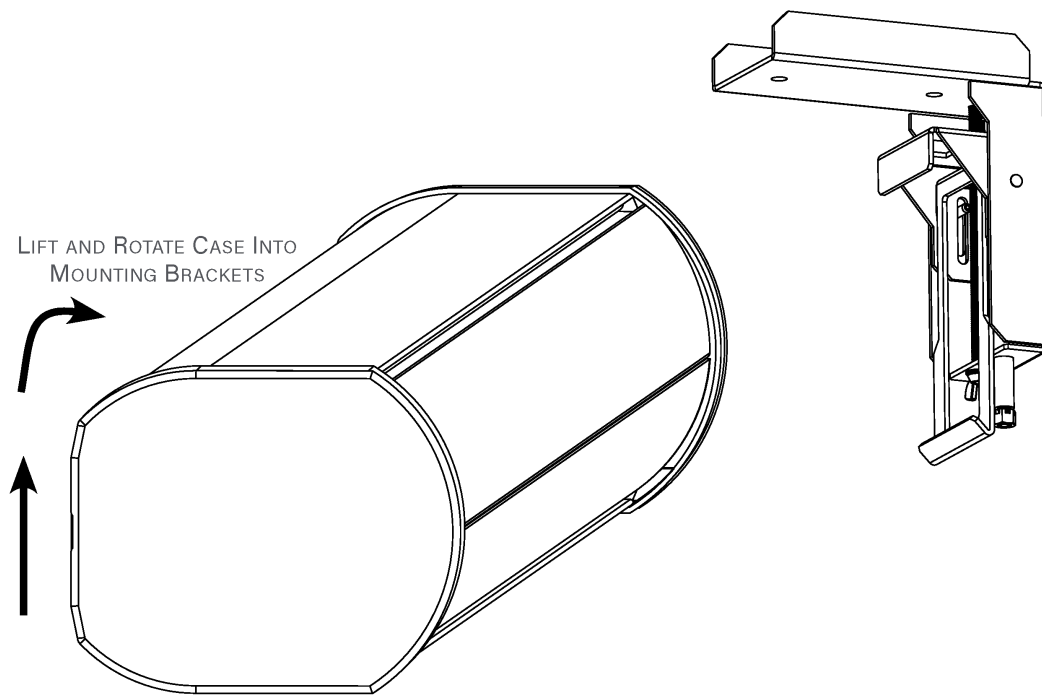
**Figure 2**

6. The case is shipped on its side. Lift the case out of its packaging and carry on its side to prevent damage to the rounded doors (Figure 3).



**Figure 3**

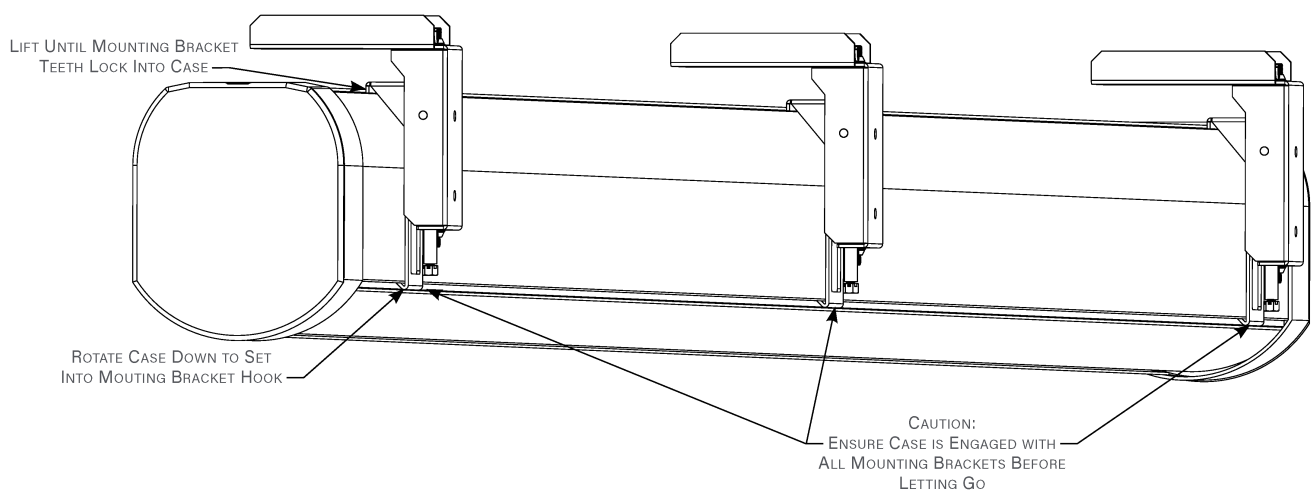
7. Once close to the brackets, lift and rotate the case so that the mounting bracket teeth lock into the case profile (Figure 4).



**Figure 4**

8. Rotate the case down to set into the mounting bracket hook (Figure 5).

a. Caution: ensure the case is engaged with all mounting brackets before releasing



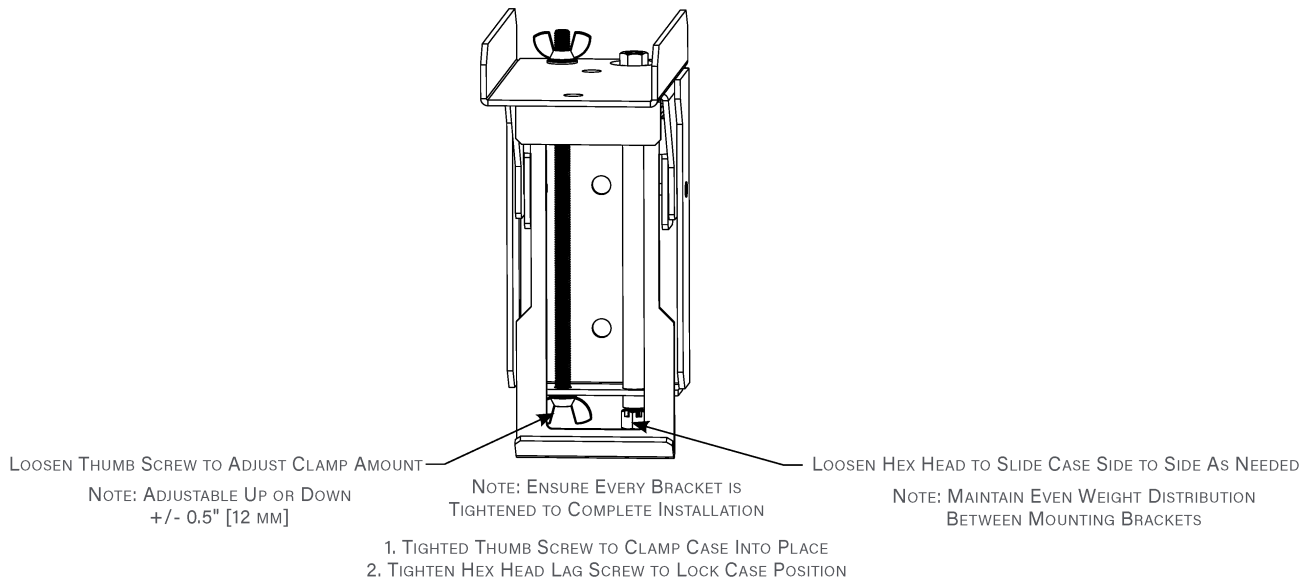
**Figure 5**

## 9. Adjustment options (Figure 6):

a. Left, right: loosen hex head to slide case side to side as needed (while maintaining even weight distribution)

b. Up, down: loosen thumb screw to adjust up or down +/- 0.5" [12 mm]

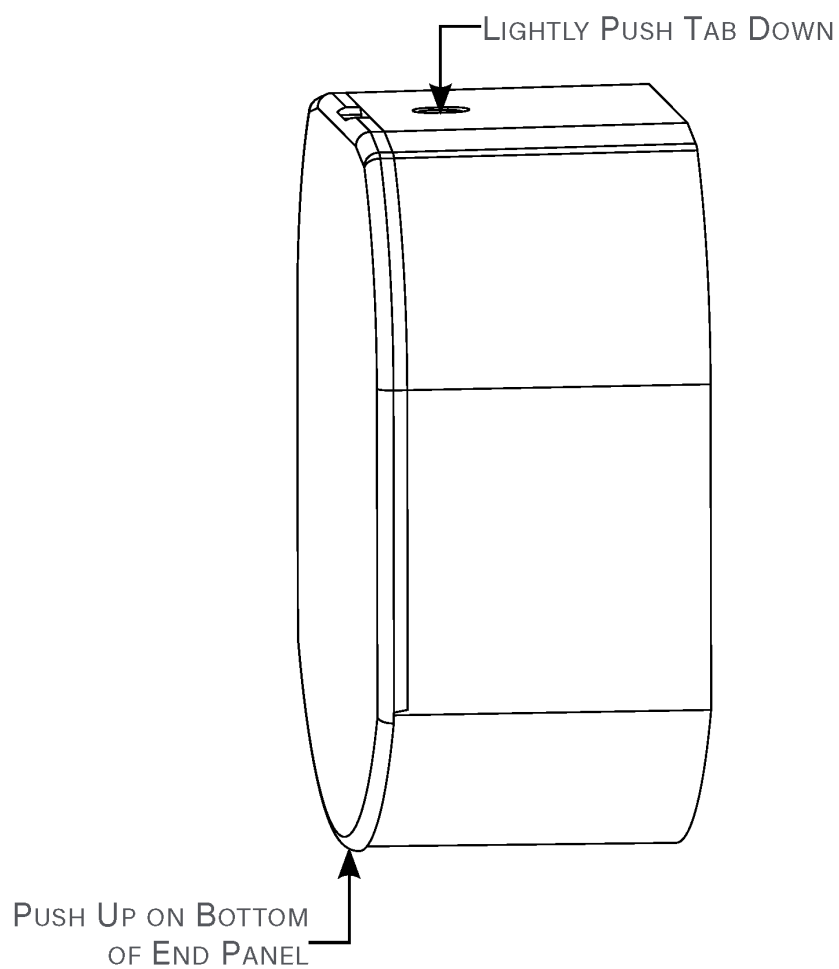
10. Clamp the mounting bracket down with thumb screw. Tighten the hex head screw to keep the case in place



## WIRING IN END CAPS

### Remove End Panel

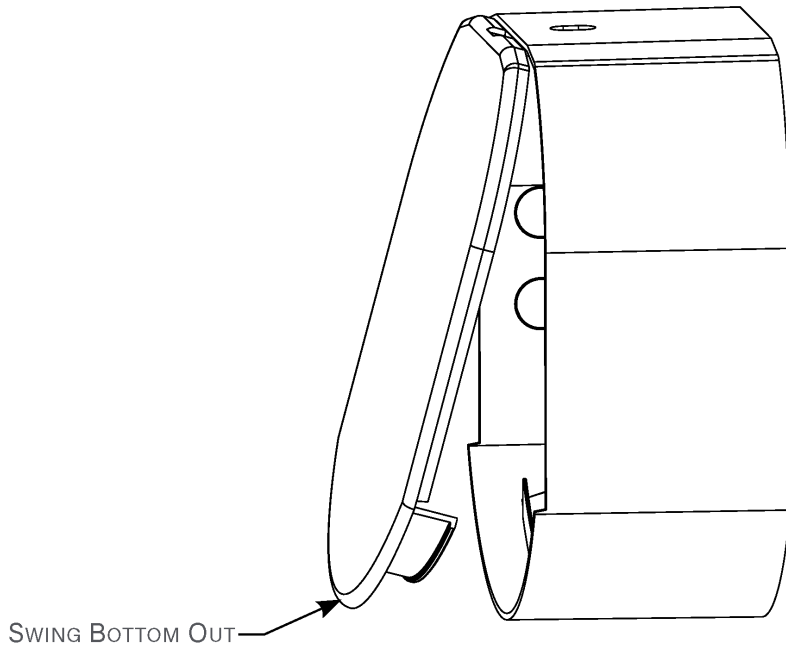
1. Push up on the bottom of the panel and lightly push the tab down (Figure 7).



END PANEL REMOVE

**Figure 7**

2. Swing the bottom out (Figure 8).



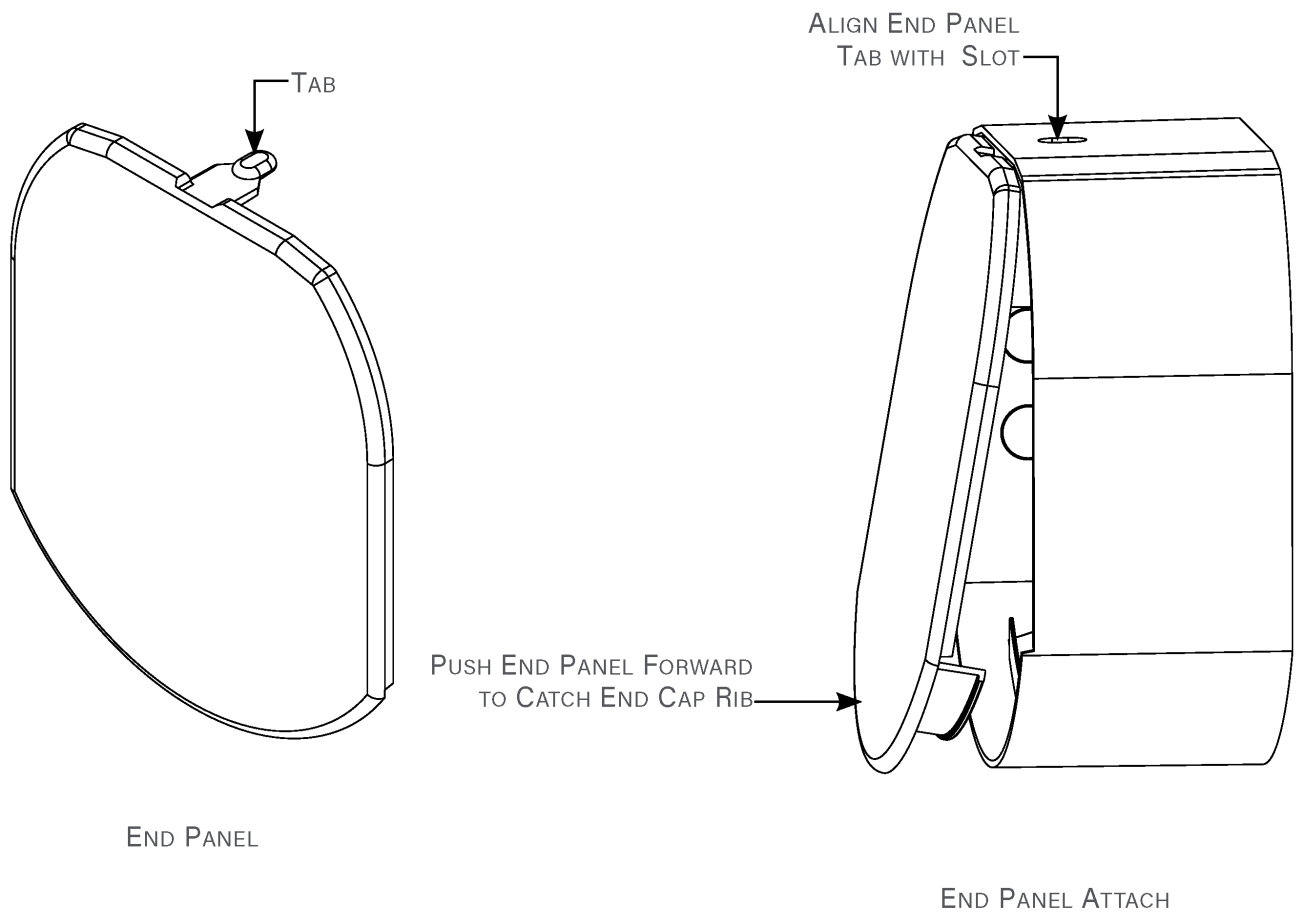
END PANEL REMOVE

**Figure 8**

#### **Attach End Panel**

1. Align the tab on the end panel with the slot on the end cap (Figure 9).
2. Push the bottom of the end panel forward to snap onto the rib inside the end cap (Figure 9).

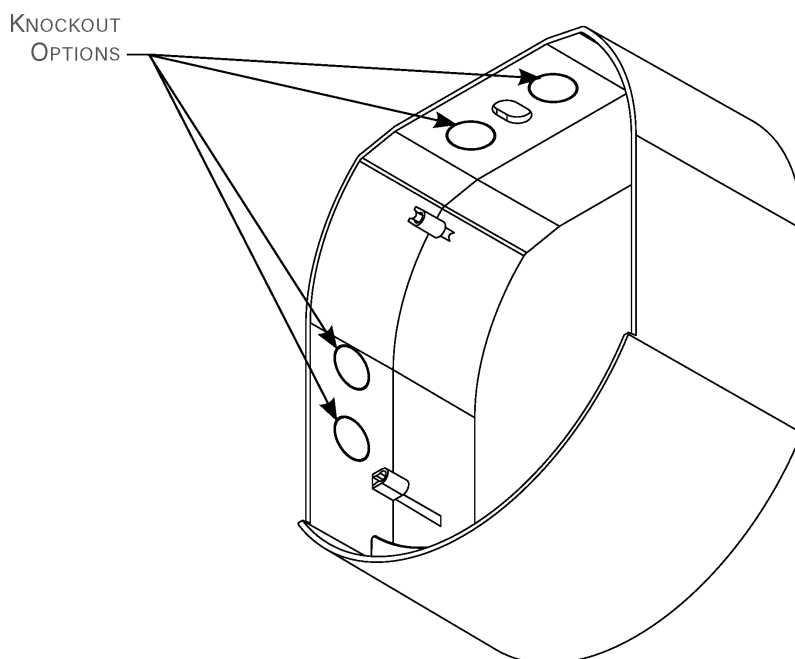




**Figure 9**

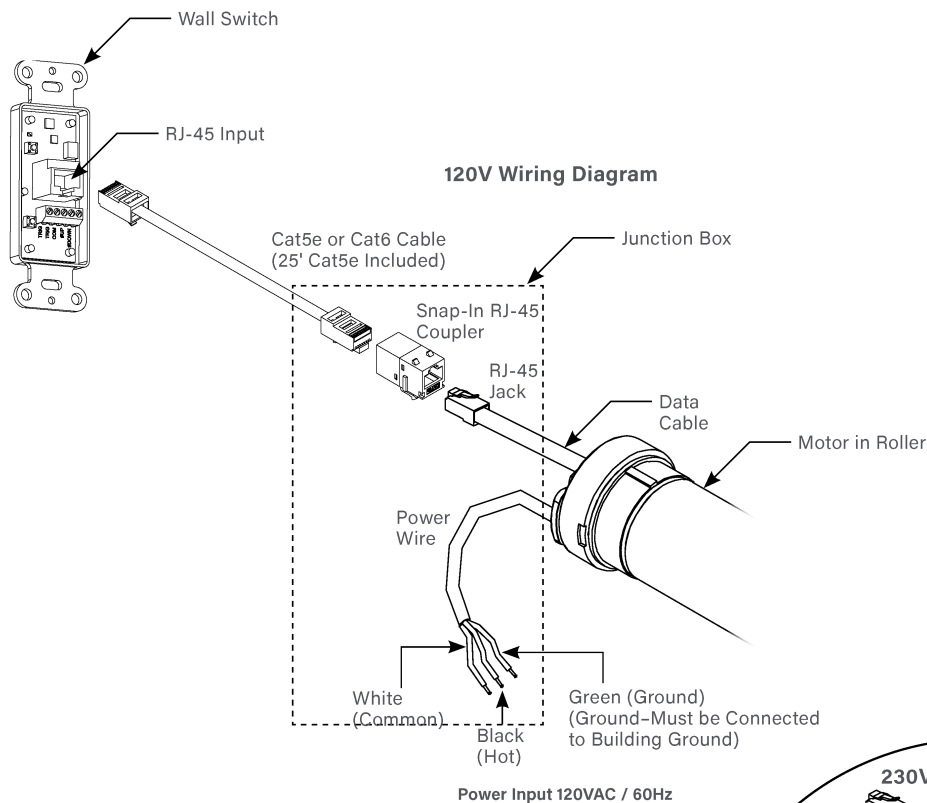
## Knockouts and Wiring

1. Each end cap has wiring knockout options (Figure 10).

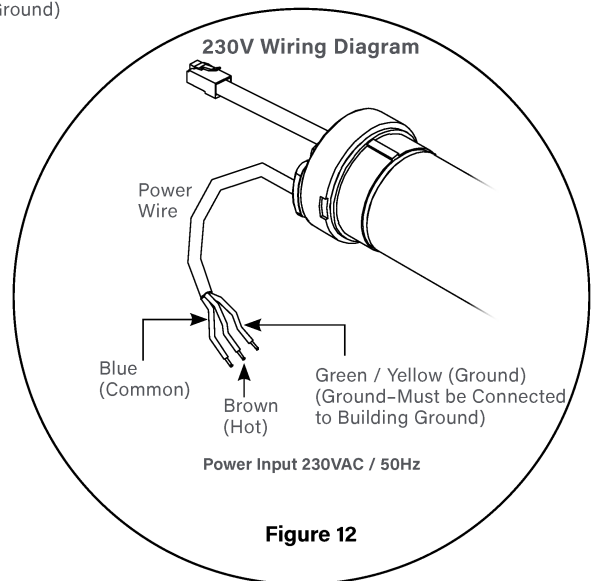


**Figure 10**

2. Remove the chosen knockout location.
3. The power cable is connected to the plate.  
Run wires out of the knockout to the power connection
4. Plug the Cat5e cable into the RJ-45 connector (Figure 11).
5. Connect the Cat5e cable included to the wall switch (Figure 11).



**Figure 11**



**Figure 12**

## ALTERNATE WALL SWITCH FOR FOR 230V SCREENS

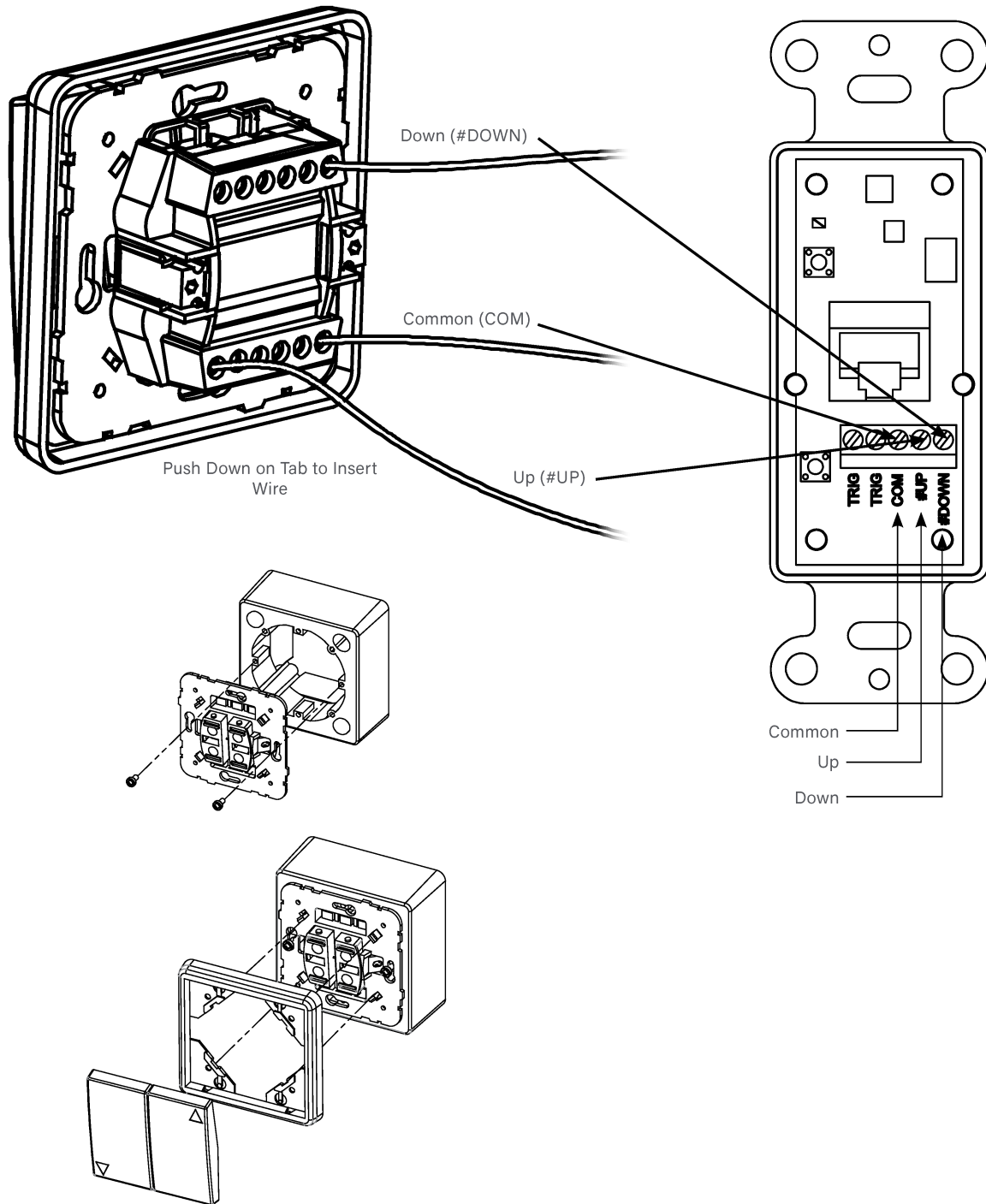
### 230V Wiring Diagram with Optional European Style Wall Switch

Use 3-conductor 20–24 gauge wire to connect European style wall switch to the COM, #UP, and #DOWN to the limit adjustment wall switch

**IMPORTANT NOTE:** The European style wall switch is for operation only and CANNOT be used to make limit switch adjustments. Therefore, it is advised to locate the limit adjustment wall switch in an accessible location.

### European Style Wall Switch

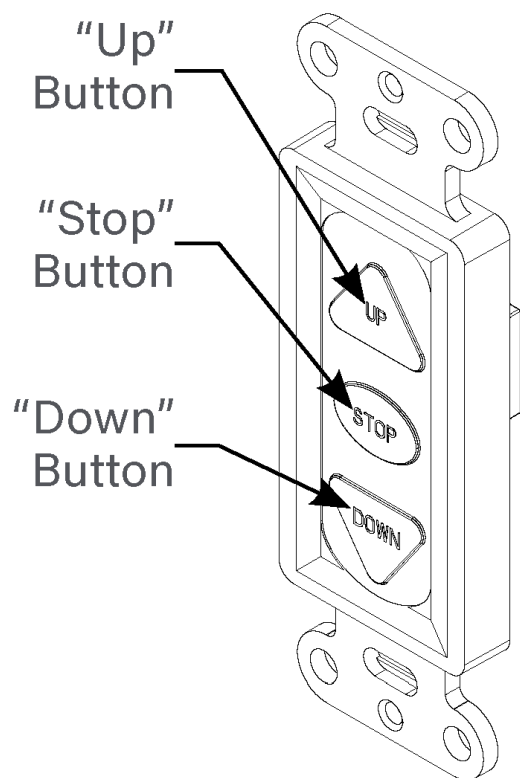
### Limit Adjustment Switch (See Previous Page for Wiring to Screen)



## OPERATION OF SCREEN

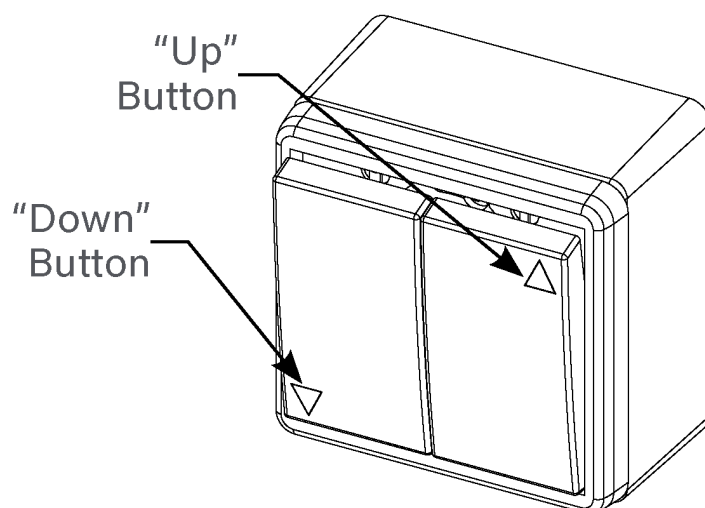
### Operation & Limit Adjustment Wall Switch

1. Press "DOWN" button on screen switch and screen will deploy out of case in downward direction.
2. Press "STOP" button on screen switch and screen will stop if in movement.
3. Press "UP" button on screen switch and screen will retract upward into case.



#### **European Style Wall Switch (230V models only)**

1. Press "DOWN" button on screen switch and screen will deploy out of case in downward direction.
2. Press "UP" button on screen switch and screen will retract upward into case.

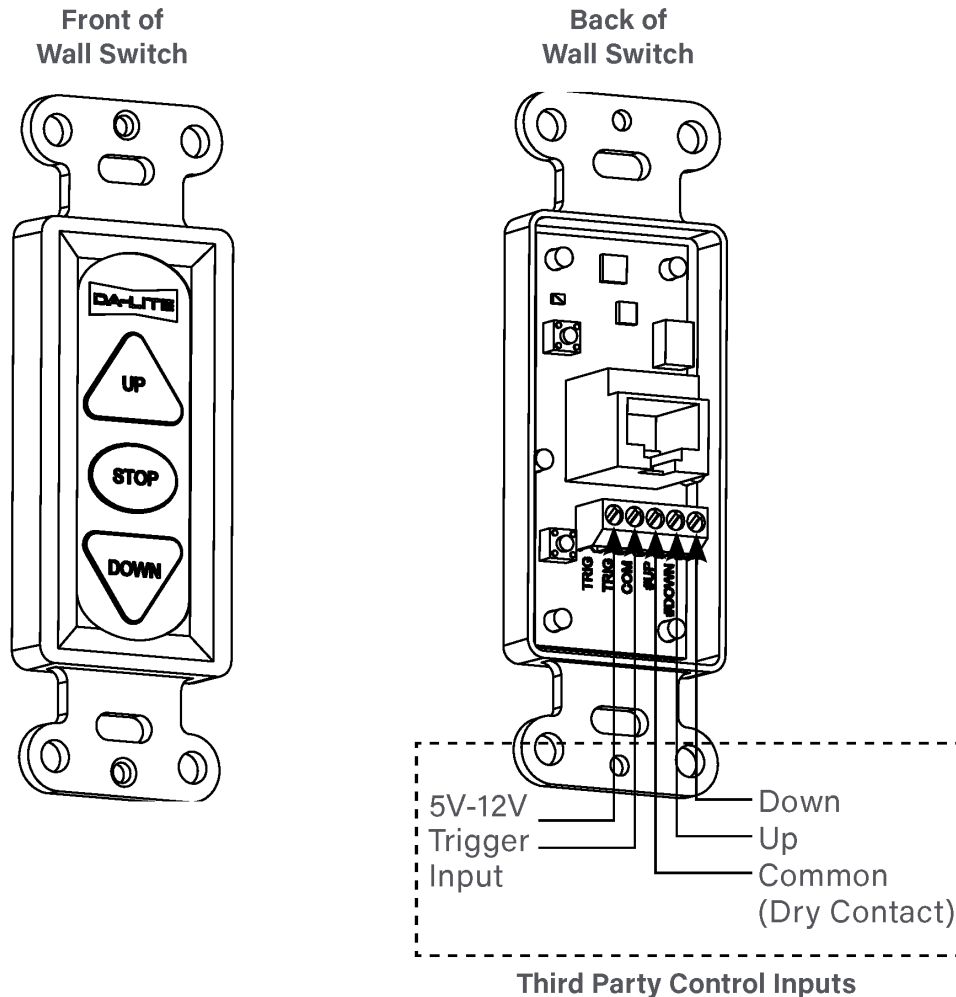


#### **THIRD PARTY CONTROL**

**Control Panel**

A control panel may be connected to the wall switch by using the dry contact Up, Down and Common connections. The control panel must provide a momentary, dry contact closure of at least 1/2 second.

1. Use 3-conductor 20-24 gauge wire to connect the control panel to the Screen Controller.
2. A momentary closure across the COM and #UP inputs will be an “up” command.
3. A momentary closure across the COM and #DN inputs will be a “down” command.
4. A momentary closure across the COM, #UP and #DN inputs will be a “stop” command.



### Projector Trigger

When a 5-12V signal is received from a projector trigger output (or trigger output from any other device) the screen will move to the down position.

When voltage is removed the screen will run to the up position.

Use 2-conductor 18–24 gauge wire to extend the low voltage connection from the 5 to 12-volt trigger output to the TRIG input on the wall switch.

**NOTE:** When extending the low voltage connection from the trigger output polarity does not matter. The wires are interchangeable.

### SCREEN ADJUSTMENT

If general adjustment is needed, please follow the steps below and refer to the Wiring Diagram.

1. Locate the wall switch and remove the cover plate from the wall switch and remove the switch from the junction box.
2. Locate the two tactile buttons on the back of the switch.  
They are black round buttons on silver plates.
3. To adjust the down limit switch, press and hold the down tactile button until the LED on the back of the switch turns solid red. This will put the motor in limit set mode. Turn the wall switch over and use the down button on the front of the switch. Press and hold the down button until the desired down position is reached.

If you travel too far down, press the up button to move the screen upward. If you press and let go of either the up or down buttons, the motor will do a small jog in that direction for fine adjustment of the screen. Once the desired position is reached, turn the switch over; press and hold the down tactile button until the LED on back of switch blinks red twice. The down limit is now set.

**NOTE:** If the screen is in limit set mode and no buttons are pushed for 2 minutes, the LED on the back of the wall switch will turn off, the motor will return to run mode and no changes will be saved. If this occurs, return to step 3 for down limit adjustment or step 4 for up limit adjustment.

4. To adjust the up limit switch, press and hold the up tactile button until the LED on the back of the switch turns solid green. This will put the motor in limit set mode. Turn the wall switch over and use the up button on the front of the switch. Press and hold the up button until the desired up position is reached. If you travel too far up, press the down button to move the screen downward. If you press and let go of either the up or TENSIONED AND NON-TENSIONED MODELS

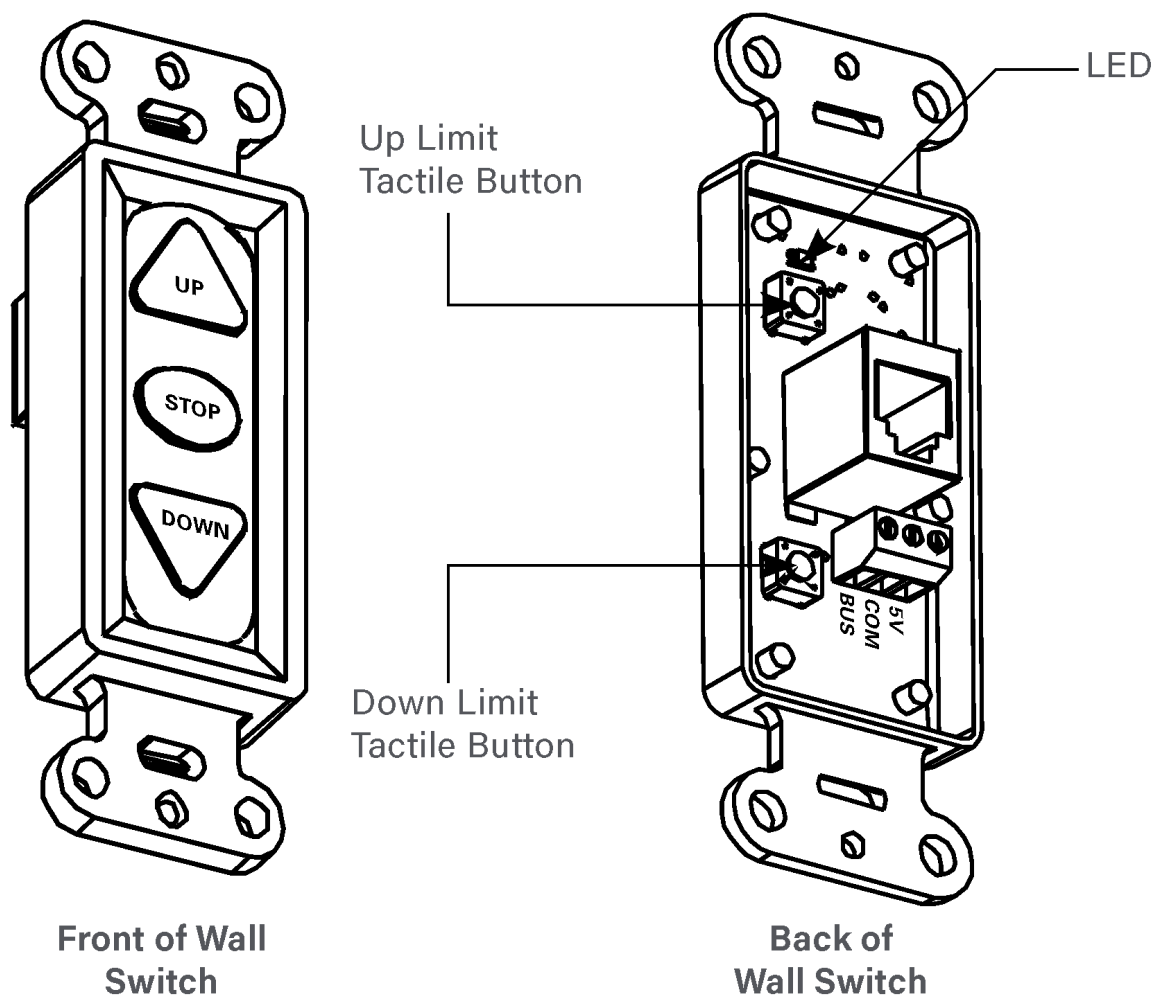
**CAUTION:** Do not adjust for more drop than what was ordered. At least 1–1/2 wraps of fabric must remain on the roller.

#### SIGHTLINE MODELS (TENSIONED AND NONTENSIONED)

**CAUTION:** Do not adjust for more than 16' of wire drop. At least 2 wraps of wire must remain on the roller. This screen comes standard with 0" to 16' of wire drop. See the specification data sheet for details. down buttons, the motor will do a small jog in that direction for fine adjustment of the screen. Once the desired position is reached, turn the switch over; press and hold the up tactile button until the LED on back of switch blinks green twice. The up limit is now set.

5. To test the limit switch settings, press and release the up or down buttons on the switch to operate the screen.
6. Replace the switch and cover plate on the wall.

**IMPORTANT NOTE:** The wall switch is REQUIRED to make any limit switch adjustments, even if a third party control system is used.



## TENSIONED MODELS

CAUTION: Adjusting the down limit switch for less drop by more than 6" can cause the screen surface to lose proper tensioning.

ATTENTION! LE FAIT D'AJOUTER NE DÉROULEZ PAS TROP L'ÉCRAN PLUS DE 15 CM (6PO) AUX INTERRUPTEURS DE FIN DE COURSE PEUT FAIRE PERDRE LA BONNE TENSION À LA SURFACE DE L'ÉCRAN.

NON-TENSIONED AND SIGHTLINE (TENSIONED AND NON-TENSIONED) MODELS

No restrictions on adjusting for less drop.

## TROUBLESHOOTING

SYMPTOM	CAUSE	SOLUTION
Screen will not operate and motor does not hum.	Incorrect line voltage.	Verify 115-125V (or 220-240V). If insufficient voltage, rewire incoming electric line.
	Blown fuse.	Replace fuse.
	Tripped circuit breaker.	Reset circuit breaker.
	No power to operating switch or junction.	Check above. Tighten all loose wire connections. Correct any improper connections. Down Position Check for power across black and white leads. Up Position Check for power across red and white leads.
Screen will not operate and motor does not hum.  Power at junction box.	Thermal overload tripped.	Let motor cool down for 15 minutes. Try again.
	Broken wire in the "down" or "up" position.	Check for continuity. Cut off old splice and reconnect.
	Defective motor, limit switch or capacitor.	Replace motor assembly. NOTE: Motor is a sealed assembly.
	Capacitor burned out.	Replace motor assembly.
Screen does not stop at correct position.	Limit switch out of adjustment.	See Screen Adjustment section.
Noise. NOTE: Screen will operate with a low pitched hum.	Squeaking, rubber end plug rubbing on motor.	Center roller in case.
	Grinding. Foreign object in screen rubbing on roller or fabric.	Remove.
	Gear noise.	Replace motor assembly.
Coasting.	Defective brake.	Replace motor assembly.
Fabric hangs crooked.	Screen not installed properly.	Check for level and plumb.
	Fabric has backed up inside case.	Adjust "down" limit switch slowly until roller is exposed and wrinkle comes out, then readjust for proper drop.
	Fabric is damaged.	Replace fabric.

## CONDITIONS FOR TRANSPORTATION AND STORAGE

- Temperature: Between 40 – 1000F (5 – 400C)
- Relative Humidity: 30% to 70%, non-condensing
- Always keep the projection screen horizontal during transport and storage
- Make sure the entire package is supported when stored Do not stack more than six projection screens on top of each other
- Make sure the heaviest package is places at the bottom of the stack

Screen surface should be allowed to air out once every two months, or otherwise used on a regular basis, if the temperature is above 720F (220C) and at least once every month if the temperature goes above 850F (300C).



C2G | Chief | Da-Lite | Luxul | Middle Atlantic | Vaddio | Wiremold

FOR YOUR IMAGE | [legrandav.com](https://legrandav.com)

USA 866.977.3901 [av.da-lite.support@legrand.com](mailto:av.da-lite.support@legrand.com) CANADA 877.345.4329 [av.da-lite.support@legrand.com](mailto:av.da-lite.support@legrand.com)

EMEA +31 495 580 840 [av.emea.sales@legrand.com](mailto:av.emea.sales@legrand.com) APAC +852 2145 4099 [av.asia.sales@legrand.com](mailto:av.asia.sales@legrand.com)

©2024 Legrand AV Inc. 240215 Rev B 06/24 Da-Lite is a registered trademark of Legrand AV Inc. All other brand names or marks are used for identification purposes and are

## Specifications:

- Product Name: Myriad™ Reveal
- Variants: tensioned and non-tensioned, with and without SightLine
- Model Number: 240215 Rev B DL16754

## Product Usage Instructions:

### Pre-Installation:

1. Carefully unpack the case and remove it from the shipping carton.

### Required Tools:

M8 open wrench or socket driver

### Installation:

1. Remove the mounting brackets and mount them to the desired location:
    - On wall: screw into wall from back
    - On ceiling: screw into ceiling from top
  2. For ceiling suspension using threaded rod: All 3 mounting brackets must be used. Place the center bracket +/- 12" from the center of the case and remaining brackets within 36" of the ends of the case.
  3. Use proper hardware per local code requirements.
  4. Ensure all brackets are level.
  5. Ensure the hook part of the bracket is in the down position before setting the case on.
  6. Lift the case out of its packaging on its side to prevent damage to the rounded doors.
  7. Once close to the brackets, lift and rotate the case so that the mounting bracket teeth lock into the case profile.
  8. Rotate the case down to set into the mounting bracket hook. Ensure all mounting brackets are engaged before releasing.
  9. Adjustment options:
    - Left, right: loosen hex head to slide case side to side as needed while maintaining even weight distribution.
    - Up, down: loosen thumb screw to adjust up or down +/-0.5".
-

## FAQ:


**Q: Can I use attachments not recommended by the manufacturer?**

A: No, using accessory attachments not recommended by the manufacturer may cause a risk of fire, electric shock, or injury to persons.

**Q: What should I do if I encounter structural strength issues during installation?**

A: It is important to reinforce the structure to ensure it can support the weight of all equipment before installing the component. Failure to provide adequate structural strength can result in serious personal injury or equipment damage.

## Documents / Resources

	<p><a href="#">DA-LITE DL16754 Tensioned and Non Tensioned With and Without Sightline</a> [pdf] Installation Guide</p> <p>DL100136EL, DL16754, DL16754 Tensioned and Non Tensioned With and Without Sightline, DL16754, Tensioned and Non Tensioned With and Without Sightline, Tensioned With and Without Sightline, Sightline</p>
---	---

## References

- [av.asia](#)
- [User Manual](#)

[Manuals+](#), [Privacy Policy](#)

This website is an independent publication and is neither affiliated with nor endorsed by any of the trademark owners. The "Bluetooth®" word mark and logos are registered trademarks owned by Bluetooth SIG, Inc. The "Wi-Fi®" word mark and logos are registered trademarks owned by the Wi-Fi Alliance. Any use of these marks on this website does not imply any affiliation with or endorsement.