



CYCPLUS CDZN888-C3 Bike Speed and Cadence Sensor User Guide

[Home](#) » [CYCPLUS](#) » CYCPLUS CDZN888-C3 Bike Speed and Cadence Sensor User Guide

Contents [[hide](#)]

- [1 CYCPLUS CDZN888-C3 Bike Speed and Cadence Sensor](#)
- [2 Packing List](#)
- [3 Specifications](#)
- [4 Instructions for use](#)
- [5 Documents / Resources](#)
- [6 Related Posts](#)

CYCPLUS

CYCPLUS CDZN888-C3 Bike Speed and Cadence Sensor



Packing List

- Speed Cadence Sensor (Battery included)• 1

- Rubber band *2
- Curved rubber mat (For speed sensor) *1
- Flat rubber mat (For cadence sensor) *1
- User guide *1

Specifications

- Color : Black
- Size : 9.5mm x 29.5mm x 38.0mm
- Weight : 9.2g
- Battery : 220mAh CR2032
- Using time : : 600hours(Cadence) / 400hours(Speed)
- Standby lime : 300days
- Protection rating : IP67
- Available objects: Garmin\Wahoo\Zwift\Tacx\Bryton\XOSS\Blackbird etc.
- Protocol standard : The sensor can be connected to all kinds of APPs and devices which support Bluetooth or ANT+

Instructions for use

1. Before using, please open the battery cover, and then remove the transparent insulation spacer.
2. One sensor can not measure speed and cadence at the same time. If you need to measure them simultaneously, please purchase two sensors.
3. For speed measurement, hub width must be more than 38mm.
4. The product is used for cadence measurement by default. Bluetooth name is CYCPLUS C3 when used for cadence measurement. Bluetooth name is CYCPLUS S3 when used for speed measurement.
5. When using the Bluetooth protocol, It can be connected to only one device or APP concurrently. Please disconnect the previous device or APP first when you want to change it.
6. When using the ANT+ protocol, it can be connected to multiple devices at the same time.
7. When using a smartphone APP, you need to search for the sensor. It's invalid to search via the phone's Bluetooth.

Indicator Status (After replacing the battery)	Status
Flashing Green Light	Cadence mode
Flashing Blue Light	Speed mode
Flashing Red Light	Device battery less than 20%

Function one: Speed measurement

1. Open the battery back cover. Toggle switch to S position. Install the battery back cover.
2. Fix the curved rubber mat on the bottom of the product and use a rubber band to fix the sensor on the hub.
3. Turn the bicycle wheel to wake up the sensor and then connect it to a device or APP.

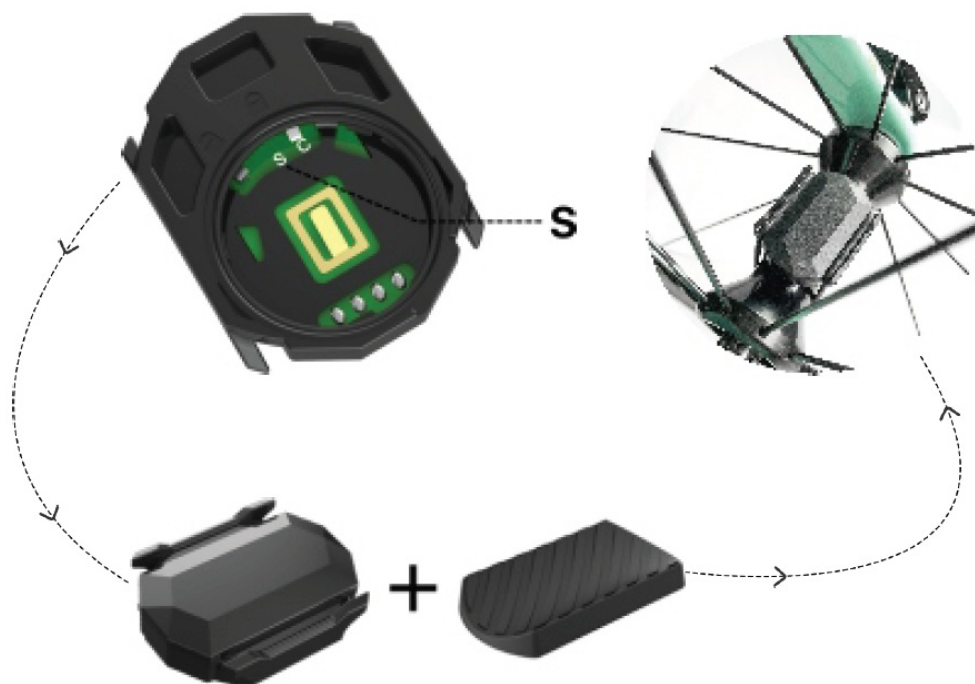

Function two: Cadence measurement.

1. Open the battery back cover. Toggle switch to C position. Install the battery back cover.
2. Fix the flat rubber mat on the bottom of the product and use a rubber band to fix the sensor on the crank.
3. Turn the crank to wake up the sensor, and then connect it to a device or APP.

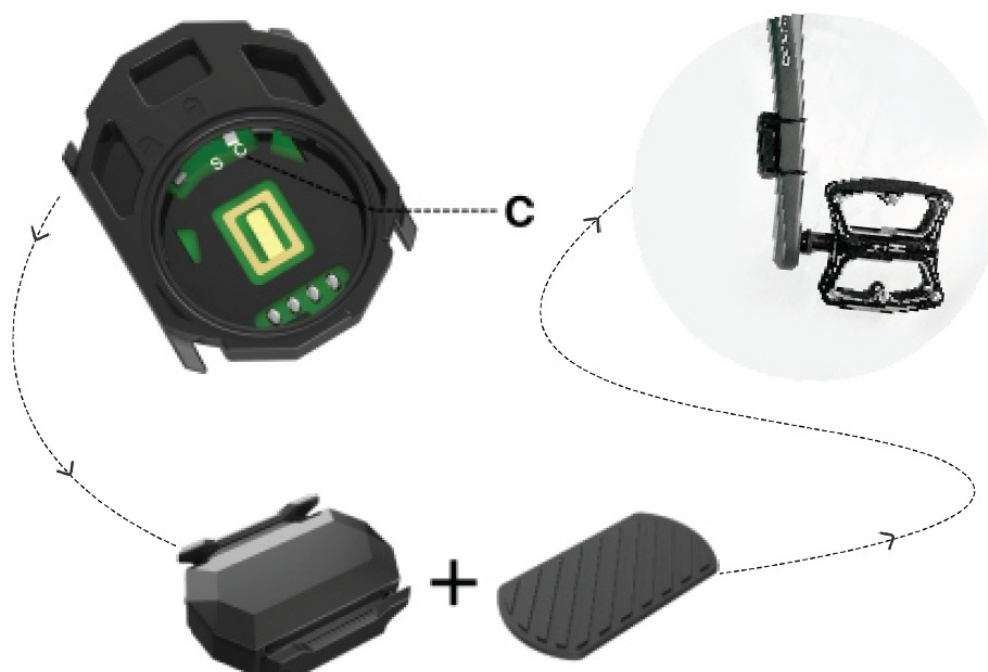



TANMET INT'L BUSINESS LTD
9 Pantygralgwen Road, Pontypridd, Mid Glamorgan, CF37 2RR,UK tanmetbiz@outlook.com

Documents / Resources

 <p><small>Speed Cadence Sensor User Guide</small></p>	<p>CYCPLUS CDZN888-C3 Bike Speed and Cadence Sensor [pdf] User Guide CDZN888-C3, CDZN888C3, 2A4HXC DZN888-C3, 2A4HXC DZN888C3, CDZN888-C3 Bike Spe ed and Cadence Sensor, CDZN888-C3, Bike Speed and Cadence Sensor</p>
---	---