



CYCPLUS CD-BZ-090059-03 Speed-Cadence Sensor User Guide

[Home](#) » [CYCPLUS](#) » CYCPLUS CD-BZ-090059-03 Speed-Cadence Sensor User Guide 

Contents

- [1 CYCPLUS CD-BZ-090059-03 Speed-Cadence Sensor](#)
- [2 Speed/Cadence Sensor C3 User Guide](#)
- [3 Quick Start](#)
- [4 Fixing to Bicycle](#)
- [5 Instructions for Use](#)
- [6 Quick Start](#)
- [7 Fix to Bicycle](#)
- [8 Specifications](#)
- [9 Summary](#)
- [10 Indicator Light](#)
- [11 Documents / Resources](#)
- [12 Related Posts](#)



CYCPLUS CD-BZ-090059-03 Speed-Cadence Sensor



Speed/Cadence Sensor C3 User Guide

The Speed/Cadence Sensor C3 is a device that measures either the speed or cadence of a bicycle. It can connect to any device or app that supports Bluetooth or Ant+ protocol standards. The product comes with a one-year free replacement or repair warranty from the manufacturer, Chengdu Chendian Intelligent Technology Co., Ltd.

Quick Start

1. Push the battery cover's protrusion to the center position and then open the battery cover.
2. Remove the battery isolation sheet and then reinstall the battery cover.
3. Install the battery cover onto the body. When installing the battery cover, make sure to align the protrusion to the center position.
4. Press the battery cover tightly, and then push the battery cover's protrusion to the left or right to set the sensor to speed or cadence mode.
5. After installation, the indicator light will flash for 10 seconds. Blue indicates speed mode, Green indicates cadence mode, and Red indicates low battery.

Fixing to Bicycle

Speed

1. Fix the curved rubber pad onto the bottom of the sensor.
2. Fix the sensor onto the hub using a rubber band.
3. Turn the wheel to activate the sensor and establish a connection with your device or app.

Cadence

1. Fix the flat rubber pad onto the bottom of the sensor.
2. Fix the sensor onto the crank using a rubber band.
3. Turn the crank to activate the sensor and establish a connection with your device or app.

Instructions for Use

1. Before using, please open the battery cover, and remove the transparent insulation spacer.
2. One sensor cannot measure both speed and cadence simultaneously. If you need to measure both, please purchase two sensors.
3. For speed measurement, the hub width must be more than 38mm.
4. The product defaults to cadence measurement. The Bluetooth name is CYCPLUS S3 when used for speed measurement.
5. When using Bluetooth protocol, it can only be connected to one device or app at a time. To change the device or app, please disconnect the previous one first.
6. When using the ANT+ protocol, it can be connected to multiple devices simultaneously.
7. When using a smartphone app, search for the sensor in the app. Searching via phone Bluetooth is invalid.

Specifications

The sensor can connect to any APPs or devices that support Bluetooth or Ant+ protocol standards.

Summary

To switch between speed and cadence mode, simply turn the battery cover while holding it to prevent it from popping up. The indicator light will flash blue for speed mode, green for cadence mode, and red when the battery power is less than 20%.

For any after-sale support or queries, please contact the manufacturer via email at steven@cycplus.com. The product is made in China.

Quick Start

1. Push the battery cover's protrusion to the center position and then open the battery cover.
2. Remove the battery isolation sheet and then reinstall the battery cover.
3. Install the battery cover onto the body. When installing the battery cover, make sure to align the protrusion to the center position.

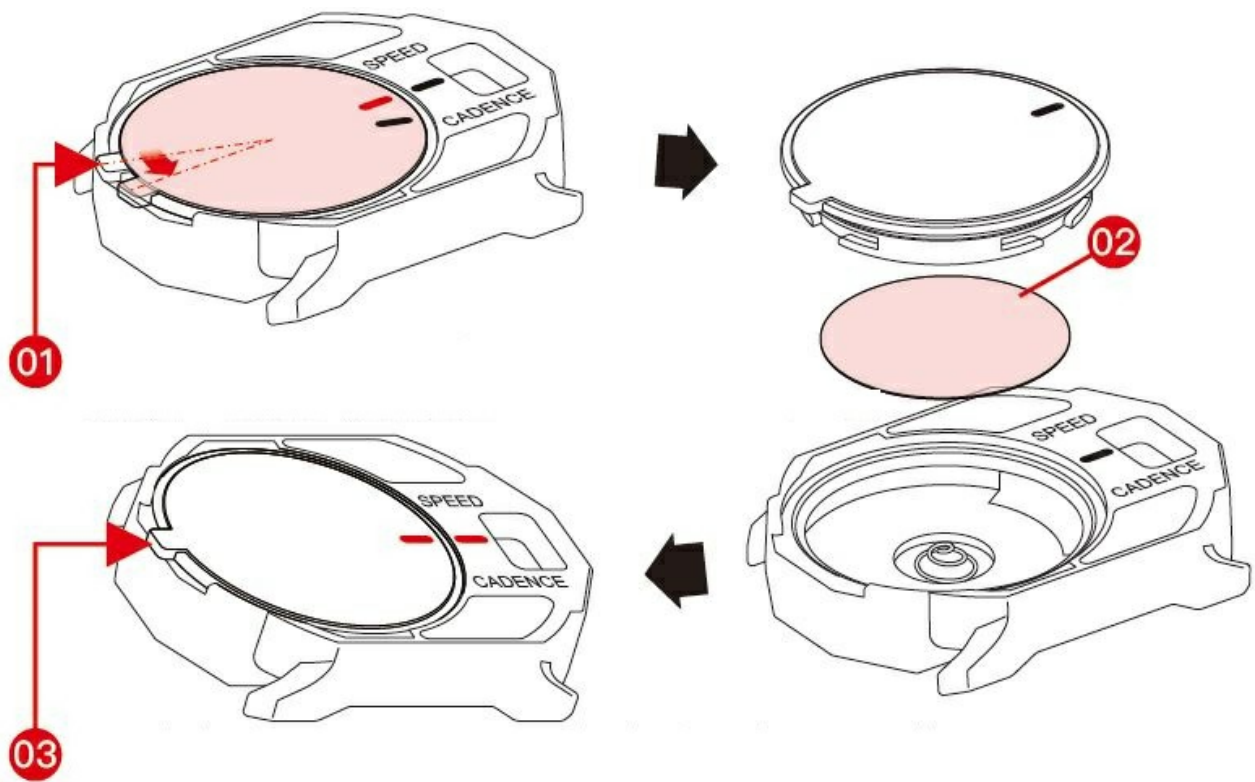

4. Press the battery cover tightly, and then push the battery cover's protrusion to the left or right to set the sensor to speed or cadence mode.
5. After installation, the indicator light will Flash for 10 seconds.
 - Blue : Speed
 - Green: Cadence
 - Red: Low battery

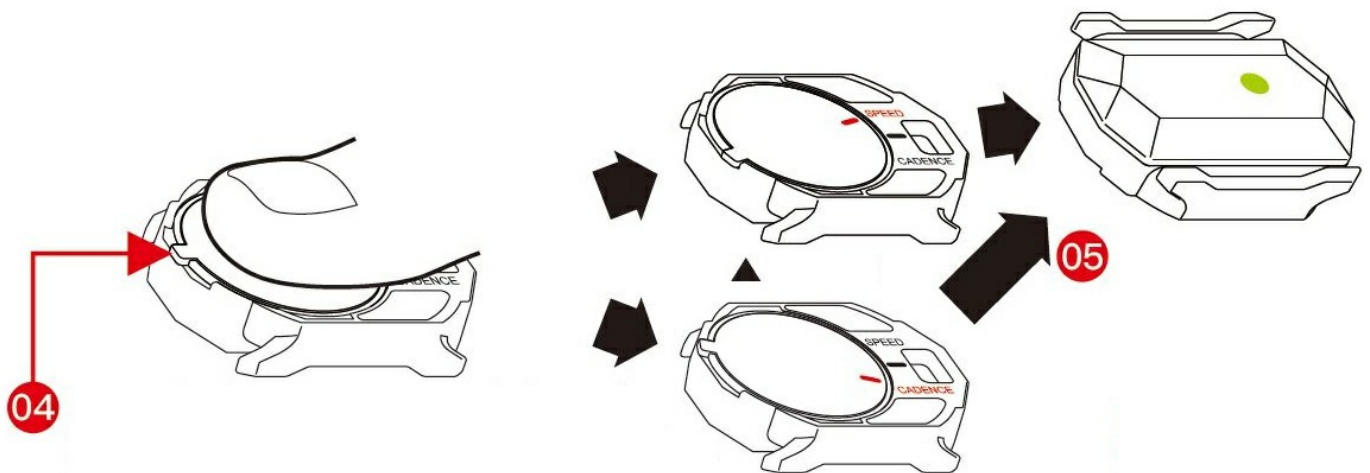

Fix to Bicycle

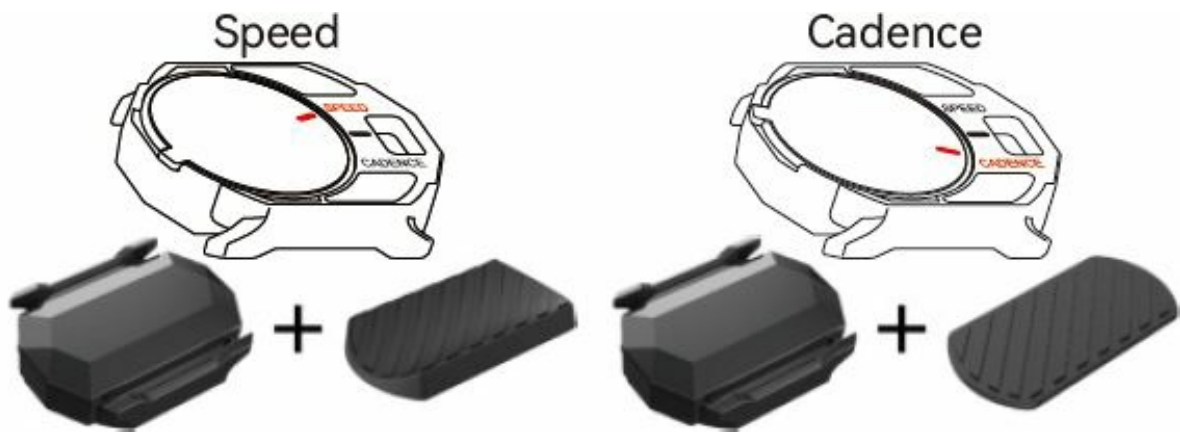

- Fix the curved rubber pad onto the bottom of the sensor
- Fix the flat rubber pad onto the bottom of the sensor



Fix the sensor onto the hub using a rubber band. Turn the wheel to activate the sensor and establish a connection with your device or app. Fix the sensor onto the crank using a rubber band. Turn the crank to activate the sensor and establish a connection with your device or app.

Instructions for Use

1. Before using, please open the battery cover, and remove the transparent insulation spacer.
2. One sensor cannot measure both speed and cadence simultaneously.
If you need to measure both, please purchase two sensors.
3. For speed measurement, the hub width must be more than 38mm.
4. The product defaults to cadence measurement.
5. The Bluetooth name is CYCPLUS S3 when used for speed measurement. When using Bluetooth protocol, it can only be connected to one device or app at a time. To change the device or app, please disconnect the previous one first.
6. When using the ANT+ protocol, it can be connected to multiple devices simultaneously.
7. When using a smart phone app, search for the sensor in the app. Searching via phone Bluetooth is invalid.

Specifications

- **Dimension:** 9.5mm×29.5mm×38.0mm
- **Weight:** 9.2g

- **Battery:** 220mAh CR2032
- **Usage time:** 600 hours Cadence / 400 hours Speed
- **Standby time:** 300 days
- **Protection rating:** IP67
- **Compatible with:** Garmin, Wahoo, Zwift, Tacx, BLjton, XOSS, Blackbird, and other devices
- **Protocol standards:** The sensor can connect to any APPs or devices that support Bluetooth or Ant+.

Summary

Switch the work modes

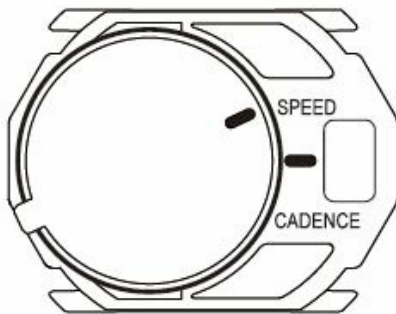

Speed mode

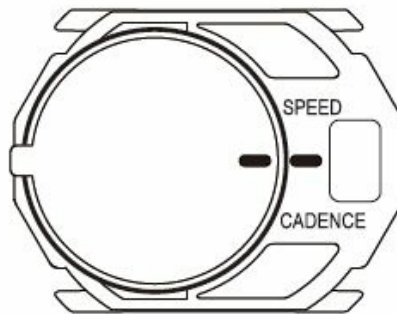

Open the
battery cover

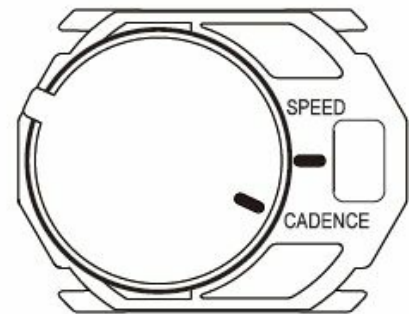

Cadence mode

When switching modes by turning the battery cover, please hold the cover with your hand to prevent it from popping up when passing through the gap in the middle.

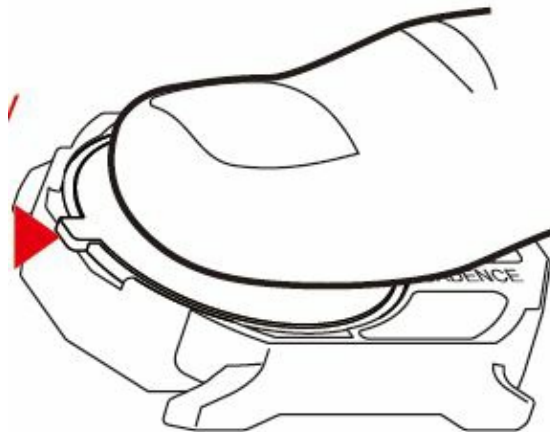

Indicator Light

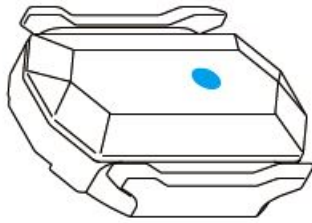

Blue light flash

Speed
measurement

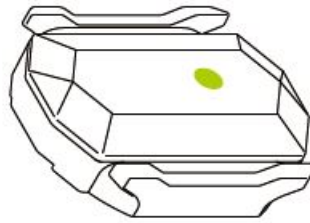

Green light flash

Cadence
measurement

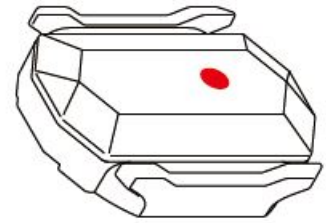

Red light flash

Battery power is
less than 20%

Factory Info

Manufacturer:

Chengdu Chendian Intelligent Technology Co., Ltd

Warranty: One-year free replacement or repair

After sale E-mail: steven@cycplus.com

Documents / Resources

	CYCPLUS CD-BZ-090059-03 Speed-Cadence Sensor [pdf] User Guide CD-BZ-090059-03 Speed-Cadence Sensor, CD-BZ-090059-03, Speed-Cadence Sensor, Cadence Sensor, Sensor
--	--

[Manuals+](#)