

cybex
GOLD
LIBELLE Ultra Lightweight
Compact Stroller



cybex LIBELLE Ultra Lightweight Compact Stroller Instruction Manual

[Home](#) » [CYBEX](#) » cybex LIBELLE Ultra Lightweight Compact Stroller Instruction Manual 

Contents

- [1 cybex LIBELLE Ultra Lightweight Compact Stroller](#)
- [2 Specifications](#)
- [3 Installation](#)
- [4 FAQs](#)
- [5 Documents / Resources](#)
 - [5.1 References](#)



cybex LIBELLE Ultra Lightweight Compact Stroller



Specifications

- Weight: 3kg
- Maximum Weight Capacity: 10kg
- Color Options: Black, Gray, White

Product Registration

To unlock benefits, register your product by visiting the website and following the instructions.

Installation

Follow the provided guidelines for setting up the product in your desired location.

Braking System

To engage the brake, follow these steps: [provide detailed instructions on how to use the brake system]

Folding Mechanism

To fold the product, carefully follow the steps outlined in the user manual to ensure safe folding and unfolding.

Harness System

The harness system ensures safety. Learn how to adjust and secure it properly for your child's comfort and safety.

Bumper Bar

The bumper bar provides additional safety. Learn how to attach and detach it as needed.

Footrest

Adjust the footrest to provide comfort for your child. Follow the instructions for proper adjustment.

Wheel Removal

If you need to remove the wheels for maintenance or storage purposes, follow the steps outlined in the manual.

WARNING



Tutorial video



Product registration



Maximum weights

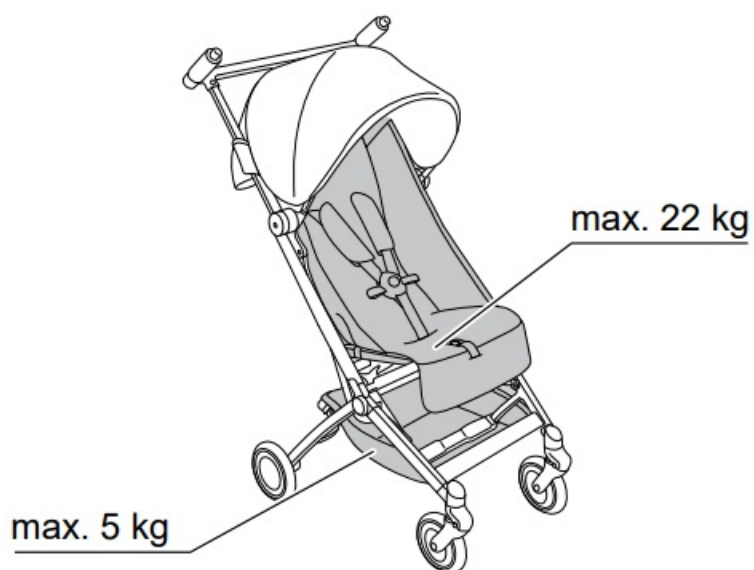

Folding

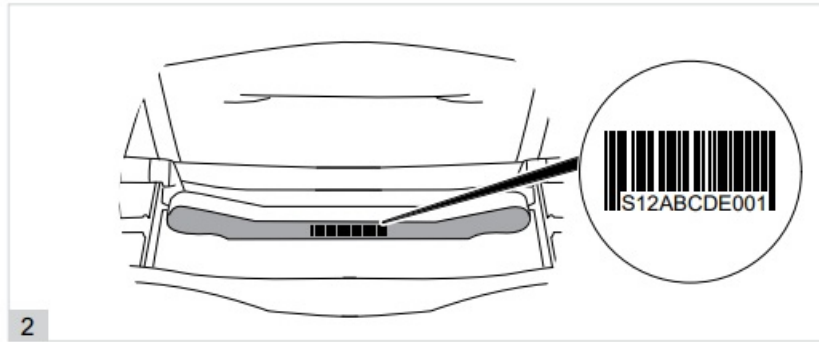
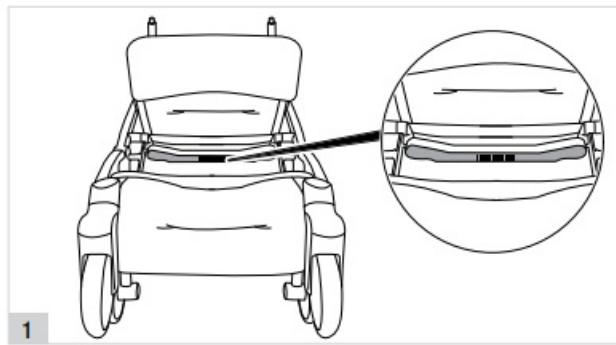

Harness

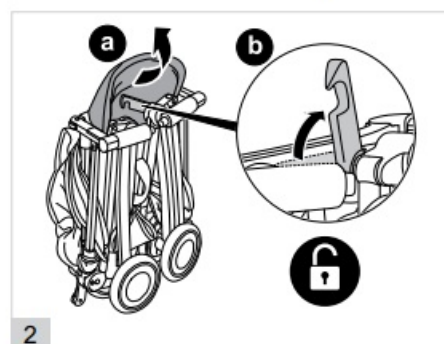
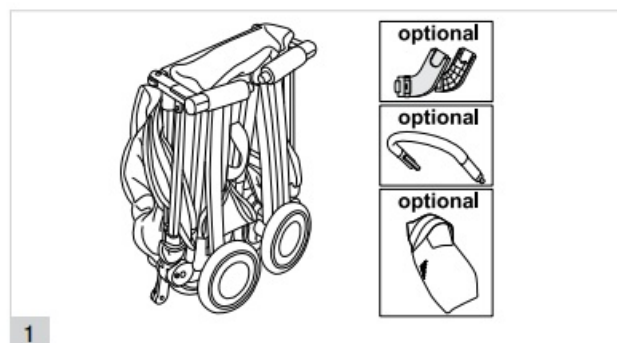

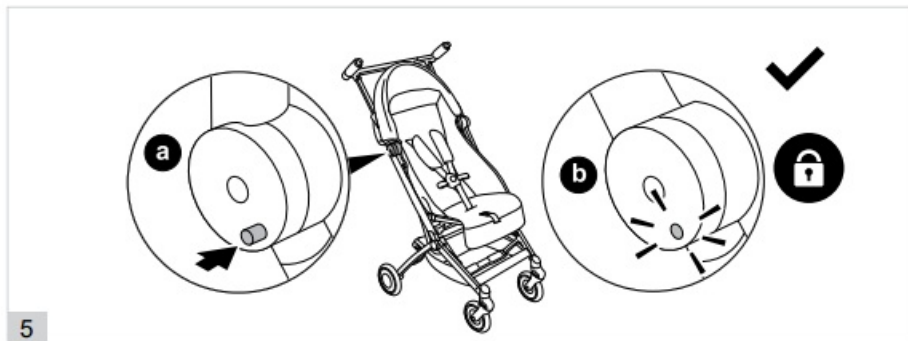

Bumper bar

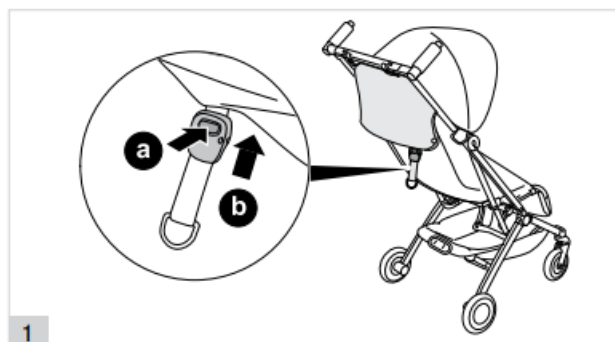
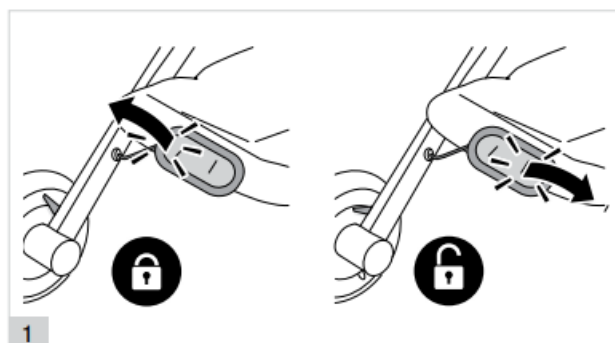

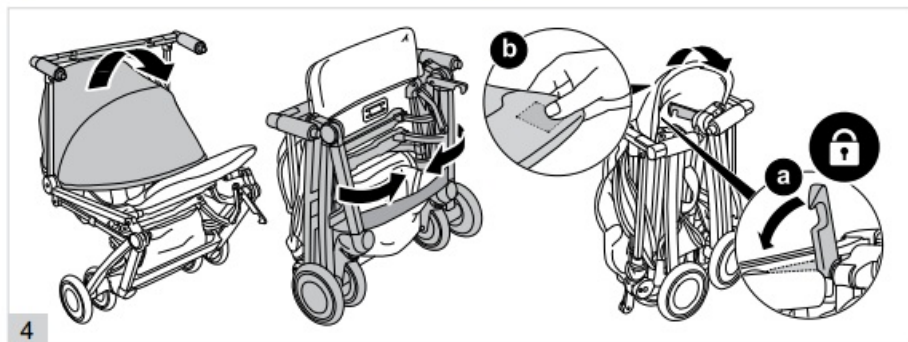
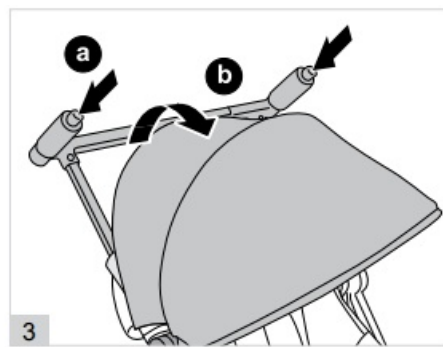

Backrest

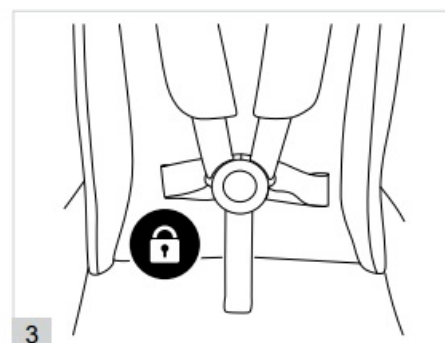
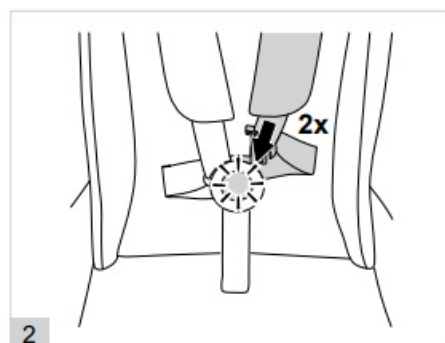
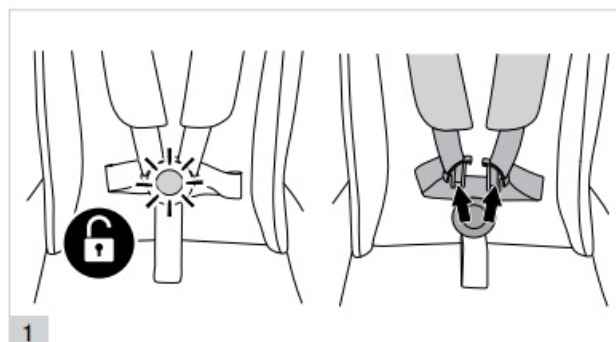

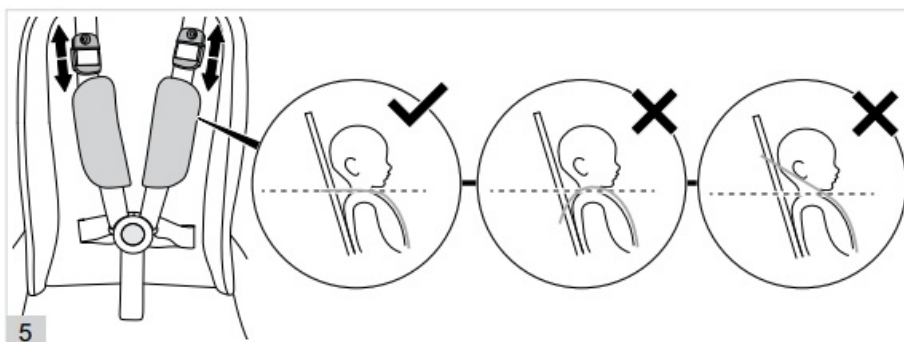
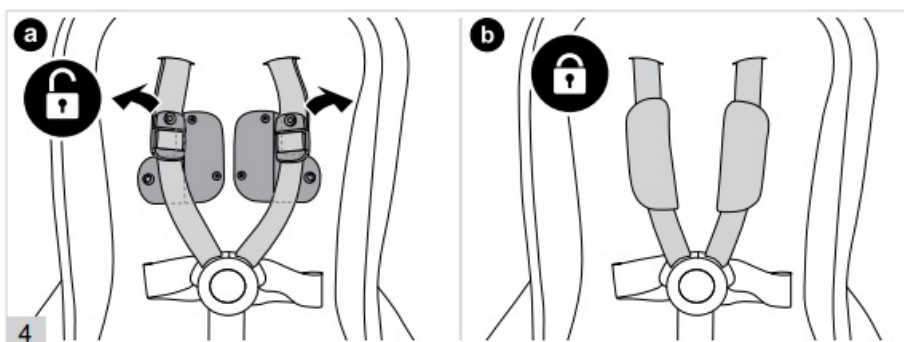
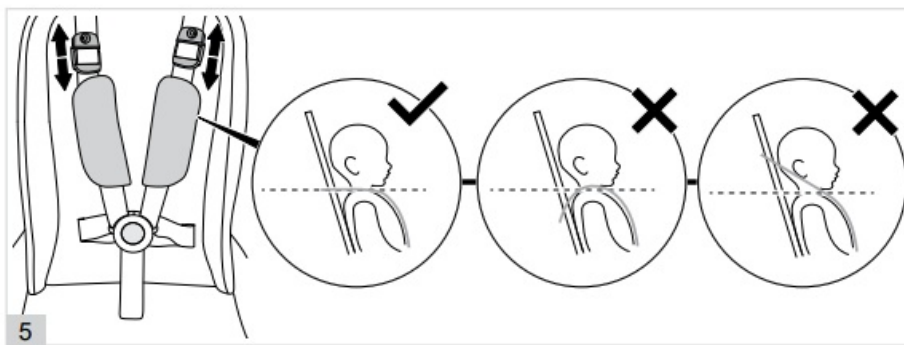
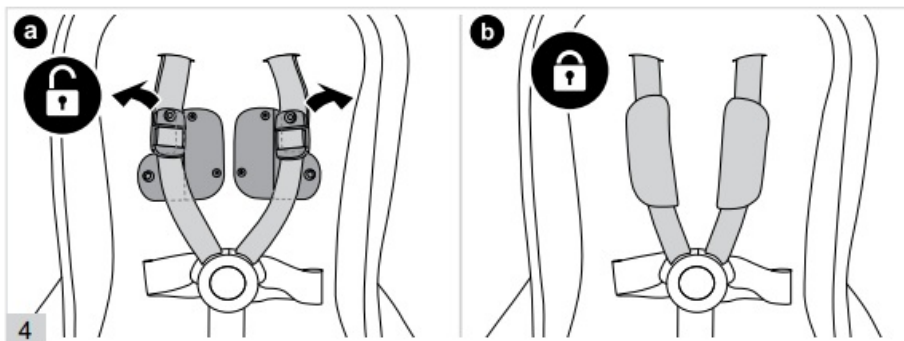

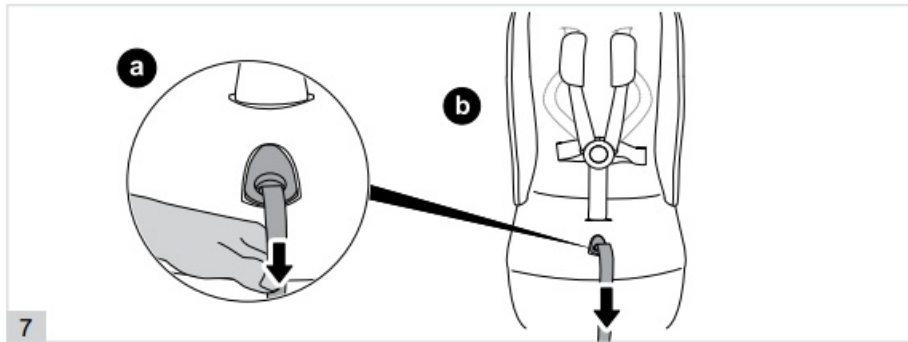
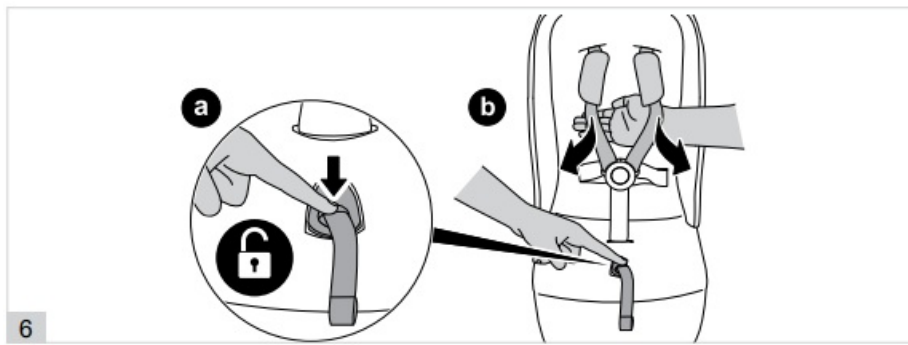

Legrest

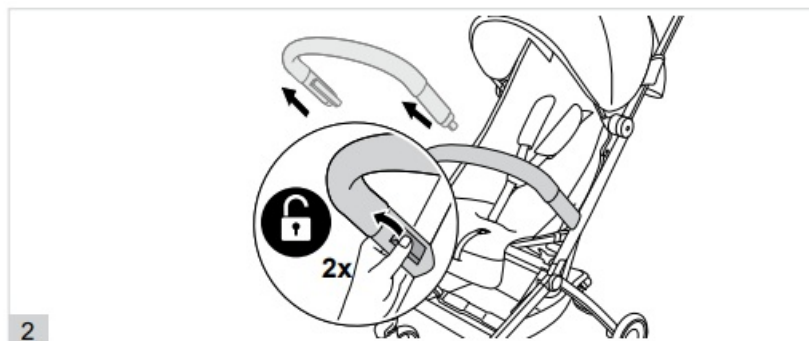

Removing the wheels

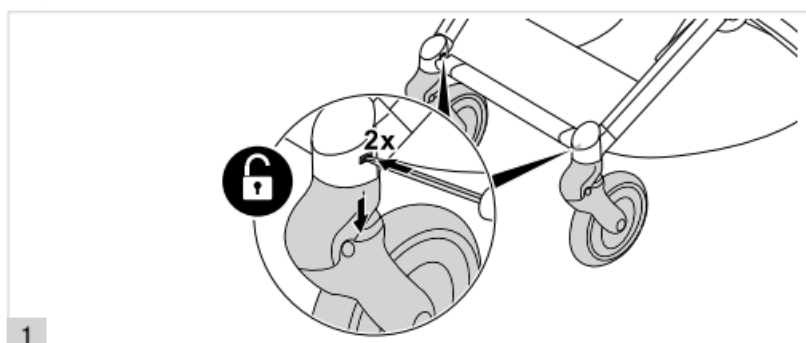
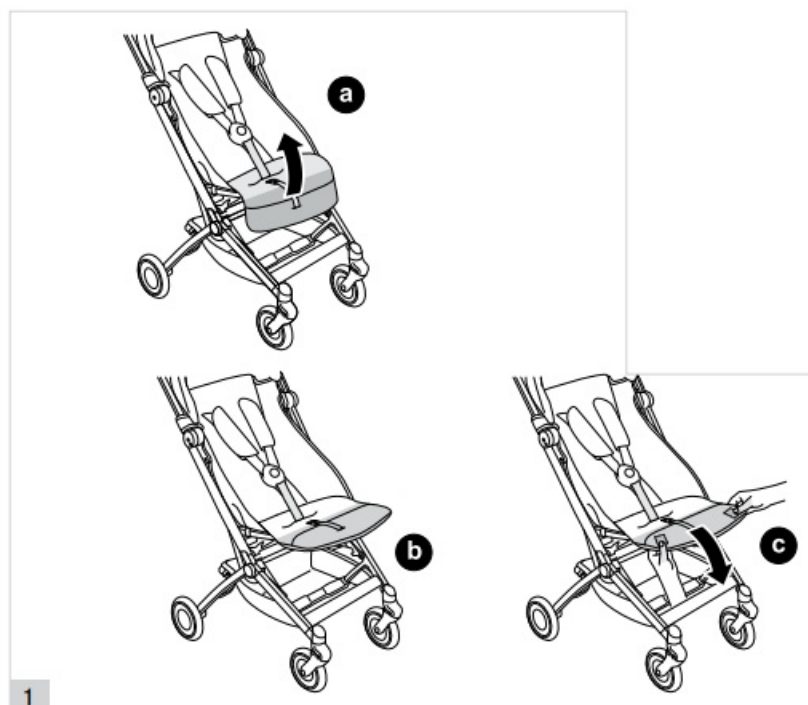
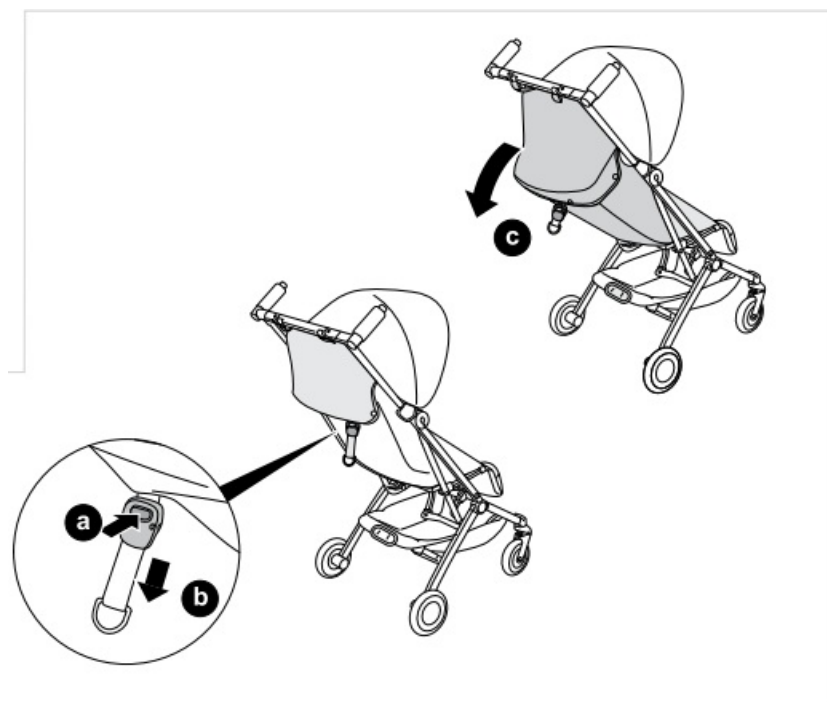

Removing the fabric

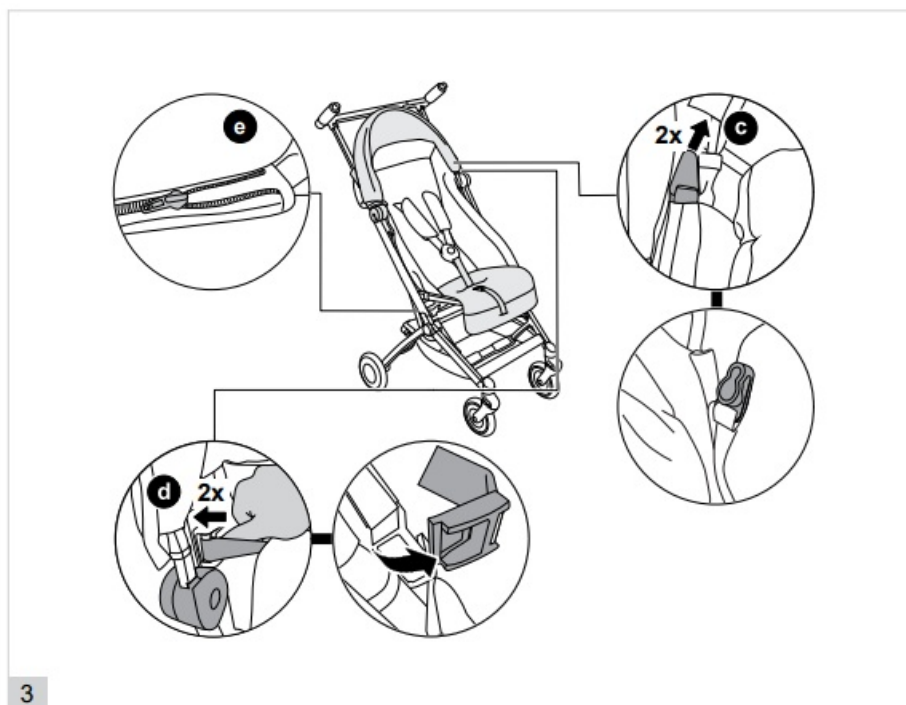
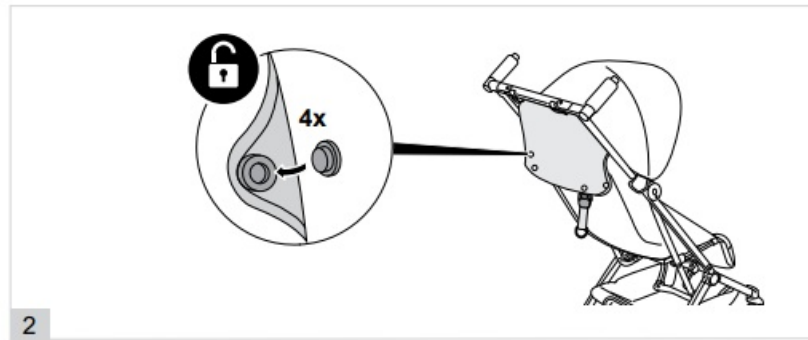

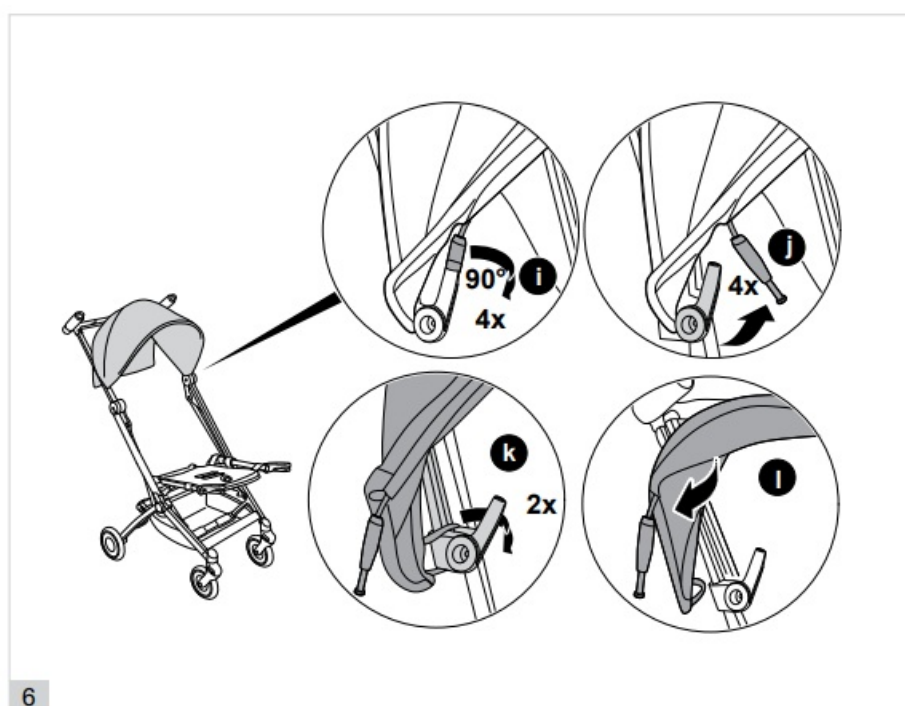
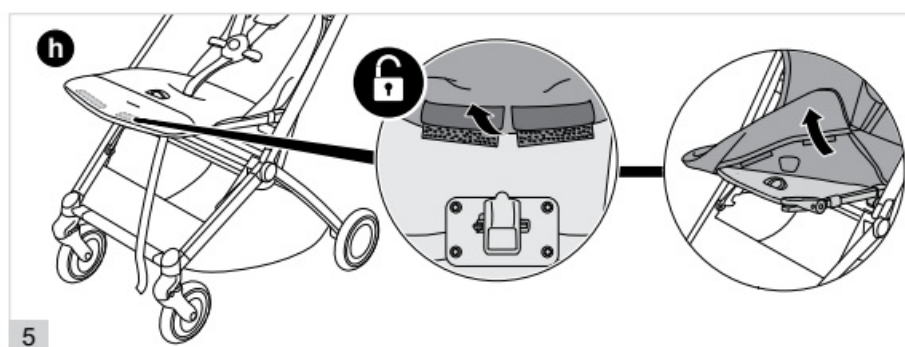
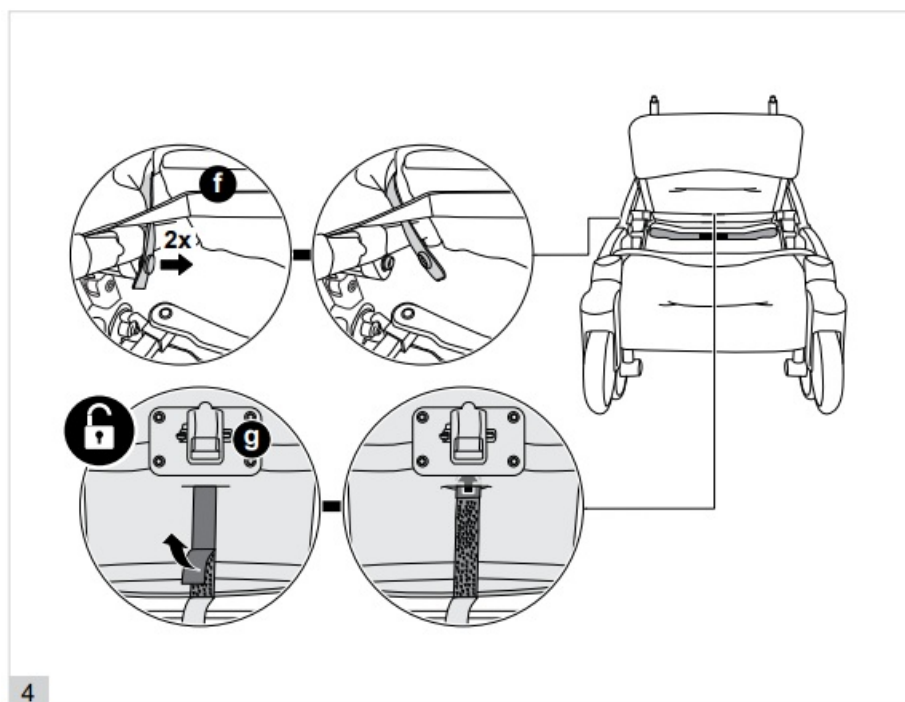

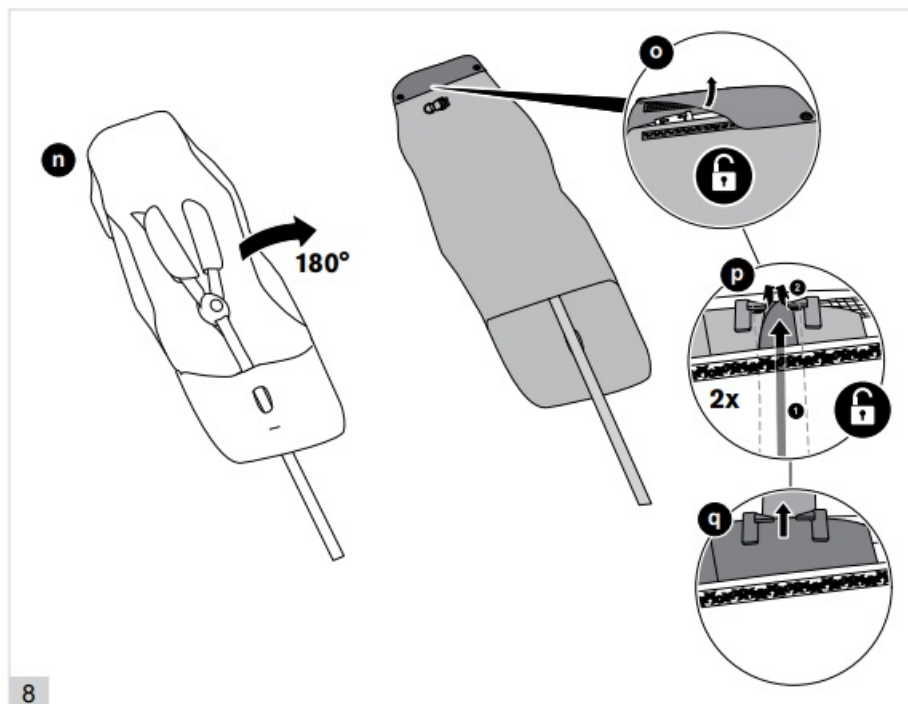
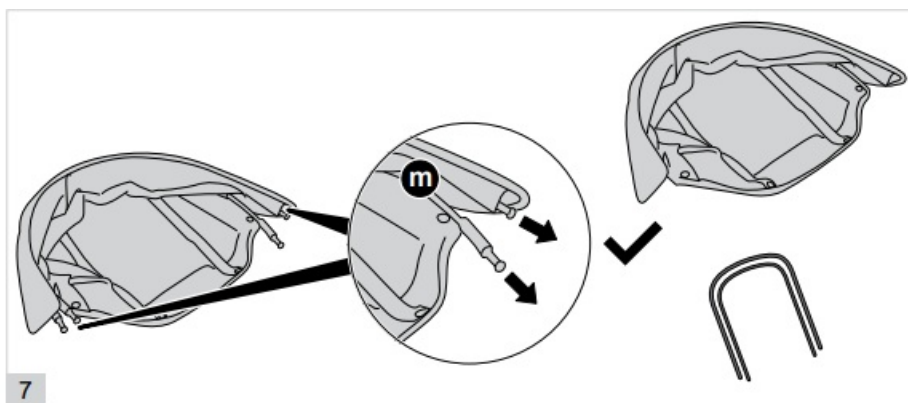

Rain cover

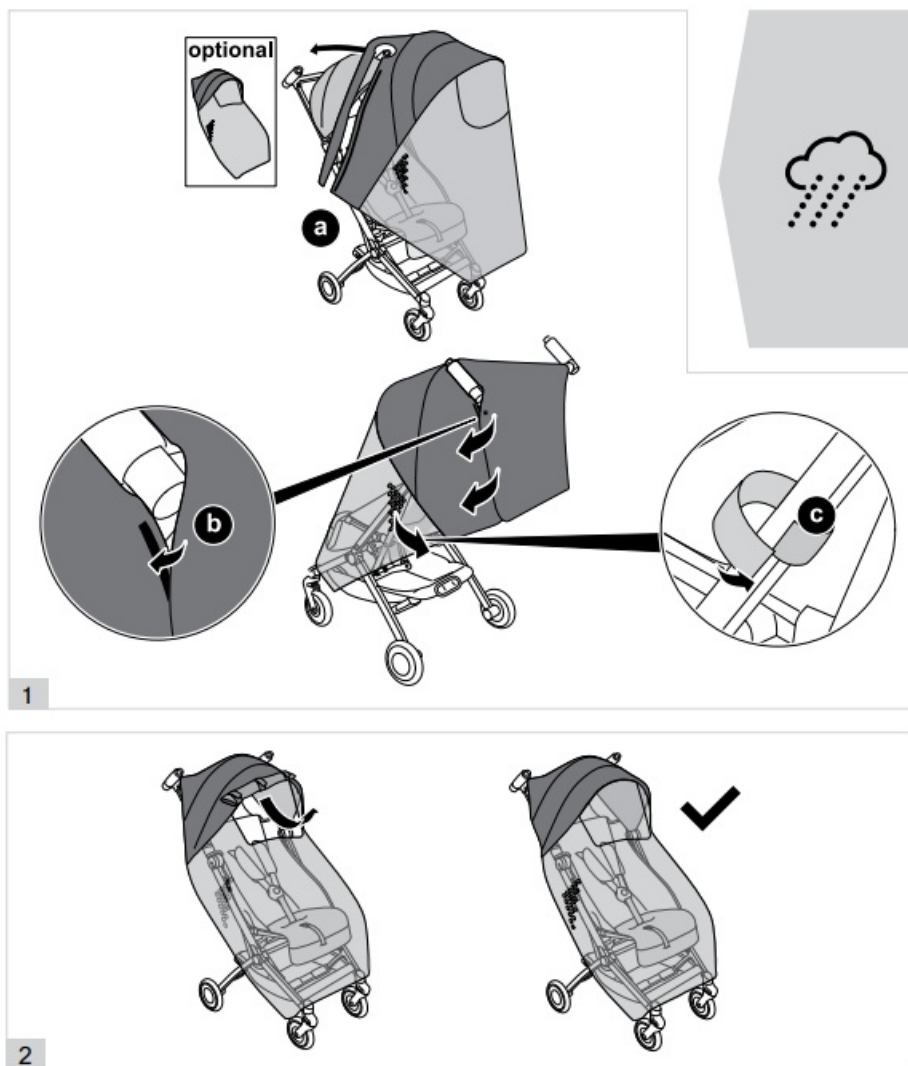

CYBEX GmbH

- Riedingerstr. 18
- 95448 Bayreuth
- Germany+49 (0) 921-78 511-0
- info@cybex-online.com
- www.cybex-online.com



Register here and unlock your benefits



FAQs

Q: How do I adjust the harness system?

A: To adjust the harness system, locate the straps and buckles, and follow the provided instructions to ensure a secure fit.

Q: Can I wash the fabric seat?

A: Yes, the fabric seat is machine washable. Follow the care instructions for best results.

Q: How do I lock the wheels?

A: To lock the wheels, locate the wheel locking mechanism and engage it by following the provided steps in the manual.

Documents / Resources

	cybex LIBELLE Ultra Lightweight Compact Stroller [pdf] Instruction Manual LIBELLE Ultra Lightweight Compact Stroller, LIBELLE, Ultra Lightweight Compact Stroller, Lightweight Compact Stroller, Compact Stroller
---	--

References

- [CYBEX Online Shop | Child Car Seats, Strollers, Baby Carriers and Furniture from CYBEX](#)
- [User Manual](#)

[Manuals+](#), [Privacy Policy](#)

This website is an independent publication and is neither affiliated with nor endorsed by any of the trademark owners. The "Bluetooth®" word mark and logos are registered trademarks owned by Bluetooth SIG, Inc. The "Wi-Fi®" word mark and logos are registered trademarks owned by the Wi-Fi Alliance. Any use of these marks on this website does not imply any affiliation with or endorsement.