



## CyberData 011527 InformaCast Enabled WiFi Alert Button Installation Guide

[Home](#) » [CyberData](#) » CyberData 011527 InformaCast Enabled WiFi Alert Button Installation Guide 

### Contents

- [1 CyberData 011527 InformaCast Enabled WiFi Alert Button](#)
- [2 Typical Installation](#)
  - [2.1 Parts](#)
- [3 Mounting](#)
  - [3.1 Mounting Options—Optional Plastic Low Voltage Bracket \(Not Included\)](#)
  - [3.2 Reset Test Function Management \(RTFM\) Button](#)
- [4 Documents / Resources](#)
  - [4.1 References](#)
- [5 Related Posts](#)

**CyberData**  
The IP Endpoint Company

CyberData 011527 InformaCast Enabled WiFi Alert Button



## Typical Installation

### InformaCast Enabled WiFi Alert Button Connectivity

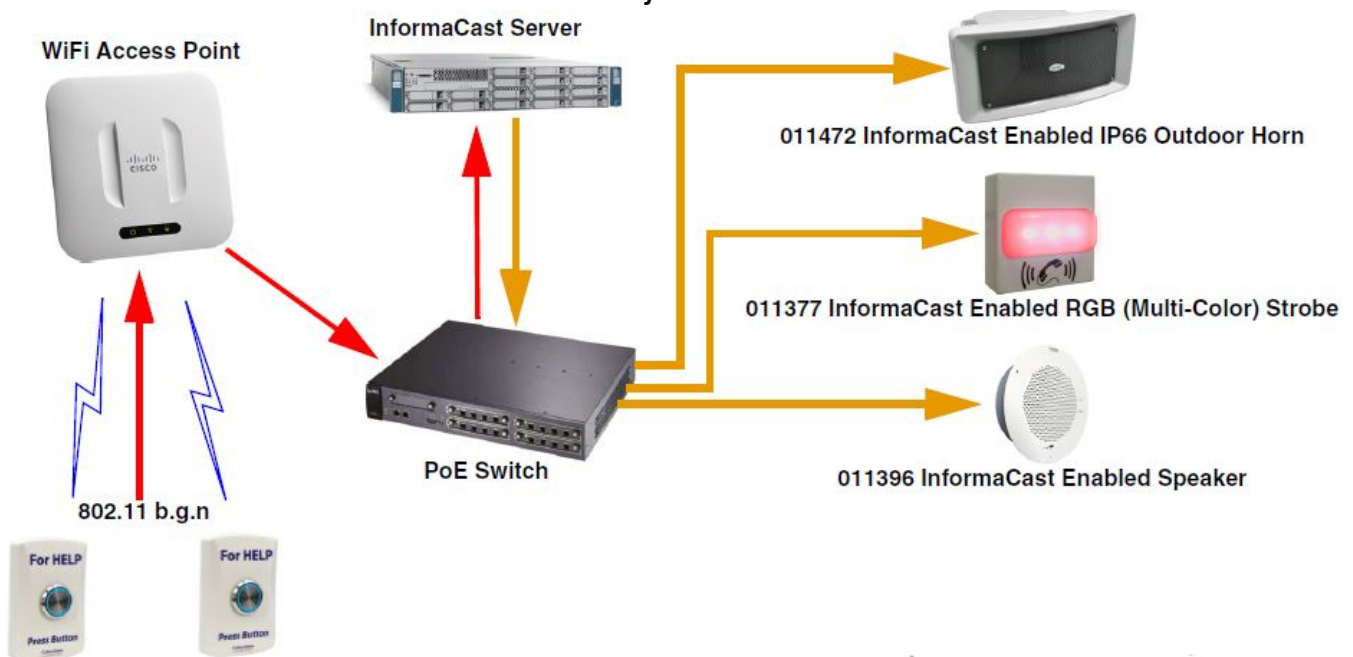







## Getting Started

- Download the InformaCast Enabled WiFi Alert Button Operations Guide PDF file from the Downloads tab at: <http://www.cyberdata.net/products/011527/>
- Create a plan for the locations of your speakers.
- **WARNING:** To prevent injury, this apparatus must be securely attached to the wall in accordance with the installation instructions.
- **WARNING:** The USB or J3 connectors are intended for intra-building connections only and do not route to the outside plant.

- **WARNING:** The device enclosure is not rated for any AC voltages!

## Parts

<p>(1) InformaCast Enabled WiFi Alert Button Assembly</p>  <p>(1x) M3 Flat Head Machine Screw</p> 	<p>(1) USB to AC Adapter</p>  <p>(1) Accessory Kit 3 ft USB Cable for WiFi Button</p> 	<p><b>Accessory Kit</b></p> <p>(4x) Plastic Ribbed Anchor</p>  <p>(4x) Wall Mounting #6x1.25" Pan Head Phillips Sheet Metal Screw</p> 
----------------------------------------------------------------------------------------------------------------------------------------------------------------------------------------------------------------------------------------------------------------------	--------------------------------------------------------------------------------------------------------------------------------------------------------------------------------------------------------------------------------------------------------------	--------------------------------------------------------------------------------------------------------------------------------------------------------------------------------------------------------------------------------------------------------------------------------------------------------------

## Mounting

### Mounting Options—Wall Mounting

To be installed and or used in accordance with the appropriate electrical codes and regulations.

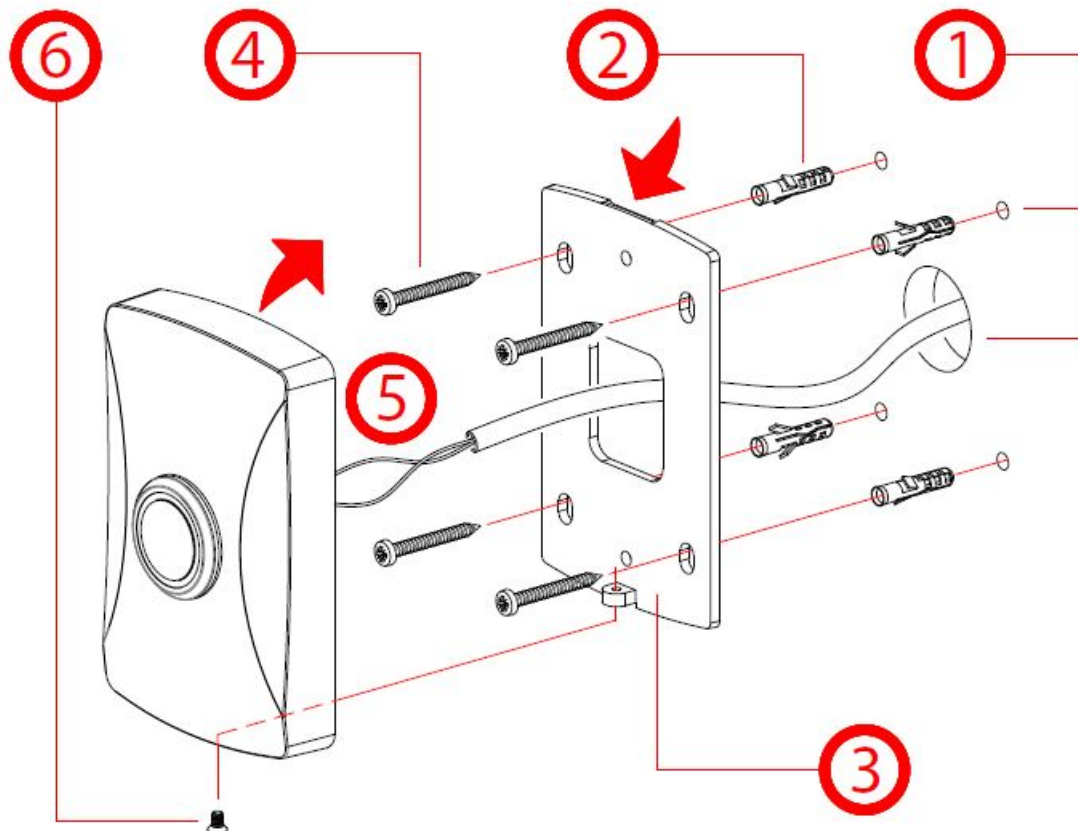

1. Prepare hole cutouts for both wires and the plastic-ribbed anchors. Use the provided Mounting Template or place the backplate directly onto the mounting surface. Mark the surface, and then drill the holes. (Drill **Size:** 3/16-inch / 4.8-mm)
2. Use a rubber mallet to hammer the plastic-ribbed anchors into the prepared holes.
3. Line up the backplate's Elongated Hole to the plastic-ribbed anchors.
4. Install the mounting screws through the backplate and plastic-ribbed anchors.
5. Connect the wires to the terminals on the InformaCast Enabled WiFi Alert Button. See the J1 Power Connection diagram on this Quick Reference Placemat.

- Put the InformaCast Enabled WiFi Alert Button and the backplate together by installing the flat head machine screw on the bottom.

#### Mounting Options—Optional Plastic Low Voltage Bracket (Not Included)

To be installed and or used in accordance with the appropriate electrical codes and regulations.

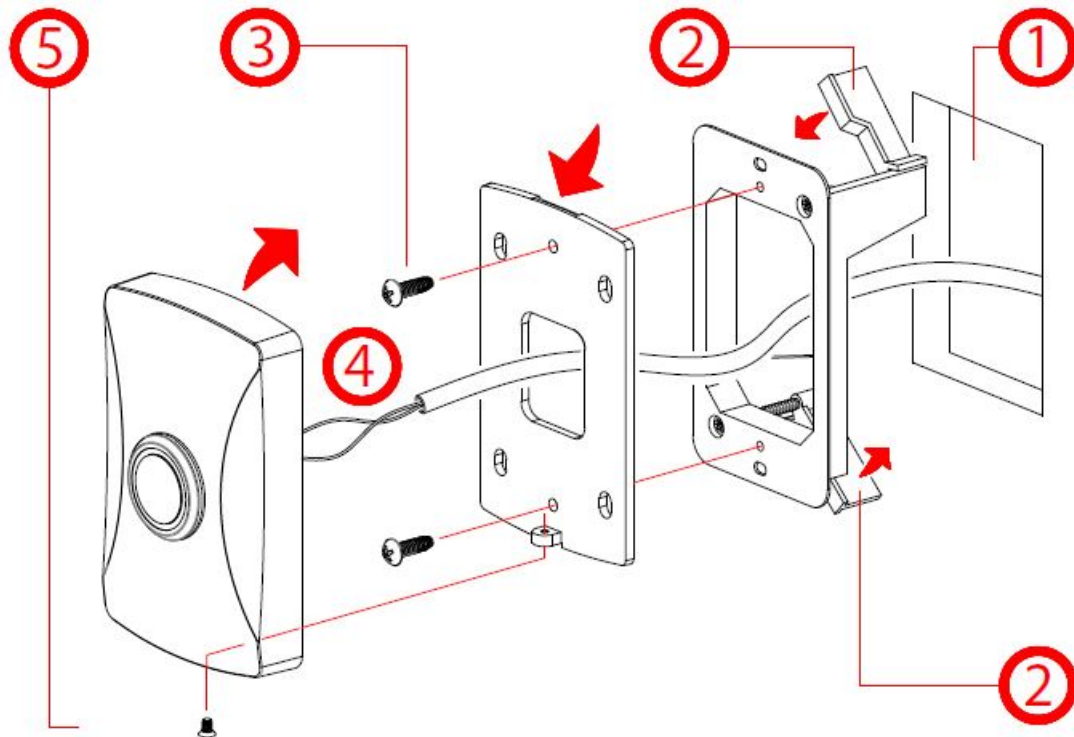

- Make a hole cutout for the Low Voltage Bracket\*.
- Fold down the flagnuts, and then insert the Low Voltage Bracket into the hole cutout.
- Install the mounting screws\* through the backplate and the Low Voltage Bracket.
- Connect the wires to the terminals on the InformaCast Enabled WiFi Alert Button. See the J1 Power Connection diagram on this Quick Reference Placemat.
- Put the InformaCast Enabled WiFi Alert Button and the backplate together by Installing the flat head machine screw on the bottom. \*The Low Voltage Bracket and mounting screws are not provided.

#### J1 Power Connection

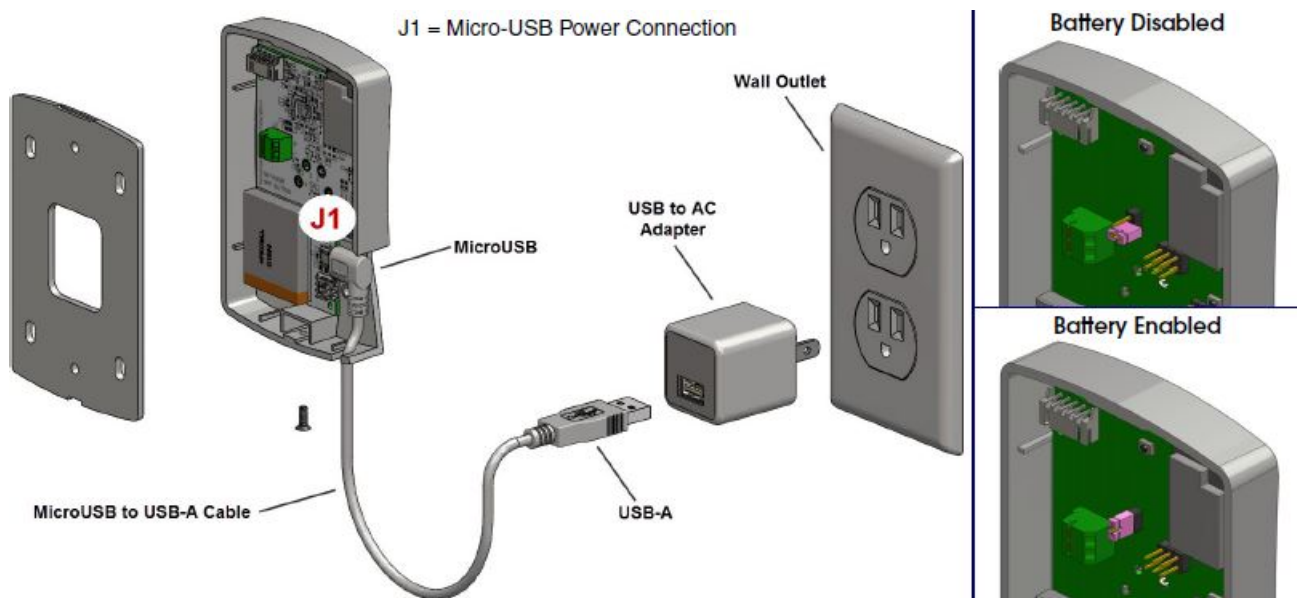

### Optional Auxiliary Power Supply (Part #561015 [Sold Separately])

AC Power Input  
Blue - Neutral  
Brown - Line  
0.4A @ 230VAC  
0.8A @ 115VAC

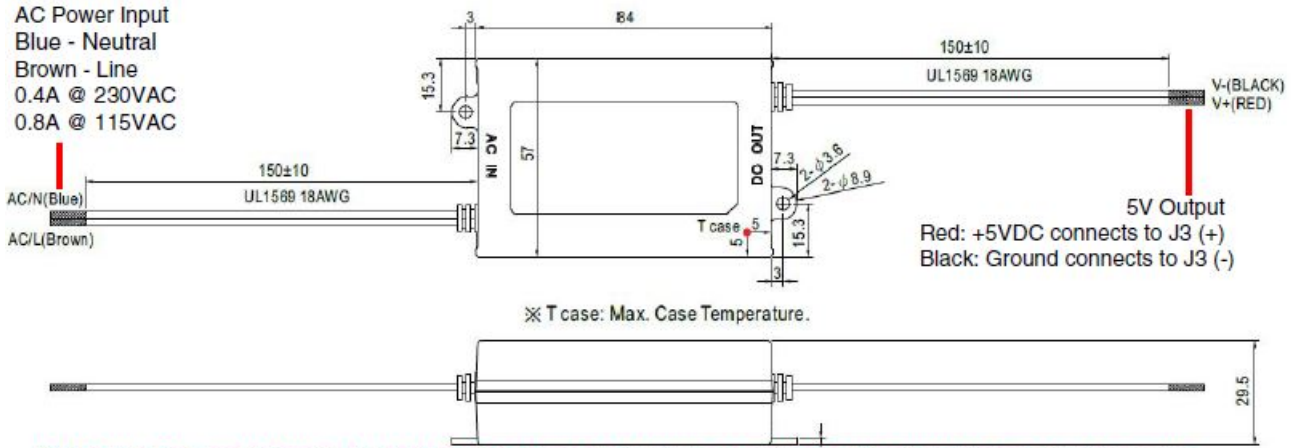

**WARNING:** This product should be installed by a licensed electrician according to all local electrical and building codes.

## J3 Power Connection

### J3 Power Connection

J3 = Auxiliary Power Input

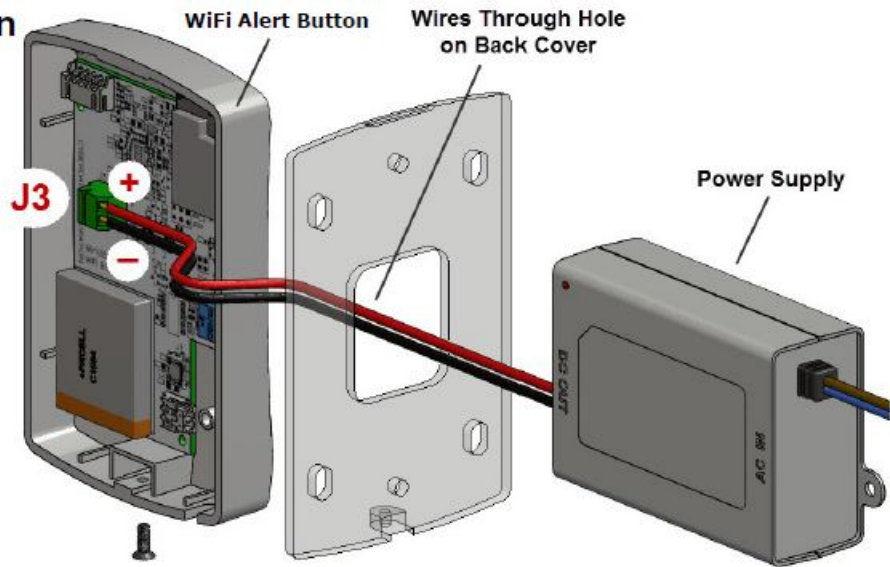

### Reset Test Function Management (RTFM) Button

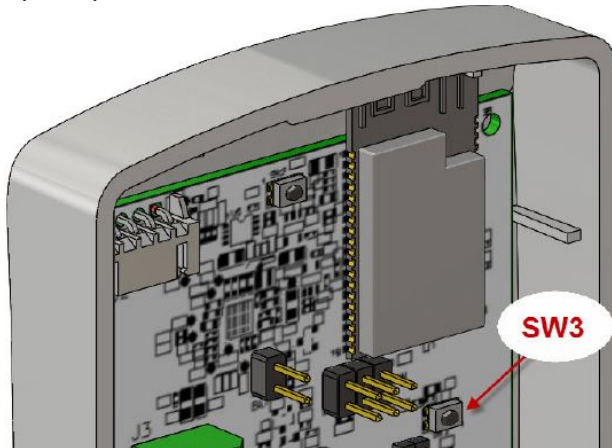

When the device is operational and linked to a network, you can use the Reset Test Function Management (RTFM) button (SW3 [see picture]) to restore the device to the factory default settings.

**To restore the device to factory default settings:**

- Press and hold the RTFM button for three seconds.

## Dimensions and Mounting Template



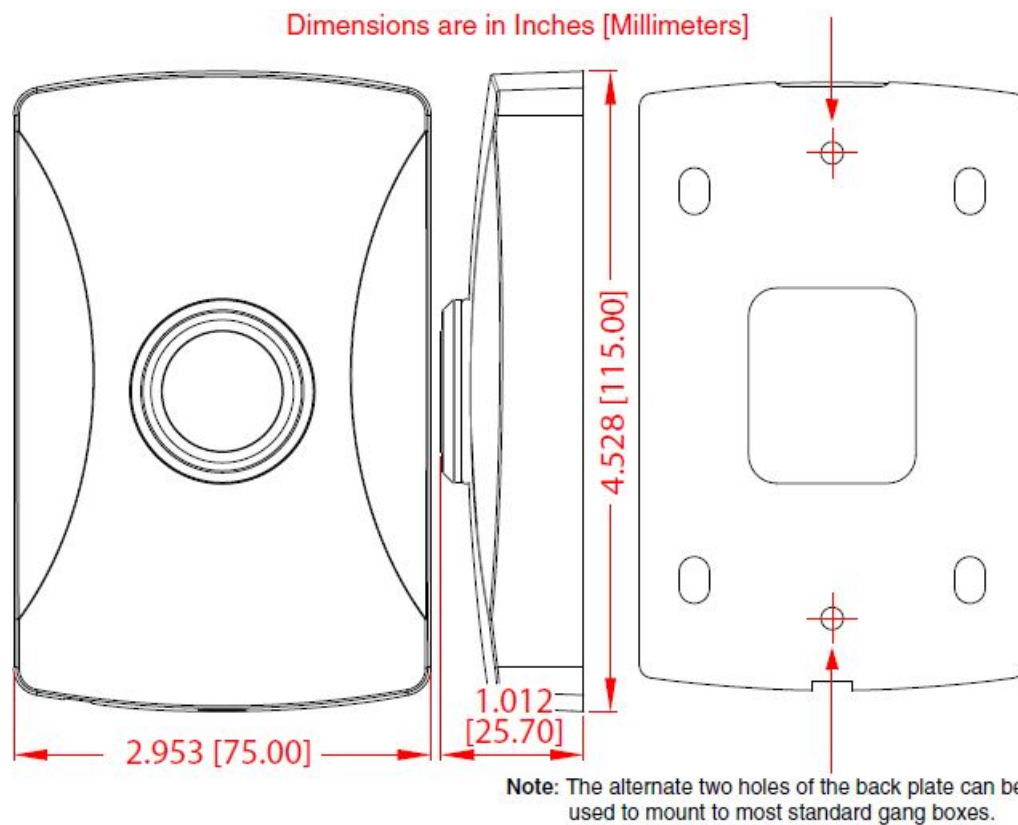

## Documents / Resources

	<p><a href="#">CyberData 011527 InformaCast Enabled WiFi Alert Button</a> [pdf] Installation Guide 011527, InformaCast Enabled WiFi Alert Button</p>
	<p><a href="#">CyberData 011527 InformaCast Enabled WiFi Alert Button</a> [pdf] User Guide 011527, InformaCast Enabled WiFi Alert Button</p>

## References

- [CD CyberData Corporation](#)