



CXY T13Plus 2000A Multi Function Portable Car Jump Starter User Manual

[Home](#) » [CXY](#) » CXY T13Plus 2000A Multi Function Portable Car Jump Starter User Manual 

Contents

- [1 CXY T13Plus 2000A Multi-Function Portable Car Jump Starter](#)
- [2 PRODUCT INFORMATION](#)
- [3 What's in the Box](#)
- [4 SPECIFICATIONS](#)
- [5 HOW TO RECHARGE THE JUMP STARTER](#)
- [6 HOW TO JUMP-START A CAR](#)
- [7 Documents / Resources](#)
 - [7.1 References](#)
- [8 Related Posts](#)

CXY

CXY T13Plus 2000A Multi-Function Portable Car Jump Starter



PRODUCT INFORMATION

Model: T13PLUS

THANK YOU FOR PURCHASING 2000A MULTI-FUNCTION PORTABLE CAR JUMP STARTER

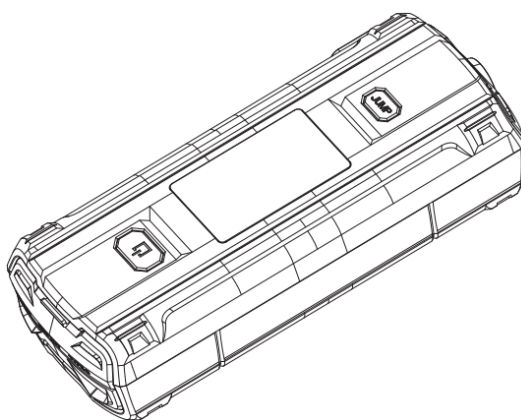

Friendly Tips

Please carefully read the instruction manual and use the product correctly based on the instruction manual so that you can be familiar with the product more conveniently and quickly!

Please keep the user manual for future reference.

What's in the Box

- CXY T13PLUS Jump Starter x 1
- Battery clamps with starter cable x1
- High-quality USB-A to USB-C cable x1
- High-quality USB-C to USB-C cable x1
- Cigarette lighter converter x1

- Jump starter carry case x1
- User manual x1

AT A GLANCE

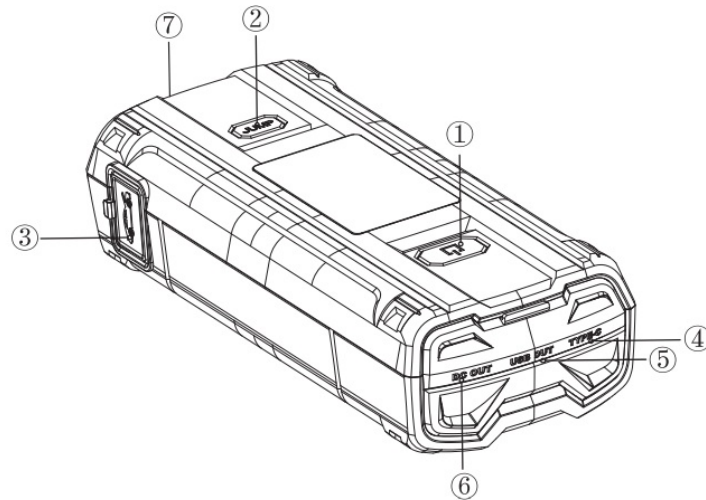

1. Power Button
2. Jump Button
3. Jumping port
4. **USB C output/input:** PD 60W
5. **USB output:** QC 18W
6. **DC output:** 12V/6A
7. LED Light

SPECIFICATIONS

- **Capacity:** 20000mah / 74wh
- **Weight:** 1600g | 56.43oz
- **Size:** 226*90*54mm 8.9*3.5*2.1 in
- **USB-C Input:** 5V /3A 9V /3A 12V /3A 15V/3A 20V/3A (PD 60W)
- **USB-C Output:** 5V /3A 9V /3A 12V /3A 15V/3A 20V/3A (PD 60W)
- **USB Output:** 5V/3A 9V/2A 12V/1.5A (QC18W)
- **DC Output:** 12V/6A
- **Starting Current:** 800A
- **Peak Current:** 2000A

HOW TO RECHARGE THE JUMP STARTER

12 ways to recharge the jump starter:

1. Use a USB-C charger adapter and the USB-C cable we provided to recharge the jump starter via the USB-C port. Support PD 60W fast charging (60W PD charger adapter required)

2. Use 5521 connector chargers (5521 DC car charger, 5521 laptop charger, 5521 AC to DC adapter charger) to recharge the jump starter via the 5521 DC port.

PLEASE NOTE:

- This product is designed for vehicles with 12V battery only. Do not attempt to jump-start vehicles with a higher battery rating, or different voltage.
- If the vehicle isn't started immediately, please wait for 1 minute to allow the jump starter to cool down before the next attempt. Do not try to restart the vehicle after three consecutive attempts as this may damage the unit. Check your vehicle for other possible reasons why it can't be restarted.
- If your vehicle battery is dead or its battery voltage is under 2V, it's unable to activate the jump cable and your vehicle will not be started.

HOW TO JUMP-START A CAR

1. Switch on your jump starter and make sure it's over 25% charged.
2. Insert the jumper cable into the jumping port.

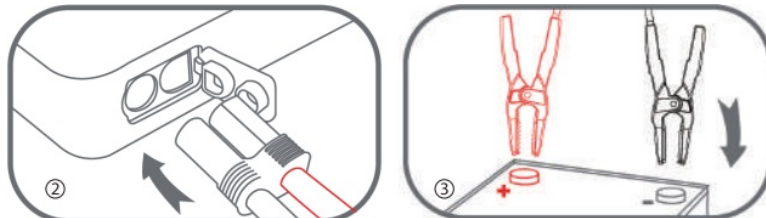

3. Connect the red clamp to the positive(+) terminal and the black clamp to the negative(-) terminal of the car battery.
4. Press the Jump button for 3 seconds.
 - The display screen shows Orange "READY" which means the jump starter and clamps are in standby mode.
 - The display screen shows Green "READY" which means it's all ready to start your car.
 - The display screen shows "RC" which means the clamps and car battery's negative and positive poles are connected reversely. Please connect them correctly and try again.
 - The display screen shows "LV" which means low voltage, please recharge the jump starter then try again.
 - The display screen shows "u HT" which means clamps overheat, please wait for several minutes to cool down then try again.
 - Display screen flicker "188" means the jump starter overheats, please wait for several minutes to cool down then try again.
5. Start your engine.
6. Remove clamps and jump starters.

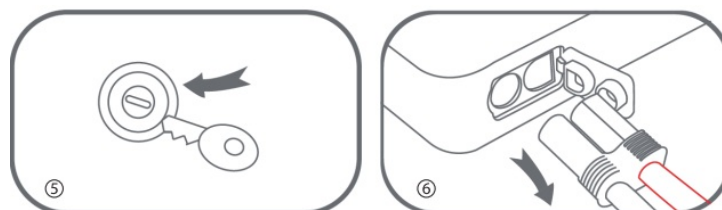

CHARGE VARIOUS DIGITAL DEVICES WITH T13PLUS

This product has 3 output ports for multiple charging demands. Such as cellphones, tablets, iPads, laptops, PSPs,

gamepads, car vacuum cleaners (with the provided cigarette lighter converter), and more.

1. **USB-C PORT:** PD 60W MAX
2. **USB-A PORT:** QC 18W MAX
3. **DC PORT:** 12V / 6A

LED FLASHLIGHT

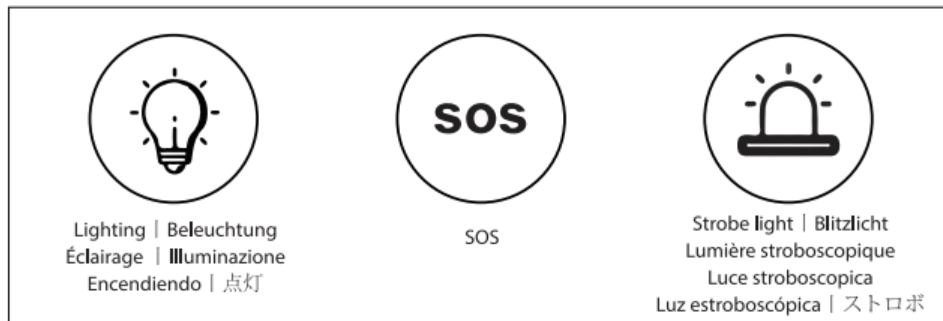



Long press the power button for 3 seconds to turn on /turn off the flashlight. Quick press the power button to switch 3 flashlight modes.

ATTENTION

- To preserve battery lifespan, use and recharge it at least once every 6 months.
- Must use our standard jump cable to jump-start your car.
- DO NOT recharge the jump starter immediately after starting your car.
- Avoid dropping
- DO NOT heat the product or use it near fire.
- DO NOT put it into water or disassemble the product.

CUSTOMER SERVICE

-  24-months warranty
-  Lifetime technical support

eVamaster Consulting GmbH Bettinastr. 30,60325 Frankfurt am Main, Germany contact@evatmaster.com
EVATOST CONSULTING LTD Suite 11, First Floor, Moy Road Business Centre, Taffs Well, Cardiff, Wales, CF15
7QR contact@evatmaster.com

E-mail: cxyeuvc@outlook.com

MADE IN CHINA



Documents / Resources

	<p>CXY T13Plus 2000A Multi Function Portable Car Jump Starter [pdf] User Manual</p> <p>T13Plus 2000A Multi Function Portable Car Jump Starter, T13Plus, 2000A Multi Function Portable Car Jump Starter, Portable Car Jump Starter, Car Jump Starter, Jump Starter</p>
---	---

References

- [User Manual](#)