



CXY T13 Multi Function Portable Car Jump Starter User Manual

[Home](#) » [CXY](#) » CXY T13 Multi Function Portable Car Jump Starter User Manual 

Contents

- [1 CXY T13 Multi Function Portable Car Jump Starter](#)
- [2 What's in the Box](#)
- [3 AT A GLANCE](#)
- [4 SPECIFICATIONS](#)
- [5 HOW TO RECHARGE THE JUMP STARTER](#)
- [6 HOW TO JUMP START A CAR](#)
- [7 CHARGE VARIOUS DIGITAL DEVICES WITH T13](#)
- [8 LED FLASHLIGHT](#)
- [9 CUSTOMER SERVICE](#)
- [10 Documents / Resources](#)
 - [10.1 References](#)
- [11 Related Posts](#)

CXY

CXY T13 Multi Function Portable Car Jump Starter



Friendly Tips

Please carefully read the instruction manual and use product correctly based on the instruction manual so that you can be familiar with the product more conveniently and quickly! Please keep the user manual for future reference.

What's in the Box

- CXY T 13 Jump Starter x 1
- Battery clamps with starter cable x1
- High quality USB-A to USB-C cable x1
- High quality USB-C to USB-C cable x1
- Cigarette lighter converter x1
- Jump starter carry case x1
- User manual x1

AT A GLANCE

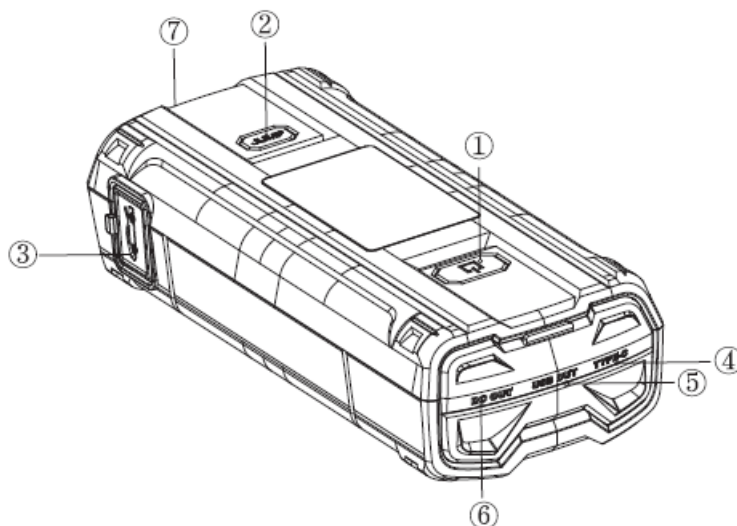

1. Power Button
2. Jump Button
3. Jumping port
4. **USB C output/input:** PD 60W
5. **USB output:** QC 18 w
6. **DC output:** 12V/6A
7. LED Light

SPECIFICATIONS

- **Capacity:** 16000mah/59.2wh
- **Weight:** 1 S00g/52.9oz
- **Size:**
 - 226*90*S4mm
 - 8.9*3.5*2.1 in
- **USB-C Input:** 5V/ 3A 9V/ 3A 12V/ 3A 15V/3A 20V/3A (PD 60W)
- **USB-C Output:** 5V/ 3A 9V/ 3A 12V/3A 15V/3A 20V/3A (PD 60W)
- **USBOutput:** 5V/3A 9V/ 2A 12V/1.5A (QC18W)
- **DC Output:** 12V/6A
- **Starting Current:** 700A
- **Peak Current:** 1500A

HOW TO RECHARGE THE JUMP STARTER

2 ways to recharge the jump starter:

1. Use a USB-C charger adapter and the USB-C cable we provided to recharge the jump starter via the USB-C port. Support PD 60W fast charging (60W PD charger adapter required)
2. Use 5521 connector chargers (5521 DC car charger, 5521 laptop charger, 5521 AC to DC adapter charger) to recharge the jump starter via the 5521 DC port.

PLEASE BE NOTED:

- This product is designed for vehicles with 12V battery only. Do not attempt to jump start vehicles with a higher battery rating, or different voltage.
- If the vehicle isn't started immediately, please wait for 1 minute to allow the jump starter to cool down before next attempt. Do not try to restart the vehicle after three consecutive attempts as this may damage the unit. Check your vehicle for other possible reasons why it can't be restarted.
- If your vehicle battery is dead or its battery voltage is under 2V, it's unable to activate the jump cable and your vehicle will not be started.

HOW TO JUMP START A CAR

1. Switch on your jump starter and make sure it's over 25% charged.

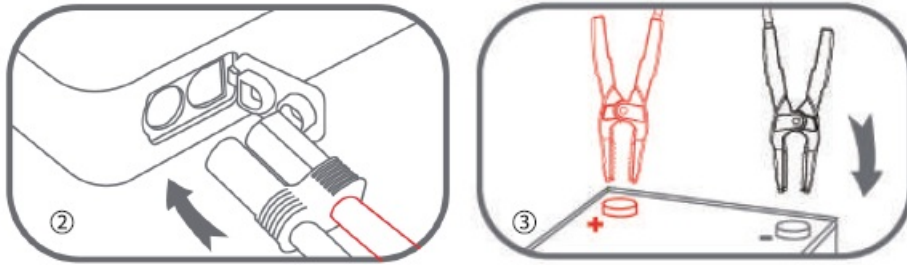

2. Insert jumper cable into jumping port.
3. Connect red clamp to positive(+) terminal and black clamp to negative(-) terminal of the car battery.
4. Press the Jump button for 3 seconds.
 - Display screen shows Orange "READY" means the jump starter and clamps are at standby mode.
 - Display screen shows Green "READY" means it's all ready to start your car.
 - Display screen shows "RC" means the clamps and car battery negative and positive poles are connected reversely. Please connect them correctly and try again.
 - Display screen shows "LV" means low voltage, please recharge the jump starter then try again.
 - Display screen shows u HT" means clamps over heat, please wait for several minutes to cool down then try again.
 - Display screen flicker "188" means the jump starter over heat, please wait for several minutes to cool down then try again.
5. Start your engine.
6. Remove clamps and jump starter.



CHARGE VARIOUS DIGITAL DEVICES WITH T13

This product has 3 output ports for multiple charging demands. Such as cellphone, tablet, iPad, laptop, PSP, gamepad, car vacuum cleaner (with the provided cigarette lighter converter) and more.

1. **USB-C PORT:** PD 60W MAX
2. **USB-A PORT:** QC 18W MAX
3. **DC PORT:** 12V/6A

LED FLASHLIGHT



Long press the power button for 3 seconds to turn on /turn off the flashlight. Quick press the power button to

switch 3 flashlight modes.

ATTENTION

- To preserve battery lifespan, use and recharge it at least once every 6 months.
- Must use our standard jump cable to jump start your car.
- DO NOT recharge the jump starter immediately after starting your car.
- Avoid dropping
- DO NOT heat the product or use it near fire.
- DO NOT put it into water or disassemble the product.

CUSTOMER SERVICE

- 24-months warranty
- Lifetime technical support

eVatmaster Consulting GmbH

Bettinastr. 30,60325 Frankfurt am Main,Germany contact@evatmaster.com.

EVATOST CONSULTING LTD

Suite 11, First Floor, Moy Road Business Centre, Taffs
Well, Cardiff, Wales, CF15 7QR contact@evatmaster.com.

- E-mail: cxyeuvvc@outlook.com.

MADE IN CHINA.

Documents / Resources

	<p>CXY T13 Multi Function Portable Car Jump Starter [pdf] User Manual T13 Multi Function Portable Car Jump Starter, T13, Multi Function Portable Car Jump Starter, F unction Portable Car Jump Starter, Portable Car Jump Starter, Car Jump Starter, Jump Starter, Starter</p>
---	--

References

- [User Manual](#)