



# Custom Dynamics CD-LPSEQ-BCM4-R Low Profile Sequential Saddlebag LED Lights Instruction Manual

[Home](#) » [Custom Dynamics](#) » Custom Dynamics CD-LPSEQ-BCM4-R Low Profile Sequential Saddlebag LED Lights Instruction Manual 

## Contents

- [1 Custom Dynamics CD-LPSEQ-BCM4-R Low Profile Sequential Saddlebag LED Lights](#)
- [2 Part Numbers](#)
- [3 Package Contents](#)
- [4 Fits](#)
- [5 ATTENTION](#)
- [6 Installation](#)
- [7 Questions](#)
- [8 Documents / Resources](#)
- [9 Related Posts](#)



**Custom Dynamics CD-LPSEQ-BCM4-R Low Profile Sequential Saddlebag LED Lights**



We thank you for purchasing the Custom Dynamics® Low Profile Se-quential Saddlebag LED Lights. Our products utilize the latest technology and high quality components to ensure you the most reliable service. We offer one of the best warranty programs in the industry and we back our products with excellent customer support, if you have questions before or during installation of this product, please call Custom Dynamics® at 1(800) 382-1388.

## Part Numbers

- CD-LPSEQ-BCM4-R
- CD-LPDC-BCM4-R
- CD-LPSEQ-BCM4-S
- CD-LPDC-BCM4-S

## Package Contents

- Saddlebag LED Light W/ Quick Disconnect Harness (2)
- BCM Adapter Harness (1)
- 4" Cable Tie (10)

## Fits

2014-2022 Harley-Davidson® Road King (FLHR), 2014 Road King CVO (FLHRSE), 2022 Street Glide ST (FLHXST), 2014-2022 Street Glide CVO™ (FLHXSE), 2022 Road Glide ST (FLTRXST), 2018-2022 Road Glide CVO™ (FLTRXSE), 2015 Road Glide Ultra CVO™ (FLTRUSE), 2014-2015 Limited CVO™ (FLHTKSE) and 2019-2022 Electra Glide Standard (FLHT).

## ATTENTION

- **Disclaimer:** Removal of our saddlebag lights after installation, may cause permanent damage to the finished surface area of the saddlebag.
- **Warning:** Disconnect negative battery cable from battery; refer to owner's manual. Failure to do so may result in electrical shock, injury or fire. Secure negative battery cable away from positive side of battery and all other positive voltage sources on vehicle.

- **Safety First:** Always wear appropriate safety gear including safety glasses when performing any electrical work. It is highly recommended that safety glasses be worn throughout this installation process. Be sure vehicle is on level surface, secure and cool.
- **Important:** This product is designed and intended for use as auxiliary lighting only. It is NOT intended to replace any original lighting installed on the vehicle and should not be used for that purpose.

## Installation

1. Remove the seat and disconnect the negative battery cable from the battery.
2. Locate the 6 pin connector going to the rear fender lighting. Unplug and install the BCM Adapter Harness in line with the rear fender lighting.  
Note: The order of installation will be bike's BCM main wiring harness, brake strobe module (if installed), BCM Adapter Harness, Run/Brake/Turn module (if installed) and then the bike's rear lighting harness.
3. Test fit the Low Profile Sequential Saddlebag Lights. The saddlebag light with the purple wire in the harness will mount on the left saddlebag. The saddlebag light with the brown wire in the harness will mount on the right saddlebag. The light should mount a couple millimeters below the bottom edge of the lid when the lid is closed. Mark the location with a grease pencil.
4. Clean area with denatured alcohol, allow to dry.
5. Remove the red adhesive backing and install the lights on the left and right saddlebags. Press into place making sure the adhesive tape is making contact with the saddle bag.
6. Remove both bags from the bike.
7. Select location for cable tie holders. Clean area with de-natured alcohol, allow to dry. Remove paper backing for cable tie holders and press into place. Refer to Picture 1.
8. Route wires from bag light to each tie wrap holder location and secure with enclosed tie wraps.
9. Reinstall saddlebags. Connect the black 4 pin JAE connector from bag lights to the BCM Adapter Harness.
10. Secure wires under the seat with the included cable ties. Make sure wiring will not come in contact with moving parts or in an area with high heat. Take care that wires will not get pinched or frayed when the seat is installed.
11. Perform a BCM sync by turning the ignition on, turn the 4 way hazards on, turn the ignition off. Allow the 4 way hazards to run for 3-4 minutes. Turn the ignition on. Turn the 4 way hazards off. Turn the ignition off.
12. Reinstall motorcycle seat and test operation of all lighting for proper running, brake and turn before riding.

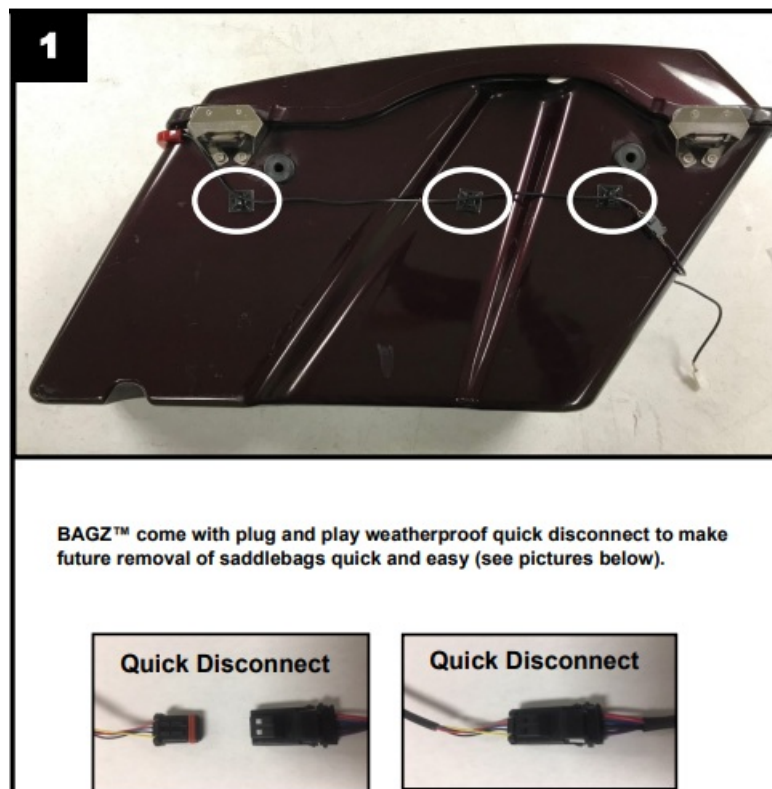

## Questions

**Call us at:** 1 (800) 382-1388 M-TH 8:30AM-5:30PM / FR 9:30AM-5:30PM EST

## Documents / Resources



[Custom Dynamics CD-LPSEQ-BCM4-R Low Profile Sequential Saddlebag LED Lights](#) [pdf]  
f] Instruction Manual

CD-LPSEQ-BCM4-R, CD-LPSEQ-BCM4-S, CD-LPDC-BCM4-R, CD-LPDC-BCM4-S, CD-LPSEQ-BCM4-R Low Profile Sequential Saddlebag LED Lights, CD-LPSEQ-BCM4-R, Low Profile Sequential Saddlebag LED Lights, Profile Sequential Saddlebag LED Lights, Sequential Saddlebag LED Lights, Saddlebag LED Lights, LED Lights, Lights