



**CD-LPF-
RZRPRO
License Plate
Frame With Tag
Light**



Custom Dynamics CD-LPF-RZRPRO License Plate Frame With Tag Light Instruction Manual

[Home](#) » [Custom Dynamics](#) » Custom Dynamics CD-LPF-RZRPRO License Plate Frame With Tag Light Instruction Manual 

Contents

- [1 Custom Dynamics CD-LPF-RZRPRO License Plate Frame With Tag Light](#)
- [2 Package Contents](#)
- [3 IMPORTANT SAFETY INFORMATION](#)
- [4 Installation](#)
- [5 CONTACT INFORMATION](#)
- [6 Documents / Resources](#)
 - [6.1 References](#)



Custom Dynamics CD-LPF-RZRPRO License Plate Frame With Tag Light



Package Contents

- License Plate Frame (1)
- Mounting Hardware Kit (1)
- Y Harness Adapter (1)
- 6" Cable Ties (10)
- **Fitment:** 2021-2024 Polaris RZR PRO

IMPORTANT SAFETY INFORMATION

ATTENTION Please read all information below before the Installation

- **Warning:** Disconnect the negative battery cable from the battery; refer to the owner's manual. Failure to do so may result in electrical shock, injury, or fire. Secure the negative battery cable away from the positive side of the battery and all other positive voltage sources on the vehicle.
- **Safety First:** Always wear appropriate safety gear including safety glasses when performing any electrical work. It is highly recommended that safety glasses be worn throughout this installation process. Be sure the vehicle is on a level surface, secure, and cool.
- **Important:** Before beginning installation, disconnect the negative battery cable from the battery to prevent damage to the LEDs or module during installation. Damage to either as a result of direct shorting is not covered under warranty.
- **Important:** For Proper fitment, the license plate may need to be cut or notched to allow the wiring from the frame to pass through. Take care when using power tools. Improper use can cause serious injury.

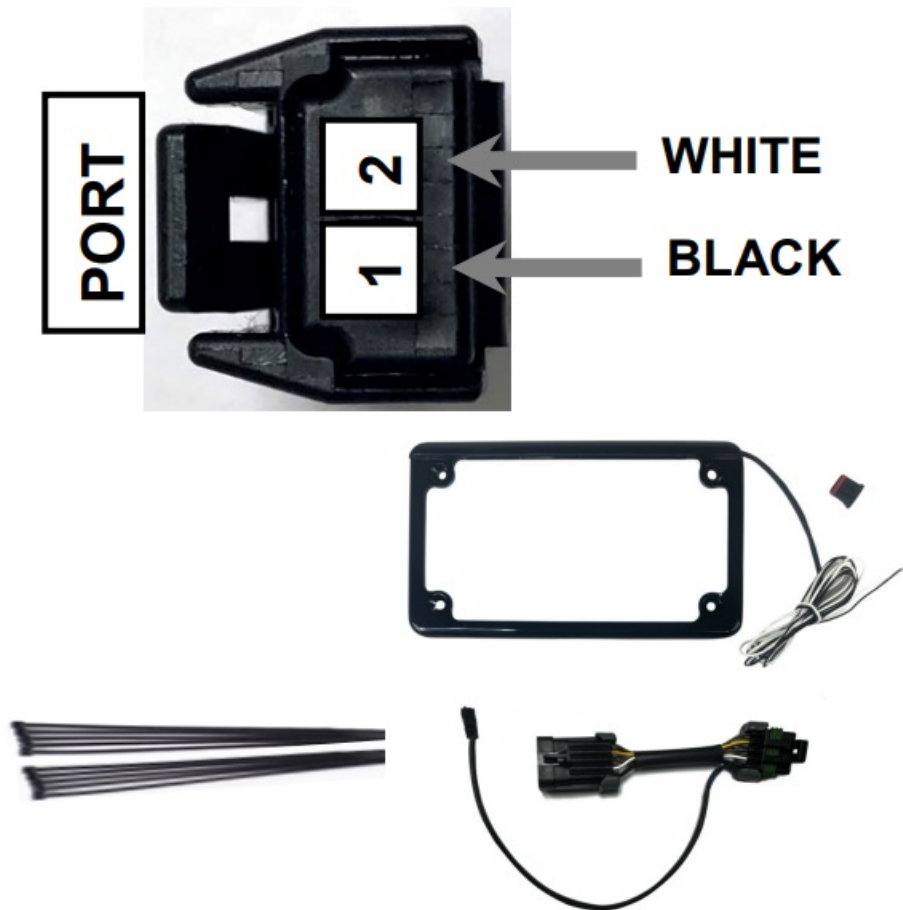

Installation

1. Secure the vehicle on a level surface. Disconnect the negative battery cable from the battery.
2. Locate and unplug the 10-position connector rear lighting harness connector to the taillights at the rear of the vehicle. The connector is typically located under the left-side rear bed rail. Plug the Y Harness Adapter, inline, into the rear lighting harness connectors.
3. Mount License Plate Frame in the desired location with the provided hardware. Notch the license plate and or any mounting surface to allow for wires to pass through, and ensure wires are protected from any sharp edges.
4. Route the License Plate Frame wiring towards the Y Harness Adapter. Secure wiring properly with the provided 6" Cable Ties.
 - **Note:** Pinched, pulled, cut, or frayed wires are not covered under warranty.
5. Install the provided Male JAE connector onto the License Plate Frame pre-pinned wires by pushing the pins into the connector ports according to Figure 1. Pins should click in place and not pull back out of the connector when installed correctly. The black wire goes into Port 1 and the white wire goes into Port 2.
6. Connect the Male JAE connector of the Plate to the Y Harness Adapter.
7. Reconnect the negative battery cable and reinstall any panels needed to access the wiring.
8. Test operation of all lighting before operating the vehicle.

CONTACT INFORMATION

- Questions?
- Email: Info@CustomDynamics.com
- Call us at 1 [800-382-1388](tel:800-382-1388) M-TH 8:30 AM-5:30 PM / FR 9:30 AM-5:30 PM EST

- **Part Numbers:** CD-LPF-RZRPRO

We thank you for purchasing the Custom Dynamics® SXS LED Plate Frame Kit. Our products utilize the latest technology and high quality components to ensure you the most reliable service. We offer one of the best warranty programs in the industry and we back our products with excellent customer support, if you have questions before or during the installation of this product please call Custom Dynamics® at 1(800) 382-1388.

Documents / Resources

	<p>Custom Dynamics CD-LPF-RZRPRO License Plate Frame With Tag Light [pdf] Instruction Manual</p> <p>CD-LPF-RZRPRO License Plate Frame With Tag Light, CD-LPF-RZRPRO, License Plate Frame With Tag Light, Frame With Tag Light, With Tag Light, Tag Light, Light</p>
---	---

References

- [User Manual](#)

Manuals+ Privacy Policy

This website is an independent publication and is neither affiliated with nor endorsed by any of the trademark owners. The "Bluetooth®" word mark and logos are registered trademarks owned by Bluetooth SIG, Inc. The "Wi-Fi®" word mark and logos are registered trademarks owned by the Wi-Fi Alliance. Any use of these marks on this website does not imply any affiliation with or endorsement.