



CURT 13579 Class 3 Square Hitch Receiver Instruction Manual

[Home](#) » [Curt](#) » CURT 13579 Class 3 Square Hitch Receiver Instruction Manual 

CURT 13579 Class 3 Square Hitch Receiver Instruction Manual



Contents

- [1 Level of Difficulty](#)
- [2 Product Photo](#)
- [3 SAFETY INSTRUCTIONS](#)
 - [3.1 Product Registration and Warranty](#)
- [4 ASSEMBLY](#)
- [5 TOWING BASICS & SAFETY INFORMATION](#)
- [6 Documents / Resources](#)
- [7 Related Posts](#)

Level of Difficulty

Easy

Installation difficulty levels are based on time and effort involved and may vary depending on the installer level of expertise, condition of the vehicle and proper tools and equipment.

Weight Carrying Capacity

Gross trailer weight (GTW): 3,500 lbs.

Tongue weight (TW): 350 lbs.

Parts List

Item Qty: Description

1: 4:Hex bolt, M12 x 1.25

2: 4: Conical-toothed washer, 1/2

Tools Required

Ratchet: Flathead screwdriver

Torque wrench: Exhaust isolator removal tool

Socket, 19mm: —

For a tools reference guide visit

curtmfg.com/trailer-hitch-installation

WARNING

Never exceed the vehicle manufacturer's recommended towing capacity

Product Photo



NOTICE

Visit www.curtmfg.com for a full-color copy of this

instruction manual, as well as helpful videos, guides and much more!

Before you begin installation, read all instructions thoroughly.

Proper tools will improve the quality of installation and reduce the time required.

This installation requires:

- Temporarily lower exhaust
- No drilling required
- No trimming required

Periodic inspection of the trailer hitch should be performed to ensure all mounting hardware remains tight and structural components are secure.

To help prevent damage to the product or vehicle, refer to the specified torque specifications when securing hardware during the installation process.

SAFETY INSTRUCTIONS

Safety glasses should be worn at all times while installing this product

Product Registration and Warranty

CURT stands behind our products with industry-leading warranties. To get copies of the product warranties, register your purchase or provide feedback, visit: warranty.curtgroup.com/surveys

ASSEMBLY

Parts	List	
Item	Qty	Description
1	4	Hex bolt, M12 x 1.25
2	4	Conical-toothed washer, 1/2

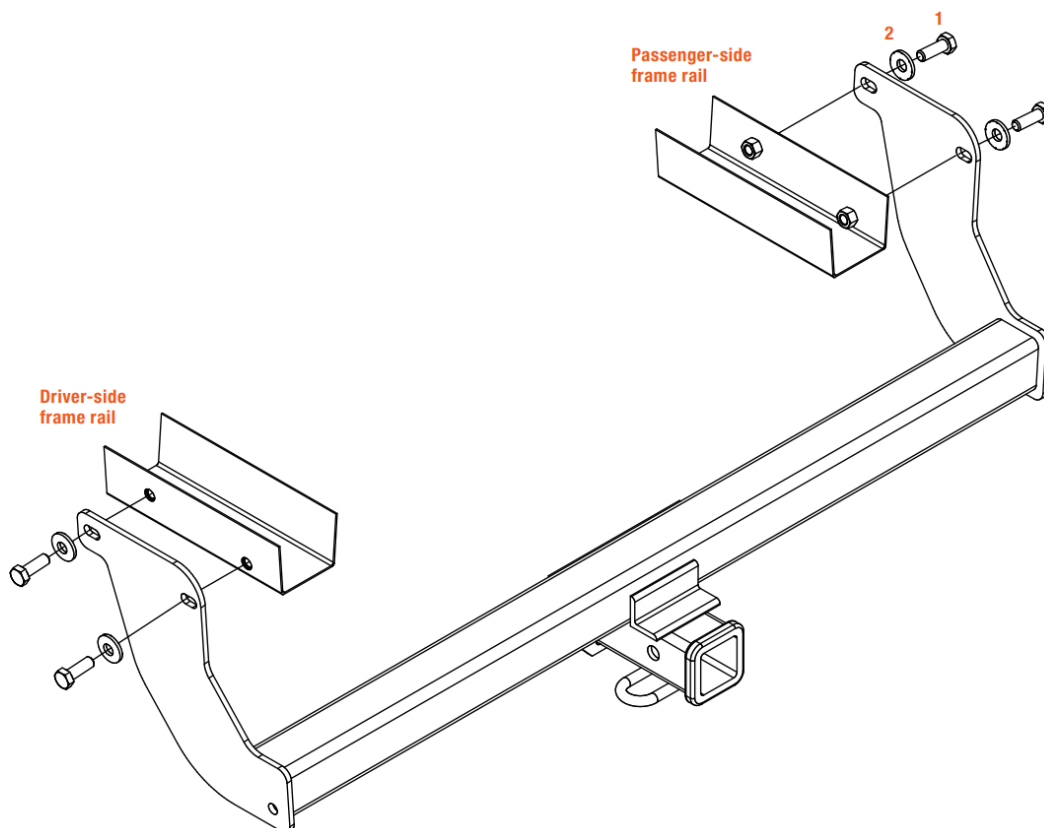

CONICAL TOOTHED WASHER ORIENTATION

WELDNUT CLEANING

To remove debris from walnuts in frame, spray lubricant or compressed air into the hole.
For heavy debris, use a wire brush.
Take care not to damage threads.

Step 1

Remove the four plastic plugs from the side of the frame rails, two on each side.



Step 2

Note: Some models may require temporarily lowering of the exhaust. To lower the exhaust, unhook the three rearmost exhaust hangers. Support the exhaust prior to prevent damage or injury



Step 3

Raise the hitch into position and install the four hex bolts (#1) and four conical-toothed washers (#2).



Step 4

Torque all M12 fasteners to 86 ft-lbs.



Step 5

Raise the exhaust back into position and reinstall the isolators if lowered in step 2.



Final Installed Image



TOWING BASICS & SAFETY INFORMATION

For information on safely towing your trailer, visit curtmfg.com/understanding-towing.



Documents / Resources

	<p>CURT 13579 Class 3 Square Hitch Receiver [pdf] Instruction Manual 13579, 13579 Class 3 Square Hitch Receiver, Class 3 Square Hitch Receiver, Hitch Receiver, Receiver</p>
--	--