



Current SARA2 LED Area Light Instruction Manual

[Home](#) » [current](#) » Current SARA2 LED Area Light Instruction Manual 

Current SARA2 LED Area Light



Contents

- [1 SAFETY INSTRUCTIONS](#)
- [2 MAINTENANCE:](#)
- [3 INSTALLATION INSTRUCTIONS:](#)
- [4 FIXTURE ATTACHMENT TO POLE:](#)
- [5 DRIVER INSTALLATION:](#)
- [6 MAINTENANCE INSTRUCTIONS:](#)
- [7 CUSTOMER SUPPORT](#)
- [8 Documents / Resources](#)
 - [8.1 References](#)
- [9 Related Posts](#)

SAFETY INSTRUCTIONS



WARNING: Fixtures must be grounded in accordance with local codes or the National Electrical Code. Failure to do so may result in serious personal injury.



WARNING: RISK OF FIRE OR ELECTRICAL SHOCK. Install this kit only in the luminaires that have the construction features and dimensions shown in the photographs and/or drawings. Luminaire's wiring, power supply, or other electrical parts may be damaged when drilling for installation of retrofit assembly hardware. Inspect all wiring and components for damage.

MAINTENANCE:

A regularly scheduled maintenance program should be established to retain optimum light output and reduce heat retention. Dusting with a soft, clean, dry cloth is normally sufficient for the reflector. Any accumulation of dust or dirt should be removed regularly from both sides of the lens during revamping (using ammonia water).

Do Not use alkaline or acid cleaners on reflector surfaces.

NOTE: All wiring must be done by a qualified electrician.

KEEP THIS SHEET FOR FUTURE REFERENCE.

INSTALLATION INSTRUCTIONS:

Make certain electrical supply is OFF before starting fixture.

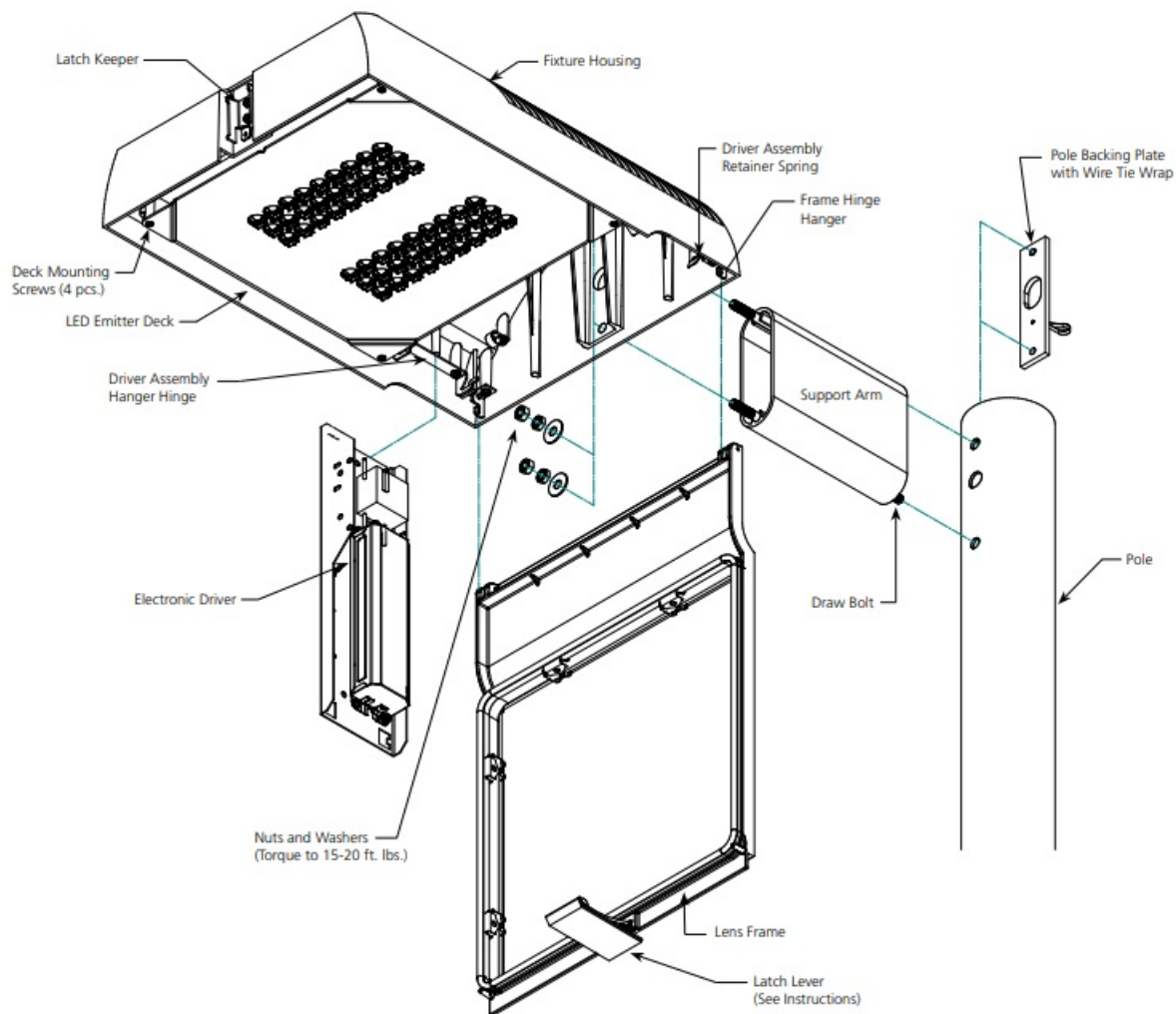

LATCH LEVER OPENING/CLOSING:

AR/SAR



1. Push up on frame and hold.
2. Pull latch lever up and out of keeper to open or on to keeper to close.

NOTE: If latch has tamper-resistant screw, use Allen wrench to remove.

CAUTION: Always hold lens frame. Damage may occur if lens frame is allowed to swing freely.

THUMB LATCH: OPENING/CLOSING:

ET/SET

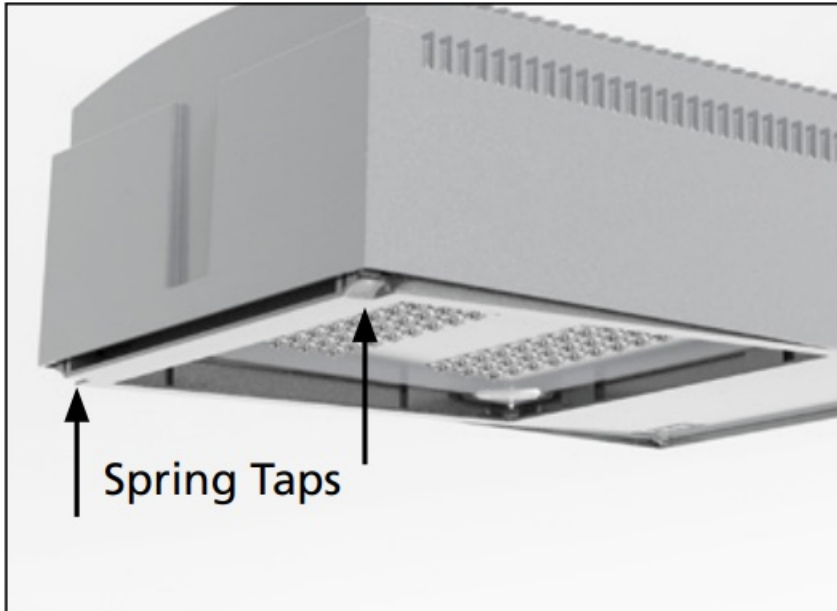

1. While holding lens frame with both hands, push both spring tabs simultaneously outward using thumbs.

CAUTION: Always hold lens frame. Damage may occur if lens frame is allowed to swing freely

FRAME REMOVAL/INSTALLATION:

AR/SAR AND ET/SET

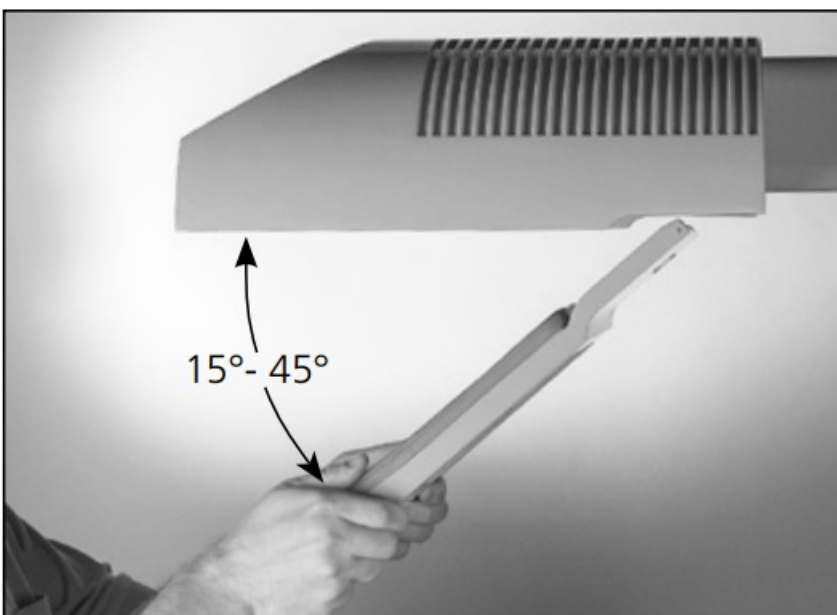

1. Open latch
2. Carefully move lens frame to a 15° to 45° angle with fixture to unhook from hinge hanger

NOTE: Frame can only be removed or attached when located between 15° and 45° angle with fixture. AR/SAR is shown..

FIXTURE ATTACHMENT TO POLE:

Tools Required:

- Flat Blade Screwdriver
- 3/32" Allen Wrench
- Torque Wrench
- Ratchet with N" 6 or 12 point deep socket



Make certain electrical power is off before starting installation.

1. Remove lens frame from fixture (see diagrams at above).
2. Lay pole horizontally on padded supports to protect finish.
3. Pull field wires through pole and out the top. Tie-wrap wires to pole backing plate. Tie field wires in a knot or backloop through tie-wrap.
4. Hold pole backing plate inside pole and thread draw bolts into backing plate. Slide support arm over draw bolts.
NOTE: Arm will have a circular cut end to fit a round pole.
5. Feed fixture wires through arm, pole, backing plate and out pole top. Mount fixture to arm (see diagram on front) using washers and thin jam nuts torqued to 15-20 ft.-lbs. Secure with thick nuts over jam nuts. Make sure fixture is square with pole before raising pole.
6. Connect fixture wires to field wires observing polarity i.e. green-to-ground white-to-common and black-to-voltage.

Optional Wall mount: See Instruction Sheet #95294.

DRIVER INSTALLATION:



Make certain electricity is off before starting installation.

1. Grasp assembly with both hands and hook it onto hanger hinges inside the compartment.
2. Join the disconnect plug halves between the Emitter Deck and the driver assembly. Then join the disconnect plug halves between the power lead-in and the driver assembly.
3. Swing the driver assembly into the housing and onto retainer spring tabs (make sure both retainer spring tabs are engaged and assembly is properly seated on hinges).

MAINTENANCE INSTRUCTIONS:



Make certain electricity is off before beginning maintenance procedures

1. For opening and closing of the fixture, refer to instructions and diagrams on other side of sheet.
2. A regularly scheduled maintenance program should be established to retain optimum light output and reduce heat retention. Dusting with a soft, clean, dry cloth is normally sufficient for the optics.

Do not use alkaline or acid cleaners on reflector surfaces.

CUSTOMER SUPPORT

currentlighting.com/kimlighting

© 2022 HLI Solutions, Inc. All rights reserved. Information and specifications subject to change without notice. All values are design or typical values when measured under laboratory conditions.

Current

Documents / Resources

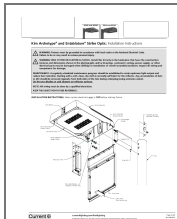

[Current SARA2 LED Area Light](#) [pdf] Instruction Manual
ARA2, SARA2, ETA2, SETA2, SARA2 LED Area Light, SARA2, LED Area Light, Area Light, Light

References

- [Web Page Under Construction](#)
- [Kim Lighting | Current - HLI Brands](#)

[Manuals+.](#)