



Current LEDL116 B LED Lamp Installation Guide

[Home](#) » [current](#) » Current LEDL116 B LED Lamp Installation Guide 

Contents

- 1 [Current LEDL116 B LED Lamp](#)
- 2 [Product Information](#)
- 3 [Product Usage Instructions](#)
- 4 [Tools Required](#)
- 5 [Installation Instructions](#)
- 6 [Documents / Resources](#)
 - 6.1 [References](#)

Current

Current LEDL116 B LED Lamp



Product Information

The LEDL116 is a Type B LED Lamp designed for installation in fixtures operating at 277-480V mains. It is compatible with ED28 (EX39) base and comes in two variants: LED150ED28/YXX/277/480 and LED115ED28/YXX/277/480. The lamp should only be used as intended by the manufacturer and is not suitable for emergency light fixtures or exit signs.

It is important to read and follow the installation instructions provided to avoid personal injury, product damage, and the risk of fire or electric shock. The lamp should not be connected to a voltage higher than 480 volts and should not be used with a ballast or igniter. Using the lamp with a HID ballast or igniter will void the warranty. Installation with voltage above 480 VAC or with a phase cut dimmer will also void the warranty.

Operating the lamp at high ambient temperatures may reduce its lifespan. In case of fuse replacement, only use a Type 5x20mm, 8A, 500Vac, Slow Blow fuse (Littelfuse part number 0477008.MXP or equivalent).

Product Usage Instructions

1. Before starting, turn off power to the fixture and remove the existing HID lamp.
2. If the fixture has a junction box, open it and bypass the HID ballast, ignitor, and capacitor by disconnecting the line and neutral wires as well as the socket black and white wires at the marked locations in the schematic diagram.
3. For open fixtures or fixtures with wire cages, connect the line to the black wire from the socket and the neutral to the white wire from the socket using UL listed wire connectors. Install the provided fuse kit on the line as shown in the schematic diagram.
4. For enclosed fixtures, follow the same wiring instructions as above.
5. Close the fixture's junction box and ensure the area is clean. Apply the re-lamp caution label to a visible location on the fixture.
6. Install the LED retrofit lamp into the socket. If using the tether kit, loop the wire of the tether around a load-bearing building structure, then feed the wire through the loop at the end of the tether before using a clip to attach it to the lamp. Minimize the length of the wire attached to the lamp and use zip ties to secure any extra

loose wire if necessary.

7. If not using the tether kit, simply install the LED retrofit lamp into the socket and close the fixture.
8. Turn on the power to the fixture and ensure proper functionality.

For any further questions or concerns, please contact the manufacturer at 1-800-327-0097.

Type B LED Lamp (277-480V)

- ED28 (EX39)
- LED150ED28/YXX/277/480
- LED115ED28/YXX/277/480

BEFORE YOU BEGIN

Read these instructions completely and carefully. To avoid personal injury and/or product damage, all of the instructions below must be followed.

WARNING:

RISK OF FIRE OR ELECTRIC SHOCK

This product is rated 277-480 V, however in the US it should only be used on branch circuits permitted in Section 210.6 of the US National Electrical Code for E39/EX39 lamp holders. LED Retrofit Kit installation requires knowledge of luminaire electrical systems. If not qualified, do not attempt installation. Contact a qualified electrician. Install this kit only in luminaires that have the construction features and dimensions shown in the drawings and where the input rating of the retrofit kit does not exceed the input rating of the luminaire. To prevent wiring damage or abrasion, do not expose wiring to edges of sheet metal or other sharp objects. Do not make or alter any open holes in an enclosure of wiring or electrical components during kit installation. Installers should examine all parts that are not intended to be replaced by the retrofit kit for damage and replace any damaged parts prior to installation of the retrofit kit.

THE RETROFIT KIT IS ACCEPTED AS A COMPONENT OF A LUMINAIRE WHERE THE SUITABILITY OF THE COMBINATION SHALL BE DETERMINED BY AUTHORITIES HAVING JURISDICTION. PRODUCT MUST BE INSTALLED BY A QUALIFIED ELECTRICIAN IN ACCORDANCE WITH THE APPLICABLE AND APPROPRIATE ELECTRICAL CODES. THE INSTALLATION GUIDE DOES NOT SUPERSEDE LOCAL OR NATIONAL REGULATIONS FOR ELECTRICAL INSTALLATIONS.

Installers should not disconnect existing wires from lamp holder terminals but should cut existing lead wires away from the lamp holder and make new electrical connections to lamp holder lead wires by employing applicable connectors. Do not use with ballast or igniter. Ensure the Misapplication fuse and fuse holder are connected between the Phase or Hot lead and the eyelet connection of the lamp holder per the wiring diagram. Ensure Safety Tether is attached to lamp and luminaire per instructions. Dimmable only when used with external Variac or similar device. Do not use with Phase cut dimmers. Install this kit only in a luminaire with a lamp compartment greater than 552 cubic inches, approximately 10 x 8 x 7 inches rectangular or 8 inch diameter x 11 inch deep cylindrical shaped area.

CAUTION

RISK OF FIRE OR ELECTRIC SHOCK

- Apply provided re-lamp caution label onto the fixture in a location where readily visible by the user during and after installation.

RISK OF FIRE OR ELECTRIC SHOCK, OVERHEATING OR LAMP DAMAGE

- Check the condition of the socket in the fixture. If the socket shows signs of corrosion, arcing, or any other type of damage like the pictures below, replace the socket with a new one.
- Ensure the EX39 socket is spring-loaded to securely grip the lamp screw base. Tighten the clamp securely into the socket.



GOOD Socket



DAMAGED Socket

Save These Instructions

Use only in the manner intended by the manufacturer. Not for use in emergency light fixtures or exit signs. If you have any questions, contact the manufacturer at 1-800-327-0097.

This lamp operates from 277-480V mains. Do not connect to voltage higher than 480 volts. Do not use with ballast or igniter. Use with HID ballast or igniter voids the warranty. Type B LED HID retrofit lamp installation with voltage above 480 VAC or phase cut dimmer voids the warranty. Operation at high ambient temperature may reduce lamp life. Replace fuse only with Type 5x20mm, 8A, 500Vac, Slow Blow, Littelfuse part number 0477008.MXP or equivalent.

Parts List

- 1 LED lamp with the tether kit
- 1 fuse kit
- 1 re-lamp caution label

Tools Required

- Screwdriver
- Wire stripper/cutter
- UL listed wire connectors

Installation Instructions

1. Turn off the power to the fixture. Remove the existing HID lamp from the fixture.
2. Open the fixture's junction box and bypass the HID ballast, ignitor (if there), and capacitor (if there) by disconnecting the line and neutral wires and socket black and white wires in the locations with "CROSS" marks in the schematic diagram.

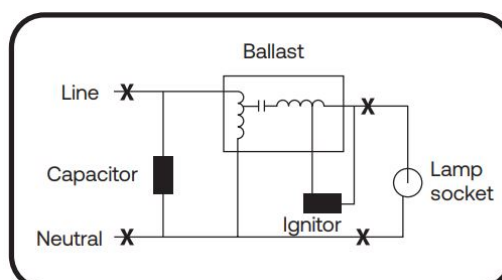

3. Connect the line to the black wire from the socket and the neutral to the white wire from the socket with UL-listed wire connectors. The fuse kit in the package should be installed on the line as shown in the schematic diagram.

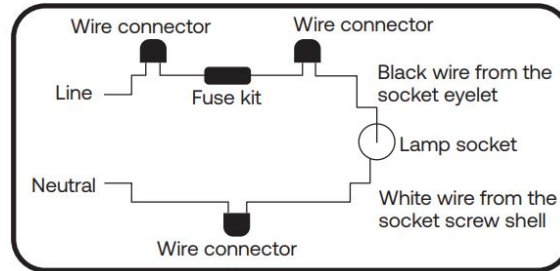

4. Close the fixture's junction box. Clean the area before applying the re-lamp caution label to a visible location on the fixture.

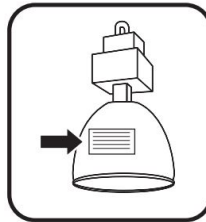

5. **For open fixtures and fixtures with a wire cage** (Illustration below is one example.)

- Install the Current HID LED retrofit lamp into the socket. Loop the wire of the tether around a load-bearing building structure, then feed the wire through the loop at the end of the tether before using clip to attach to lamp. Minimize the length of the wire attached to the lamp. Zip-tie extra loose wire if necessary.

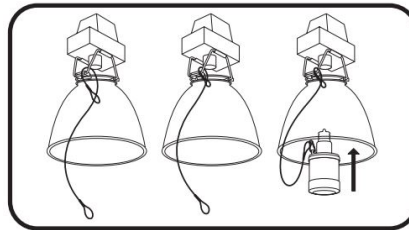

- **For the enclosed fixture** (Illustration below is one example.)
- A Tether kit is optional for enclosed fixture applications. If using, please refer to the instruction for the open fixture and check for no impact on the secured closing of the fixture door. If not using, please remove the tether kit. Install Current HID LED retrofit lamp into the socket and close the fixture.

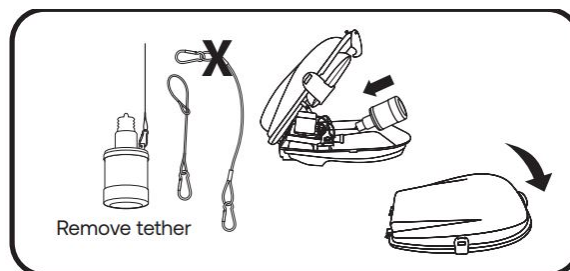

6. Turn on the power to the fixture.

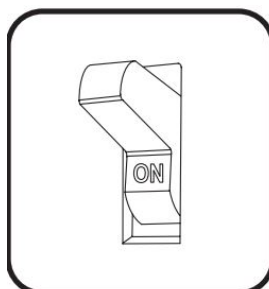

WARNING

RISK OF FALLING

- Install provided tether kit.
- Follow steps 1 to step 4 on the right to loop the tether wire.

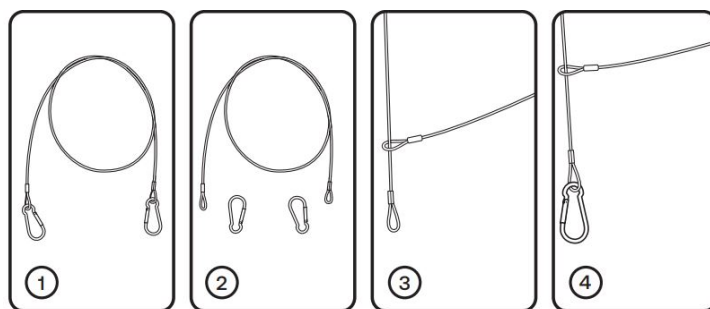

www.LED.com

© 2023 Current Lighting Solutions, LLC. All rights reserved. GE and the GE monogram are trademarks of the General Electric Company and are used under license. Information and specifications are subject to change without notice. All values are design or typical values when measured under laboratory conditions.

Documents / Resources

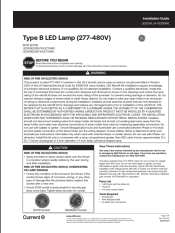
	<p>Current LEDL116 B LED Lamp [pdf] Installation Guide</p> <p>LEDL116 B LED Lamp, LEDL116, B LED Lamp, LED Lamp, Lamp</p>
--	---

References

- [C LED Commercial Lighting and Lighting Controls | Current - GLI Brands](#)