



## Current ALB062 Albeo LED Luminaire Modular High & Low Bay Lighting Installation Guide

[Home](#) » [current](#) » Current ALB062 Albeo LED Luminaire Modular High & Low Bay Lighting Installation Guide 

Current ALB062 Albeo LED Luminaire Modular High & Low Bay Lighting Installation Guide



### Contents

- [1 BEFORE YOU BEGIN](#)
- [2 Package Contents](#)
- [3 Installation Instructions](#)
- [4 Assembly Instructions](#)
- [5 Troubleshooting](#)
- [6 Customer Support](#)
- [7 Documents / Resources](#)
- [8 Related Posts](#)

### BEFORE YOU BEGIN



**WARNING**

## RISK OF ELECTRIC SHOCK

- Turn power off before inspection, installation or removal.
- Properly ground electrical enclosure.

## RISK OF FIRE

- Follow all NEC and local codes.
- Use only UL or IEC approved wire for input/output connections. Minimum size 18 AWG.

This device complies with Part 15 of the FCC Rules. Operation is subject to the following two conditions: (1) This device may not cause harmful interference, and (2) this device must accept any interference received, including interference that may cause undesired operation. CAN ICES-005 (A) / NMB-005 (A).

This equipment has been tested and found to comply with the limits for a Class A digital device, pursuant to part 15 of the FCC Rules. These limits are designed to provide reasonable protection against harmful interference when the equipment is operated in a commercial environment. This equipment generates, uses, and can radiate radio frequency energy and, if not installed and used in accordance with the instruction manual, may cause harmful interference to radio communications. Operation of this equipment in a residential area is likely to cause harmful interference in which case the user will be required to correct the interference at his own expense.

### Save These Instructions

Use only in the manner intended by the manufacturer. If you have any questions, contact the manufacturer.

**NOTE:** Contact the manufacturer for details and limitations when seeking to incorporate this product with an emergency system other than Battery Backup.

**NOTE:** CONTACT FACTORY for details and limitations when seeking to incorporate this product with an emergency system other than Battery Backup

### Prepare Electrical Wiring



### Electrical Requirements

The LED driver must be supplied with 120-480 VAC, 50/60 Hz per product label and connected to an individual properly grounded branch circuit, protected by a 15 or 20 ampere circuit breaker.



### Grounding Instructions

The grounding and bonding of the overall system shall be done in accordance with National Electric Code (NEC) Article 600 and local codes.

### Package Contents

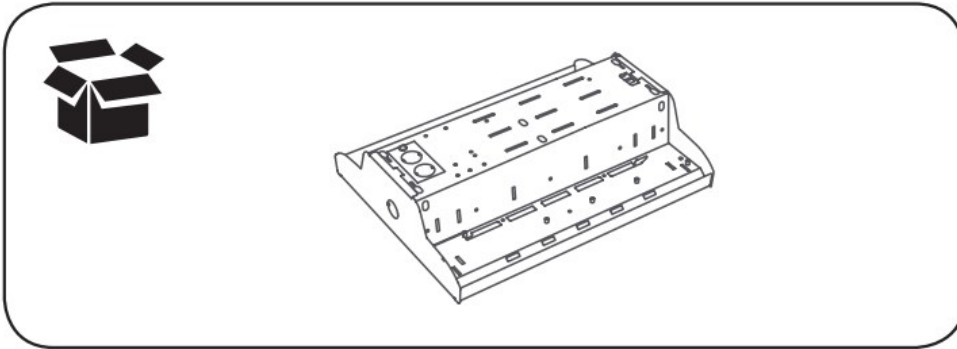
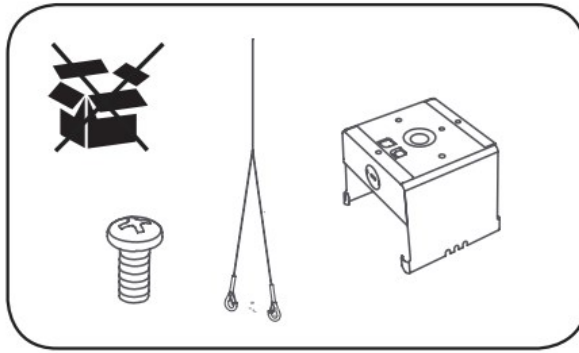

## Installation Instructions

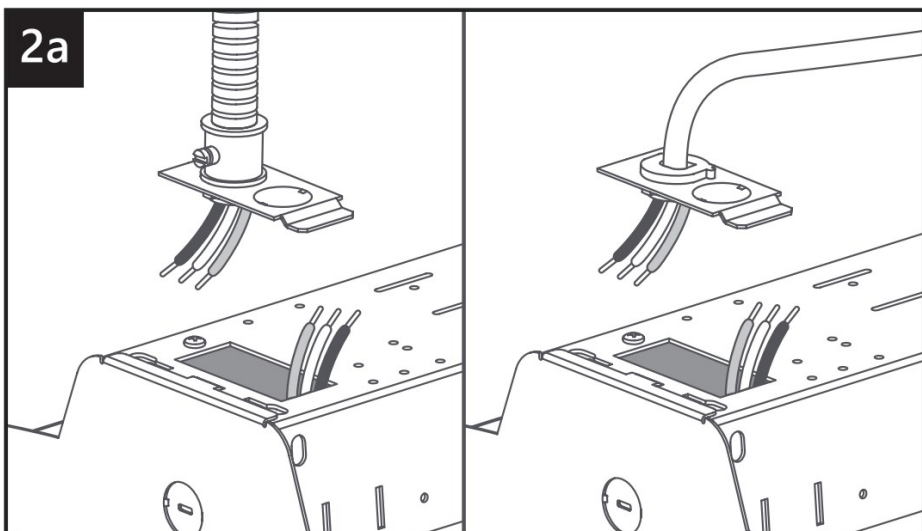
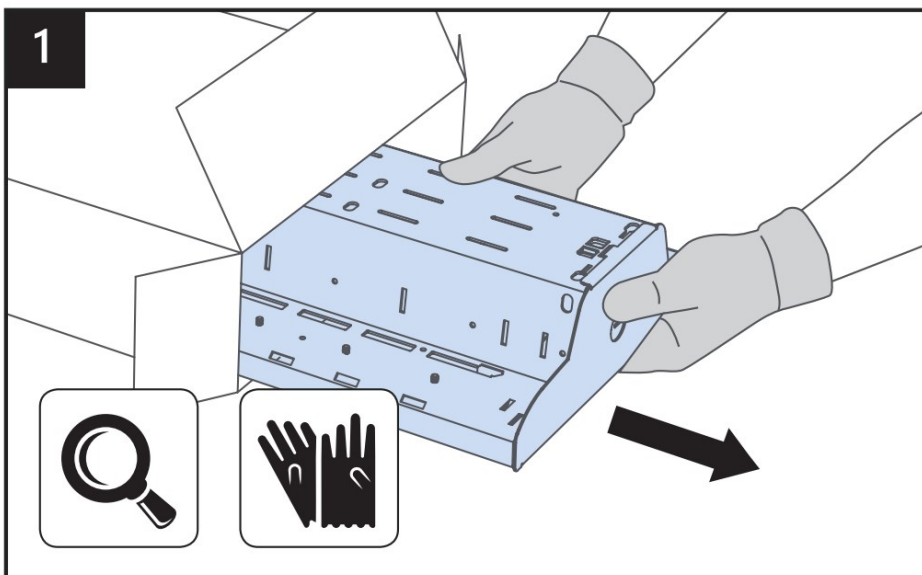

2b

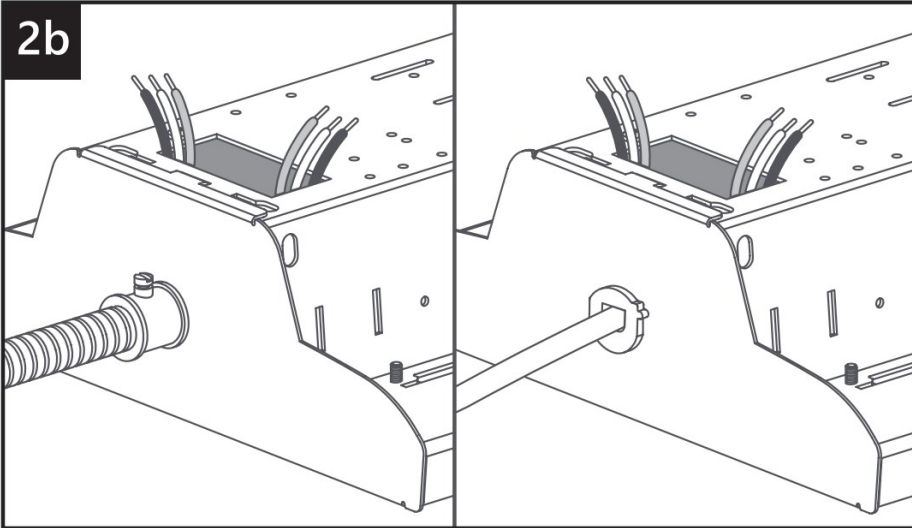

3a

120/277V

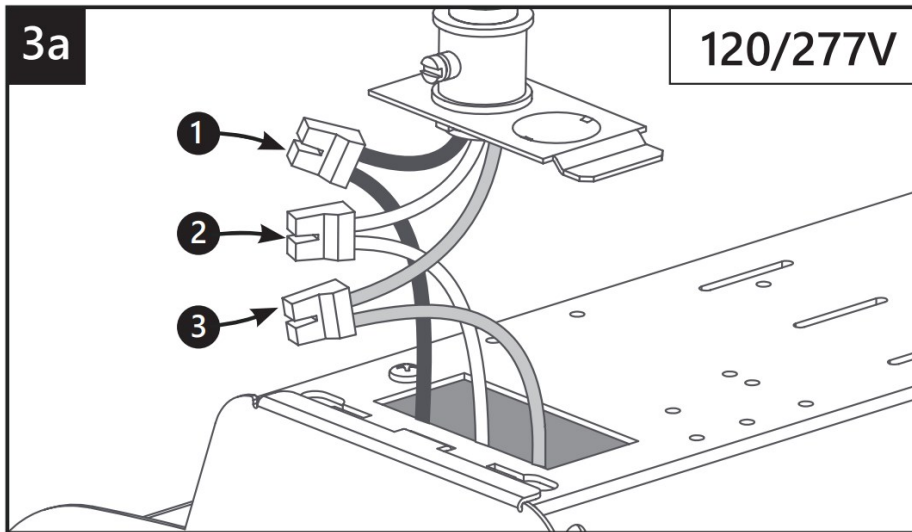

120/277V

L — BLACK ①  
N — WHITE ②  
⊕ — GREEN ③  
+ DIM — VIOLET/WHITE STRIPE  
- DIM — PINK

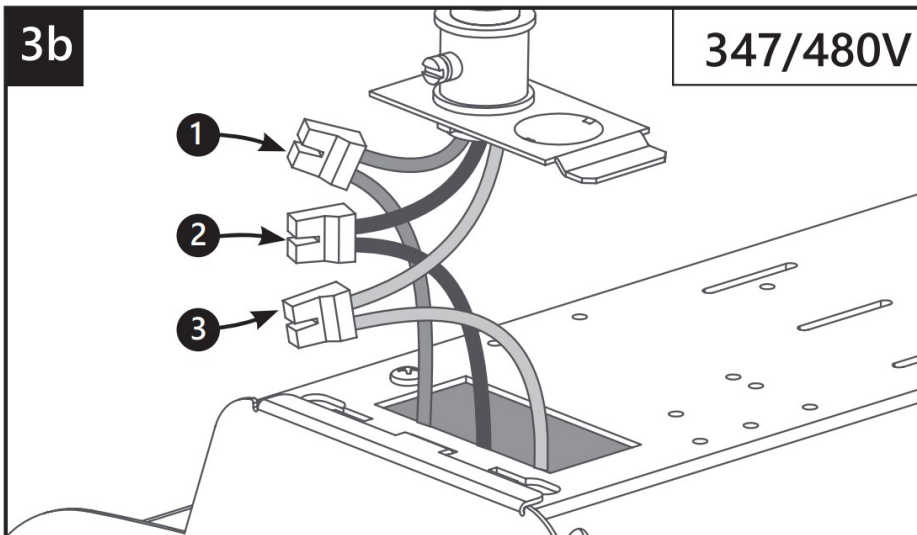

347/480V	347/480V
<p>L — RED ①</p> <p>N — BLACK ②</p> <p>⓪ — GREEN ③</p> <p>+ DIM — VIOLET/ WHITE STRIPE</p> <p>– DIM — PINK</p>	<p style="text-align: center;">Factory installed cable</p> <p>L — BLACK</p> <p>N — WHITE</p> <p>⓪ — GREEN</p> <p>+ DIM — VIOLET/ WHITE STRIPE</p> <p>– DIM — PINK</p>

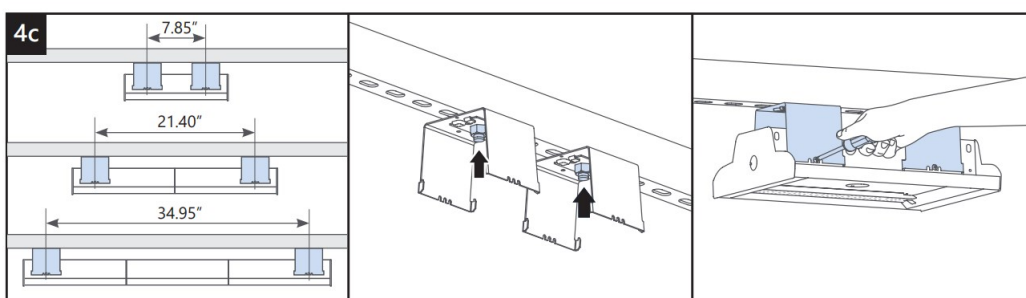
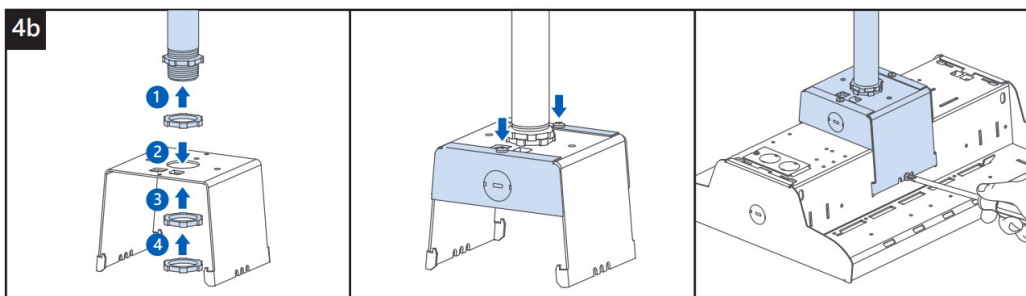
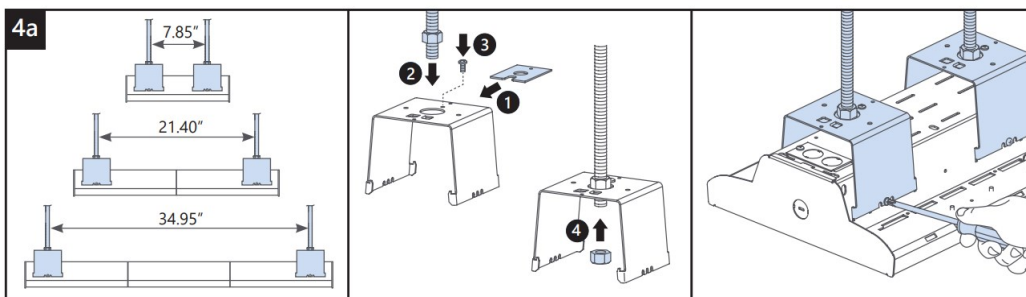

4d

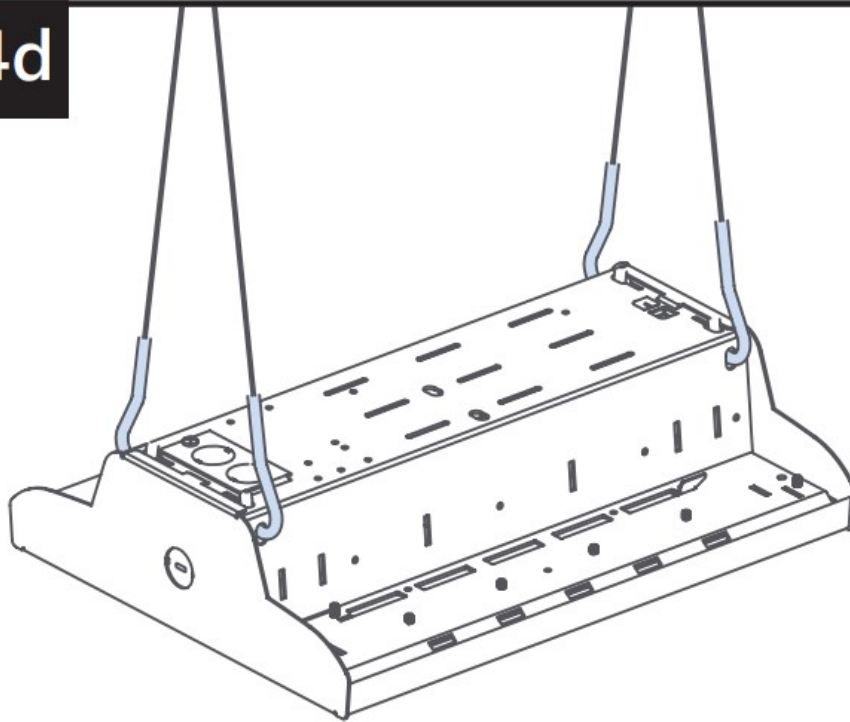

4e

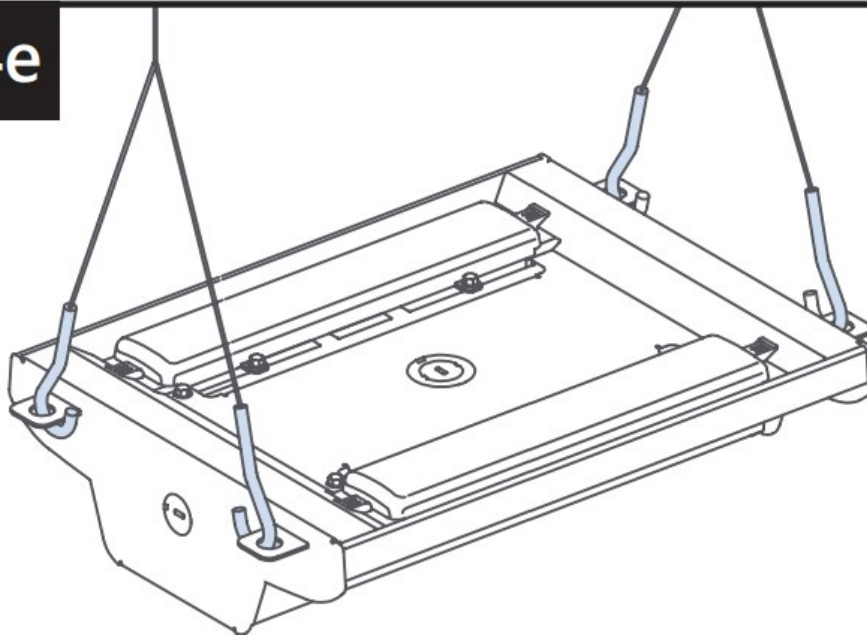

Inverted Mounting



4f

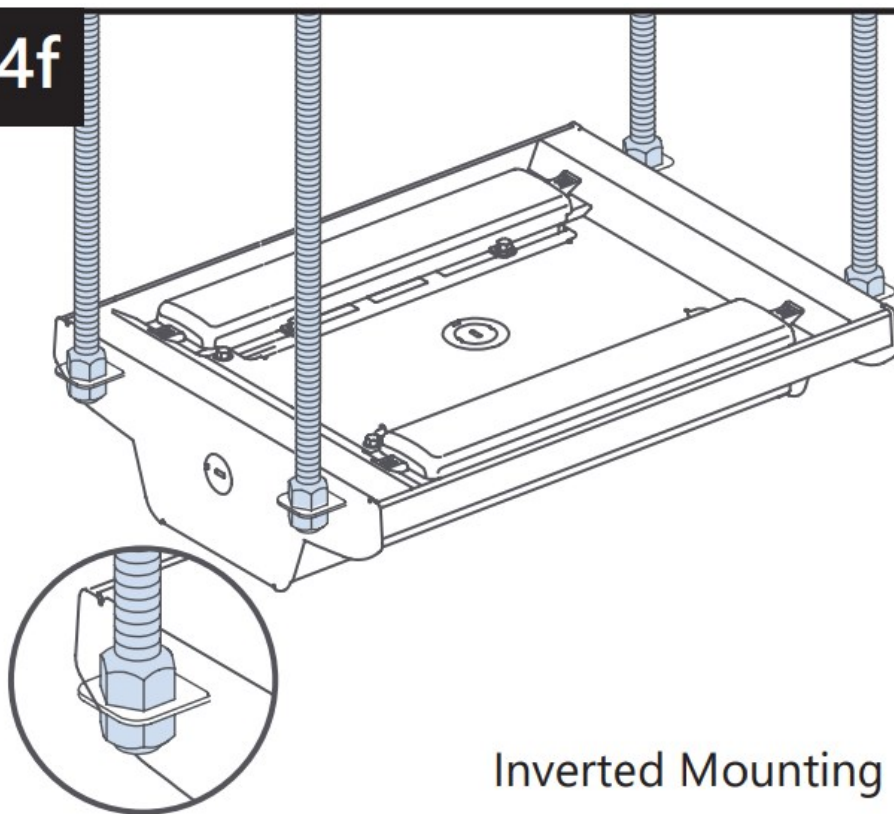

Inverted Mounting

## Assembly Instructions

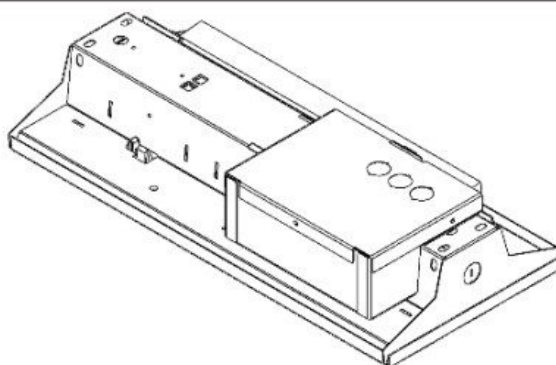
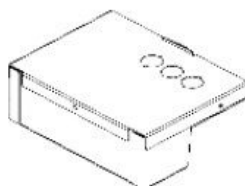

2a

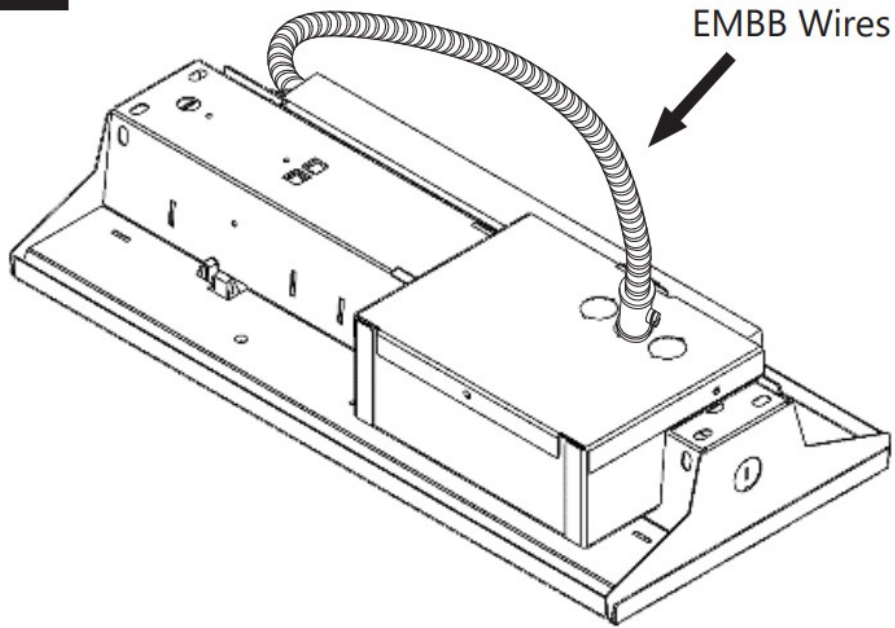

2b

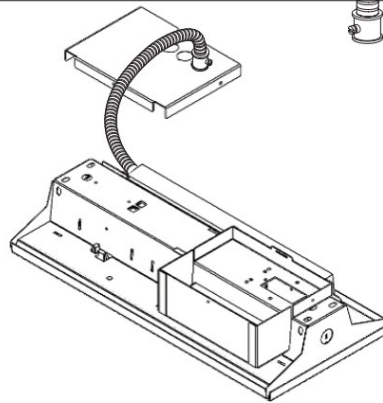
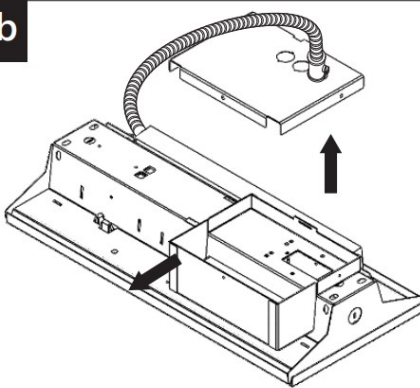

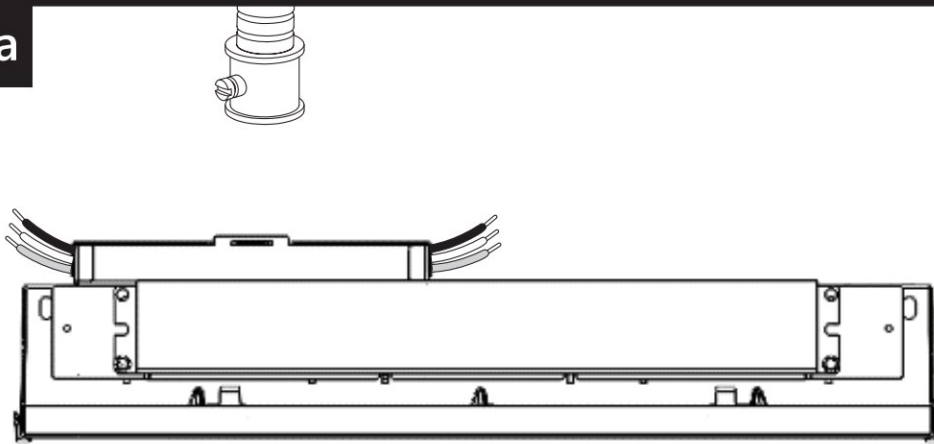

3a



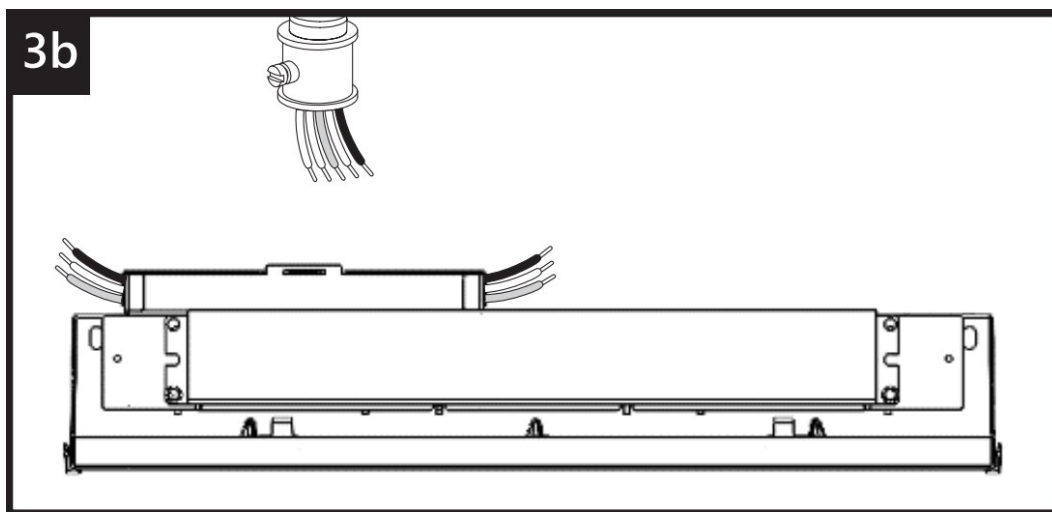

3b



N	White <b>2</b>
	Green <b>3</b>
+DIM	Violet/White Stripe
-DIM	Pink
L (unswitch)	Black
L (switch)	Red

	White	Black	Red	Green	Violet	Pink
French (FR)	Blanc	Noir	Rouge	Vert	Violet	Rose
Portuguese (PT)	Branco	Preto	Vermelho	Verde	Violeta	Cor de rosa
Spanish (ES)	Blanco	Negro	Rojo	Verde	Violeta	Rosa

## Troubleshooting

Symptom	Solution
Luminaire will not turn on	<ul style="list-style-type: none"> <li>• Check that the color of the supply side wires match the color of the wires they are connected to.</li> <li>• Check that all wire connectors are properly connected.</li> <li>• Verify that your input voltage is within specs.</li> <li>• If you are using any additional controls (i.e. wireless controls/motion sensors), please also verify that those are working properly and that the unit is setup to interface with the controllers.</li> </ul>

## Customer Support

[gecurrent.com/albeo](https://gecurrent.com/albeo)

Documents / Resources

	<p><a href="#">Current ALB062 Albeo LED Luminaire Modular High &amp; Low Bay Lighting</a> [pdf] Installation Guide</p> <p>ALB062, Albeo LED Luminaire Modular High Low Bay Lighting, Modular High Low Bay Lighting, Albeo LED Luminaire Low Bay Lighting, Low Bay Lighting, Lighting</p>
---	--