

Current ABV3-Series Albeo LED Luminaire Modular High and Low Bay Lighting Installation Guide

[Home](#) » [current](#) » Current ABV3-Series Albeo LED Luminaire Modular High and Low Bay Lighting Installation Guide 



Contents

- 1 [Current ABV3-Series Albeo LED Luminaire Modular High and Low Bay Lighting Installation Guide](#)
- 2 [Features](#)
- 3 [BEFORE YOU BEGIN](#)
- 4 [Troubleshooting](#)
- 5 [Documents / Resources](#)
 - 5.1 [References](#)
- 6 [Related Posts](#)

Current ABV3-Series Albeo LED Luminaire Modular High and Low Bay Lighting Installation Guide

Features

- 5 year warranty
- Damp location rated

BEFORE YOU BEGIN



Read these instructions completely and carefully



WARNING

RISK OF ELECTRIC SHOCK

- Turn power off before inspection, installation or removal.
- Properly ground electrical enclosure.

RISK OF FIRE

- Follow all NEC and local codes.
- Use only UL or IEC approved wire for input/output connections. Minimum size 18 AWG.

This device complies with Part 15 of the FCC Rules. Operation is subject to the following two conditions: (1) This device may not cause harmful interference, and (2) this device must accept any interference received, including interference that may cause undesired operation.

CAN ICES-005 (A) / NMB-005 (A).

This equipment has been tested and found to comply with the limits for a Class A digital device, pursuant to part 15 of the FCC Rules. These limits are designed to provide reasonable protection against harmful interference when the equipment is operated in a commercial environment. This equipment generates, uses, and can radiate radio frequency energy and, if not installed and used in accordance with the instruction manual, may cause harmful interference to radio communications. Operation of this equipment in a residential area is likely to cause harmful interference in which case the user will be required to correct the interference at his own expense.

Save These Instructions

Use only in the manner intended by the manufacturer. If you have any questions, contact the manufacturer.

NOTE: Contact the manufacturer for details and limitations when seeking to incorporate this product with an emergency system other than Battery Backup.

NOTE: CONTACT FACTORY for details and limitations when seeking to incorporate this product with an emergency system other than Battery Backup.

Prepare Electrical Wiring



Electrical Requirements

The LED driver must be supplied with 120-480 VAC, 50/60 Hz per product label and connected to an individual properly grounded branch circuit, protected by a 15 or 20 ampere circuit breaker.



Grounding Instructions

The grounding and bonding of the overall system shall be done in accordance with National Electric Code (NEC) Article 600 and local codes.

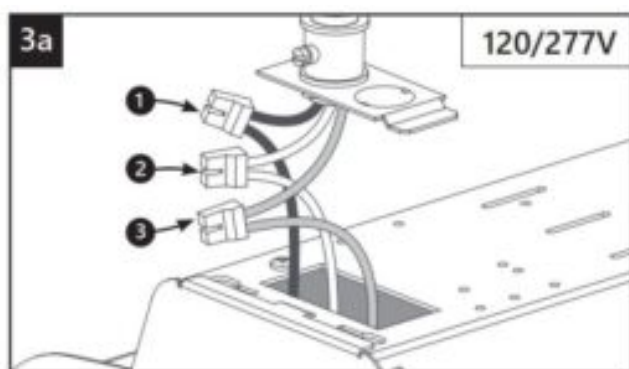
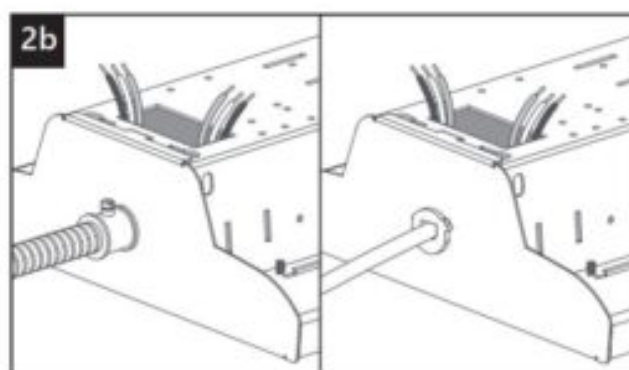
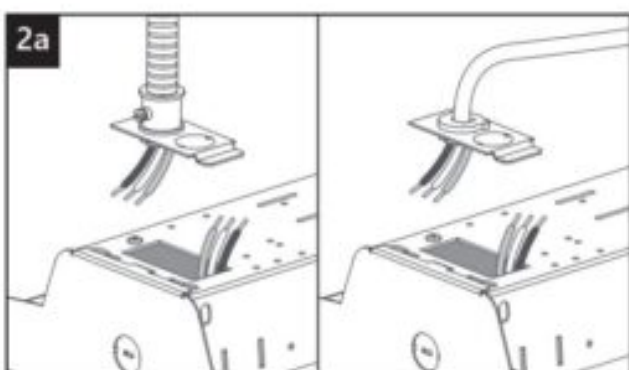
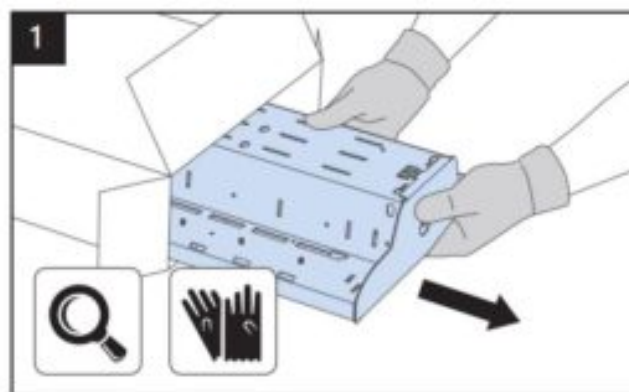
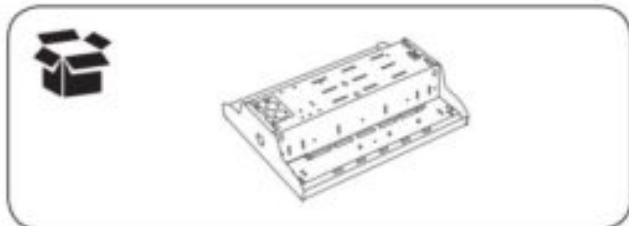
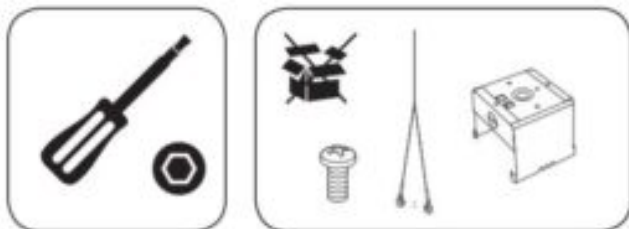

| 120/277V | |
|-----------------------------|--|
| L — BLACK ❶ | |
| N — WHITE ❷ | |
| ⊕ — GREEN ❸ | |
| + DIM — VIOLET/WHITE STRIPE | |
| - DIM — PINK | |

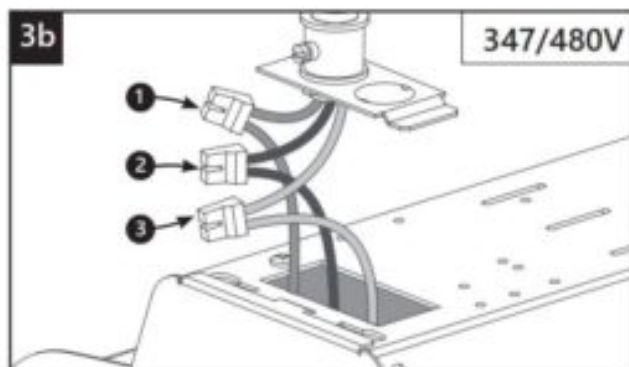

| 347/480V | 347/480V |
|-----------------------------|-----------------------------|
| | Factory installed cable |
| L — RED ❶ | L — BLACK |
| N — BLACK ❷ | N — WHITE |
| ⊕ — GREEN ❸ | ⊕ — GREEN |
| + DIM — VIOLET/WHITE STRIPE | + DIM — VIOLET/WHITE STRIPE |
| - DIM — PINK | - DIM — PINK |



ABV3 Series



4a

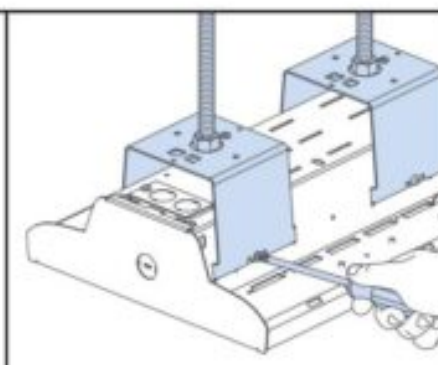
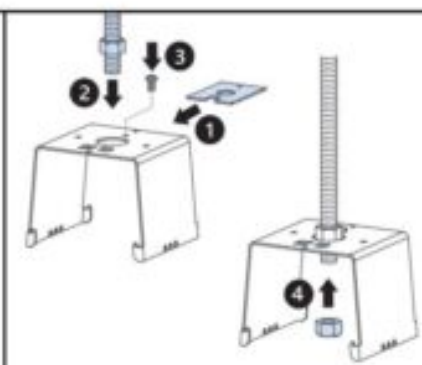
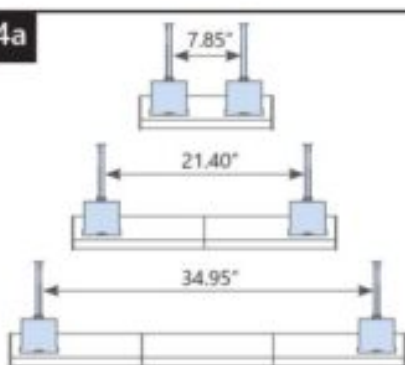

4b

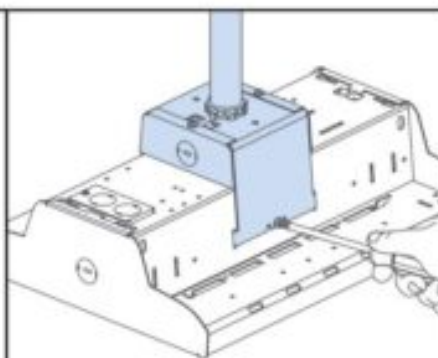
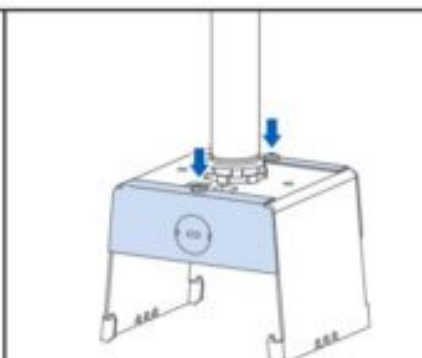
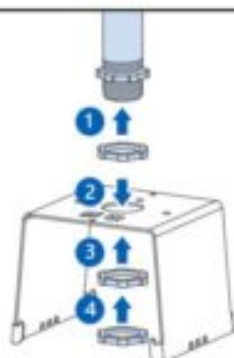

4c

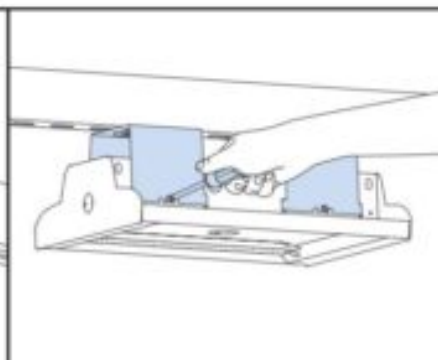
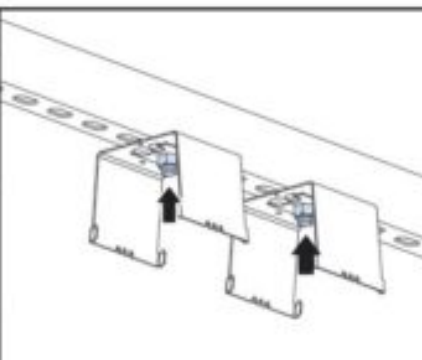
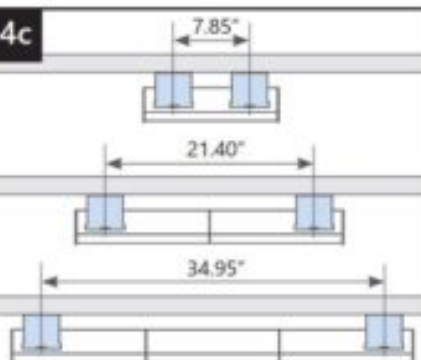

4d

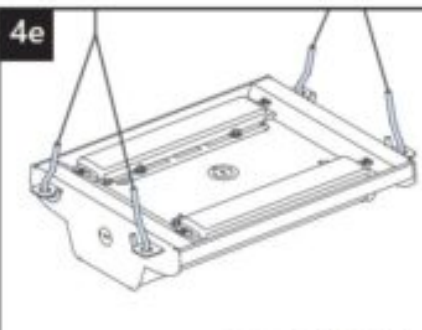
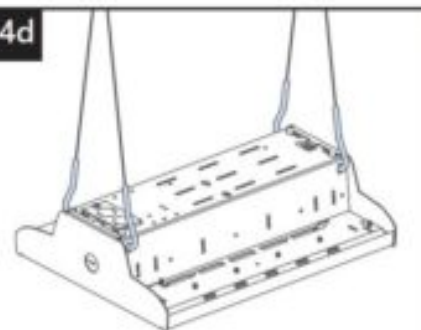

Inverted Mounting

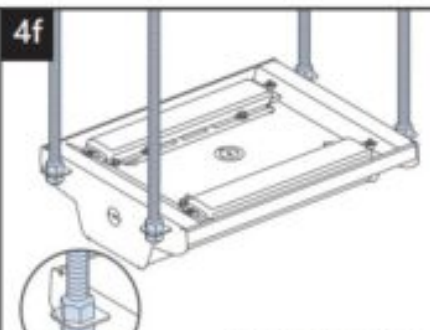

Inverted Mounting

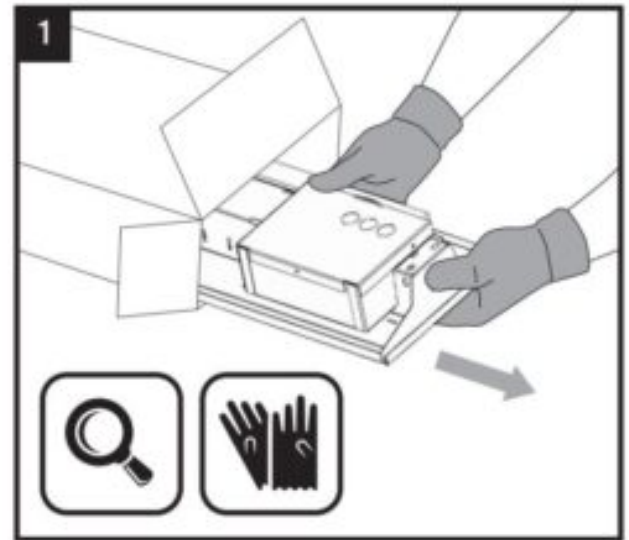
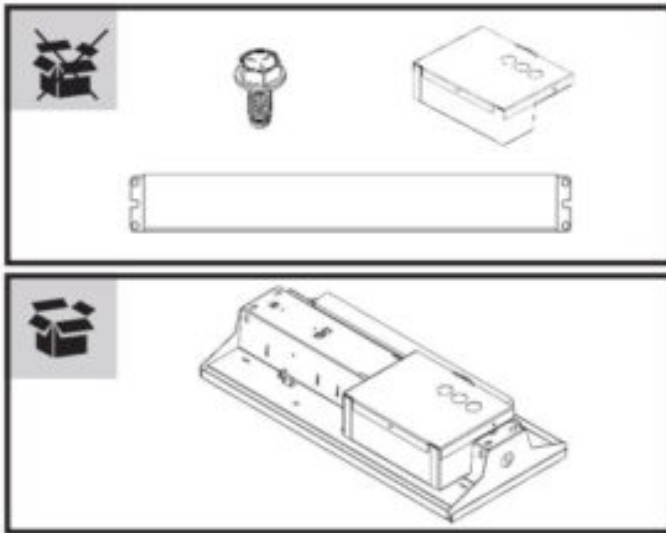

For 347/480v only see below steps in opening box.
For 120/277V follow same steps in accessing Knock Out plate for wiring.

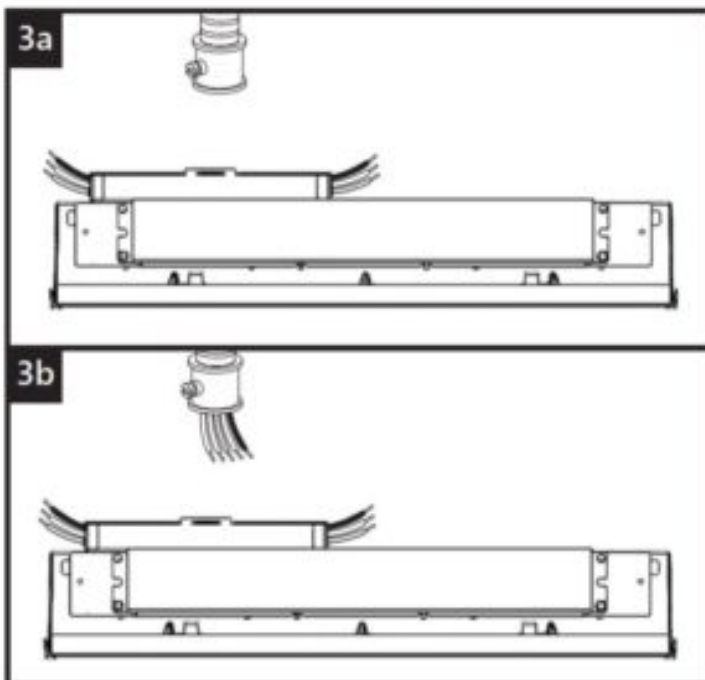
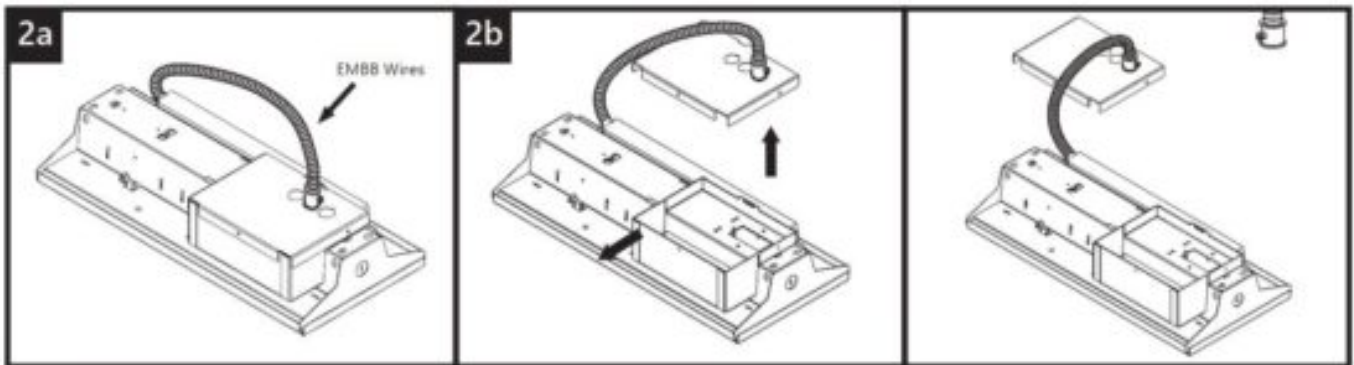

| | |
|--------------|---------------------|
| N | White ② |
| ⊕ | Green ① |
| +DIM | Violet/White Stripe |
| -DIM | Pink |
| L (unswitch) | Black |
| L (switch) | Red |

Troubleshooting

| Symptom | Solution |
|----------------------------|--------------------------------------------------------------------------------------------------------------------------------------------------------------------------------------------------------------------------------------------------------------------------------------------------------------------------------------------------------------------------------------------------------------------------------------------------------------------------------------------------|
| Luminaire will not turn on | <ul style="list-style-type: none"> • Check that the color of the supply side wires match the color of the wires they are connected to. • Check that all wire connectors are properly connected. • Verify that your input voltage is within specs. • If you are using any additional controls (i.e. wireless controls/motion sensors), please also verify that those are working properly and that the unit is setup to interface with the controllers. |



www.gecurrent.com

© 2021 Current Lighting Solutions, LLC. All rights reserved. GE and the GE monogram are trademarks of the General Electric Company and are used under license. Information provided is subject to change without notice. All values are design or typical values when measured under laboratory conditions.
ALB062 (Rev 04/12/22)

Read More About This Manual & Download PDF:

Documents / Resources

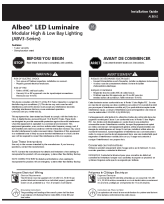
| | |
|-------------------------------------------------------------------------------------|-------------------------------------------------------------------------------------------------------------------------------------------------------------------------------------------------------------------------------------------------------------------------------------------------------------------------------------------------------------------------|
|  | <p>Current ABV3-Series Albeo LED Luminaire Modular High and Low Bay Lighting [pdf]</p> <p>Installation Guide</p> <p>ABV3-Series Albeo LED Luminaire Modular High and Low Bay Lighting, ABV3-Series, Albeo LED Luminaire Modular High and Low Bay Lighting, Albeo LED Luminaire Modular High and Low Bay Lighting, Modular High and Low Bay Lighting</p> |
|-------------------------------------------------------------------------------------|-------------------------------------------------------------------------------------------------------------------------------------------------------------------------------------------------------------------------------------------------------------------------------------------------------------------------------------------------------------------------|

References

- [C Commercial Lighting and Lighting Controls | Current - GLI Brands](#)