

Curiouser Products CW3 Connected Weights Instructions

[Home](#) » [Curiouser Products](#) » Curiouser Products CW3 Connected Weights Instructions 

Curiouser Products CW3 Connected Weights

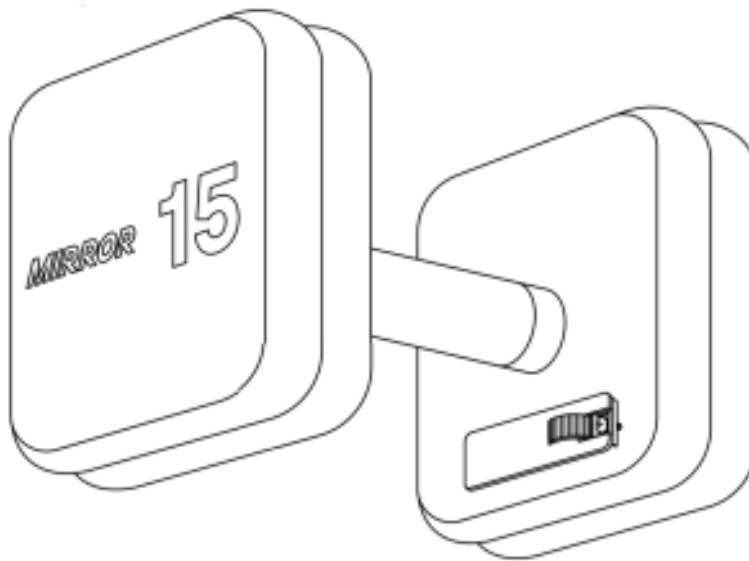

Contents

- [1 CONNECTED DUMBBELLS](#)
 - [1.1 PLEASE READ: IMPORTANT SAFETY INFORMATION](#)
- [2 Documents / Resources](#)
- [3 Related Posts](#)

CONNECTED DUMBBELLS

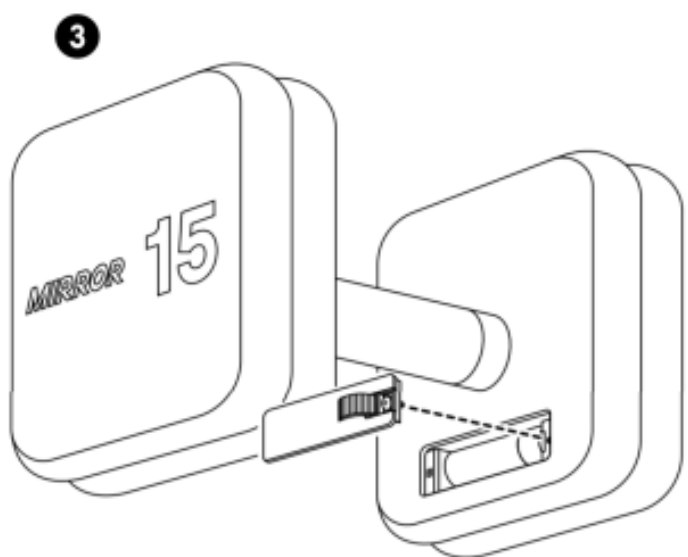
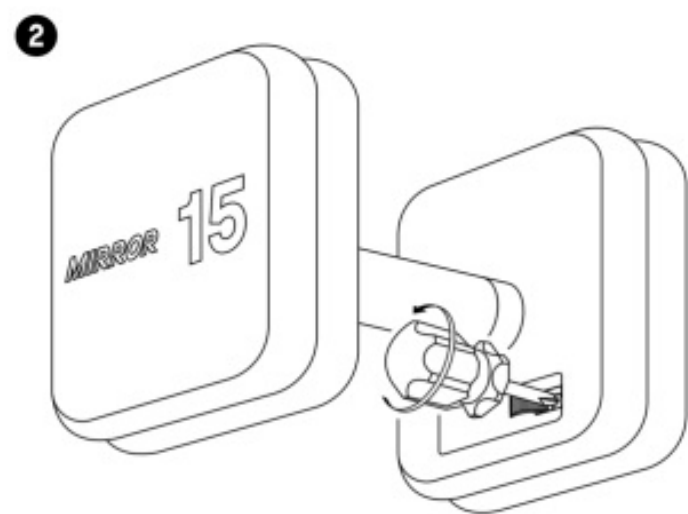
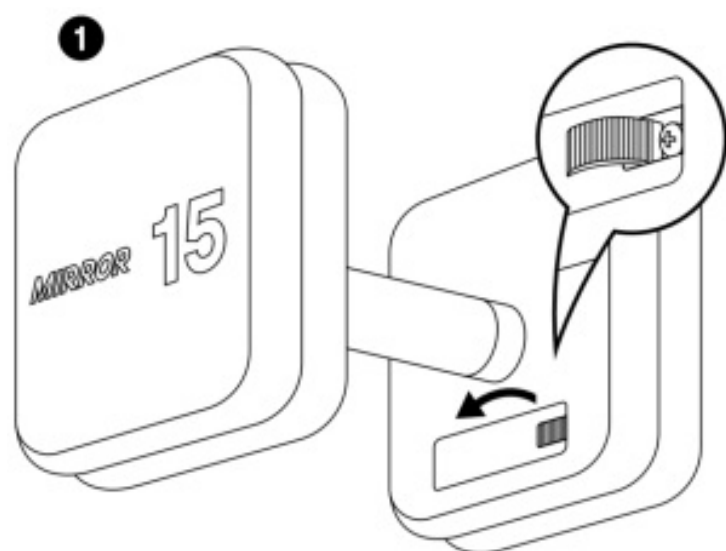

4

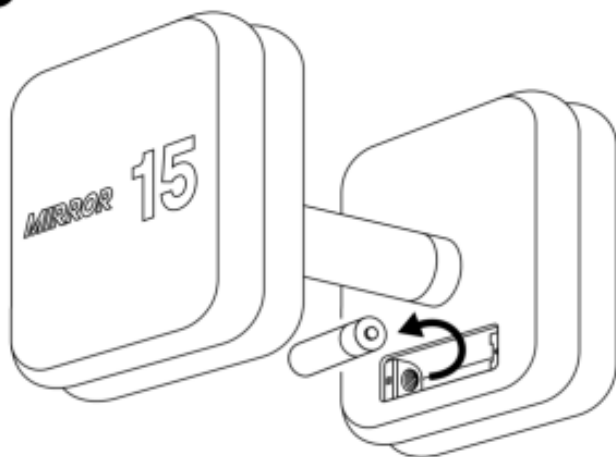

PLEASE READ: IMPORTANT SAFETY INFORMATION

- Please read all warnings and Instructions prior to use and retain this owner's guide.
- Use only as described In this guide or instructed in fitness program.
- Inspect before each use.
- Use at a minimum distance of 3 feet from the base of the Mirror
- Use and store on a level nat surface
- Ensure clearance beyond your reach for planned exercises.
- Always wear protective footwear while handling or using.
- Not intended for outdoor use.
- Keep out of reach of children under the age of 14 and pets.
- Never allow the weight to drop to the ground.
- Do not use if damaged
- Do not submerge or allow product to become wet.
- Do not use In combination with other fitness machines
- Do not forcibly hit the weights together during use

FCC

This device complies with Part 15 of the FCC Rules. Operation rs subject to the follow Ing two conditions: (1) this device may not cause harmful interference, and (2) this device must accept any interference received, including interference that may cause undesired operation. Changes or modifications not expressly approved by the party responsible for compliance could void the user's authority to operate the equipment.

This equipment has been tested and found to comply with the limits for a Class B digital device. pursuant to part 15 of the FCC Rules. These limits are designed to provide reasonable protection against harmful interference in a residential installation. This equipment generates, uses and can radiate radio frequency energy and, if not instaled and used in accordance with the instructions, may cause harmful interference to radio communications. However, there is no guarantee that interference will not occur In a particular install ation. If this equipment does cause harmful interference to radio or television reception, which can be determined by turning the equipment off and on. the user is encouraged to try to correct the Interference by one or more of the following measures:

- Reorient or relocate the receiving antenna. Increase the separation between the equipment and receiver.
- Connect the equipment into an outlet on a circuit different from that to which the receiver is connected.
- Consult the dealer or an experienced radio/TV technician for help.

IC

This device contains licence-exempt transmitter(s)/receiver(s) that comply with Innovation, Science and Economic Development Canada's licence- exempt RSS(s). Operation is subject to the following two conditions: (1) This device may not cause interference. (2) This device must accept any interference, including interference that may cause undesired operation of the device.

MIRROR

www.mirror.co/patents

Documents / Resources

	<p>Curiouser Products CW3 Connected Weights [pdf] Instructions MCW2, 2AOSD-MCW2, 2AOSDMCW2, MCW3, 2AOSD-MCW3, 2AOSDMCW3, CW3 Connected Weights, Connected Weights</p>
---	---

[Manuals+](#)