



# Cuisinart CGWM-043 Bluetooth Easy Connect Thermometer User Guide

[Home](#) » [Cuisinart](#) » Cuisinart CGWM-043 Bluetooth Easy Connect Thermometer User Guide 

## Contents

- 1 Cuisinart CGWM-043 Bluetooth Easy Connect Thermometer
- 2 PRODUCT INFORMATION
- 3 SETTING UP YOUR THERMOMETER
- 4 INSTALLING THE BATTERIES
- 5 CONNECTING THE PROBES
- 6 Documents / Resources

# Cuisinart

**Cuisinart CGWM-043 Bluetooth Easy Connect Thermometer**



## PRODUCT INFORMATION

Model NO: CGWM-043

Thank you for purchasing the Bluetooth™ Easy Connect Meat Thermometer by Cuisinart®. The Bluetooth™ Easy Connect Meat Thermometer will help you grill to perfection for every grill session. Keep this quick start guide for future reference. Please read the following instructions and warnings carefully.

## QUICK START GUIDE

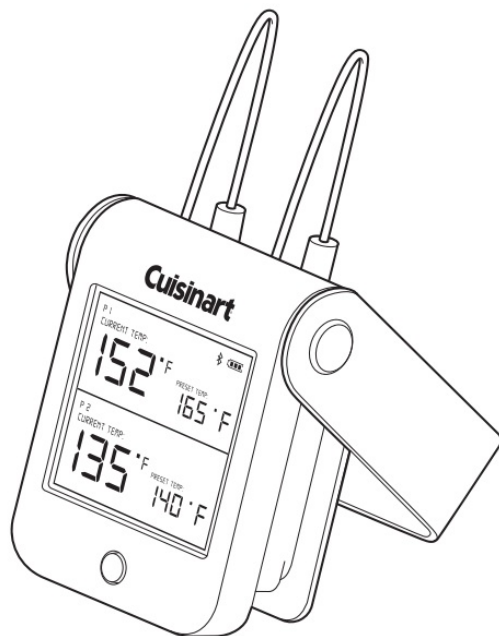

## SETTING UP YOUR THERMOMETER

### COMPONENTS

- Bluetooth™ Easy Connect Meat Thermometer Unit

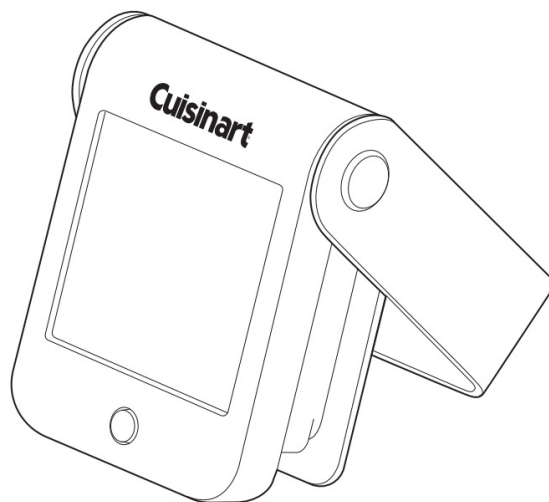

- Probes (2)

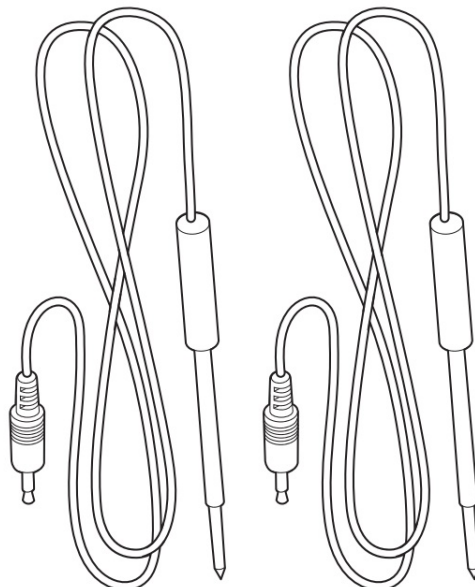

## INSTALLING THE BATTERIES

1. Slide the cover off the unit.
2. Install 2 AA batteries.
3. Replace cover.

- Do not mix Old and new batteries
- Do not mix alkaline, standard (carbon-zinc), or rechargeable (ni-cad, ni-mh, etc.) batteries

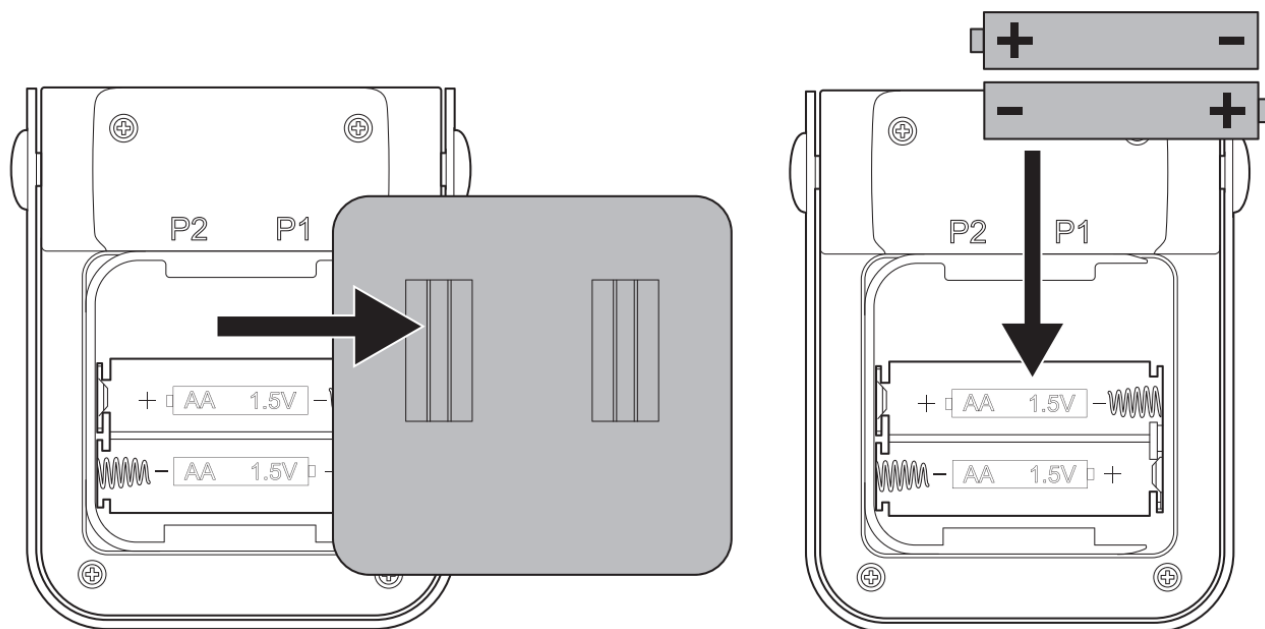

## CONNECTING THE PROBES

1. Insert the probes into the holes (labeled P1 and P2) on the back of the unit (probes are interchangeable).
2. Once the probes are connected, insert either probe into the center of the thickest portion of the meat you are grilling (preferably away from bone or gristle). Repeat with the second probe to monitor a separate piece of meat on the grill.





## Documents / Resources

