

cudy
WR3000E Mesh Wi-Fi 6 Router



cudy WR3000E Mesh Wi-Fi 6 Router Installation Guide

[Home](#) » [cudy](#) » cudy WR3000E Mesh Wi-Fi 6 Router Installation Guide 

Contents

- [1 cudy WR3000E Mesh Wi-Fi 6 Router](#)
- [2 Specifications](#)
- [3 Product Usage Instructions](#)
- [4 Installation](#)
- [5 LED](#)
- [6 Declaration of Conformity](#)
- [7 WEEE](#)
- [8 GNU General Public License Notice](#)
- [9 Frequently Asked Questions \(FAQ\):](#)
- [10 Documents / Resources](#)
 - [10.1 References](#)
- [11 Related Posts](#)

cudy

cudy WR3000E Mesh Wi-Fi 6 Router



Specifications

- Model: Cudy Router
- Wireless Standard: 2.4G / 5 GHz Wi-Fi
- Ports: WAN, LAN
- Power: Power adapter
- Support: <http://www.cudy.com/support>

Product Usage Instructions

Power On and Hardware Connection:

1. Turn off the modem and remove the battery if applicable.
2. Connect Cudy's WAN port to your ISP modem.
3. Turn on the modem and wait 2 minutes for it to restart.
4. Connect the power adapter to the router and wait for the Power system indicator light to turn solid on.
5. Check if the four LEDs are solid on to confirm correct hardware connection.

Connecting Devices:

Wi-Fi Connection:

- Connect your device to the router's Wi-Fi using the SSID (network name) and Password printed on the bottom of the router.

- SSID: Cudy-****-5G

Wired Connection:

1. Turn off the Wi-Fi on your computer.
2. Connect your computer to the router's LAN port using an Ethernet cable.

Setting Up Internet Connection:

1. Launch a web browser and enter <http://cudy.net/> or <http://192.168.10.1/> in the address bar.
2. Create an administrator password to log in.
3. Follow the step-by-step instructions to set up the internet connection.

Additional Features:

- The router supports multiple operation modes like Wireless Router, wireless access point, wireless extender, and WISP.
- You can scan the QR Code to download the Cudy App for additional functionality.

Enjoy the Internet!

Installation

1. Turn off the modem, and remove the battery if it has one.
2. Connect Cudy's WAN port to your ISP modem.
3. Turn on the modem and then wait about 2 minutes for it to restart.
4. Connect the power adapter to the router and wait for the "Power" system indicator light to turn solid on.

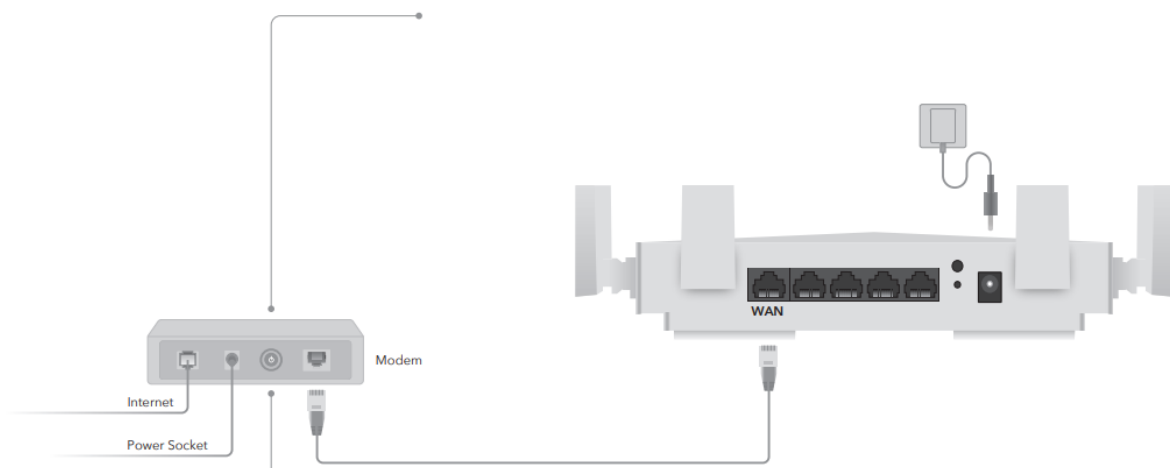

5. Check if the four LEDs are solid on to confirm the hardware is connected correctly.



6. Connect the router via A or B method.



A Wi-Fi: Connect your device to the router's Wi-Fi using the SSID (network name) and Password printed on the bottom of the router.

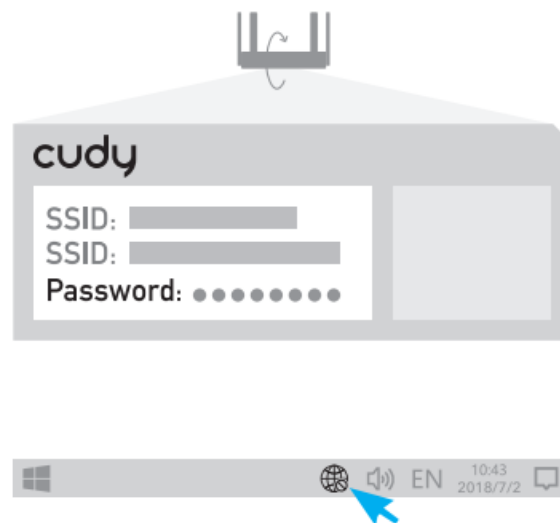

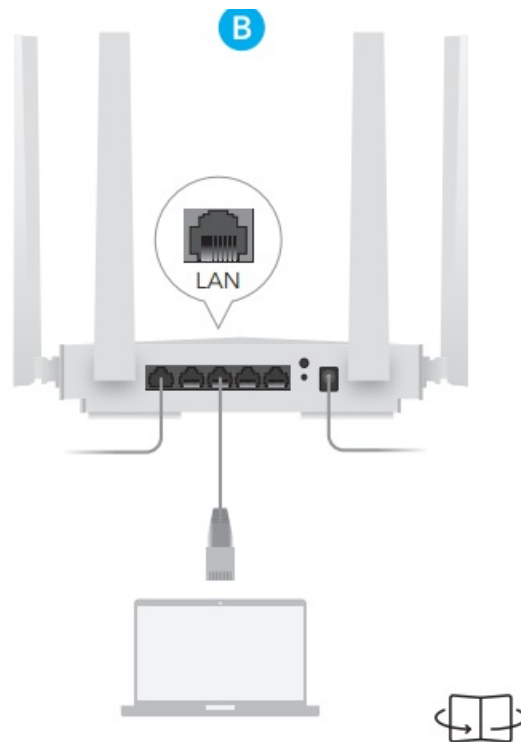

Go to step 7 and continue.

B Wired: Turn off the Wi-Fi on your computer and connect it to the router's LAN port via an Ethernet cable.

7. Launch a web browser, and enter <http://cudy.net/> or <http://192.168.10.1/> in the address bar. Create an administrator password to log in.

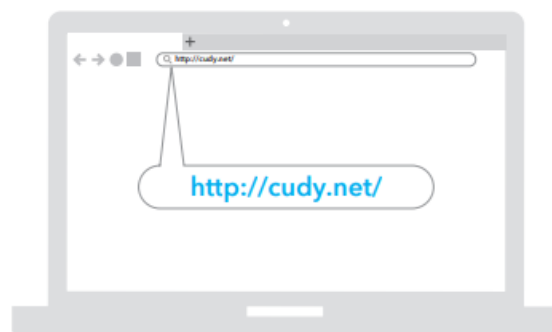
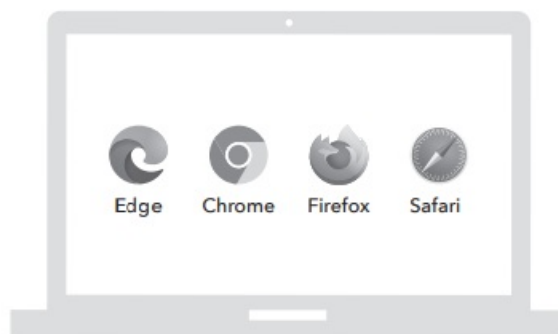

8. Then window below will pop up, please follow the step-by-step instructions to set up the internet connection.

Quick Setup

1 2 3 4 5
Mode Timezone WAN Wireless Summary

Operation Mode

- ☒ Wireless Router
- ☐ Wireless Access Point
- ☐ Wireless Extender
- ☐ WISP

Exit Next

Quick Setup

1 2 3 4 5
Mode Timezone WAN Wireless Summary

2.4G SSID

Password

5G SSID

Password

Back Save & Apply

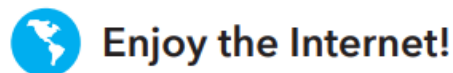

LED

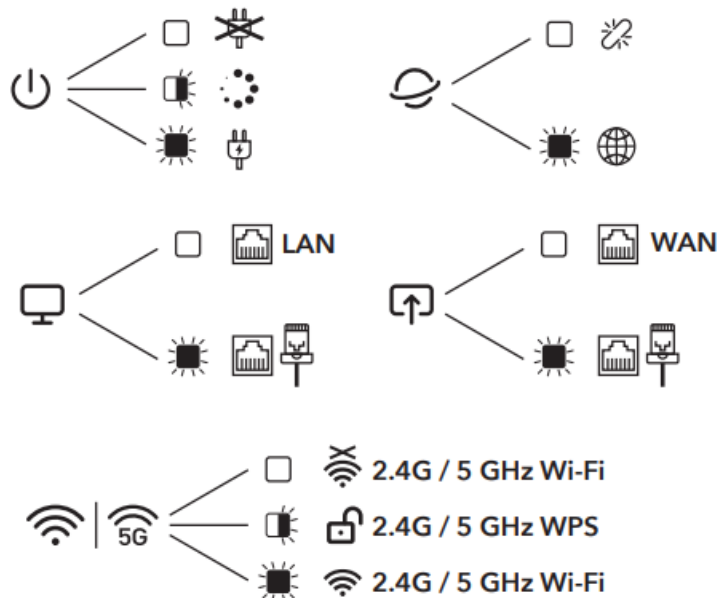

Scan the QR Code to download the Cudy App



Declaration of Conformity

Cudy hereby declares that the device is in compliance with the essential requirements and other relevant provisions of Directive 2014/53/EU, Directive 2011/65/EU, and Directive (EU) 2015/863.

The original EU declaration of conformity can be found at <http://www.cudy.com/ce>.

WEEE

According to the EU Directive on Waste Electrical and Electronic Equipment (WEEE – 2012/19 / EU), this product must not be disposed of as normal household waste. Instead, they should be returned to the place of purchase or taken to a public collection point for recyclable waste. By ensuring this product is disposed of correctly, you will help prevent potential negative consequences for the environment and human health, which could otherwise be caused by inappropriate waste handling of this product. For more information, please contact your local authority or the nearest collection point. Improper disposal of this type of waste may result in penalties according to national regulations.

GNU General Public License Notice

The software code in this product was created by third parties and is licensed under the GNU General Public License ("GPL"). If applicable, Cudy ("Cudy" in this context refers to the Cudy entity offering respective software for download or being in charge of the distribution of products that contain respective code) makes the corresponding GPL source code available upon request via the official website, either independently or with the assistance of third parties (such as Shenzhen Cudy Technology Co., Ltd.).

For GPL-related questions, email support@cudy.com. In addition, Cudy offers a GPL-Code-Center under <https://www.cudy.com/gplcodecenterdownload> where users can get the GPL source codes used in Cudy products for free. Please note, that the GPL-Code-Centre is only provided as a courtesy to Cudy's customers but may neither offer a full set of source codes used in all products nor always provide the latest or actual version of such source codes.

The GPL code used in this product is subject to the copyrights of one or more authors and is supplied WITHOUT ANY WARRANTY.

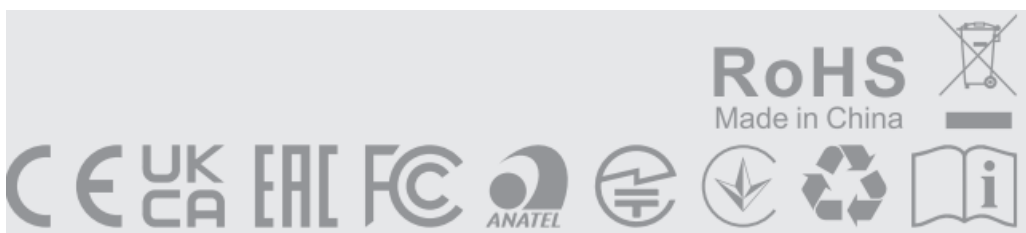

Frequently Asked Questions (FAQ):

- **Q:** Where can I find the EU Declaration of Conformity for the product?

- **A:** The original EU declaration of conformity can be found at <http://www.cudy.com/ce>.

Documents / Resources

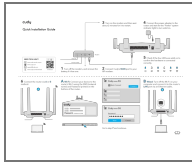

[cudy WR3000E Mesh Wi-Fi 6 Router](#) [pdf] Installation Guide
AX3000, WR3000E REV2.0, WR3000E Mesh Wi-Fi 6 Router, Mesh Wi-Fi 6 Router, 6 Router

References

- [🌐 TTrying to configure your Cudy Router](#)
- [🌐 Cudy, Your Home and Business Networking Solutions Provider](#)
- [🌐 Download Search – Cudy](#)
- [🌐 YouTube](#)
- [🌐 Download Search – Cudy](#)
- [User Manual](#)

[Manuals+](#), [Privacy Policy](#)

This website is an independent publication and is neither affiliated with nor endorsed by any of the trademark owners. The "Bluetooth®" word mark and logos are registered trademarks owned by Bluetooth SIG, Inc. The "Wi-Fi®" word mark and logos are registered trademarks owned by the Wi-Fi Alliance. Any use of these marks on this website does not imply any affiliation with or endorsement.