



## cudy RT02 Router Installation Guide

[Home](#) » [cudy](#) » cudy RT02 Router Installation Guide 

### Contents

- [1 cudy RT02 Router](#)
- [2 Product Information](#)
- [3 Product Usage Instructions](#)
- [4 OVERVIEW](#)
- [5 LED and Button](#)
- [6 WEEE](#)
- [7 FCC Caution](#)
- [8 NEED TECH HELP](#)
- [9 Documents / Resources](#)
  - [9.1 References](#)
- [10 Related Posts](#)



**cudy RT02 Router**



## Product Information

The product is a router by Cudy, which is used to create a wireless network and provide internet connectivity to devices. The router has a WAN port to connect to the internet source, LAN ports to connect wired devices, and supports wireless connectivity via 2.4GHz and 5GHz Wi-Fi networks. The router has LED indicators and buttons for WPS and resetting the device to its factory default settings. The product comes with a user manual and driver available for download on the Cudy website.

## Product Usage Instructions

1. If your internet source is an Ethernet cable coming from the wall directly instead of a DSL/Cable/Satellite modem, connect the Ethernet cable to the router's WAN port and skip steps 1, 2, 3.
2. Connect the router's WAN port to DSL/Cable/Satellite Modem.
3. Turn on the modem and wait for about 2 minutes for it to restart.
4. Connect the power adapter to the router and wait for 1 minute until the system LED changes from flashing to solid on (red or blue), indicating that the system startup is completed.
5. To connect your computer to the router, choose either wired or wireless:
  - Wired: Turn off the Wi-Fi on your computer and connect it to the router's LAN port via an Ethernet cable.
  - Wireless: Connect your device to the router's Wi-Fi using the SSID (network name) and password printed on the bottom of the router. The SSID for 2.4GHz Wi-Fi is Cudy-XXXX, and for 5GHz Wi-Fi is Cudy-XXXX-5G. The password is XXXXXXXX.
6. Launch a web browser and enter <http://cudy.net/> or <http://192.168.10.1/> in the address bar. Use admin as the password to log in.
7. Follow the step-by-step instructions in the Quick Setup window to set up the internet connection. The instructions include selecting the operation mode, timezone, WAN connection, and wireless settings.
8. After completing the setup, enjoy the internet!

If your internet source is an Ethernet cable coming from the wall directly instead of a DSL/Cable/Satellite modem, connect the Ethernet cable to the router's WAN port and skip steps 1, 2, 3.

## OVERVIEW

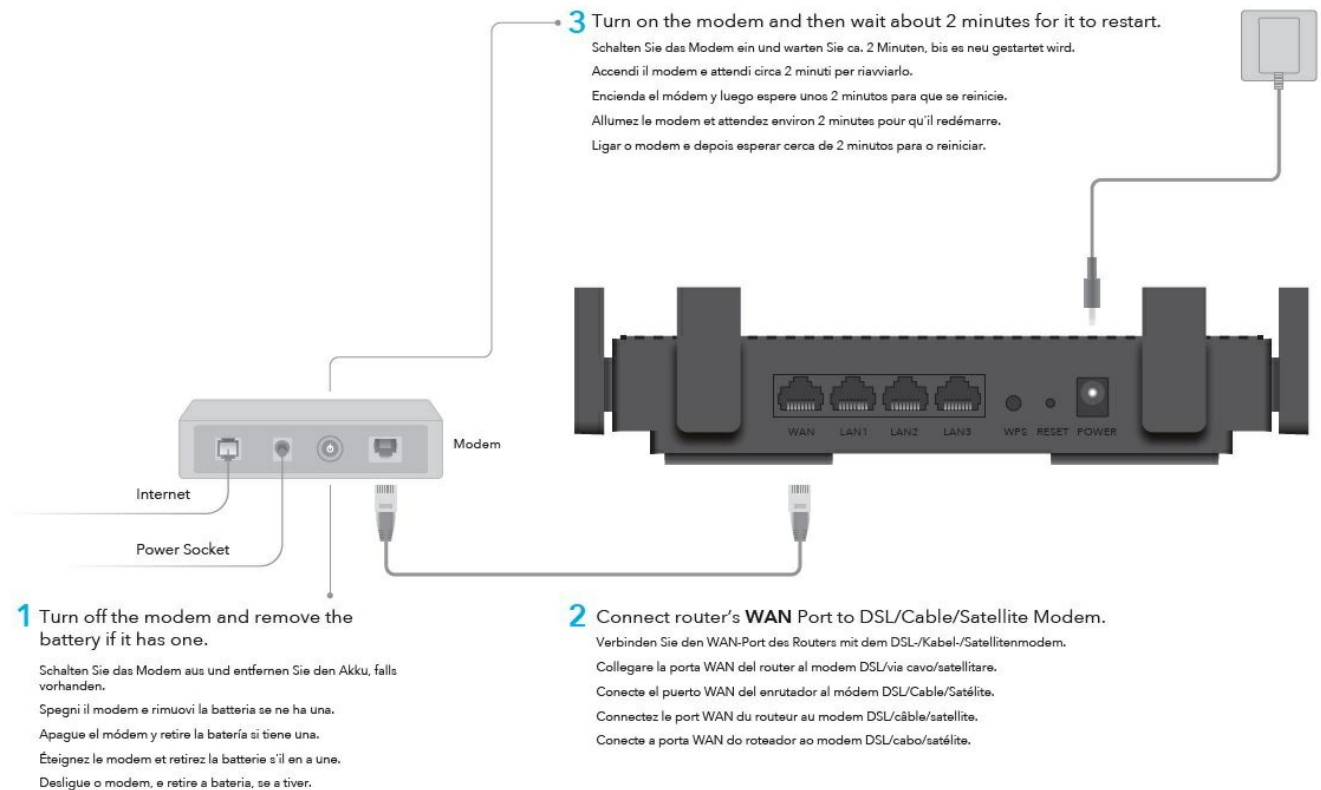

1. Connect the power adapter to the router and wait 1 minute until the system LED changes from flashing to solid on (red or blue), which means the system startup is completed.
2. Connect your computer to the router (Wired or Wireless).
  - **Wired**  
turn off the wi-fi on your computer and connect it to router S ANI port via an ethernet cable
  - **Wireless**  
Connect your device to the router's Wi-Fi using the SSID (network name) and Password printed on the bottom of the router.

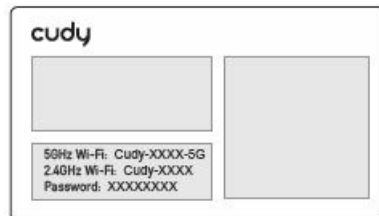

3. Launch a web browser, and enter <http://cudy.net/> or <http://192.168.10.1/> in the address bar. Use admin for password to log in.

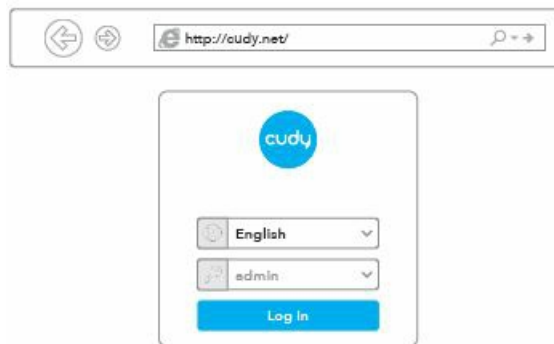

4. The window below will pop up, please follow the step-by-step instructions to set up the internet connection.



- Enjoy the internet!

## LED and Button

Name	Status	Indication
	OFF	Not powered on
	Flashing	System start-up process
	ON	System startup complete
	OFF	Not connected to the Internet
	ON	Connected to the Internet
	OFF	No connection at WAN port
	ON	WAN port has connection
	OFF	LAN port is not connected
	ON	LAN port is connected
	Off	2.4GHz Wi-Fi off
	Flashing	WPS in process
	ON	2.4GHz Wi-Fi On
	Off	5GHz Wi-Fi off
	Flashing	WPS in progress
	ON	5GHz Wi-Fi On
Button	WPS	Press and hold 1 second to enable the WPS function.
	Reset	Press and hold 2 seconds to reset the router to its factory default settings.

Cudy hereby declares that the device is in compliance with the essential requirements and other relevant provisions of Directive 2014/53/EU, directive 2011/65/EU, and Directive (EU) 2015/863. The original EU declaration of conformity can be found at <http://www.cudy.com/ce>.

## WEEE

According to the EU Directive on Waste Electrical and Electronic Equipment (WEEE – 2012/19 / EU), this product must not be disposed of as normal household waste. Instead, they should be returned to the place of purchase or taken to a public collection point for recyclable waste. By ensuring this product is disposed of correctly, you will

help prevent potential negative consequences for the environment and human health, which could otherwise be caused by inappropriate waste handling of this product. For more information, please contact your local authority or the nearest collection point. Improper disposal of this type of waste may result in penalties according to national regulations.

### GNU General Public License Notice

The software code in this product was created by third parties and is licensed under the GNU General Public License ("GPL"). If applicable, Cudy ("Cudy" in this context refers to the Cudy entity offering respective software for download or being in charge of the distribution of products that contain respective code) makes the corresponding GPL source code available upon request via the official website, either independently or with the assistance of third parties (such as Shenzhen Cudy Technology Co., Ltd.). For GPL-related questions, email [support@cudy.com](mailto:support@cudy.com). In addition, Cudy offers a GPL-Code-Centre under <https://www.cudy.com/gplco> decenter download where users can get the GPL source codes used in Cudy products for free. Please note, that the GPL-Code-Centre is only provided as a courtesy to Cudy's customers but may neither offer a full set of source codes used in all products nor always provide the latest or actual version of such source codes. The GPL code used in this product is subject to the copyrights of one or more authors and is supplied WITHOUT ANY WARRANTY.

### FCC Caution

This device complies with part 15 of the FCC Rules. Operation is subject to the following two conditions: (1) this device may not cause harmful interference, and (2) this device must accept any interference received, including interference that may cause undesired operation. Any changes or modifications not expressly approved by the party responsible for compliance could void the user's authority to operate the equipment.

**NOTE:** This equipment has been tested and found to comply with the limits for a Class B digital device, pursuant to Part 15 of the FCC Rules. These limits are designed to provide reasonable protection against harmful interference in a residential



installation. This equipment generates, uses, and can radiate radio frequency energy and, if not installed and used in accordance with the instructions, may cause harmful interference to radio communications. However, there is no guarantee that interference will not occur in a particular installation. If this equipment does cause harmful interference to radio or television reception, which can be determined by turning the equipment off and on, the user is encouraged to try to correct the interference by one or more of the following measures:

- Reorient or relocate the receiving antenna.
- Increase the separation between the equipment and the receiver.
- Connect the equipment into an outlet on a circuit different from that to which the receiver is connected.
- Consult the dealer or an experienced radio/TV technician for help.

### Radiation Exposure Statement

This equipment complies with FCC radiation exposure limits set forth for an uncontrolled environment. This equipment should be installed and operated with a minimum distance of 20cm between the radiator and your body.

### NEED TECH HELP

-  Website: [www.cudy.com](http://www.cudy.com).
-  Email: [support@cudy.com](mailto:support@cudy.com).
-  Driver & Manual: [www.cudy.com/download](http://www.cudy.com/download).
- **Support:** For technical support, the user guide, and more information, please
- visit: <https://www.cudy.com/support>.

### Documents / Resources

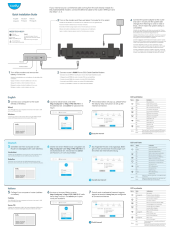

[cudy RT02 Router](#) [pdf] Installation Guide  
RT02 Router, RT02, Router

## References

- [Cudy Official Website](#)
- [cudy.com/ce](#)
- [Download Center](#)
- [cudy.com/gplcodecenterdownload](#)
- [Cudy Support Center](#)

Manuals+