

cudy
PE10G 10
Gbps PCI-E
Ethernet
Adapter



cudy PE10G 10 Gbps PCI-E Ethernet Adapter Installation Guide

[Home](#) » [cudy](#) » cudy PE10G 10 Gbps PCI-E Ethernet Adapter Installation Guide 

Contents

- [1 cudy PE10G 10 Gbps PCI-E Ethernet Adapter](#)
- [2 Product Information](#)
- [3 Product Usage Instructions](#)
- [4 Frequently Asked Questions \(FAQ\)](#)
- [5 INSTALLATION INSTRUCTION](#)
- [6 EU Declaration of Conformity](#)
- [7 Safety Information](#)
- [8 FCC compliance information statement](#)
- [9 WEB](#)
- [10 NEED TECH SUPPORT](#)
- [11 Documents / Resources](#)
 - [11.1 References](#)
- [12 Related Posts](#)

cudy

cudy PE10G 10 Gbps PCI-E Ethernet Adapter



Product Information

Specifications:

- **Compatible with:** PCI-E slot (x4 or higher version)
- **Manufacturer:** Cudy
- **Website:** www.cudy.com/pe10g
- **Contact:** support@cudy.com

Product Usage Instructions

1. Unplug the power cable and remove the case panel.
2. Insert the adapter into an available PCI-E slot (x4 or higher version) and secure it with the provided screw.
3. Assemble the case panel and power on your computer.
4. Plug the ethernet cable and connect it to your router or switch.
5. Check if the computer is connected to the network. If connected, you can enjoy the Internet directly. If not connected, download and install the driver by scanning the QR code or visiting <https://www.cudy.com/pe10g>.

Frequently Asked Questions (FAQ)

What should I do if the adapter is not detected?

Follow these steps:

1. Check the insertion of the adapter.
2. Try inserting the adapter into another PCI-E slot.
3. If the issue persists, contact support@cudy.com for assistance.

INSTALLATION INSTRUCTION

1. Unplug the power cable and remove the case panel.

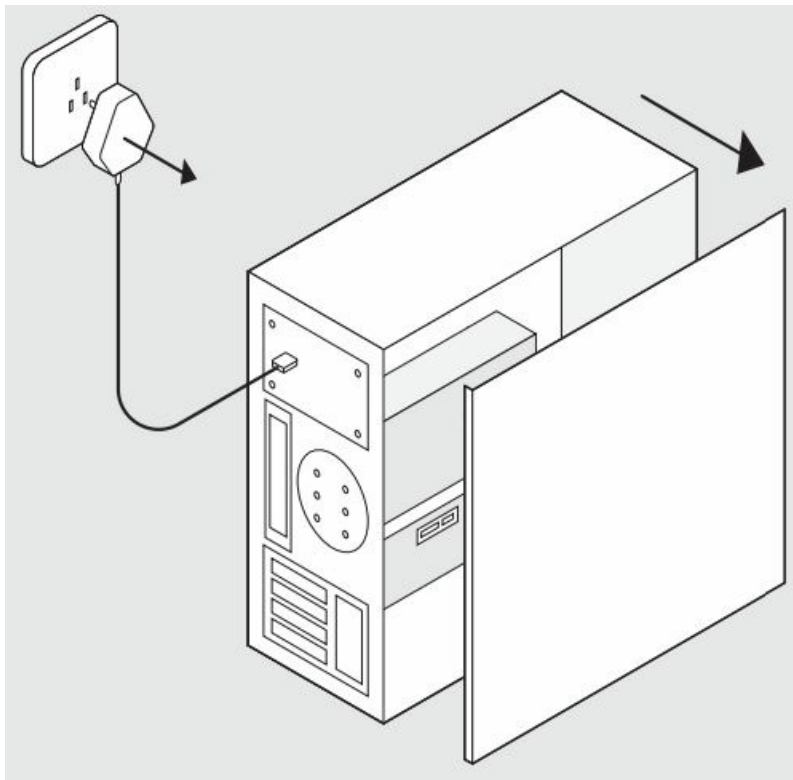

2. Insert the adapter into an available PCI-E slot (x4 or higher version) and secure it with the provided screw.

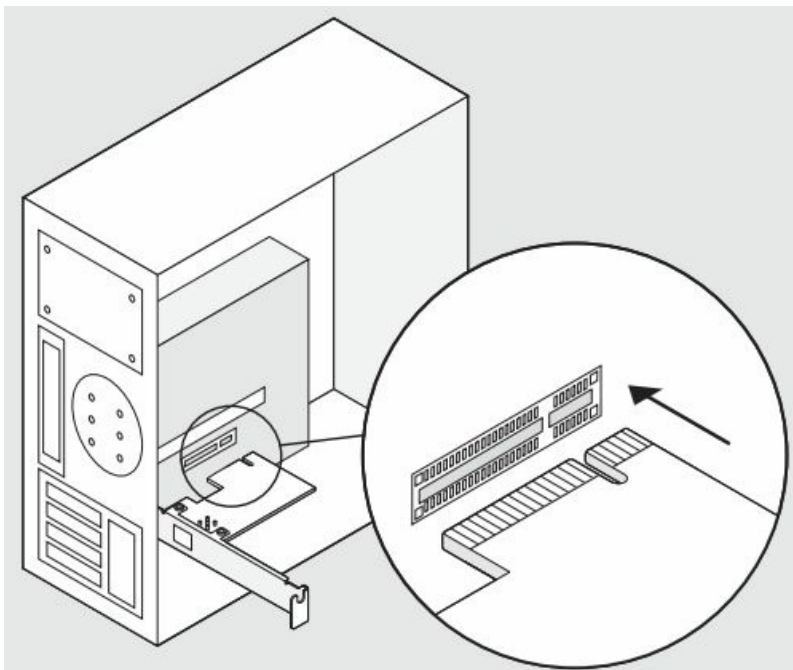

3. Assemble the case panel and power on your computer.

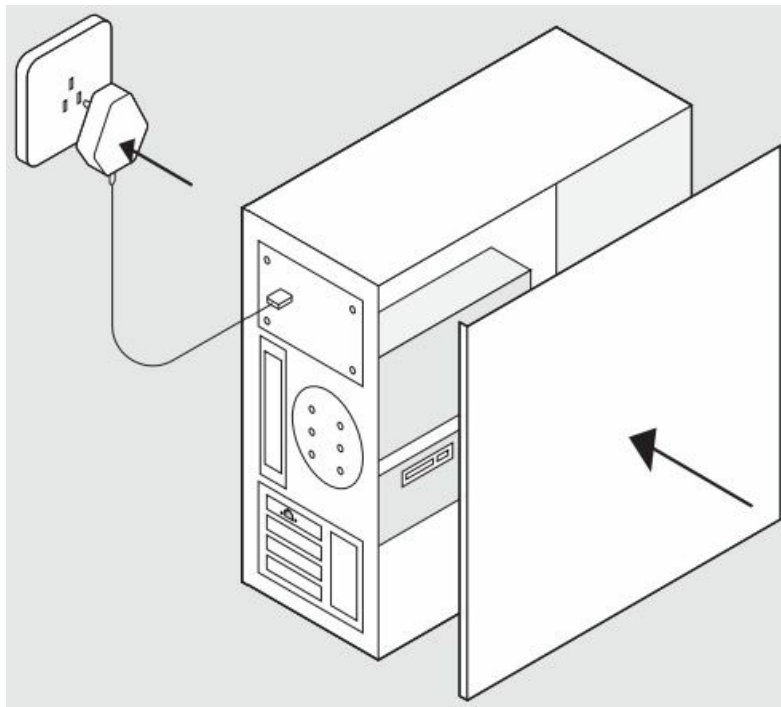

4. Plug the ethernet cable and connect to your router or switch.

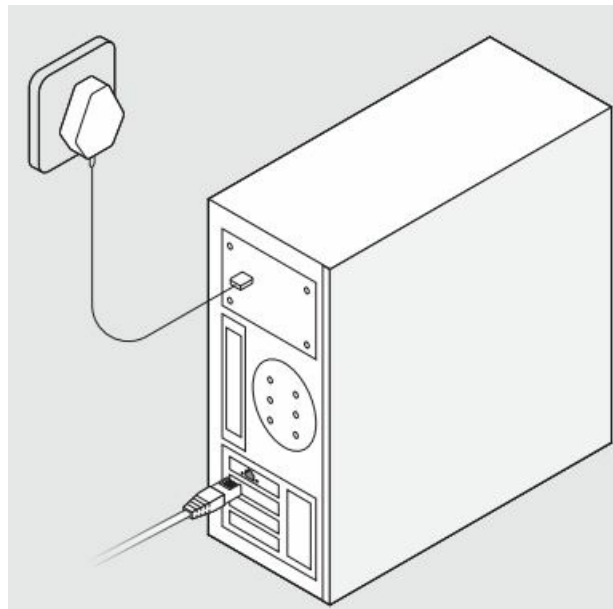

5. Check if the computer is connected to the network.

- If yes, enjoy the Internet directly;
- If not, download and install the driver by scanning the QR code or enter <https://www.cudy.com/pe10g> in your browser.

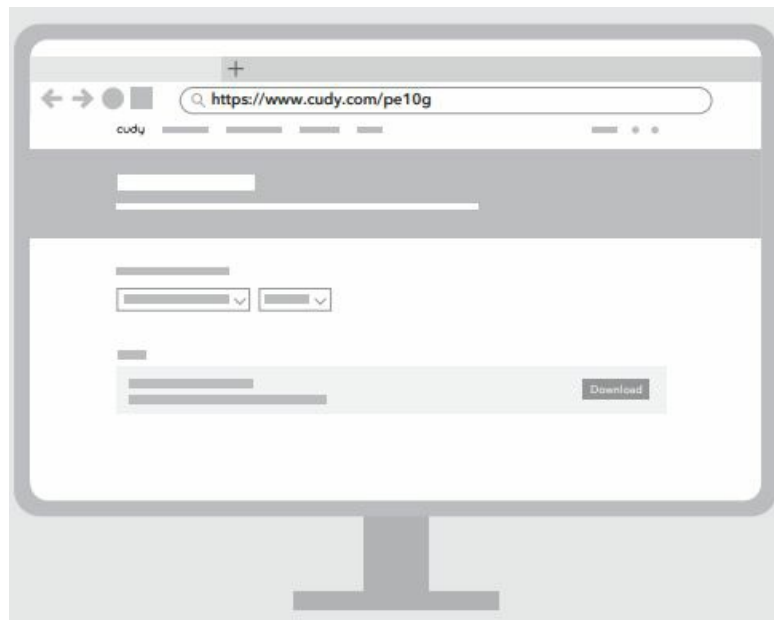
**Note:**

If the adapter is not detected:

1. Check the insertion.
2. Try another slot.
3. Contact support@cudy.com.

EU Declaration of Conformity

- Cudy hereby declares that the device complies with the essential requirements and other relevant provisions of Directive 2014/30/EU, Directive 2014/35/EU, Directive 2011/65/EU, and Directive (EU) 2015/863.
- The original EU Declaration of Conformity can be found at <http://www.cudy.com/ce>.

Safety Information

- Keep the device away from water, fire, humidity, or hot environments.
- Do not attempt to disassemble, repair, or modify the device.

Please read and follow the above safety information when operating the device. We cannot guarantee that no accidents or damage will occur due to improper use of the device. Please use this product with care and operate at your own risk.

Canadian Compliance Statement

This device complies with Industry Canada license-exempt RSS standard(s). Operation is subject to the following

two conditions:

1. This device may not cause interference.
2. This device must accept any interference, including interference that may cause undesired operation of the device.

FCC compliance information statement

This equipment has been tested and found to comply with the limits for a Class B digital device, under part 15 of the FCC Rules. These limits are designed to provide reasonable protection against harmful interference in a residential installation. This equipment generates, uses, and can radiate radio frequency energy and, if not installed and used by the instructions, may cause harmful interference to radio communications. However, there is no guarantee that interference will not occur in a particular installation. If this equipment does cause harmful interference to radio or television reception, which can be determined by turning the equipment off and on, the user is encouraged to try to correct the interference by one or more of the following measures:

- Reorient or relocate the receiving antenna.
- Increase the separation between the equipment and the receiver.
- Connect the equipment to an outlet on a circuit different from that to which the receiver is connected.
- Consult the dealer or an experienced radio/TV technician for help.

This device complies with part 15 of the FCC Rules. Operation is subject to the following two conditions:

1. This device may not cause harmful interference.
2. This device must accept any interference received, including interference that may cause undesired operation.

WEB

According to the EU Directive on Waste Electrical and Electronic Equipment (WEEE – 2012/19 / EU), this product must not be disposed of as normal household waste.

Instead, they should be returned to the place of purchase or taken to a public collection point for recyclable waste. By ensuring this product is disposed of correctly, you will help prevent potential negative consequences for the environment and human health, which could otherwise be caused by inappropriate waste handling of the product. For more information, please contact your local authority or the nearest collection point. Improper disposal of this type of waste may result in penalties according to national regulations.

NEED TECH SUPPORT

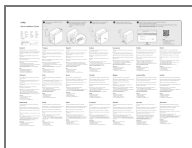

- www.cudy.com
- support@cudy.com

Documents / Resources



[cudy PE10G 10 Gbps PCI-E Ethernet Adapter](#) [pdf] Installation Guide
PE10G 10 Gbps PCI-E Ethernet Adapter, PE10G, 10 Gbps PCI-E Ethernet Adapter, PCI-E Ethernet Adapter, Ethernet Adapter, Adapter

References

-  [Anatel — Agência Nacional de Telecomunicações](#)
-  [Cudy, Your Home and Business Networking Solutions Provider](#)
-  [Download Search – Cudy](#)
- [User Manual](#)

[Manuals+](#), [Privacy Policy](#)

This website is an independent publication and is neither affiliated with nor endorsed by any of the trademark owners. The "Bluetooth®" word mark and logos are registered trademarks owned by Bluetooth SIG, Inc. The "Wi-Fi®" word mark and logos are registered trademarks owned by the Wi-Fi Alliance. Any use of these marks on this website does not imply any affiliation with or endorsement.