



cudy Mesh App User Guide

[Home](#) » [cudy](#) » cudy Mesh App User Guide 

Contents

1

cudy Mesh App

2

Product Usage Instructions

3

Documents / Resources

3.1

References

4

Related Posts



cudy Mesh App



Specifications

- Model: Cudy Mesh Network
- Wi-Fi Bands: 2.4GHz, 5GHz
- Wireless Standards: 802.11ac/b/g/n
- Ports: Ethernet port

Product Usage Instructions

Setting up a New Cudy Mesh Network

1. Power off your modem if you have one.
2. Connect a Mesh unit's power adapter and wait for the system indicator light to turn solid on.
3. Use an Ethernet cable to connect port 1 of the Mesh unit to your DSL/Cable Modem or Ethernet wall outlet.
4. Power on the modem.
5. Access the router configuration page via a browser and follow the on-screen instructions to set up your network.

Adding Units to a Cudy Mesh Router/Network

1. Place additional Mesh units near the existing setup.
2. Power on the new units and wait for the system indicator light to turn solid white.
3. Units in the same package will automatically pair; for units not in the same package, press the PAIR buttons for pairing.

Downloading the Cudy APP

Visit the app store on your device, search for “Cudy APP,” and download it to manage your Mesh network.

FAQ

- **Q: How do I change the Wi-Fi network name and password?**

- A: Access the router configuration page via a browser, navigate to the wireless settings, and update the SSID and password for both 2.4GHz and 5GHz bands.

- **Q: What should I do if I cannot access the internet after setup?**

- A: Reboot your modem and Mesh unit, connect to the Wi-Fi network, and try accessing the internet again. If issues persist, contact your ISP or support@cudy.com for assistance.

- **Q: How do I add satellite Mesh units to my network?**

- A: Place the new units near the existing setup, power them on, wait for pairing, and follow on-screen instructions. For units not in the same package, press the PAIR buttons for pairing.

Choose Your Scenario

Set up a new Cudy Mesh network.

Go to step > 1

Add units to a Cudy Mesh router/network.

Flip the page and go to step >7

Download the Cudy APP



1. Power off the modem if you have one.
2. Pick a Mesh unit from the package and connect its power adapter to it. Wait for its system indicator light to turn solid on.
3. Use an Ethernet cable to connect port 1 of the Mesh unit to your DSL/Cable Modem or the Ethernet wall outlet.
4. Power on the modem that you just turned off.

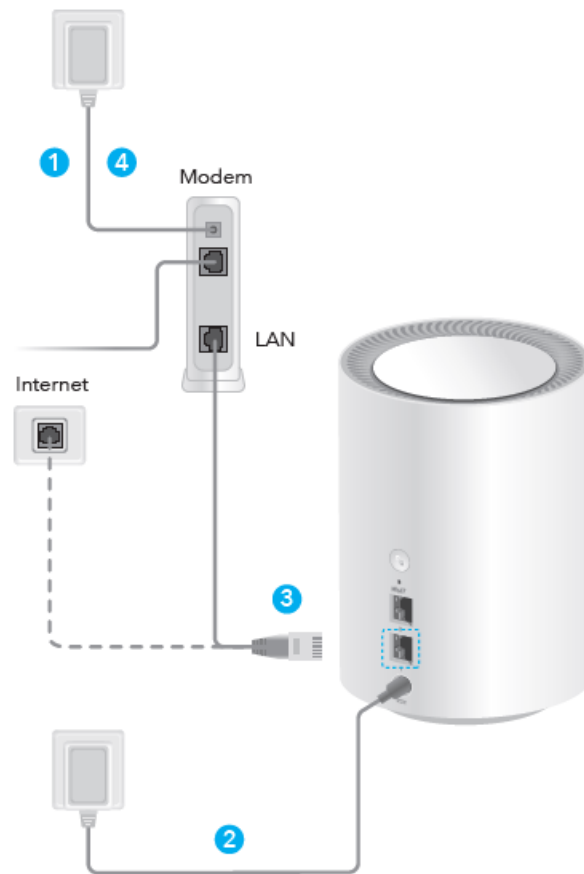

Configure the first Mesh unit

Choose one of your phones/laptops/tablets and connect it to the Mesh unit via Wi-Fi or an Ethernet cable. The default Wi-Fi name and password are printed on the bottom of the Mesh unit.



Open a browser and follow the pictures to configure the router.

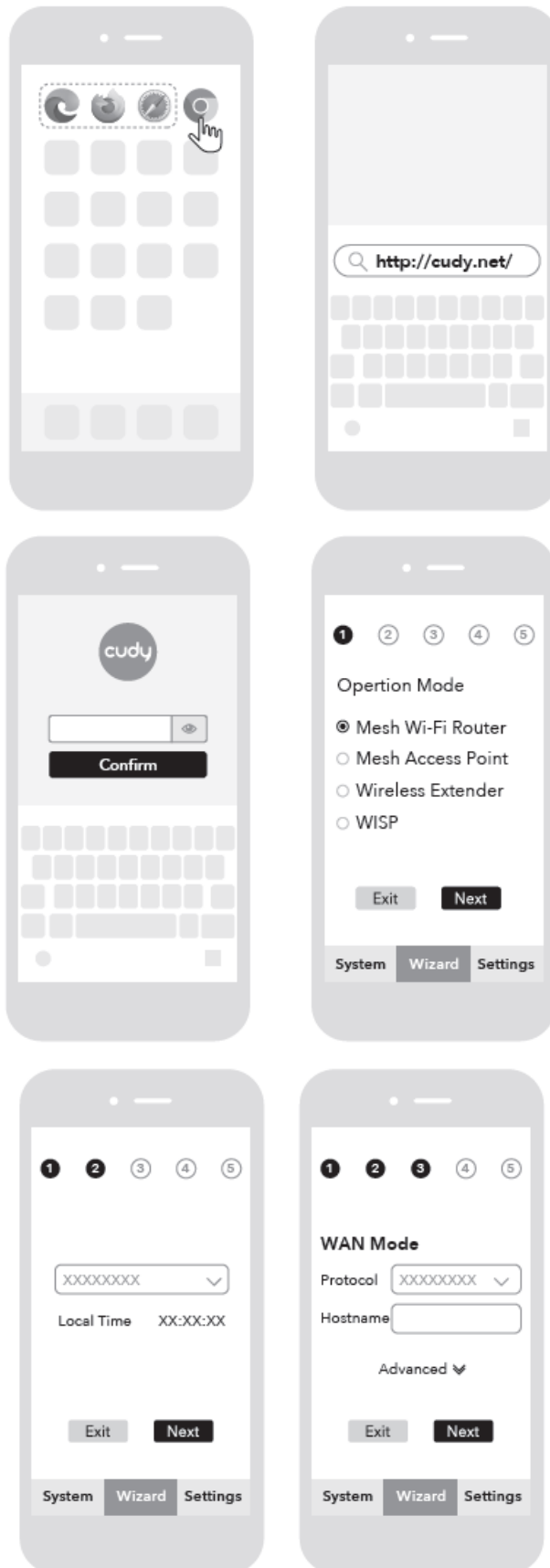

Note: When connecting via an Ethernet cable, please turn off Wi-Fi on your device.

Note: After the system indicator on the Mesh unit turns solid white, the setup of the first Mesh unit is complete.

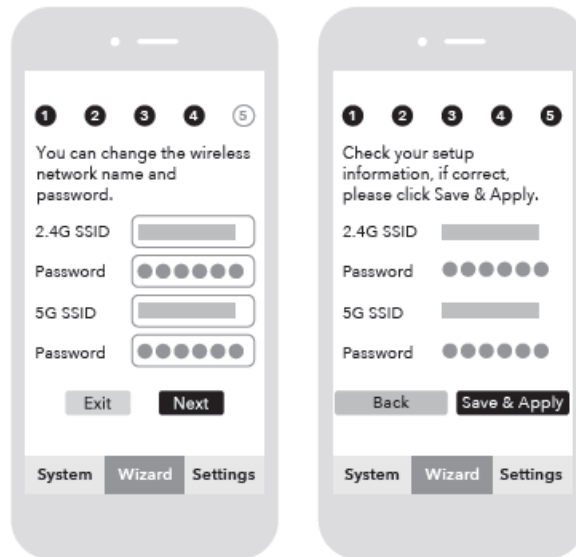

Connect the new Wi-Fi you just created and try accessing the Internet.



Note: if you cannot access the internet, please reboot your modem and Mesh unit, connect to its Wi-Fi, and try accessing the internet again.

Note: if the network is still not ready, contact your ISP or support@cudy.com for help.

Add satellite Mesh units

Place the new Mesh units near the first one. Power the new units and wait for their system indicator light to turn solid white.



Note: Units in the same package will automatically pair with the Mesh unit you just completed setup. It might take up to 5 minutes.

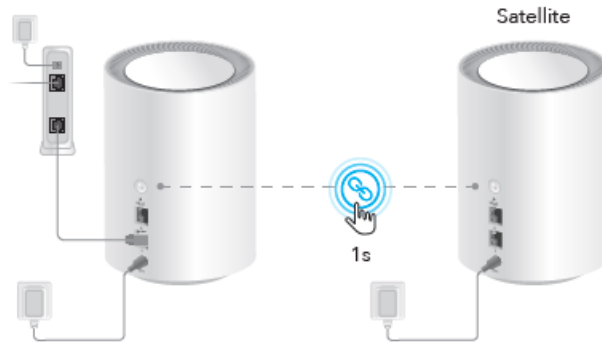

Note: For Mesh units not from the same package, please press their PAIR buttons to complete pairing. Please wait their system indicators light to turn solid white and then add another one.

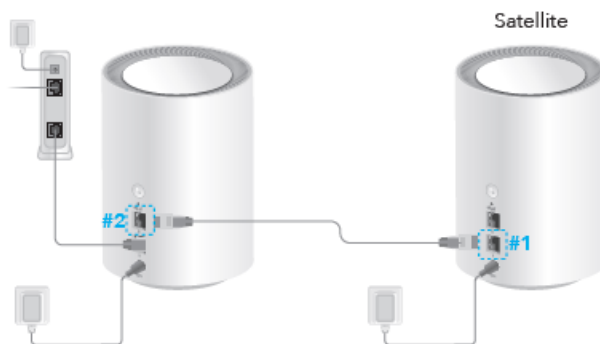















Note: You may pair units by connecting the port 2 on the main node to the port 1 of the satellite node via an Ethernet cable.

Move the newly added units to the middle between the main unit and the WiFi Deadzone.

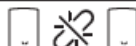

Note: Move to where your phone at least has two-bar WiFi signal and the units will reconnect to main unit automatically once they are booted up.

Enjoy the internet!

 Mesh Router	OFF	
	Flashing Red	
	Red	
	White Flash	
	White	
 Satellite Mesh	OFF	
	Flashing Red	
	Red	
	White Flash	
	White	
	Pair	
	RESET	

EU Declaration of Conformity

Cudy hereby declares that the device is in compliance with the essential requirements and other relevant provisions of directive 2014/53/EU, directive 2011/65/EU, directive (EU) 2015/863. The original EU declaration of conformity can be found at <http://www.cudy.com/ce>.

Quick Installation Guide

NEED TECH HELP?



Website: www.cudy.com



Email: support@cudy.com



Driver & Manual

www.cudy.com/download

Support

For technical support, the user guide and more information, please visit: <https://www.cudy.com/support>

810600230



Documents / Resources

	<p>cudy Mesh App [pdf] User Guide 810600230-A, Mesh App, App</p>
--	---

References

- [Cudy, Your Home and Business Networking Solutions Provider](#)
- [Download Search – Cudy](#)
- [Download Search – Cudy](#)
- [Contact Us – Cudy](#)
- [User Manual](#)

Manuals+, Privacy Policy

This website is an independent publication and is neither affiliated with nor endorsed by any of the trademark owners. The "Bluetooth®" word mark and logos are registered trademarks owned by Bluetooth SIG, Inc. The "Wi-Fi®" word mark and logos are registered trademarks owned by the Wi-Fi Alliance. Any use of these marks on this website does not imply any affiliation with or endorsement.