



## cudy M1800 Mesh Network Installation Guide

[Home](#) » [cudy](#) » cudy M1800 Mesh Network Installation Guide 

**cudy M1800 Mesh Network**



## Contents

- [1 Quick Installation Guide](#)
  - [1.1 LED Explanation](#)
  - [1.2 Button Explanation](#)
- [2 Frequently Asked Questions \(FAQ\)](#)
- [3 Documents / Resources](#)
  - [3.1 References](#)
- [4 Related Posts](#)

## Quick Installation Guide

If your internet connection is through an ethernet cable directly from the wall instead of through a

DSL/Cable/Satellite modem, connect the ethernet cable to the router's Port #1, and skip steps 1, 2 ,3.

1 Power off your modem.

2 Connect Port #1 of Cudy to your modem's LAN port.

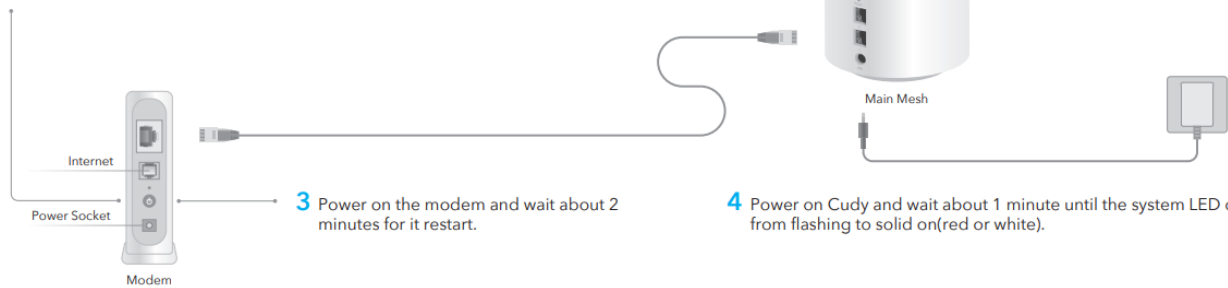

5 Connect your computer to the router (Wired or Wireless)

### Wired

Turn off the Wi-Fi on your computer and connect it to router's Port #2 via an ethernet cable.

### Wireless

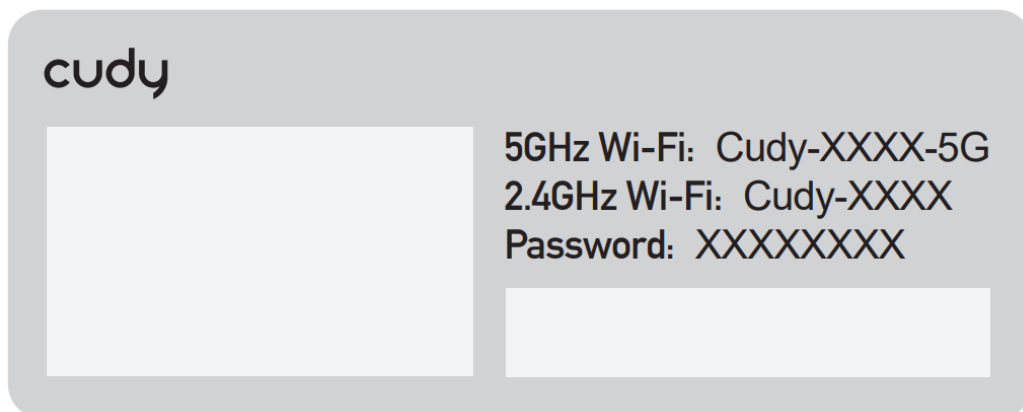

Connect your device to the router's Wi-Fi using the SSID (network name) and Password printed on the bottom of the router.





6 Launch a web browser, and enter <http://cudy.net/> in the address bar. Use admin for password to log in.



 http://cudy.net/





 English

 admin

Log In

**Note:** If the login window does not appear, please refer to FAQ > Q1.

7 Then below popup will appear, please follow step by step instructions to set up the internet connections.

**Quick Setup(1/5)**

1

2

3

4

5

Mode

Timezone

WAN

Wireless

Summary

Operation Mode

☒ Mesh Wi-Fi Router

☐ Mesh Access Point

Exit

Next

## 8 Add more mesh units

Power on the add-on mesh unit, waiting for its system LED becomes solid on.

9 Within 2 minutes, press the pair button of both the add-on mesh unit and the main mesh(the one you already configured).

Waiting for the system LED of the add-on unit becomes solid white, means successfully.



Main Mesh



Press 1 second



Add on Mesh

**Note:** For other LED status, please check the LED status explanation. Or you can contact our support team [support@cudy.com](mailto:support@cudy.com)

#### LED Explanation

LED Status		Main Mesh	Add on Mesh
Red	Flash	Starting up	Starting up
	Solid	System ready, no internet	System ready, not connected to main mesh
White	Flash	Pairing	Connected to main mesh, signal not good
	Solid	Connected to internet	Connected to main mesh, signal good
Red White Red		N/A	Pairing

#### Button Explanation

Button		Press and hold 1 second to start pairing.
	Reset	Press and hold 6 seconds to reset the router to its factory default settings.

	Email: <a href="mailto:support@cudy.com">support@cudy.com</a>
	Driver & Manual: <a href="http://www.cudy.com/download">www.cudy.com/download</a>

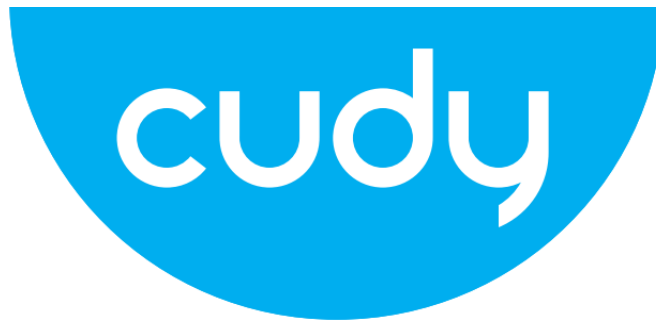

## Frequently Asked Questions (FAQ)

### Q1: What can I do if the login window does not appear?

**A1:** If the computer is set to a static IP address, change its settings to obtain an IP address and DNS server address automatically.

**A2:** Verify that <http://cudy.net/> or 192.168.10.1 is correctly entered in the web browser .

**A3:** Use another web browser and try again.

**A4:** Reboot your router and try again.

**A5:** Disable and then enable the network adapter being used.

### Q2: What should I do if i can not find Wi-Fi signal?

**A:** Please make sure the router is connected, power and broadband interface has no loose. If everything is normal but still no signal, please try to use computer to set, or restore the router to factory settings. If after restoring factory settings but still no signal, you can restart the router, if it still doesn't work, maybe the router has fault.

## Documents / Resources

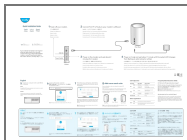

[cudy M1800 Mesh Network](#) [pdf] Installation Guide

M1800 Mesh Network, M1800, Mesh Network, Mesh, Network, M1800 Network

## References

- [C Download Center](#)