

CUBE V1.2402 Longtail Hybrid



CUBE V1.2402 Longtail Hybrid Instruction Manual

[Home](#) » [CUBE](#) » CUBE V1.2402 Longtail Hybrid Instruction Manual 

Contents

- [1 CUBE V1.2402 Longtail Hybrid](#)
- [2 GENERAL](#)
- [3 SAFETY INSTRUCTIONS FOR ACCESSORIES](#)
- [4 CLEANING AND CARE](#)
- [5 Designation](#)
- [6 Documents / Resources](#)
 - [6.1 References](#)



CUBE V1.2402 Longtail Hybrid



GENERAL

READ AND KEEP THE MANUAL

This and other accompanying instructions contain important information on the assembly, initial operation, and maintenance of the product.

Read all enclosed instructions carefully before assembling or using the product, especially the general safety instructions. Non-observance of this manual may result in serious injury or damage to the product itself and your vehicle. Keep the enclosed instructions close to hand for further use. If you pass on the product or the vehicle equipped with the product to a third party, always include all accompanying instructions.

The enclosed instructions are subject to European legislation. If the product or vehicle is delivered outside Europe, the manufacturer/importer may have to provide additional instructions.

EXPLANATION OF SYMBOLS

The following symbols and signal words are used in the enclosed instructions, on the product or on the packaging.

WARNING!

A medium risk of hazard which may result in death or serious injury if not avoided.

CAUTION!

A low risk of hazard which may result in moderate or minor injury if not avoided.

NOTICE!

Warning of possible damage to property.



Useful additional information for assembly or operation.



Read and observe the enclosed instructions.



Reference to further documentation – See instructions (Doc. – Number)



NM Use a torque wrench. Use the torque values indicated in the symbol.



Observe indication sound.

SAFETY INSTRUCTIONS FOR ACCESSORIES

WARNING!

Intended use

Use the product only as described in these instructions. Any other use is considered improper and may cause accidents, serious injuries or damage to the product or e-bike.

The product is an accessory for mounting on compatible e-bikes from the CUBE Longtail Hybrid model series. It serves as a foot support for transported children/passengers. The product is not designed as a standing surface, i.e. children must not stand with their full weight on one or both footboards.

- The children transportation accessories for the CUBE Longtail Hybrid include the following individual parts: Top rail (item no. 94760), seat set (item no. 94762), footboards(item no. 94761) and side guard (item no. 94763).

- Never use the product without the supplied additional accessories. When transporting children/passengers with the CUBE Longtail Hybrid, all accessories for transporting children must always be installed correctly and professionally.
- Please observe all information relating to intended use. Do not assemble or use the product in a way other than described here or in a way that is not intended.
- The manufacturer or dealer shall not assume any liability for damage caused by improper or incorrect use.
- Do not use the product with other (incompatible) e-bikes/bikes.
- If necessary, contact your specialist dealer for information on whether the product is compatible with your e-bike.

Safety instructions for assembly

We at CUBE strongly recommend that you have this product assembled by your dealer.

Improper assembly or an incorrect assembly sequence can result in serious falls. If the product is not fitted to the e-bike correctly, there is a risk of accident and injury for you and/or the children/passengers being transported.

- If the scope of delivery for the product is not complete or if you notice any damage, sharp edges or burrs on the product, components or vehicle, do not use it.
- Make sure that your e-bike is suitable for fitting the product.
- Do not make any structural modifications to the product.
- Screw connections must be tightened correctly with a torque wrench and with correct torque values. If you are not experienced in using a torque wrench or do not have a suitable torque wrench, have loose screw connections checked by your dealer.

Safety Instructions for Operation

Please note that the additional weight of accessories can change the riding characteristics of your e-bike, especially the steering and braking behaviour.

- Adapt your riding style to the change in handling characteristics.
- Note the information on the maximum load capacity of the product.
- Note the information on the maximum permissible total weight of the e-bike.
- Never attach a trailer or saddlebags, etc. to the product.
- Make sure that children do not stand with their full weight on one or both footboards.

Safety instructions for maintenance

Prevent malfunctions due to excessive wear, material fatigue or loose screw connections:

- Check the product and your vehicle regularly.
- Do not use the product and your vehicle if you notice excessive wear or loose screw connections.
- Do not use the vehicle if you notice cracks, deformation or color changes.
- Have the vehicle inspected immediately by your dealer if you notice excessive wear, loose screw connections, deformation, cracks or color changes.

CLEANING AND CARE

NOTICE!

Risk of damage!

Improper handling of cleaning agents can cause damage to the product.

- Do not use aggressive cleaning agents, brushes with metal or nylon bristles or sharp or metallic cleaning objects such as knives, hard spatulas and the like. These can damage the surfaces and the product.

Clean the product regularly with water (add a mild detergent if necessary) and a soft cloth.

STORAGE

All parts must be completely dry before storage.

- Always store the product in a dry place.
- Protect the product from direct sunlight.

DISPOSAL

Dispose of the packaging according to its type. Add cardboard and cartons to your waste paper collection, and films and plastic parts to your recyclables collection.

Dispose of the product in accordance with the laws and regulations valid in your country.

LIABILITY FOR MATERIAL DEFECTS

If there are any defects, please contact the dealer from whom you purchased the product.

In order to ensure that your complaint is processed smoothly, it is necessary for you to present proof of purchase and proof of inspection.

Please keep them in a safe place.

To ensure a long service life and durability of your product or your vehicle, you may only use it in accordance with its intended purpose. It is essential that you observe the information in the operating instructions of your vehicle. Furthermore, the installation instructions (especially torques for screws) and the prescribed maintenance intervals must be observed.

OTHER INFORMATION

Please visit us occasionally on our website at www.CUBE.eu. There you will find news, information and the latest versions of our manuals as well as the addresses of our specialist dealers.

Designation

| No. | Designation | Num- ber |
|-----|------------------|----------|
| 1 | Right board | 1× |
| 2 | Left board | 1× |
| 3 | Right bar | 1× |
| 4 | Left bar | 1× |
| 5 | Screw M6×30 | 6× |
| 6 | Self-locking nut | 6× |
| 7 | Screw M5×16 | 4× |
| 8 | Screw M6×40 | 2× |

A: Mount the right board 1 to the right bar 3 using three bolts 5 and nuts 6.

IMPORTANT: The rough side of the board is the top side.
Then mount the left board 2 to the left bar 4 using three bolts 5 and nuts 6.

Torque: 3 Nm

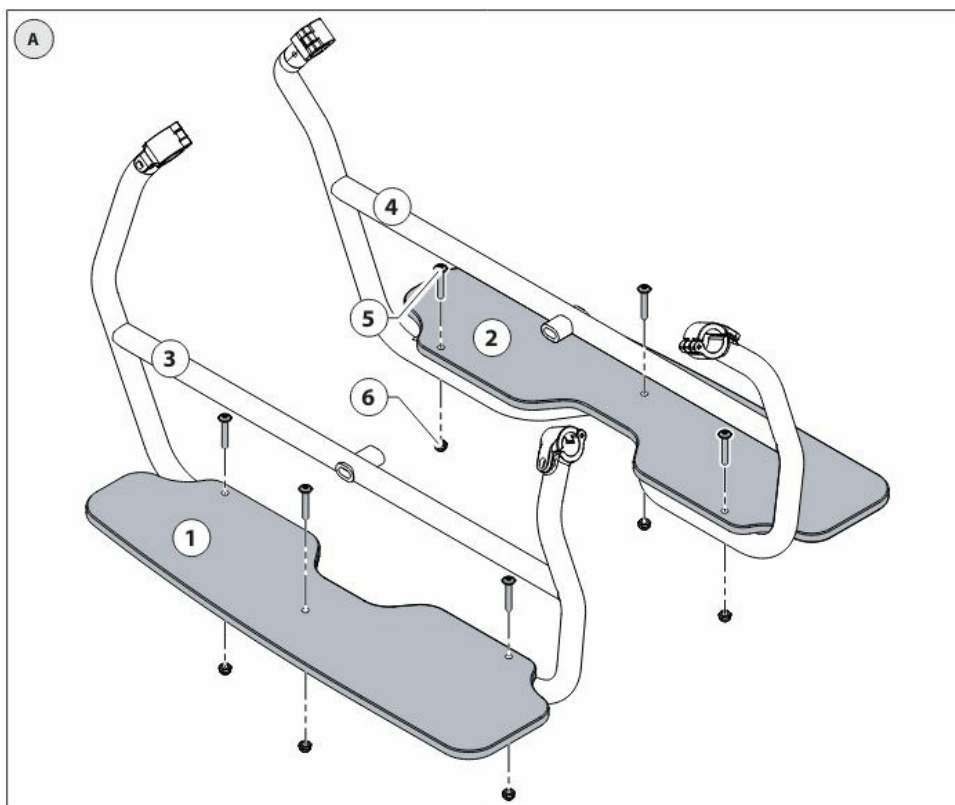

B: Attach assembled products to B the right and left of the luggage rack.

Secure the products at the top first of all.

In order to secure the product, open the bracket, place it around the corresponding bar on the luggage rack, close and fix in place using the screw 7.



Torque: 8 Nm

Then secure each of the products on both sides of the luggage rack at the bottom with one screw 8.

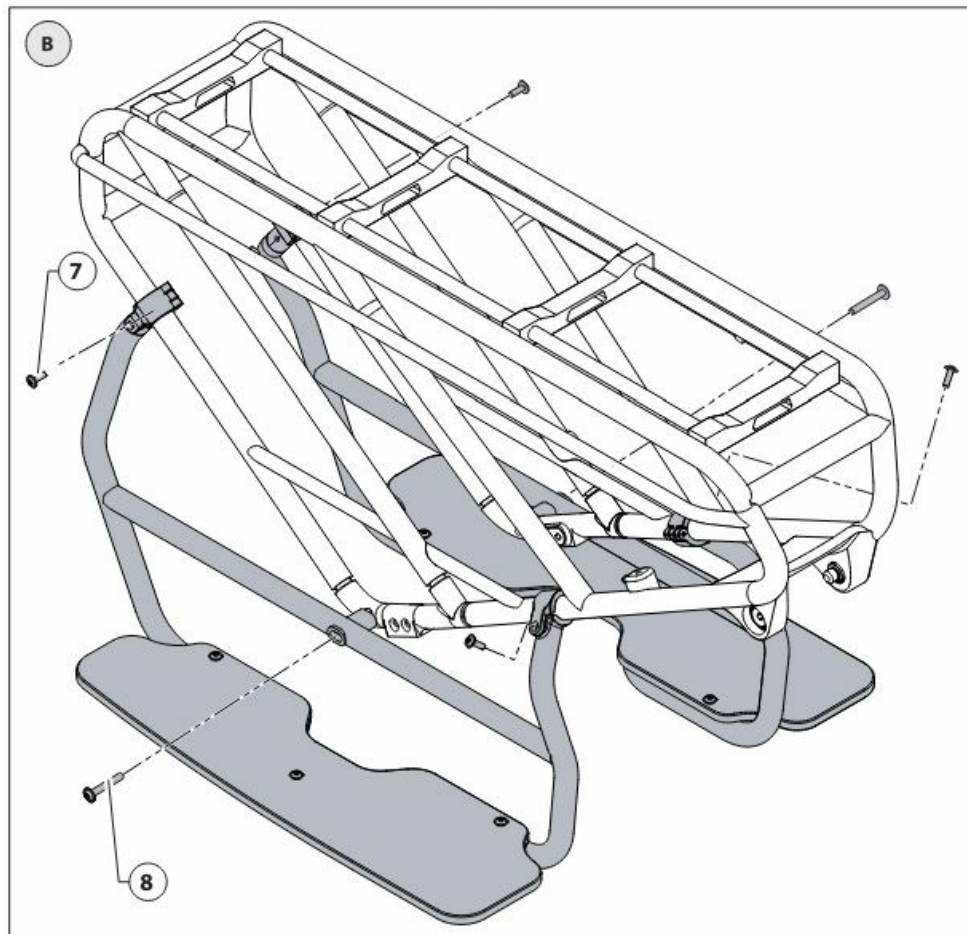
Torque: 6 Nm



Documents / Resources

| | |
|---|---|
|  | <p>CUBE V1.2402 Longtail Hybrid [pdf] Instruction Manual V1.2402, 94760, 94762, 94761, 94763, V1.2402 Longtail Hybrid, V1.2402, Longtail Hybrid, Hybrid</p> |
|  | <p>CUBE V1.2402 Longtail Hybrid [pdf] Instruction Manual V1.2402 Longtail Hybrid, V1.2402, Longtail Hybrid, Hybrid</p> |
|  | <p>CUBE V1.2402 Longtail Hybrid [pdf] User Manual V1.2402 Longtail Hybrid, V1.2402, Longtail Hybrid, Hybrid</p> |

References

- [User Manual](#)

[Manuals+](#), [Privacy Policy](#)

This website is an independent publication and is neither affiliated with nor endorsed by any of the trademark owners. The "Bluetooth®" word mark and logos are registered trademarks owned by Bluetooth SIG, Inc. The "Wi-Fi®" word mark and logos are registered trademarks owned by the Wi-Fi Alliance. Any use of these marks on this website does not imply any affiliation with or endorsement.