



# CUBE Hydration Bladder Instruction Manual

[Home](#) » [CUBE](#) » CUBE Hydration Bladder Instruction Manual 

## Contents

- [1 CUBE Hydration Bladder](#)
- [2 Product Information](#)
- [3 Product Usage Instructions](#)
- [4 GENERAL](#)
- [5 SAFETY INSTRUCTIONS FOR ACCESSORIES](#)
- [6 OVERVIEW](#)
- [7 MANUAL for hydration bladder](#)
- [8 INSTRUCTION](#)
- [9 CLEANING AND CARE](#)
- [10 OTHER INFORMATION](#)
- [11 Documents / Resources](#)
- [12 Related Posts](#)

***CUBE***

**CUBE Hydration Bladder**



## Product Information

The product manual contains important information on the assembly, initial operation, and maintenance of the product. It is important to read all enclosed instructions carefully before assembling or using the product, especially the general safety instructions. The manual also contains useful additional information for assembly or operation. The product comes with symbols and signal words that indicate warnings, cautions, and notices for possible hazards or damage to property.

## Manufacturer Information

The product is manufactured by Pending System GmbH & Co. KG, located in D-95679 Waldershof. For any inquiries or concerns, you can contact them at +49 (0)9231 97 007 80 or visit their website at [www.cube.eu](http://www.cube.eu).

## Product Usage Instructions

### Assembly

Before assembly, it is recommended to have the product assembled by your dealer. To assemble, read the enclosed instructions carefully and use a torque wrench. Use the torque values indicated in the symbol. Drill a hole at the marked position using the drill diameter indicated in the symbol. Observe indication sound and trim with a suitable tool.

### Operation

When using the product, it is important to note that accessories can have a significant influence on the characteristics of the vehicle. Always read the safety instructions for operation and observe them to prevent accidents, serious injury, and damage.

### Maintenance

To prevent malfunctions due to excessive wear, material fatigue, or loose screw connections, always read and observe the safety instructions for maintenance. It is also important to keep the product clean and well-maintained.

## **Disposal**

After use, dispose of the packaging properly. Sort cardboard and paper for recycling and dispose of films and plastic parts in the appropriate waste collection.

## **Additional Information**

For any complaints, it is necessary to present the purchase receipt and inspection records. If passing on the product or the vehicle equipped with the product to a third party, always include all accompanying instructions.

## **GENERAL**

### **READ AND KEEP THE MANUAL**

- This and other accompanying instructions contain important information on the assembly, initial operation, and maintenance of the product.
- Read all enclosed instructions carefully before assembling or using the product, especially the general safety instructions. Non-observance of this manual may result in serious injury or damage to the product itself and your vehicle. Keep the enclosed instructions close to hand for further use. If you pass on the product or the vehicle equipped with the product to a third party, always include all accompanying instructions.
- We at CUBE strongly recommend that you have this product assembled by your dealer.
- The enclosed instructions are subject to European legislation. If the product or vehicle is delivered outside Europe, the manufacturer/importer may have to provide additional instructions.

## **EXPLANATION OF SYMBOLS**

The following symbols and signal words are used in the enclosed instructions, on the product, or on the packaging

### **WARNING!**

A medium risk of hazard that may result in death or serious injury if not avoided.

### **CAUTION!**

A low risk of hazard may result in moderate or minor injury if not avoided.

### **NOTICE!**

Warning of possible damage to property.



- Useful additional information for assembly or operation.



- Read and observe the enclosed instructions.



- Reference to further documentation – See instructions (Doc. – Number) NM Use a torque wrench.



- Use the torque values indicated in the symbol. mm



- Drill a hole at the marked position.



- Use the drill diameter indicated in the symbol.



- Observe the indication sound.



- Trim with a suitable tool

## **SAFETY INSTRUCTIONS FOR ACCESSORIES**

### **Risk of accident and injury!**

Read all safety notes and instructions. Failure to observe the safety instructions and instructions can cause accidents, serious injury and damage.

### **Safety of children**

If children play with the packaging or small parts, they may swallow them and suffocate or injure themselves.

- Keep small parts away from children.
- Do not let children play with the packaging or product.
- Do not leave the product or vehicle unattended during assembly.

### **Safety instructions for assembly**

- Before assembly, check the scope of delivery of the product for completeness.
- Before assembly, check all components of the product and the vehicle for damage, sharp edges or burrs.
- If the scope of delivery for the product is not complete or if you notice any damage, sharp edges or burrs on the product, components or vehicle, do not use it.
- Have the product and the vehicle checked by your dealer.
- Use only parts and accessories intended for the product. Components from other manufacturers may affect optimal function.
- If you intend to combine this product with vehicles of other manufacturers, be sure to check their specifications and check dimensional accuracy and compatibility according to the instructions in the enclosed manuals and the owner's manual of your vehicle.
- Screw connections must be tightened correctly with a torque wrench and with correct torque values.
- If you are not experienced in using a torque wrench or do not have a suitable torque wrench, have loose screw connections checked by your dealer.
- Note special torques for components made of aluminum or carbon fiber-reinforced polymer. Please also read and follow the operating instructions of your vehicle.

### **Safety Instructions for Operation**

Please note that accessories can have a significant influence on the characteristics of the vehicle.

- If you are not absolutely sure or if you have questions, please contact your dealer.
- The enclosed instructions cannot cover every possible combination of the product with all vehicle models.

### Safety instructions for maintenance

Prevent malfunctions due to excessive wear, material fatigue or loose screw connections:

- Check the product and your vehicle regularly.
- Do not use the product and your vehicle if you notice excessive wear or loose screw connections.
- Do not use the vehicle if you notice cracks, deformation or color changes.
- Have the vehicle inspected immediately by your dealer if you notice excessive wear, loose screw connections, deformation, cracks or color changes.

### OVERVIEW

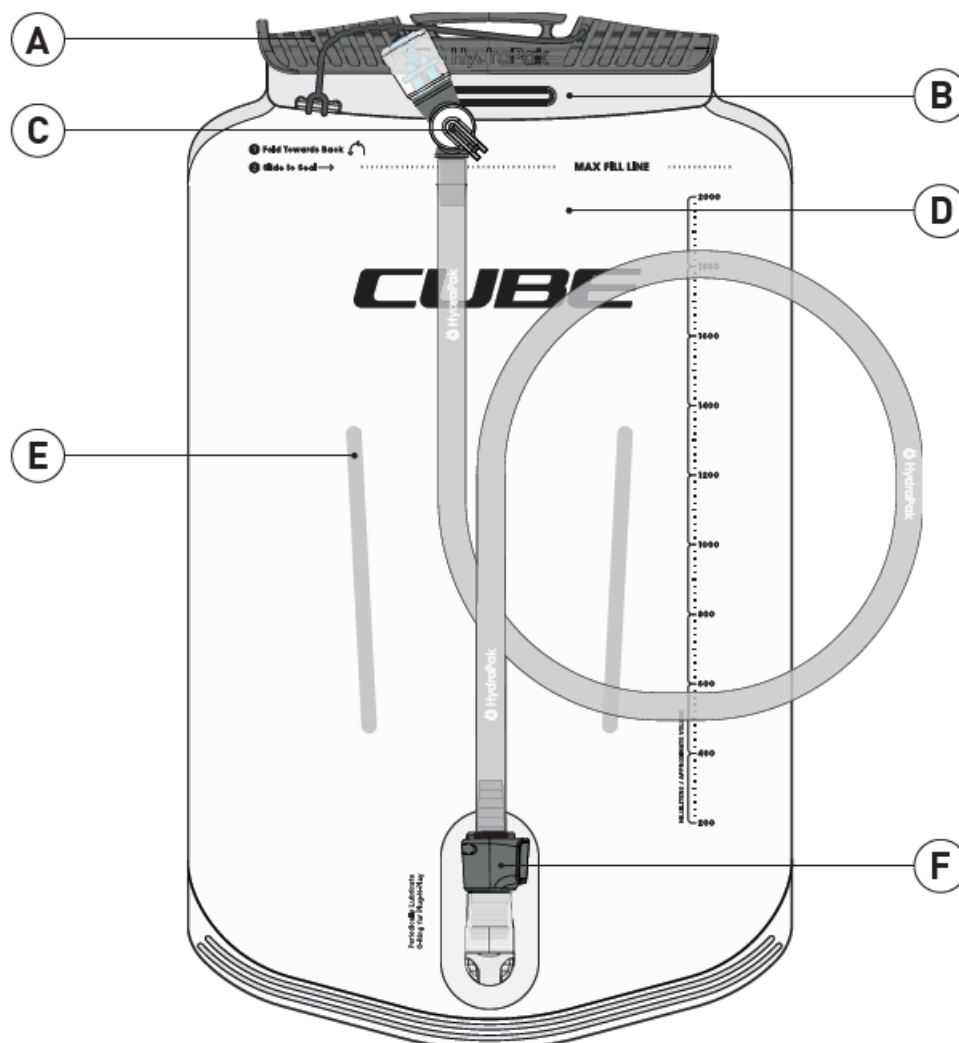

- **SLIDE-SEAL™**  
Opens wide and seals tight
- **FLEXGRIP**  
Dual FlexGrips make it simple to fill, carry and access in your pack
- **COMET™ VENTIL**  
One hand locking valve – Self seals after each sip and features an on/off bar to prevent leaks
- **REVERSIBLE**

Turns inside out for easy cleaning and drying

- **SHAPE-SHIFT™ Baffle**

Locks for slim profile & increased stabilization, unlocks for full volume

- **PLUG-N-PLAY™**

Easily disconnect tube & remove reservoir from pack for convenient refilling.

## MANUAL for hydration bladder

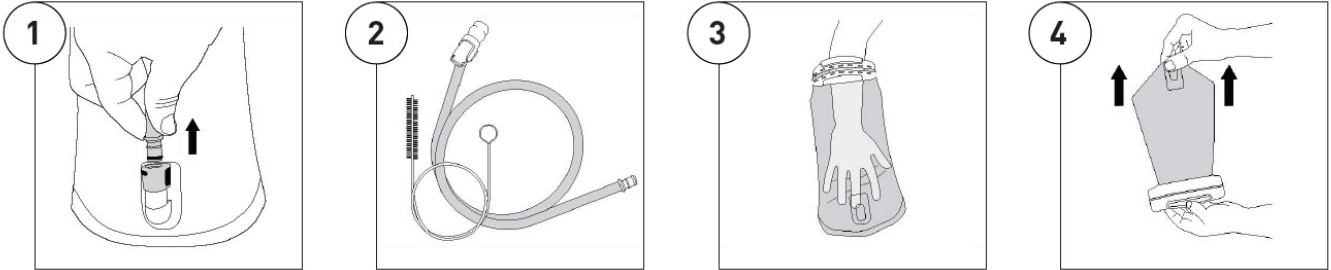

1. If equipped with a PLUG-N-PLAY™, disconnect the hose from the reservoir.
2. Flush hot, soapy water through the tube followed by a cold water rinse.
3. To clean, unlock the baffle first and then place your hand in the reservoir.
4. Pull back through the opening – turning inside out. Clean by hand with warm water and mild dish soap or use top rack of the dishwasher.

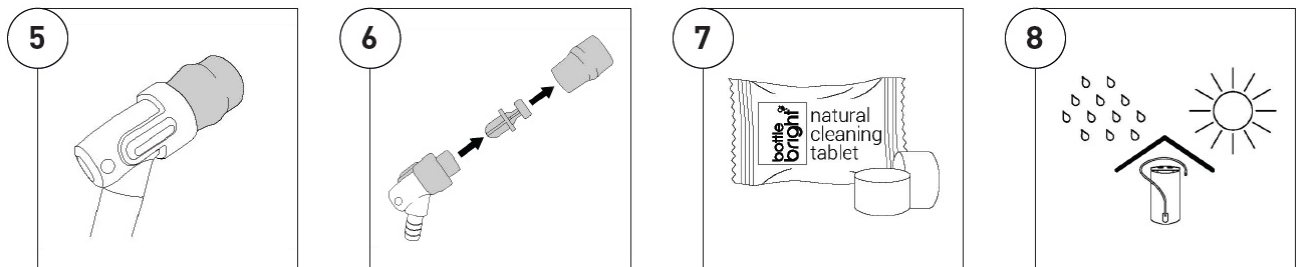

5. Clean the surface of the sheath with warm water and mild dish soap
6. For periodic deep cleaning of the valve, pull the sheath from valve body then push the center post out through the end of the sheath. Hand wash with warm water and mild dish soap or place into a dishwasher.
7. Use Bottle Bright® cleaning tablets as an alternative cleaning solution for your reservoir, bite valve, tube, and other components.
8. When not in use, store your reservoir out of direct sunlight in a clean and dry area.

## INSTRUCTION

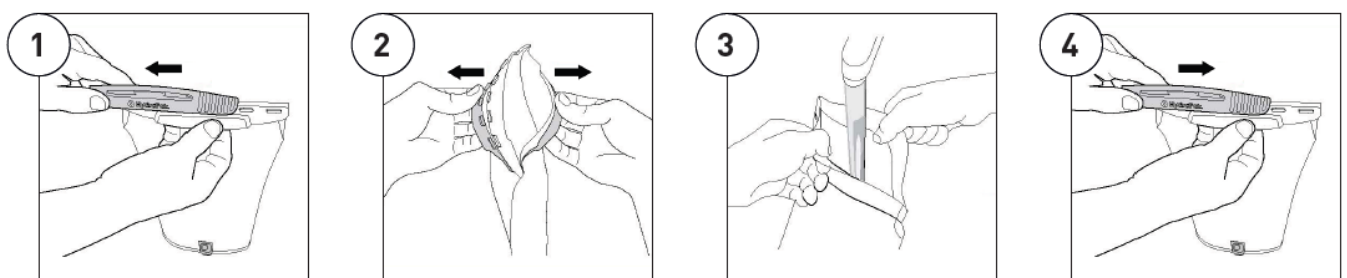

1. Grasp the slider top firmly and pull to the side.
2. With a firm grasp of both the front and back handles, pull the two handles apart from each other.
3. Fill the reservoir with water. Do not fill past the max-fill indicator on the reservoir.
4. Once filling, push the slide seal across the top to seal the reservoir.



5. Push the drinking tube into the connector to allow flow.

## **CLEANING AND CARE**

### **Risk of damage!**

- Improper handling of cleaning agents can cause damage to the product.
- Do not use aggressive cleaning agents, brushes with metal or nylon bristles or sharp or metallic cleaning objects such as knives, hard spatulas and the like.
- These can damage the surfaces and the product.
- Clean the product regularly with water (add a mild detergent if necessary) and a soft cloth.

### **STORAGE**

All parts must be completely dry before storage.

- Always store the product in a dry place.
- Protect the product from direct sunlight.

### **DISPOSAL**

Dispose of the packaging according to its type. Add cardboard and cartons to your waste paper collection, and films and plastic parts to your recyclables collection.

Dispose of the product in accordance with the laws and regulations valid in your country.

### **LIABILITY FOR MATERIAL DEFECTS**

- If there are any defects, please contact the dealer from whom you purchased the product.
- In order to ensure that your complaint is processed smoothly, it is necessary for you to present proof of purchase and proof of inspection.
- Please keep them in a safe place.
- To ensure a long service life and durability of your product or your vehicle, you may only use it in accordance with its intended purpose. It is essential that you observe the information in the operating instructions your vehicle.
- Furthermore, the installation instructions (especially torque for screws) and the prescribed maintenance intervals must be observed.

## **OTHER INFORMATION**

Please visit us occasionally on our website at [www.CUBE.eu](http://www.CUBE.eu). There you will find news, information and the latest versions of our manuals as well as the addresses of our specialist dealers.  
Pending System GmbH & Co. KG Ludwig-Hüttner-Str. 5-7 D-95679 Waldershof  
+49 (0)9231 97 007 80  
[www.cube.eu](http://www.cube.eu)

## Documents / Resources

	<a href="#">CUBE Hydration Bladder</a> [pdf] Instruction Manual Backpacks Hydration Bladder, Hydration Bladder, Bladder
---	--

Manuals+.