



CUBE Fold Hybrid Bikes Instruction Manual

[Home](#) » [CUBE](#) » CUBE Fold Hybrid Bikes Instruction Manual 



Operating manual
Faltmechanismus CUBE Fold Hybrid

Contents

- 1 Operating manual to the folding mechanism of the CUBE Fold Hybrid
- 2 Folding process
- 3 Build up
- 4 Documents / Resources
 - 4.1 References

Operating manual to the folding mechanism of the CUBE Fold Hybrid

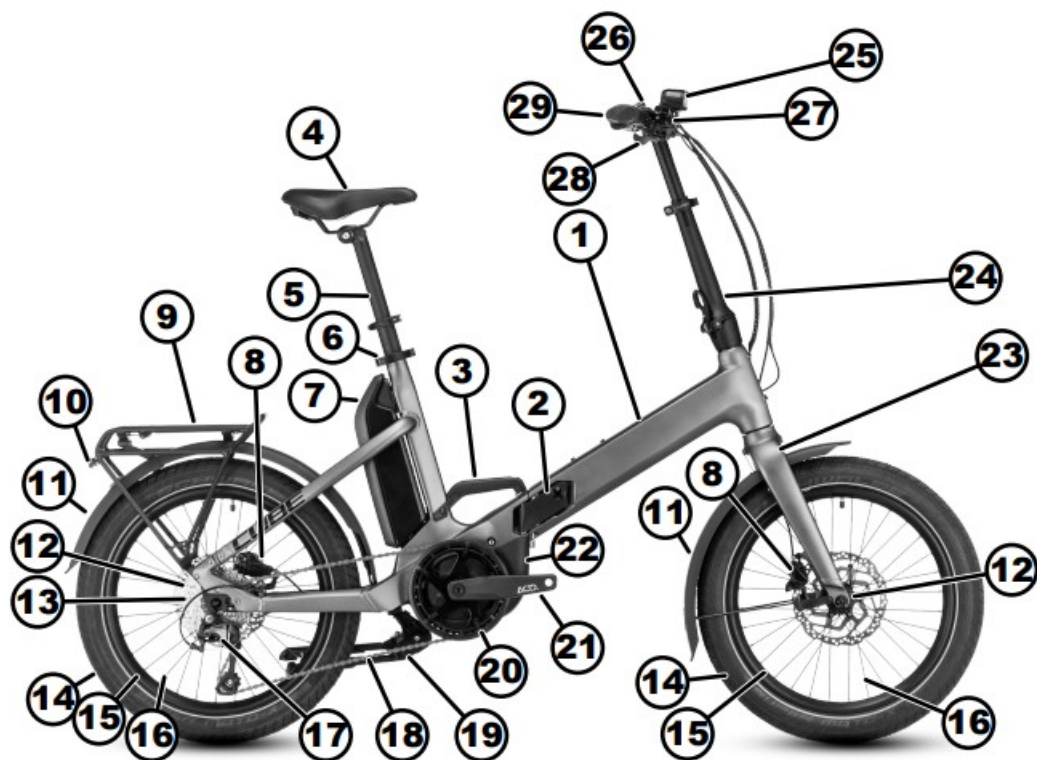

1. Frame
2. Folding joint
3. Carrying handle
4. Saddle
5. Seat post
6. Seat clamp
7. Battery
8. Brake
9. Rear carrier
10. Rear light
11. Mudguard
12. Hub
13. Cassette
14. Rim
15. Tire
16. Spoke
17. Rear Derailleur
18. Chain
19. Kickstand
20. Chain ring
21. Crank arm
22. Mid-drive motor
23. Fork
24. Folding stem
25. Headlight
26. Display

- 27. Brake lever
- 28. Shifter
- 29. Grip

General notes on these operating instructions

! NOTICE

The exclamation mark (without triangle) alerts you to information that requires special attention.

! WARNING

The yellow warning triangle in combination with the signal word "Warning" indicates dangers that can lead to slight personal injury and damage to property.

! DANGER

The yellow warning triangle in combination with the signal word "Danger" indicates dangers that can lead to severe personal injury (up to death).

General information

This supplementary operating manual is intended to familiarize you with the correct handling of the folding mechanism of your Fold Hybrid.

If you should have any further questions about the correct operating of the folding mechanism of your Fold Hybrid, please always contact your CUBE Specialist Dealer.

! NOTICE

Always make sure that your Fold Hybrid stands securely when you transport it in the folded state.

Especially when transporting in public transport and in the car, make sure that the bike is secured against falling over.

When falling over, your bike can be damaged.

Folding process

! WARNING

The e-bike system must always be switched off before starting the folding process.

Failure to do so may result in the motor assistance of the e-bike system kicking in and causing injury.

! NOTICE

Before starting the folding process and for transport in the folded state, remove any luggage from the bike.

! NOTICE

To get a smaller pack size of the bike when needed, the pedals can be folded.

1. Park your bike safely on the kickstand.



Fig. 1: bike on kickstand

2. Fully retract the seat post and the height-adjust-able stem by using the quick-release levers.



Fig. 2: Draw in Seatpost + stem

3. Fold the stem as shown in the following figures.

? Unlock the safety lever (1) of foldable stem by pushing the round unlocking button (2).

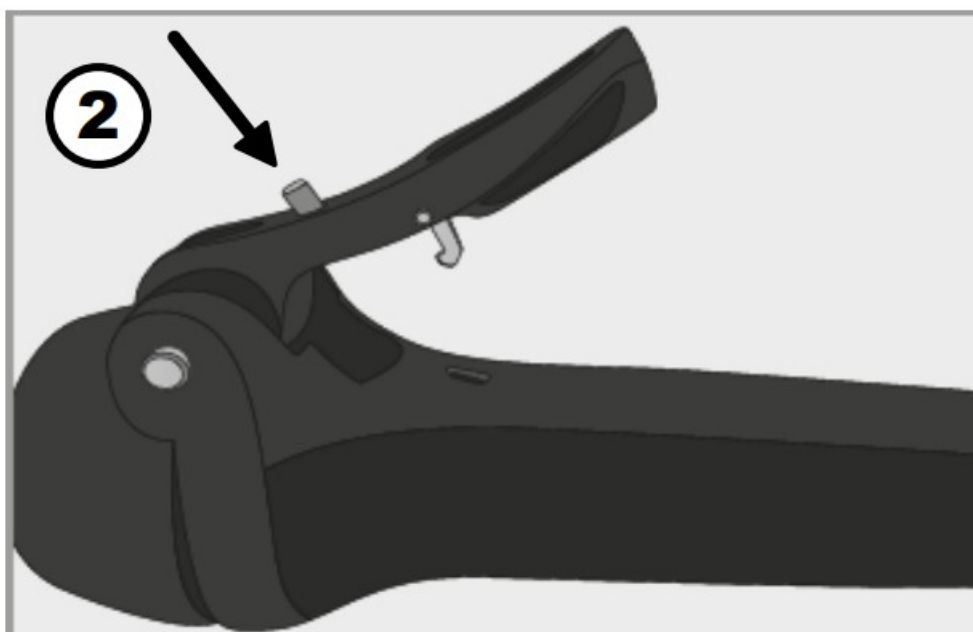
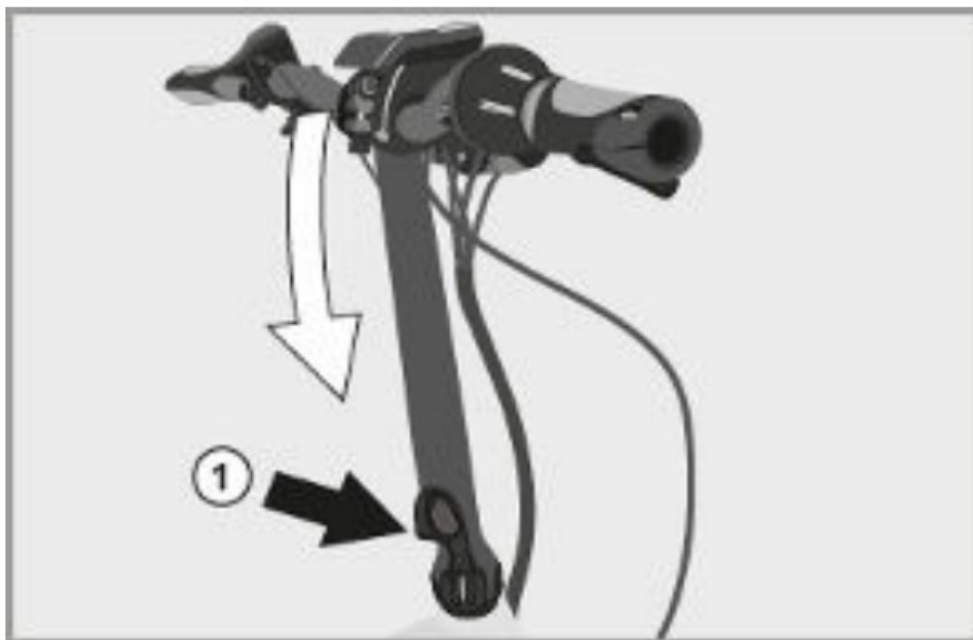

? Fold down the stem together with the handlebars.



Fig. 3: Fold stem

4. Unlock the folding mechanism on the frame.



Fig. 4: Unlock folding mechanism

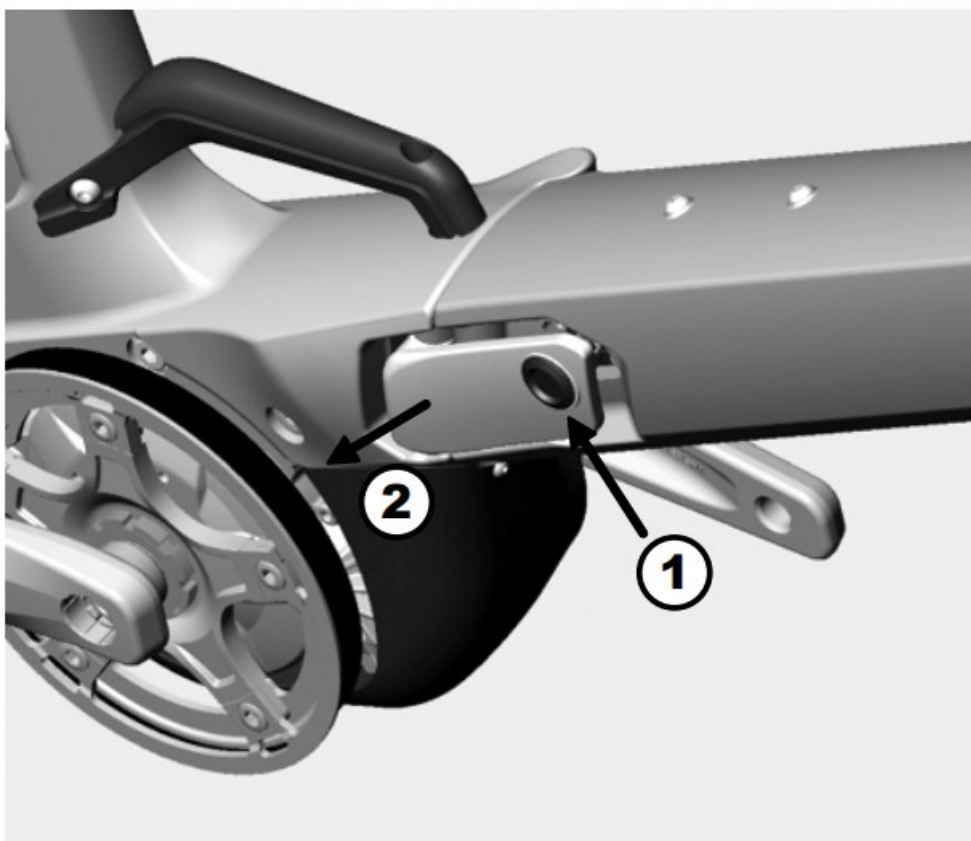

Fig. 5: Fold frame joint

- 1 Press push button.
 - 2 Open frame lock.
5. Swing the front frame part to the rear frame part.



Fig. 6: Swing front frame part (close)

6. By a slight pressure the fork locks on the Klickfix Quadlock adapter.

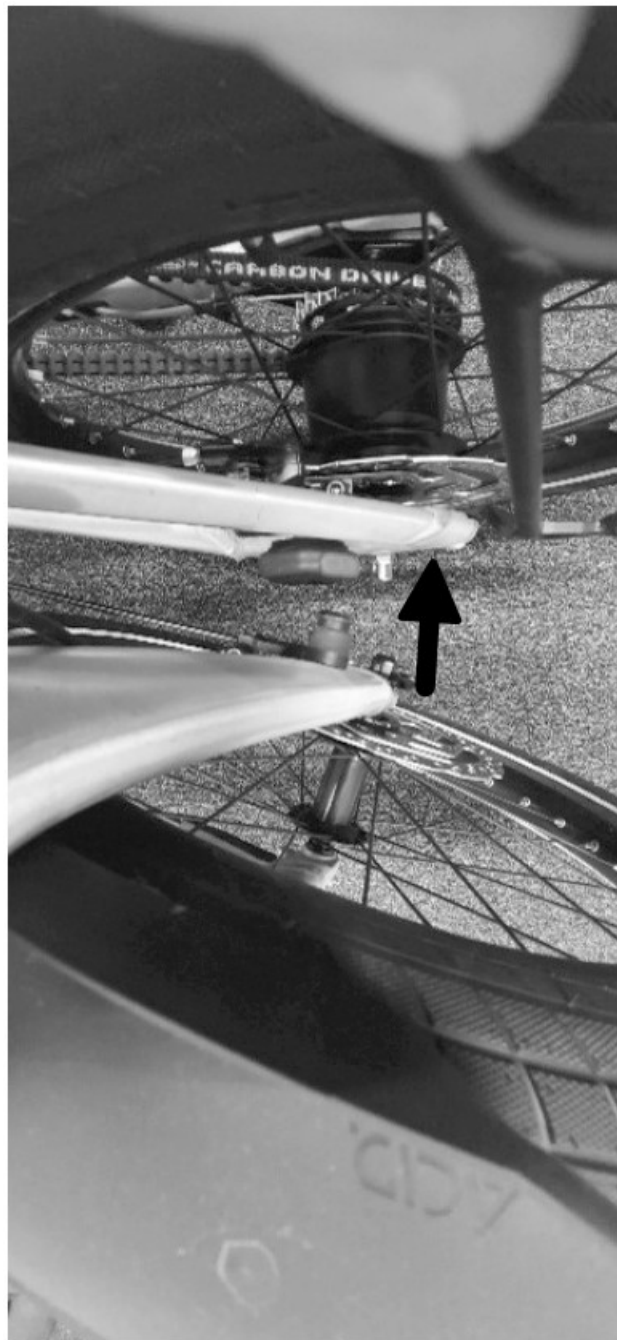

Fig. 7: Close Klickfix Quadlock Adapter



Fig. 8: Klickfix Quadlock Adapter closed

?  **WARNING**

Check that the Klickfix Quadlock adapter is fully engaged between fork and rear triangle.
Otherwise, the Fold Hybrid can be open during transport and result in injuries.

7. Before transporting the bike, fold the kickstand back in.

? Your bike is now completely folded and can be transported safely with the help of the carrying handle.

Build up

! **NOTICE**

Before you start setting up the Fold Hybrid, unfold the kickstand and place the bike on it.



Fig. 9: Bike folded on stand

1. Open the lock by pressing the Klickfix Quadlock adapter.

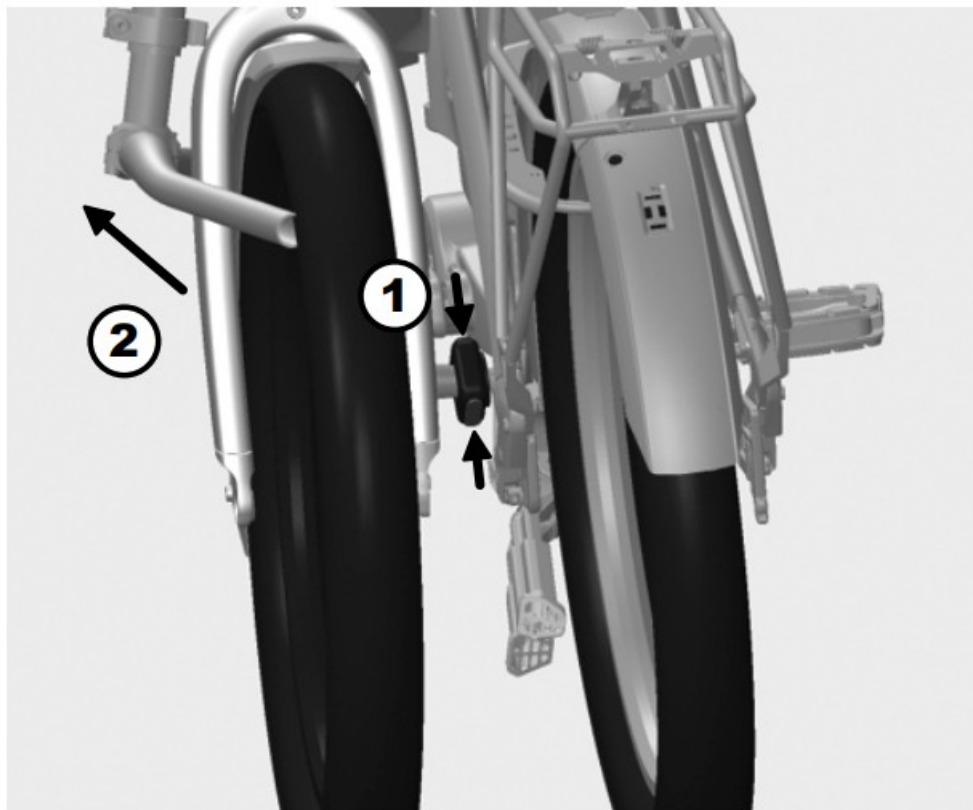

Fig. 10: Open Klickfix Quadlock Adapter

- 1 Press the release mechanism of the Klickfix Quad-lock Adapters.
- 2 Detach the front frame part from the adapter.
2. Swing the front frame part 180° into the driving direction until the joint is closed.



Fig. 11: Swing front frame (open)

3. Lock the Frame joint

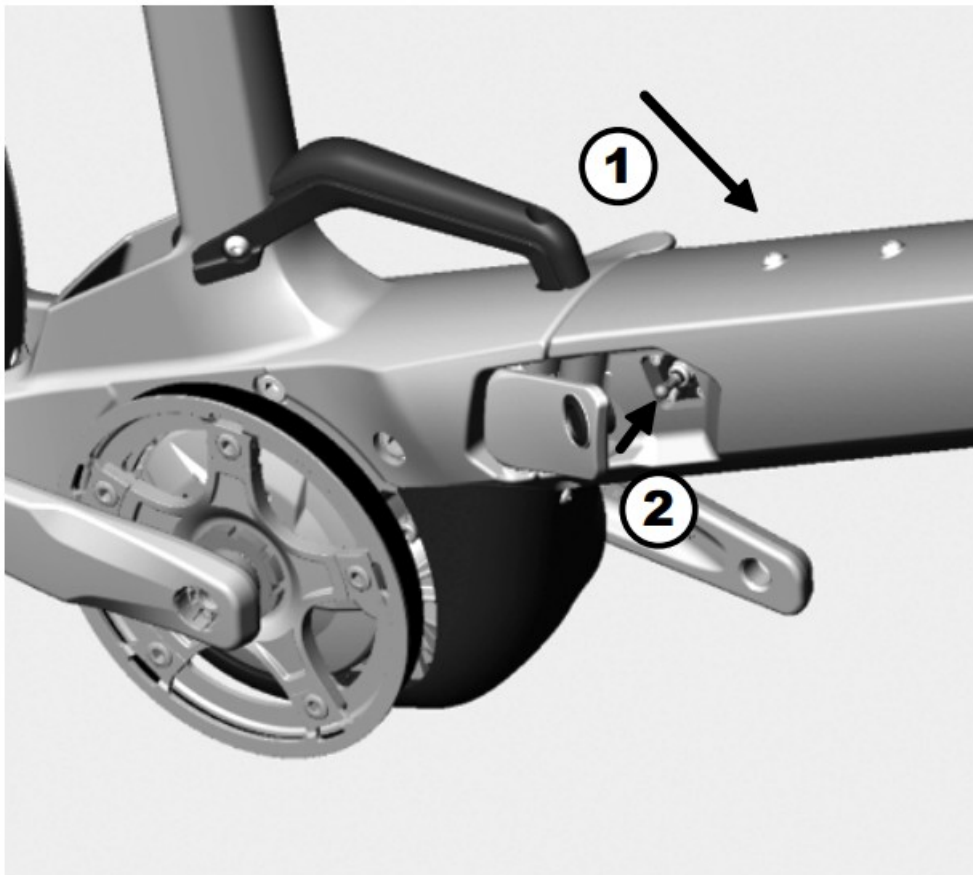

Fig. 12: Close and lock frame joint

1 Close the frame joint completely.

2 Lock the folding mechanism by engaging the lever in the ball head.



Fig. 13: Lock the folding mechanism by engaging the lever in the ball head

?  **DANGER**

Make sure that the frame joint is fully closed and the lever is correctly locked in the ball head. Otherwise, the joint of the frame may open while driving.

This can lead to dangerous driving situations, falls, accidents and property damage.

4. Set up the stem as shown in the images.

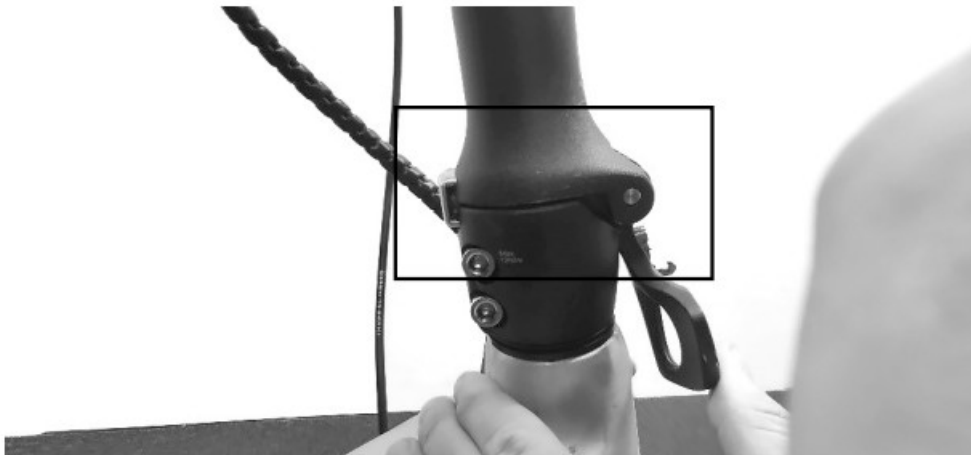

Fig. 14: Set up stem

? Push the lever all the way down.



? Fully straighten the stem, the upper part must be flush with the lower part.



? Lock the lever on the stem in the upward position.



 **DANGER**

Make sure that the stem joint is fully closed and the lever is correctly locked.

Otherwise, the stem joint may open while riding.

This can lead to dangerous driving situations, falls, accidents and property damage.

5. Adjust the saddle and stem height to your needs for safe riding and guiding of the bike.



Fig. 15: Adjust stem and saddle height

DANGER

Observe the correct insertion depth of the seat post.

The maximum distance to which the seat post can be pulled out of the frame is marked on the seat post.

Never pull the seat post out further than this marking!

Otherwise, the seat post may come loose from the frame.

This can lead to dangerous driving situations, falls, accidents and property damage.

NOTICE

If the pedals have been folded, return them to their original position.

Fold the kickstand back in before starting to ride!

? Your bike is now fully assembled and ready to ride.

Legal notice

Manufacturer:

Pending System GmbH & Co. KG

Ludwig-Hüttner-Straße 5-7

95679 Waldershof

Germany

www.cube.eu

info@cube.eu

FON: +49(0) 9231-97 007 80

FAX: +49(0) 9231-97 007 199

Status: March 2023

Documents / Resources

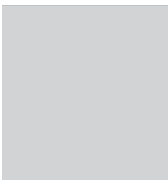
	<p>CUBE Fold Hybrid Bikes [pdf] Instruction Manual Fold Hybrid Bikes, Fold, Hybrid Bikes, Bikes</p>
---	---

References

- [User Manual](#)

[Manuals+](#), [Privacy Policy](#)